



Prime Retail Spaces Available on Westlake Ave

307 Westlake Avenue N,
Seattle, WA 98109



307
WESTLAKE

A  BioMed Realty property

307 WESTLAKE

Situated at the corner of Westlake Ave N and Thomas St in South Lake Union, this retail opportunity offers versatile space suitable for food and beverage concepts as well as a broad range of retail and service uses. Retail spaces are available with flexible configurations designed to accommodate a variety of business needs.

Positioned in the heart of one of Seattle's most dynamic neighborhoods, the property is surrounded by leading tech employers, high density residential, and established local businesses, generating steady daytime and evening activity.

With open layouts, strong visibility, and a prominent corner presence, these spaces present an exceptional opportunity for retailers, restauranteurs, and service providers looking to establish or expand their presence in the vibrant South Lake Union community.



99

Walk Score
"Walker's Paradise"



89

Transit Score
"Excellent Transit"



77

Bike Score
"Very Bikeable"



STRONG DEMOGRAPHICS



Average Household Income:

- 1-Mile: \$135,055
- 2-Mile: \$134,533
- 3-Mile: \$137,030



Population:

- 1-Mile: 89,040
- 2-Mile: 184,051
- 3-Mile: 273,092

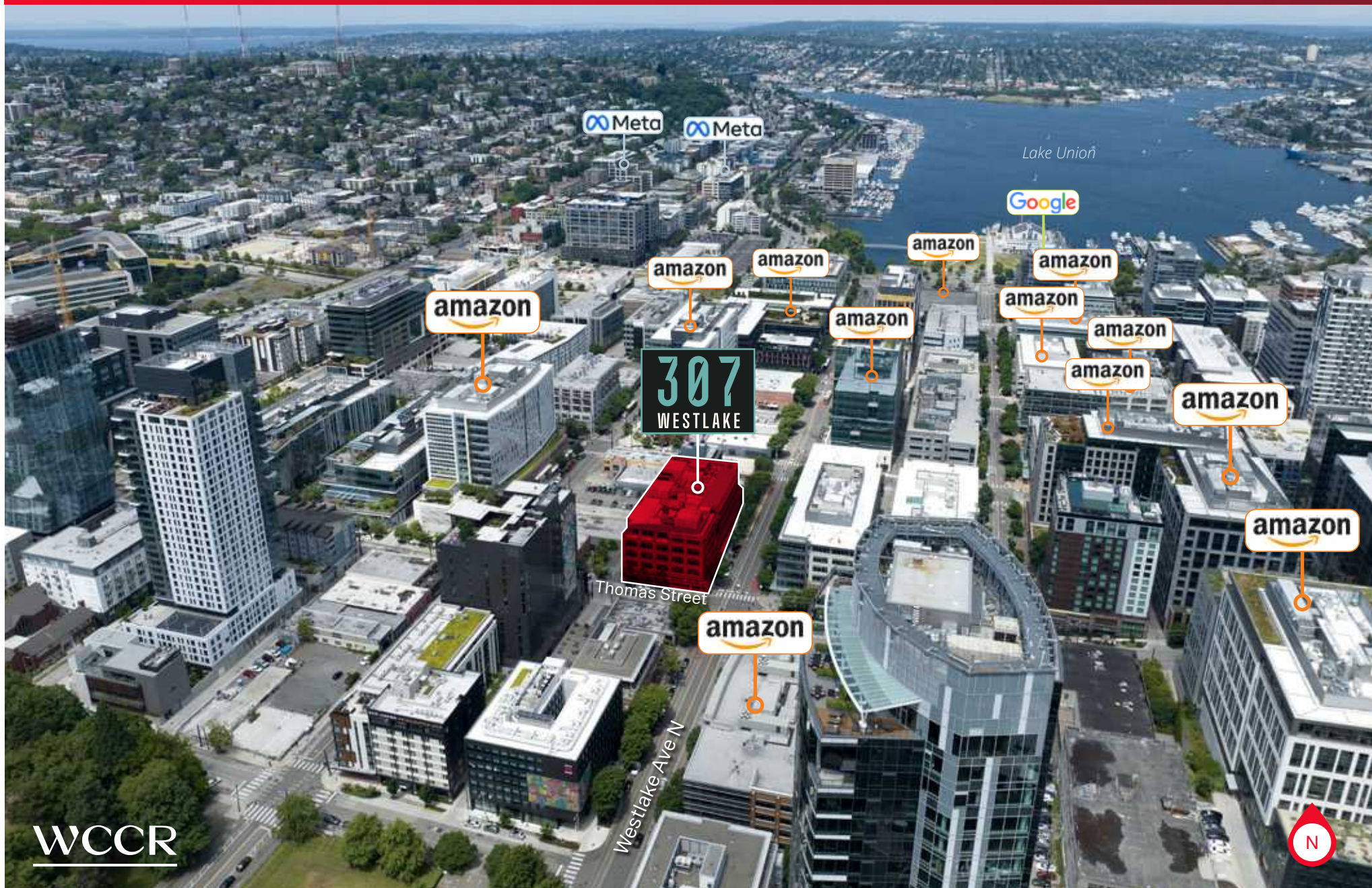

LOCATED IN THE HEART OF SOUTH LAKE UNION

Located within 0.5 miles

135 Restaurants, Bars & Cafes

2 National Grocers

50 Boutiques & Shops

CULTURAL CENTERS

- Climate Pledge Arena
- Pacific Science Center
- McCaw Hall
- Cornish Playhouse
- Space Needle
- Chihuly Garden & Glass
- MOHAI
- Center for Wooden Boats
- The Gates Foundation



SITE PLAN

Retail 1 - 1,378 SF Available (2nd generation restaurant)

Retail 3 - 1,386 SF Available

Retail 4 - 1,386 SF Available

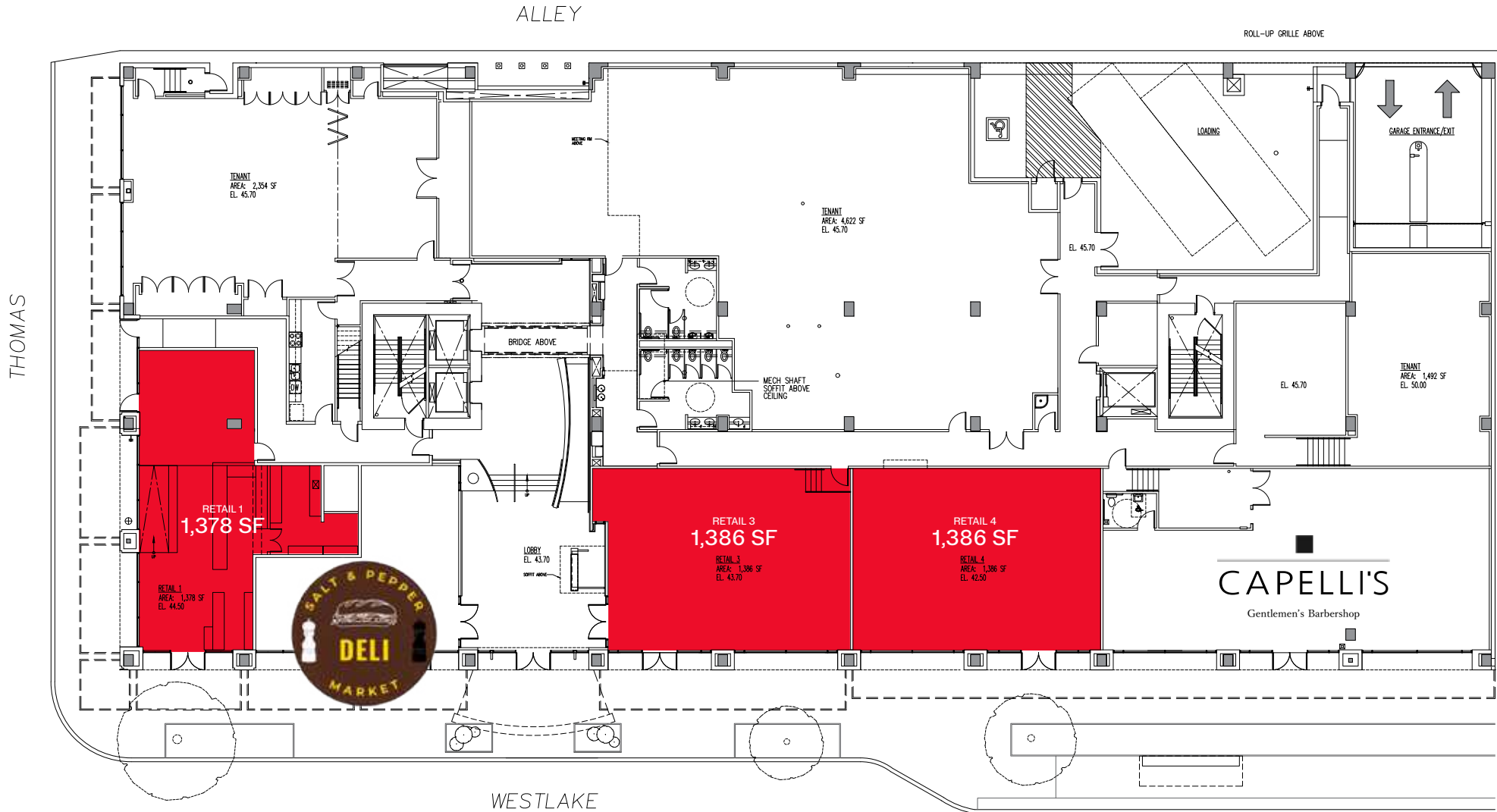

FLOOR PLAN

Retail 1 -
1,378 SF Available
2nd generation restaurant



Elevation view from Thomas St



Elevation view from Westlake Ave

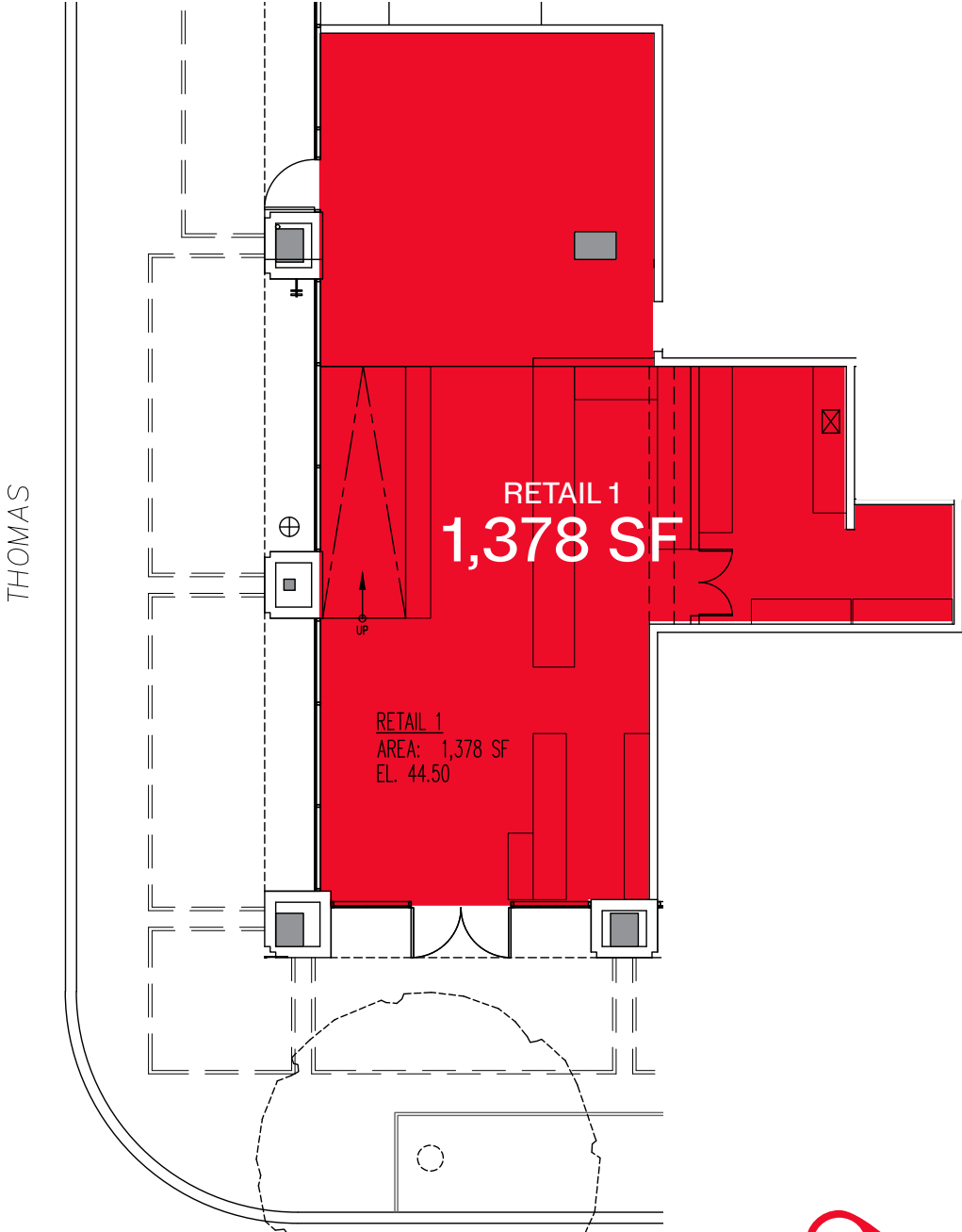

FLOOR PLAN

Retail 3 -
1,386 SF Available

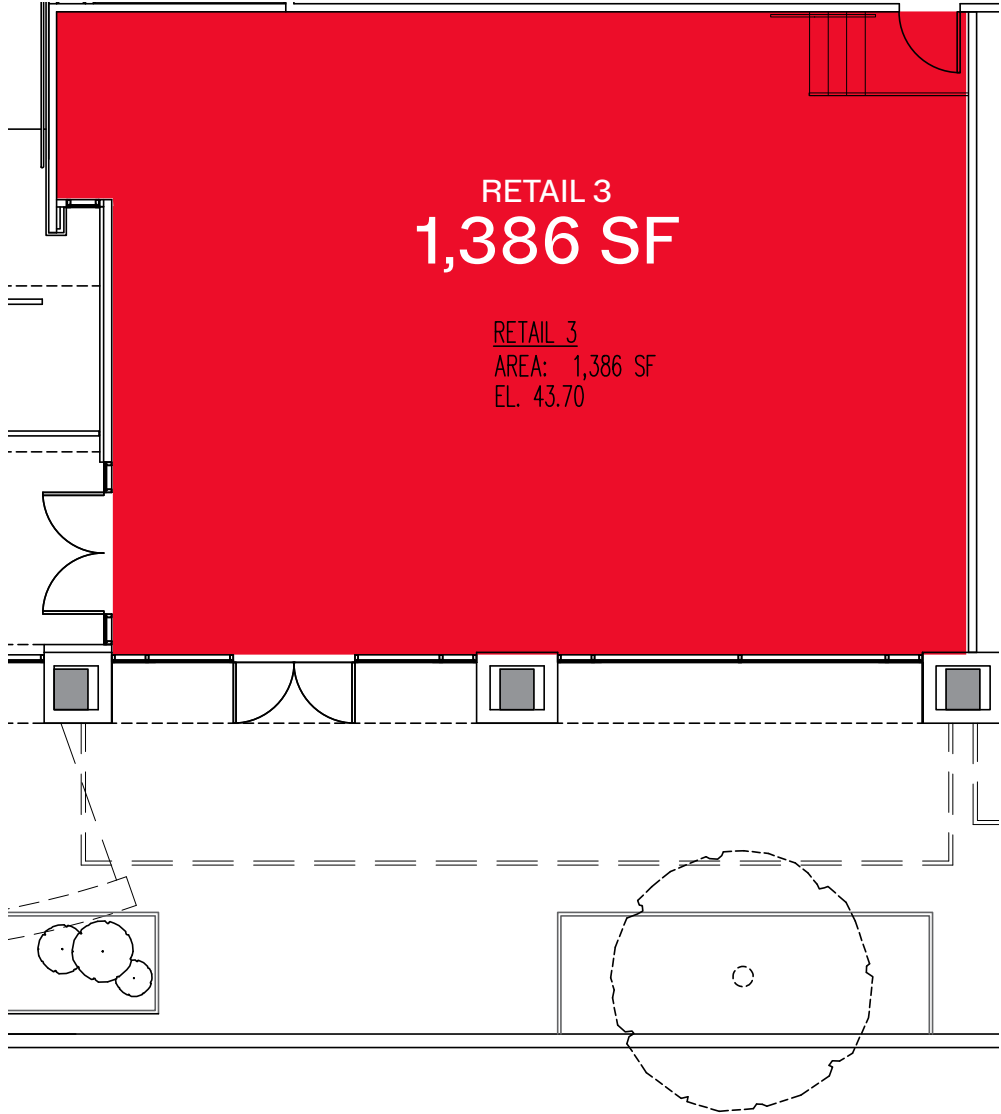

WESTLAKE



FLOOR PLAN

Retail 4 -
1,386 SF Available

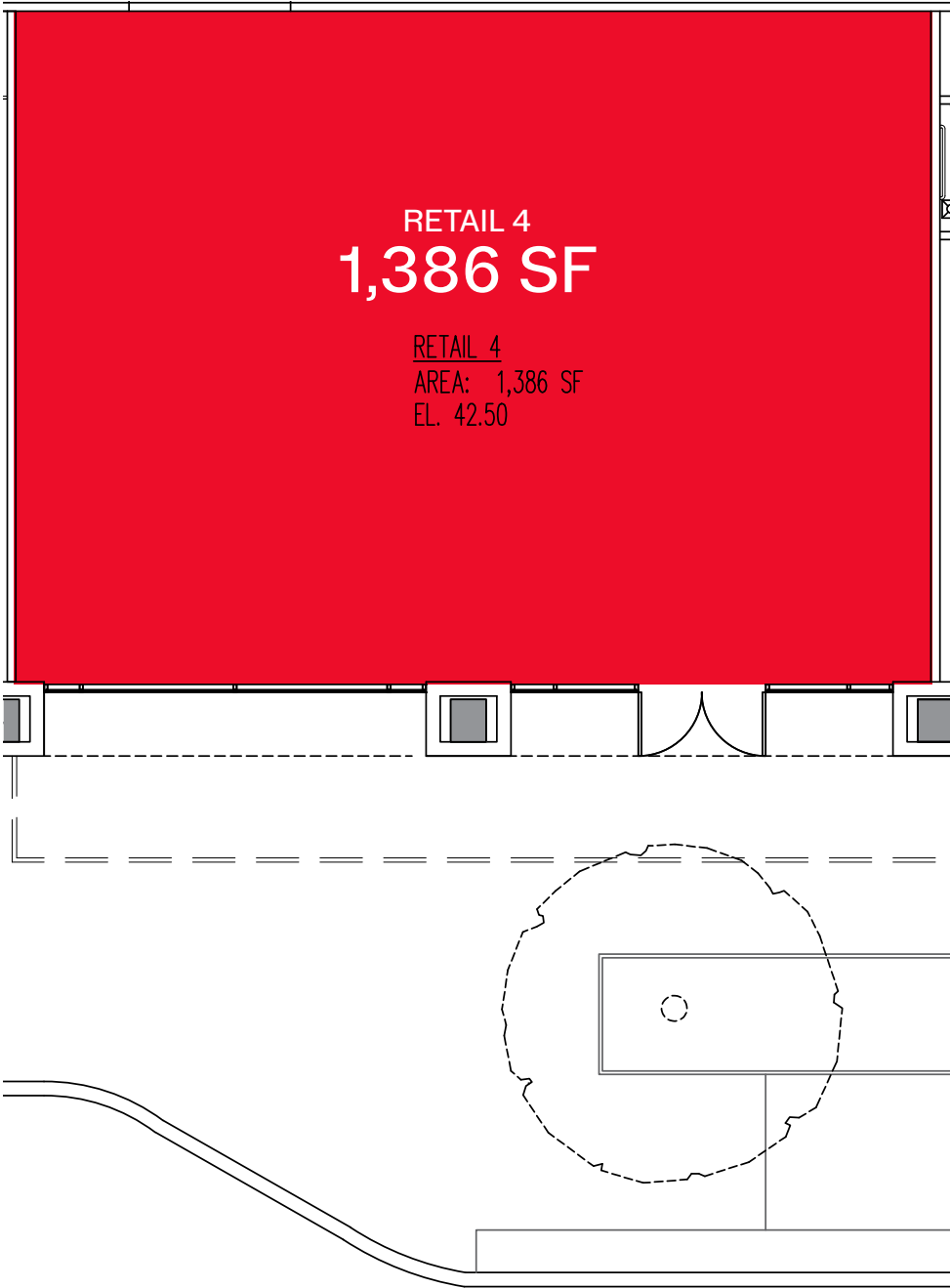

WESTLAKE



307 WESTLAKE

307 Westlake Avenue N,
Seattle, WA 98109

Tiffini Connell

tiffini@wccommercialrealty.com
206 854 1925

Avery Connell

avery@wccommercialrealty.com
206 475 9367

Kara Farley

karaf@wccommercialrealty.com
682 351 8844

DISCLAIMER: The above information has been secured from sources believed to be reliable, however, no representations are made to its accuracy. Prospective tenants or buyers should consult their professional advisors and conduct their own independent investigation. Site plan and configuration are subject to change. Properties are subject to change in price and/or availability without notice. West Coast Commercial Realty, LLC

MEMBER OF **SITE SOURCE** **CBA** **Cisc** **CoStar**
RETAIL BROKER NETWORK

WCCR | West Coast
Commercial
Realty

206 283 5212
wccommercialrealty.com

