

FOR LEASE

2424

8TH AVE S | SEATTLE, WA 98134

AVAILABLE SF

59,915 SF

OFFICE SF

18,879 SF (Divisible to 6,725 SF)

[8thavepoint.com](http://8thavepoint.com)



**NEWMARK**

**THAD MALLORY, SIOR**  
thad.mallory@nmrk.com  
425-362-1410

**CAM WARREN**  
cam.warren@nmrk.com  
425-362-1395

**BLAKE BENTZ**  
blake.bentz@nmrk.com  
425-362-1391

**EVAN LUGAR**  
evan.lugar@nmrk.com  
425-362-1403



# BUILDING DETAILS

ADDRESS	2424 8th Ave S, Seattle, WA
TOTAL AVAILABLE SF	59,915 SF
TOTAL OFFICE SF	18,879 SF (Divisible to 6,725 SF)
CLEAR HEIGHT	20' - 24'
LOADING	34 Dock Positions (16 Double Wide Doors)
RATE	\$1.20 PSF, \$0.50 NNN

# RECENT CAPITAL IMPROVEMENTS

- Seismic Upgrades
- New Roof
- Dock Packages
- New Bogey Strip in the Truck Court
- Office Improvements
- New Paint and Building Façade

VIRTUAL TOUR

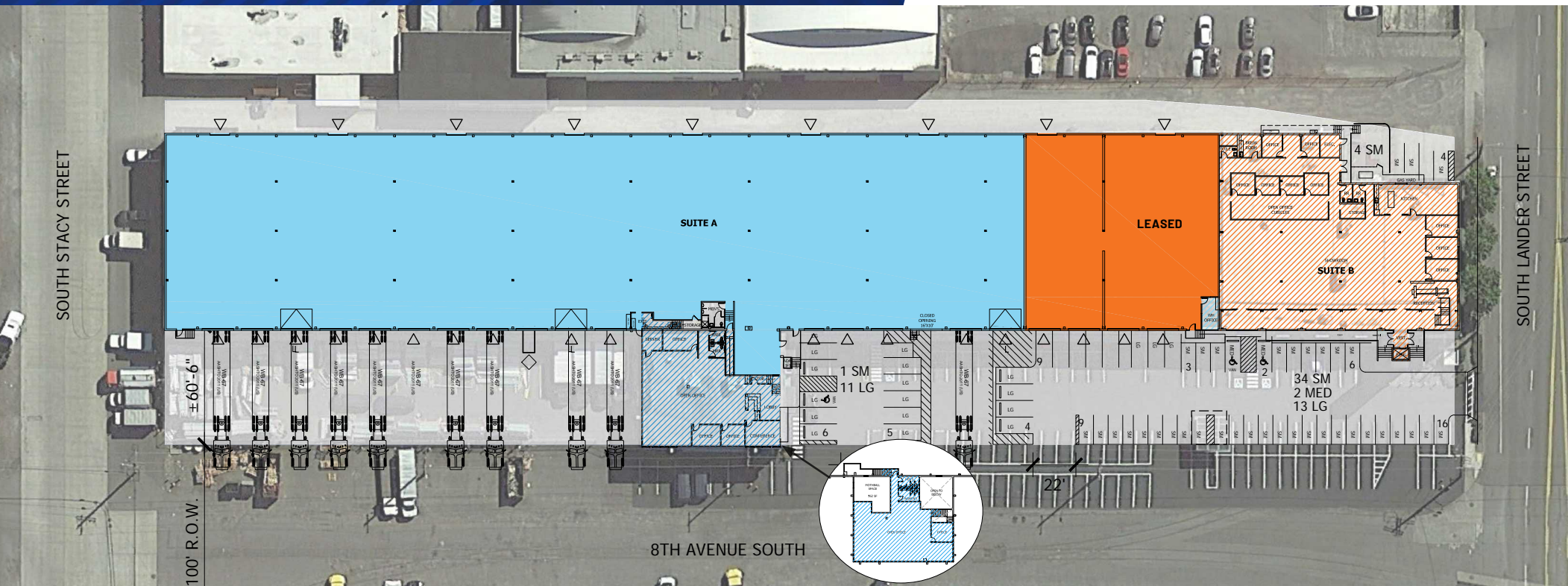

# BUILDING PHOTOS

PROPERTY VIDEO 



# DRIVE TIMES



PORT OF SEATTLE

3.2 Miles



SEA-TAC AIRPORT

10.7 Miles

# 2424

8TH AVE S | SEATTLE, WA 98134

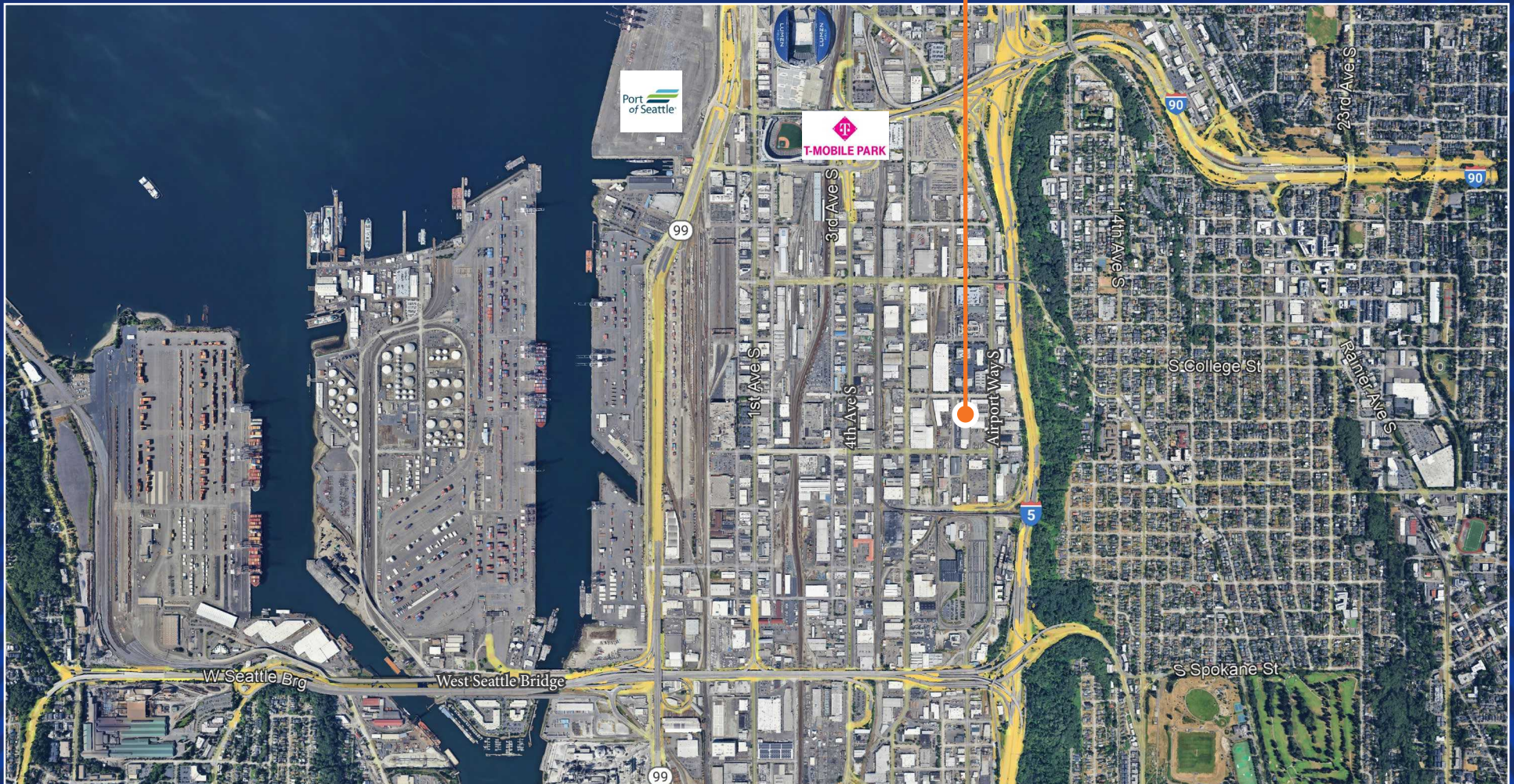

# 2424

8TH AVE S | SEATTLE, WA 98134

[8thavepoint.com](http://8thavepoint.com)



**THAD MALLORY, SIOR**  
thad.mallory@nmrk.com  
425-362-1410

**CAM WARREN**  
cam.warren@nmrk.com  
425-362-1395

**BLAKE BENTZ**  
blake.bentz@nmrk.com  
425-362-1391

**EVAN LUGAR**  
evan.lugar@nmrk.com  
425-362-1403

**NEWMARK**

The distributor of this communication is performing acts for which a real estate license is required. The information contained herein has been obtained from sources deemed reliable but has not been verified and no guarantee, warranty or representation, either express or implied, is made with respect to such information. Terms of sale or lease and availability are subject to change or withdrawal without notice. 9270997124 06/2025