



## WAREHOUSE & OFFICE FOR LEASE

126 S. Sheridan St.,  
Spokane, WA 99202

- LOCATION:** Conveniently located along Pacific Ave., between Sherman and Sheridan, within the periphery of downtown Spokane, minutes to I-90. Office area is directly off of Sheridan Street, one block south of Sprague Ave.
- SITE:** A portion of a ±42,600 SF multi-tenant site; parcel 35202.1302
- ZONING:** City of Spokane DTU, Downtown University; allows for limited industrial uses including warehouse, freight movement, wholesale, manufacturing and production that meets the low impact criteria of the zoning code
- YEAR BUILT:** 1935

	<b>Warehouse</b>	<b>Office</b>
<b>Total Area:</b>	±6,786 SF	±1,920 SF
<b>Heat:</b>	Two (2) gas unit heaters	HVAC
<b>Loading:</b>	11'8" W x 9'10" H van high loading door	*office lease includes
<b>Construction Type:</b>	Concrete Block	common area restrooms
<b>Ceiling Height:</b>	Beam: 16'8"; Ceiling: 17'9" - 18'5"	
<b>Monthly Rent (full service, excluding janitorial):</b>	\$4,800/Month/Gross	\$2,420/Month/Gross
<b>Availability:</b>	Immediately	Immediately
<b>Utilities:</b>	Rent is inclusive of all utilities	
	Warehouse and office area can be leased together or separately	

**Mark Lucas, SIOR |**  
509.755.7524  
mlucas@kiemlehagood.com

**Tracy Lucas |**  
509.755.7558  
tracyl@kiemlehagood.com



# WAREHOUSE & OFFICE FOR LEASE

126 S. Sheridan St.,  
Spokane, WA 99202

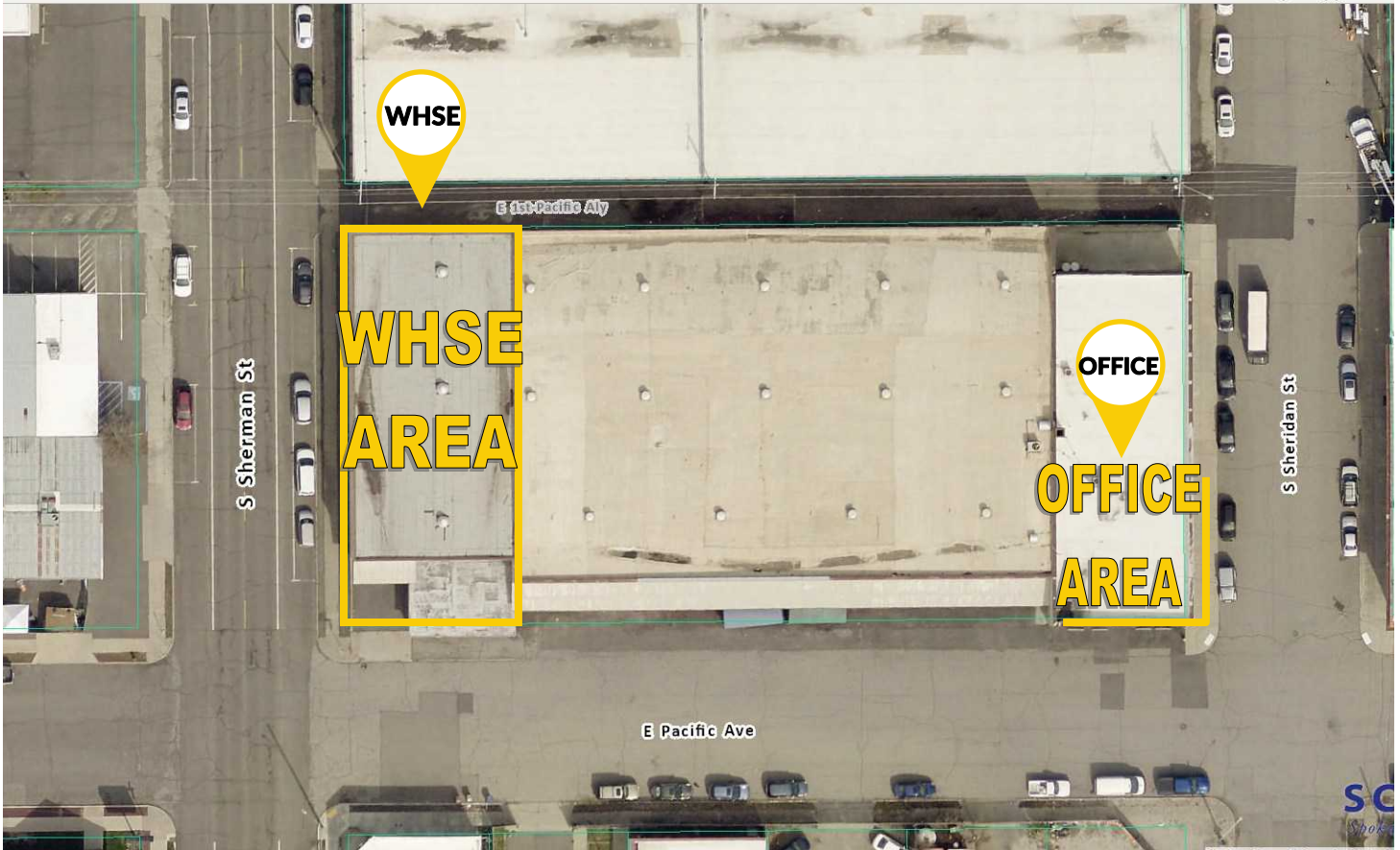

## WAREHOUSE SPACE FOR LEASE

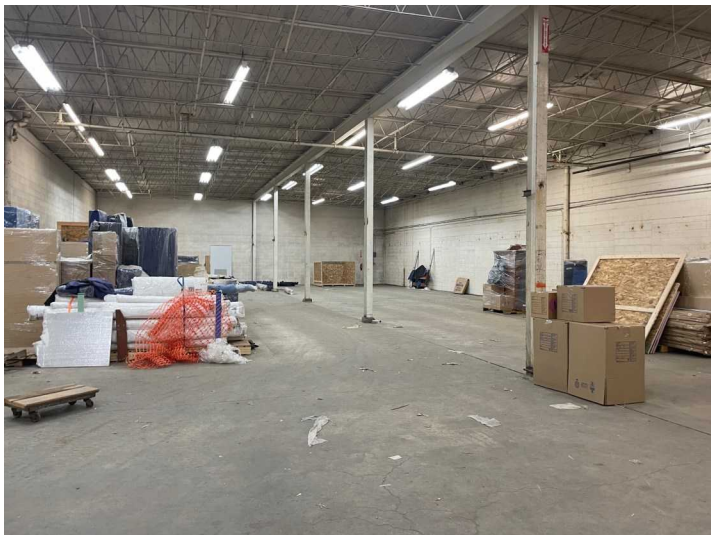

# WAREHOUSE FLOOR PLAN

126 S. Sheridan St.,  
Spokane, WA 99202

THIS DRAWING IS FOR CONVENIENCE ONLY. ALL CRITICAL MEASUREMENTS SHOULD BE VERIFIED BY PURCHASER OR LESSEE. ALL RIGHTS RESERVED.  
NO PART OF THIS DOCUMENT MAY BE REPRODUCED IN ANY FORM OR BY ANY MEANS WITHOUT WRITTEN PERMISSION FROM TRACY LUCAS.

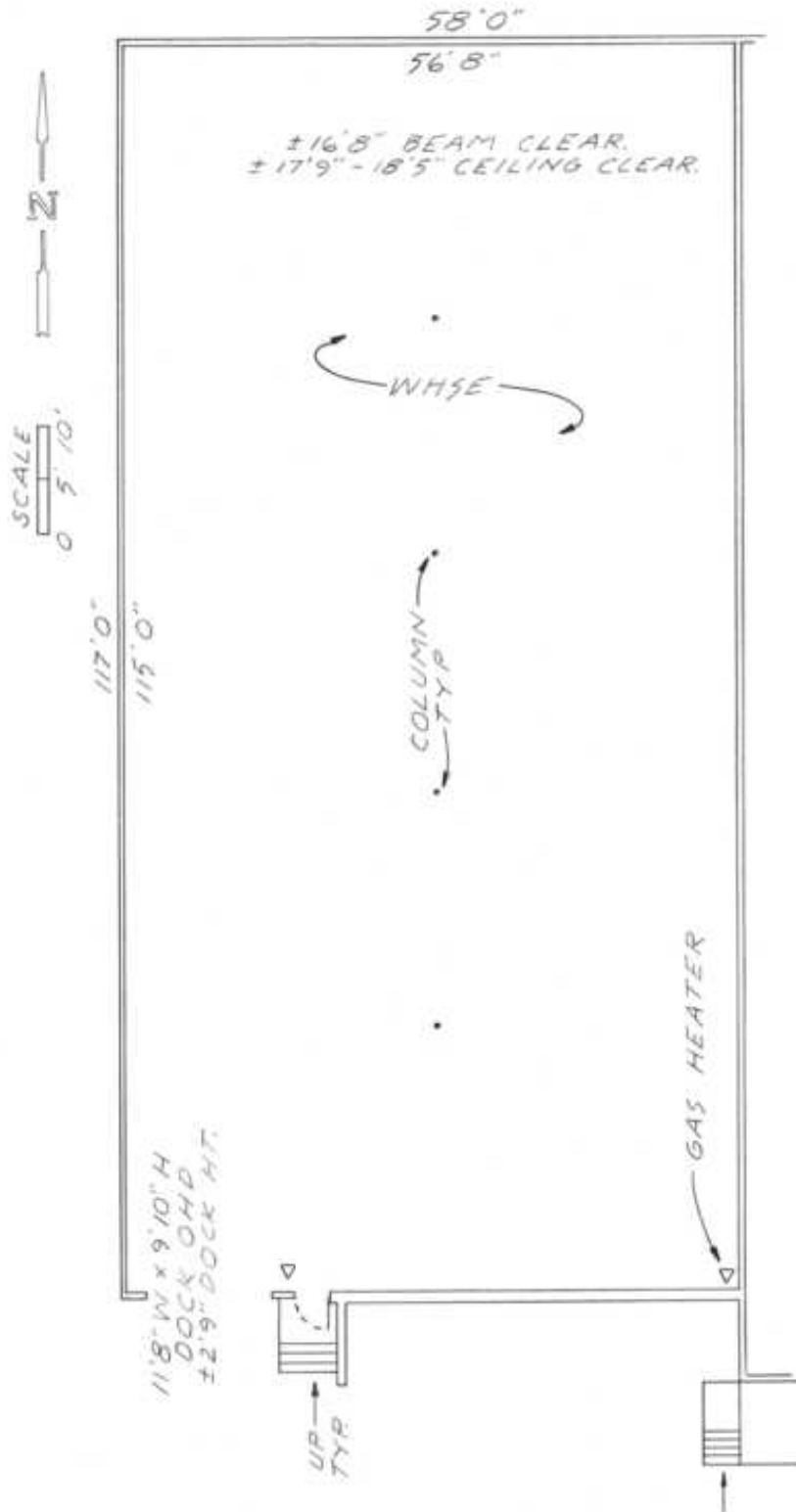

**Mark Lucas, SIOR** |  
509.755.7524  
mlucas@kiemleahgood.com

**Tracy Lucas** |  
509.755.7558  
tracyl@kiemleahgood.com

# OFFICE FLOOR PLAN

126 S. Sheridan St.,  
Spokane, WA 99202

THIS DRAWING IS FOR CONVENIENCE ONLY. ALL CRITICAL MEASUREMENTS SHOULD BE VERIFIED BY PURCHASER OR LESSEE. ALL RIGHTS RESERVED. NO PART OF THIS DOCUMENT MAY BE REPRODUCED IN ANY FORM OR BY ANY MEANS WITHOUT WRITTEN PERMISSION FROM TRACY LUCAS.

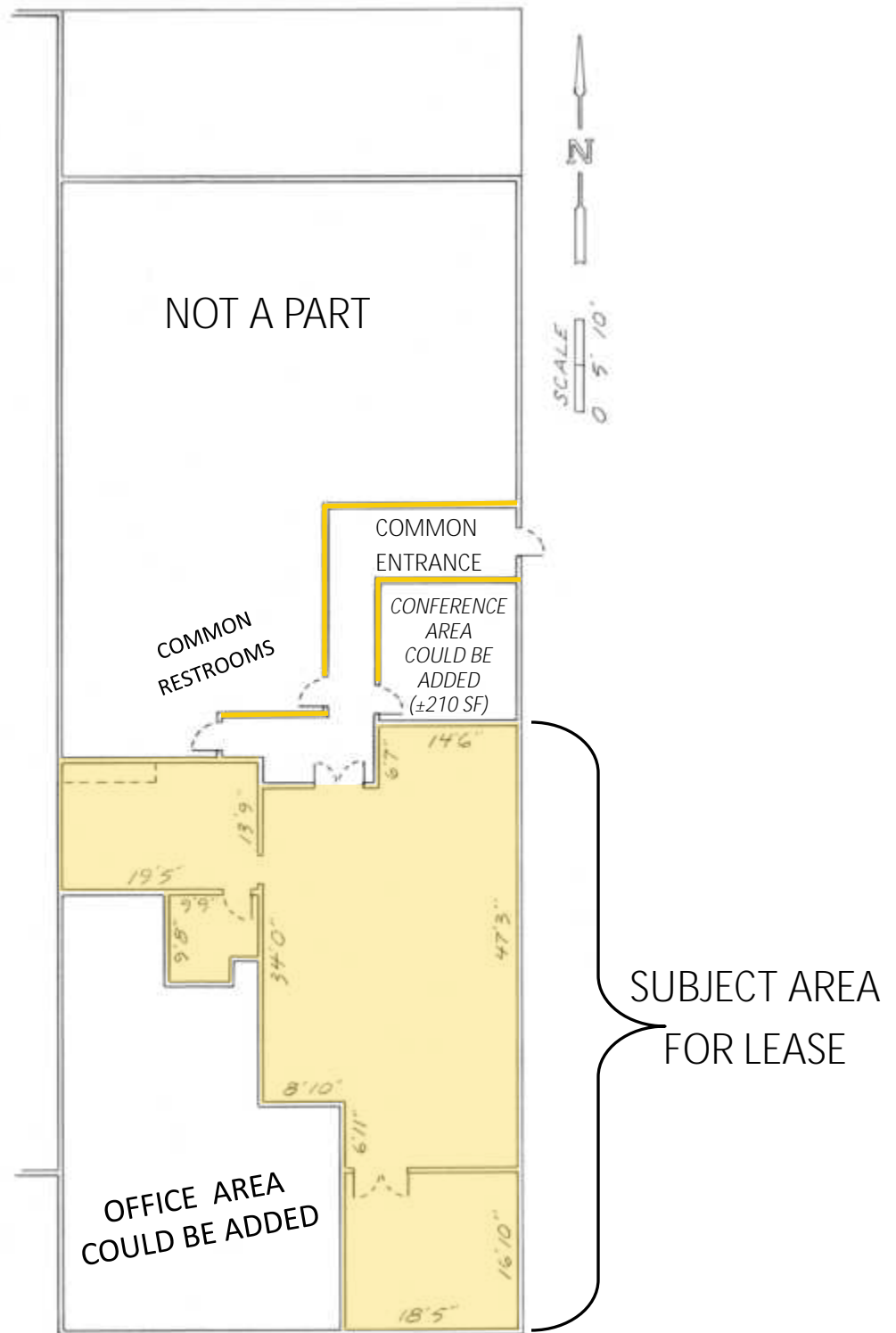

**Mark Lucas, SIOR** |  
509.755.7524  
mlucas@kiemlehagood.com

**Tracy Lucas** |  
509.755.7558  
tracyl@kiemlehagood.com

126 S. Sheridan St., Spokane, WA 99202

OFFICE SPACE FOR LEASE



# 126 S. Sheridan St., Spokane, WA 99202

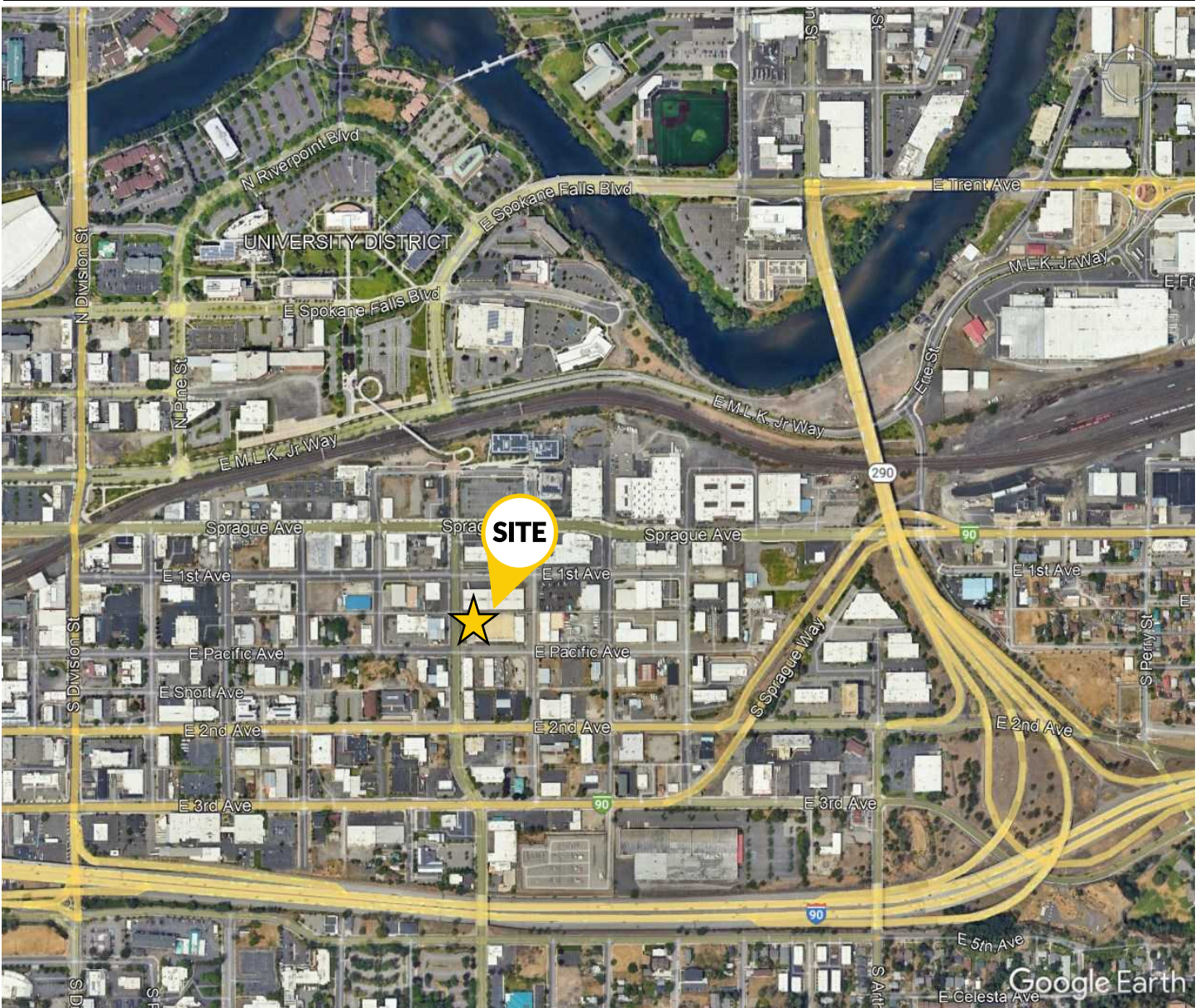

**Mark Lucas, SIOR |**  
**509.755.7524**  
**mlucas@kiemlehagood.com**

**Tracy Lucas |**  
**509.755.7558**  
**tracyl@kiemlehagood.com**

601 W. Main Avenue, Suite 400  
Spokane, WA 99201

**KIEMLE  
HAGOOD**

OFFICE LOCATIONS

SPOKANE | COEUR D'ALENE | TRI-CITIES | PALOUSE | MISSOULA

Kiemle Hagood respects the intellectual property of others: If you believe the copyright in your work has been violated through this Website, please contact our office for notice of claims of copyright infringement. For your complaint to be valid under the Digital Millennium Copyright Act of 1998 (DMCA), you must provide the following information when providing notice of the claimed copyright infringement: Identify the material on the Website that you believe infringes your work, with enough detail so that we may locate it on the Website; provide your address, telephone number and email address; provide a statement that you have a good faith belief that the disputed use is not authorized by the copyright owner, its agent, or the law; provide a statement that the information in the notification is accurate, and under penalty of perjury, that the complaining party is authorized to act on behalf of owner of an exclusive right that is allegedly infringed; provide your physical or electronic signature. Upon receiving your complaint, Kiemle Hagood will, upon review, remove content that you believe infringes your copyright if the complaint is found valid.