

FOR LEASE

KENT IOS YARD

25220 PACIFIC HIGHWAY S, KENT, WA

43,332 SF IOS Development Site

Parcel Number: 212204-9056

Commercial Manufacturing (CM) Zoning

5,000 SF Warehouse (1,000 SF Office)

16.5' - 18' Clear Height

4 Ground-Level Doors

Site is Paved, Fenced, & Lit

Unparalleled Access to Pacific Hwy S/SR-509

Call Broker for Pricing

DANE DAHLINE, SIOR

Senior Vice President

206.248.6519 | dane.dahline@kidder.com

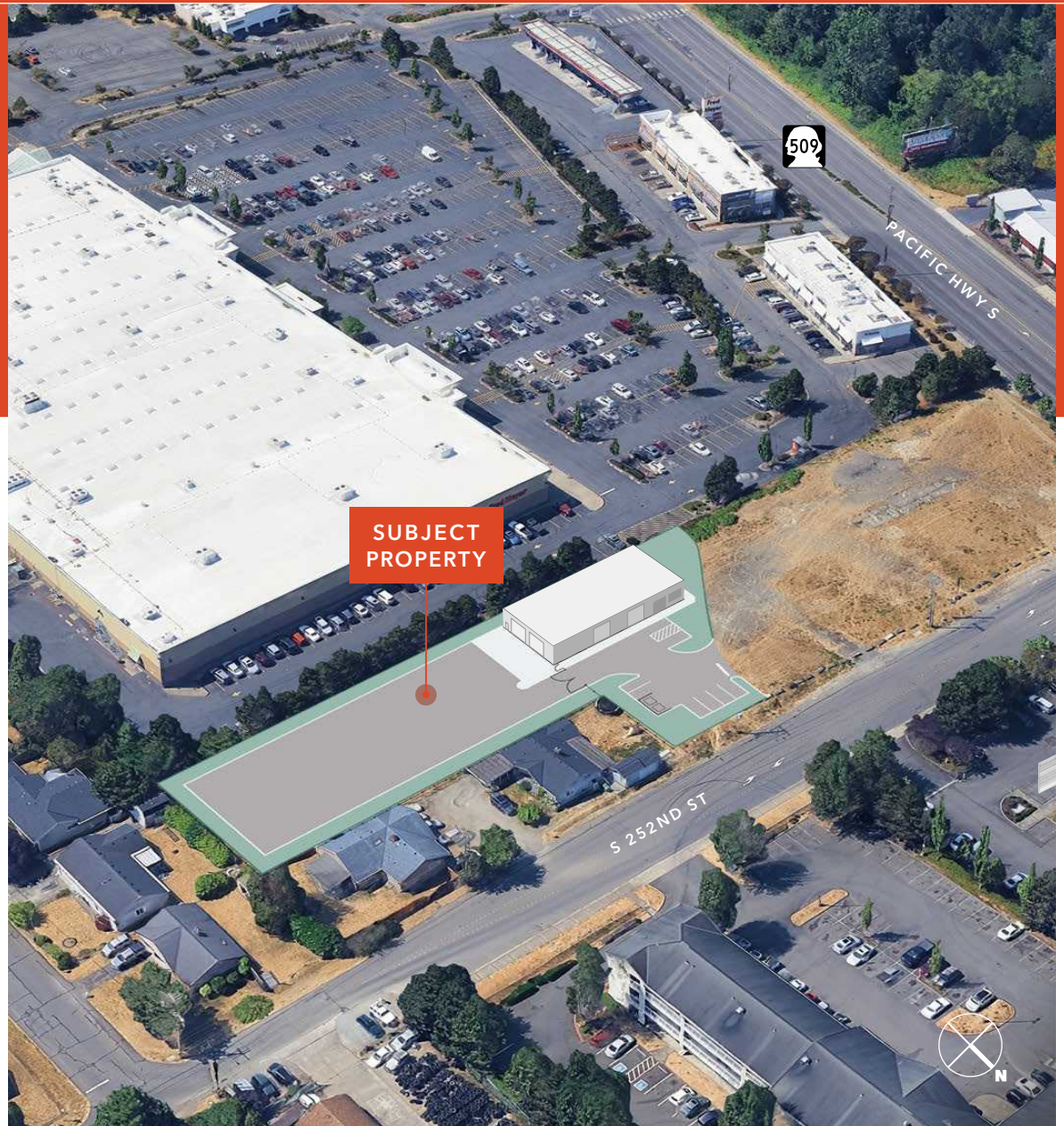

KIDDER.COM

This information supplied herein is from sources we deem reliable. It is provided without any representation, warranty, or guarantee, expressed or implied as to its accuracy. Prospective Buyer or Tenant should conduct an independent investigation and verification of all matters deemed to be material, including, but not limited to, statements of income and expenses. Consult your attorney, accountant, or other professional advisor. All Kidder Mathews designs are the sole property of Kidder Mathews. Branded materials and layouts are not authorized for use by any other firm or person.

km Kidder
Mathews



1.5 MI

TO I-5

4.5 MI

TO SEATAC AIRPORT

7 MI

TO I-405

8 MI

TO SR-18

14 MI

TO PORT OF TACOMA

17 MI

TO PORT OF SEATTLE

S 252ND ST

25200 PACIFIC HWY S

PACIFIC HIGHWAY S



S 260TH ST



KIDDER.COM

This information supplied herein is from sources we deem reliable. It is provided without any representation, warranty, or guarantee, expressed or implied as to its accuracy. Prospective Buyer or Tenant should conduct an independent investigation and verification of all matters deemed to be material, including, but not limited to, statements of income and expenses. Consult your attorney, accountant, or other professional advisor. All Kidder Mathews designs are the sole property of Kidder Mathews. Branded materials and layouts are not authorized for use by any other firm or person.

