

FOR LEASE

901 PACIFIC AVE

TACOMA, WA 98402

*1,335 SF - 2,168 SF Retail Spaces
Available Now in Downtown Tacoma*

COMING SOON

**graze
craze**
CHARCUTERIE BOARDS & BOXES



KIDDER.COM

km Kidder
Mathews



Multiple retail spaces with street frontage available now in the heart of downtown Tacoma.

AVAILABILITIES

SUITE C	1,335 SF
SUITE D	2,168 SF
LEASE RATE	\$17.00-20.00 PSF, + NNN
NNN	\$6.50

DEMOGRAPHICS

	5 Minutes	10 Minutes	15 Minutes
2024 POPULATION	42,717	126,369	259,149
2029 POPULATION	47,094	131,499	264,786
AVG HH INCOME	\$97,638	\$111,618	\$113,455
MED HH INCOME	\$71,263	\$85,836	\$85,909

\$17-20/SF

LEASE RATE, + NNN



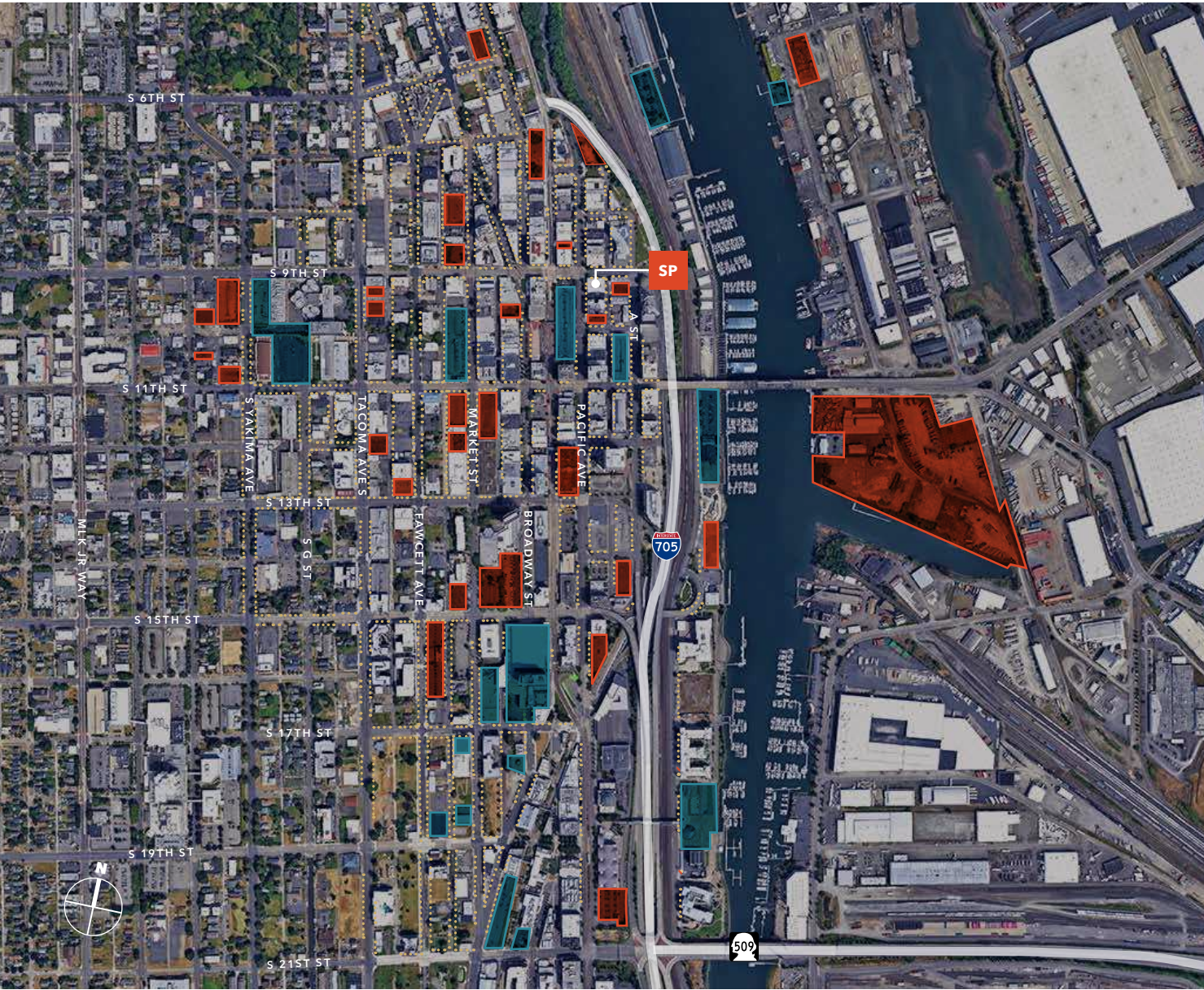

PUBLIC CITY PARKING

LEGEND

-  Subject Property
-  Public Parking Lot
-  Public - Privately Owned Parking Lot
-  Street Parking

S 9TH ST - 8,906 VPD

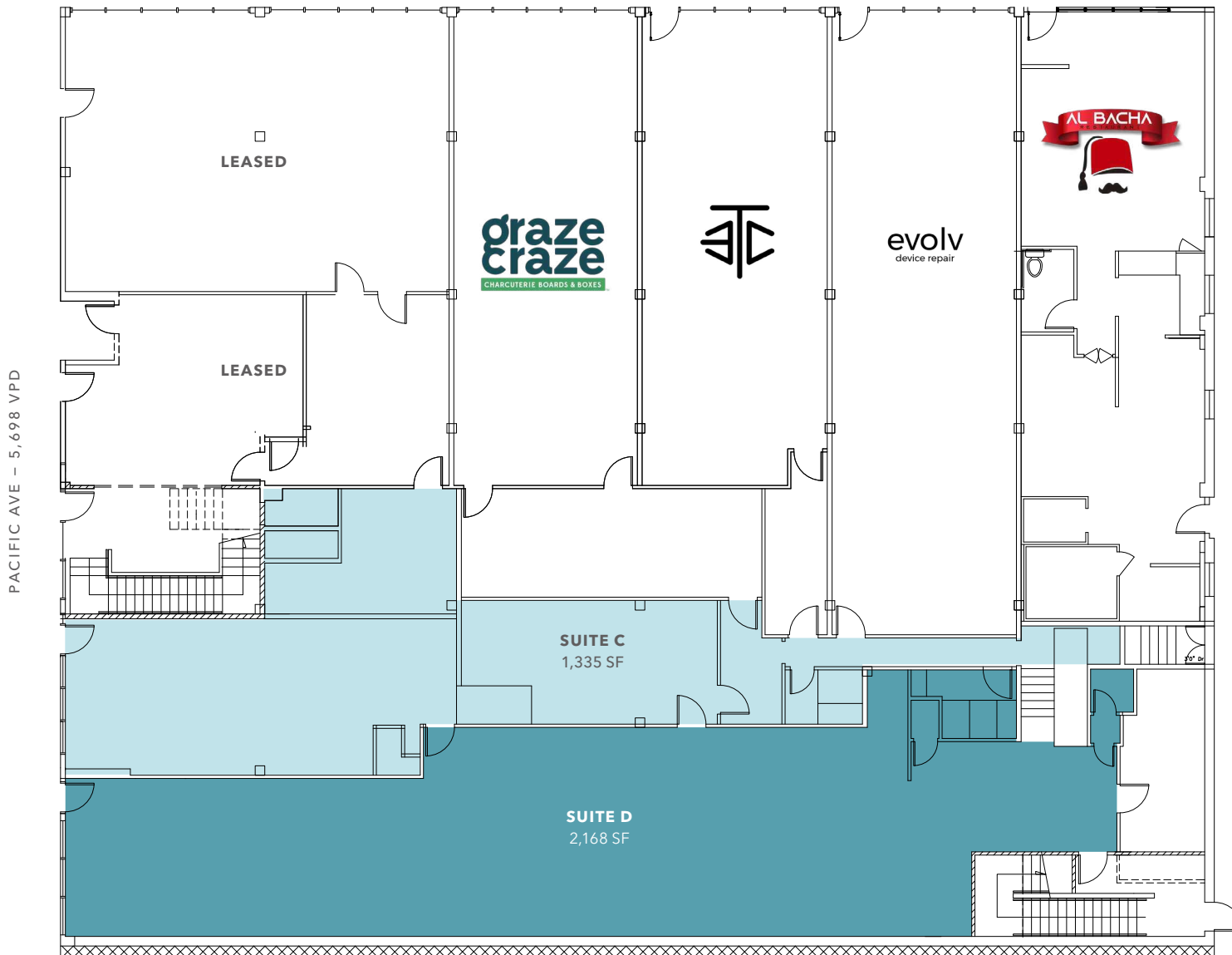

PACIFIC AVE - 5,698 VPD

1,335 SF

SUITE C

2,168 SF

SUITE D

\$17-20/SF

LEASE RATE, + NNN

NOW

AVAILABLE

HIGHLY- ACCESSIBLE LOCATION

3 minute drive to UW Tacoma

5 minute drive to St. Joseph Medical Center

1 block from Link Light Rail T-Line
Commerce St Station

Conveniently located near major
confluences Interstate 5, Highway 509,
and Highway 16

Easy for visitors to locate

4 MIN
HIGHWAY 16

3 MIN
INTERSTATE 5

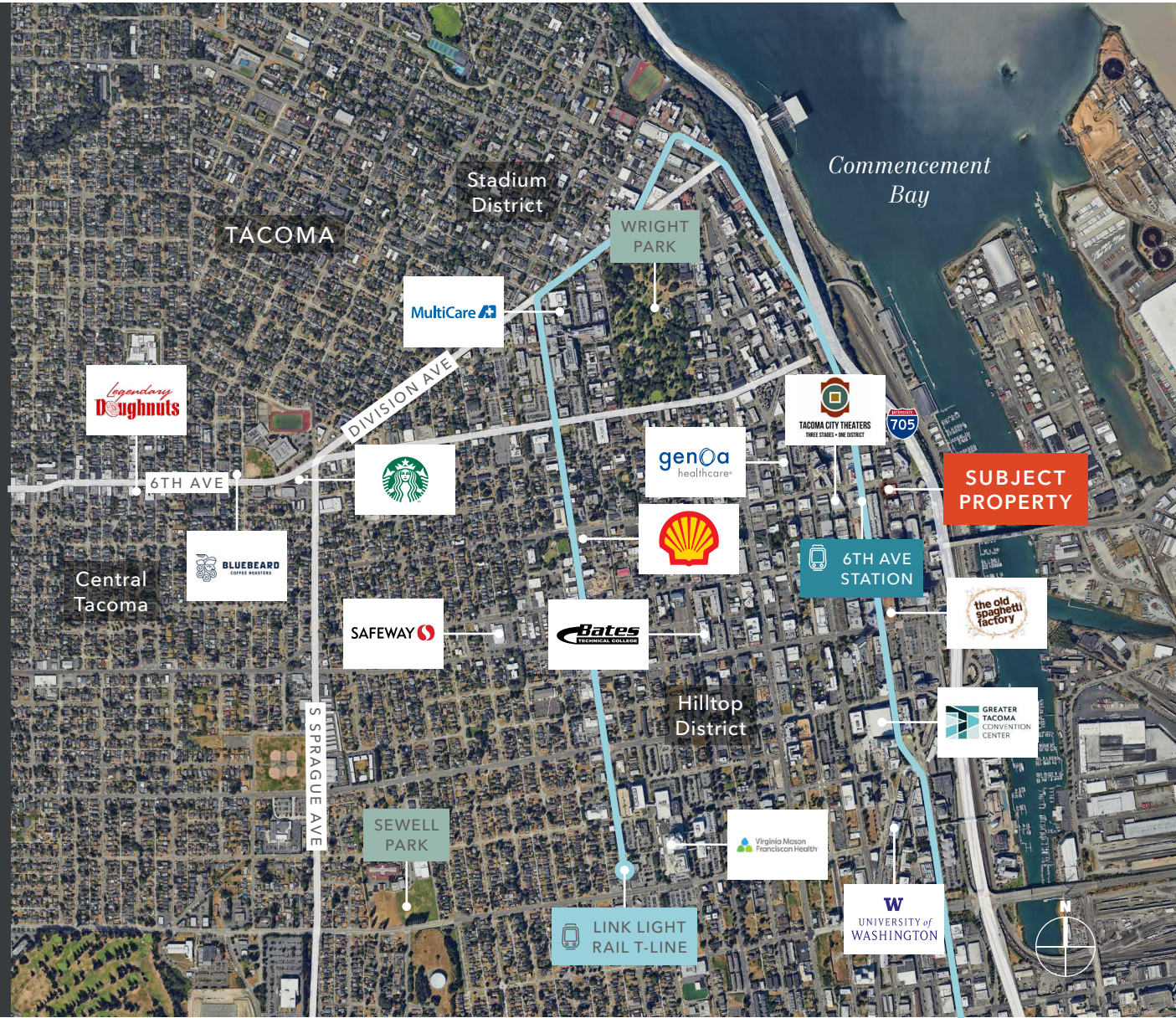





901 PACIFIC AVE

BLAKE WEBER
206.898.1231
blake.weber@kidder.com

NED WHALEN
206.491.5998
ned.whalen@kidder.com

DON WHITTLES
253.208.2257
don.whittles@kidder.com

TIM WEBER
206.650.0391
tim.weber@kidder.com

KIDDER.COM

This information supplied herein is from sources we deem reliable. It is provided without any representation, warranty, or guarantee, expressed or implied as to its accuracy. Prospective Buyer or Tenant should conduct an independent investigation and verification of all matters deemed to be material, including, but not limited to, statements of income and expenses. Consult your attorney, accountant, or other professional advisor. All Kidder Mathews designs are the sole property of Kidder Mathews. Branded materials and layouts are not authorized for use by any other firm or person.

