

INDUSTRIAL/OFFICE
LEASE

Highway 167 - 93,855 CPD



KENT BUSINESS CENTER

25316 - 25530 74th Avenue S | Kent, WA

Stossi Tsantilas

425.279.7943

stossit@rosenharbottle.com

Grant Rubenstein

425.289.2220

grant@rosenharbottle.com

425.454.3030
rosenharbottle.com

PO Box 5003
Bellevue, WA 98009 - 5003



HIGH-IMAGE OFFICE/ WAREHOUSE/FLEX SPACE

1,703 SF - 5,130 SF Available

LOCATION FEATURES:

- Landlord Flexible on Office/Warehouse Ratios
- Varying Suite Sizes - Ready to Lease
- Grade-Level Loading Doors
- Direct Entry to Suites
- 2.86/1,000 SF Parking Ratio
- Quick Access to State Route 167, SR 516 & Downtown
- Close-by Kent Station, Retail and Restaurant Amenities



The information provided herein has been obtained from sources believed to be reliable, but no representation or warranty, express or implied, is made with respect to the accuracy or completeness of any such information. Each prospective buyer or tenant should independently investigate, evaluate and verify all information provided herein and any other matters deemed material. Please consult your attorney, tax advisor or other professional advisor. The terms of sale or lease set forth herein are subject to change or withdrawal at any time and without notice.

BUILDING A FLOOR PLAN

Suite	Square Feet	Rate	Notes
25426	2,070 SF (1,198 SF ofc)	Call for Rates	Warehouse/Office with open office area and 1 private office. 2 restrooms and one grade-level roll up door. Available Now.
25502	5,130 SF	Call for Rates	Warehouse/Office space with climate controlled office and lab/warehouse area with one grade-level roll up door. Available Now.

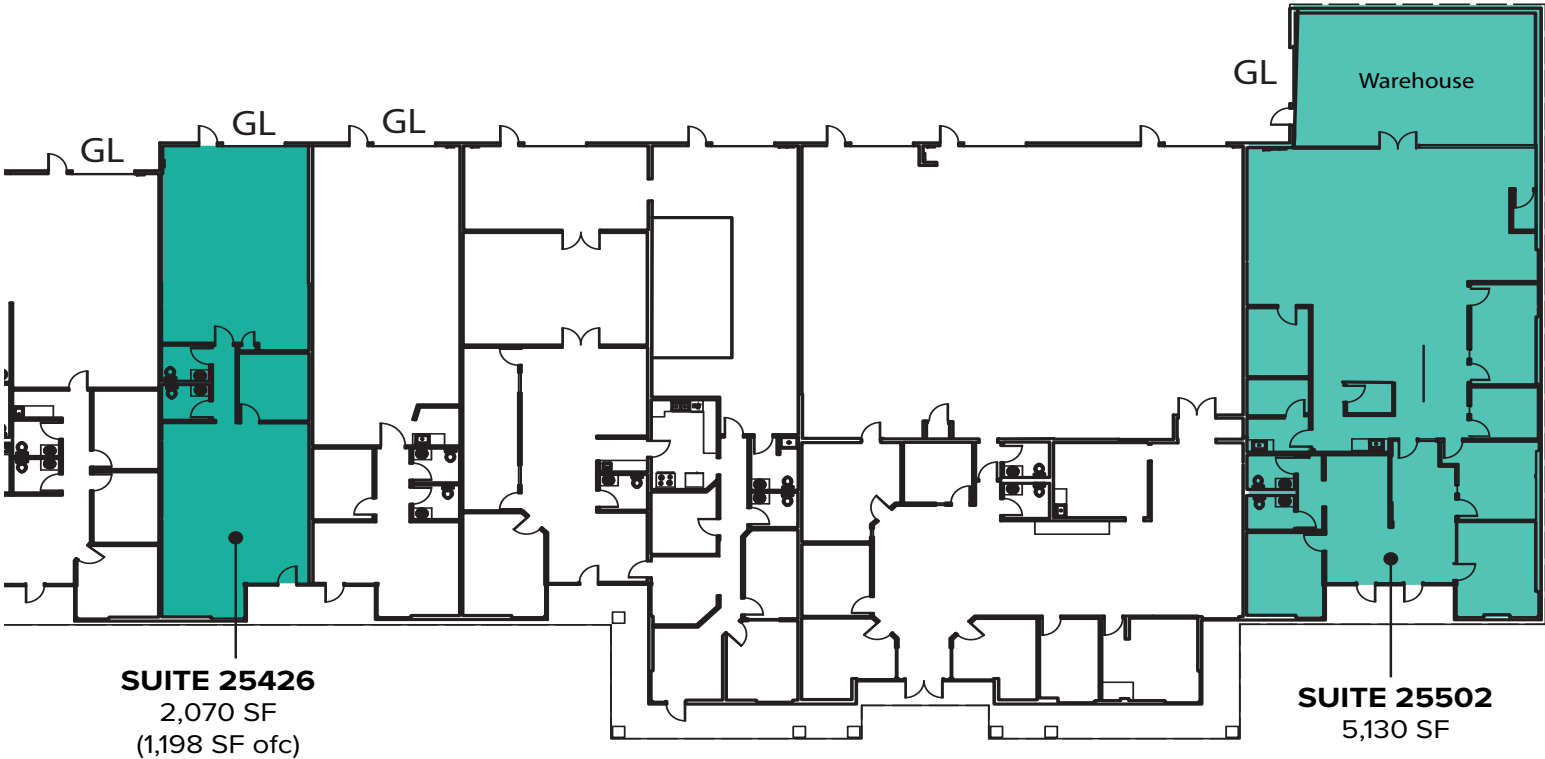

The information provided herein has been obtained from sources believed to be reliable, but no representation or warranty, express or implied, is made with respect to the accuracy or completeness of any such information. Each prospective buyer or tenant should independently investigate, evaluate and verify all information provided herein and any other matters deemed material. Please consult your attorney, tax advisor or other professional advisor. The terms of sale or lease set forth herein are subject to change or withdrawal at any time and without notice.

BUILDING A FLOOR PLAN CONTINUED

Suite	Square Feet	Rate	Notes
25404	1,187 SF	Call for Rates	Efficient office layout with 4 private offices, 2 restrooms, and a kitchenette. Can be contiguous with Suite 25402 for 3,465 SF total. Available 6/1/2026.
25402	2,278 (1,503 SF ofc)	Call for Rates	Office/warehouse space with 3 restrooms, a kitchenette and one grade-level door. Can be contiguous with Suite 25404 for 3,465 SF total. Available 6/1/2026.

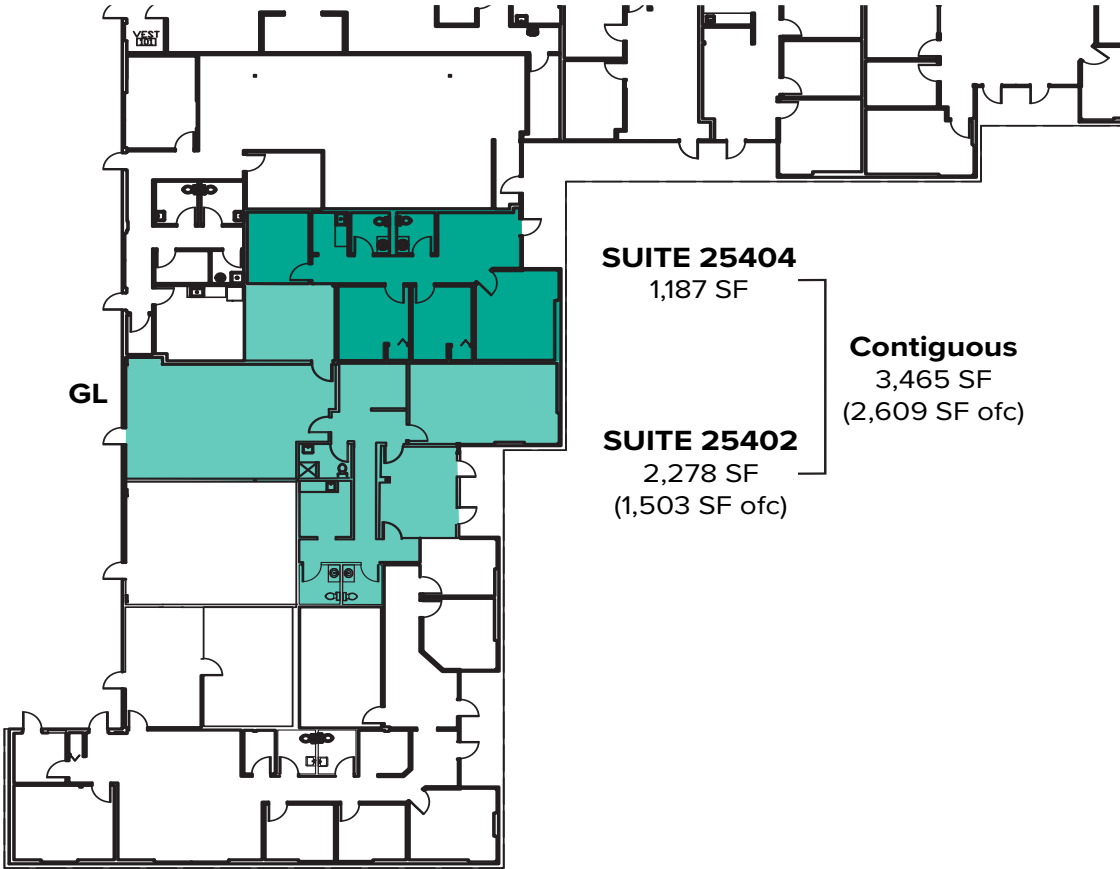

The information provided herein has been obtained from sources believed to be reliable, but no representation or warranty, express or implied, is made with respect to the accuracy or completeness of any such information. Each prospective buyer or tenant should independently investigate, evaluate and verify all information provided herein and any other matters deemed material. Please consult your attorney, tax advisor or other professional advisor. The terms of sale or lease set forth herein are subject to change or withdrawal at any time and without notice.

BUILDING B FLOOR PLAN

Suite	Square Feet	Rate	Notes
25518	1,703 SF (391 SF ofc)	\$1.55/SF, NNN	Warehouse/Office space with reception area, 1 private office, 1 restroom, open warehouse area, and 1 grade-level door. Available 4/1/2026.



SUITE 25518
 1,703 SF
 (391 SF ofc)

The information provided herein has been obtained from sources believed to be reliable, but no representation or warranty, express or implied, is made with respect to the accuracy or completeness of any such information. Each prospective buyer or tenant should independently investigate, evaluate and verify all information provided herein and any other matters deemed material. Please consult your attorney, tax advisor or other professional advisor. The terms of sale or lease set forth herein are subject to change or withdrawal at any time and without notice.

LOCATION MAP

