

FOR SUBLEASE

16th Avenue Industrial Bldg

18929 16th Ave S, SeaTac, WA

Prime warehouse location in SeaTac available for sublease through 2026.

PROPERTY HIGHLIGHTS

- + Size: 7,488 SF (1,500 SF office)
- + Loading – 1 GL door
- + 23' clear height
- + Sublease Through: 12/31/2026
- + Available Now
- + Rate: Call Brokers

CONNOR POWELL, SIOR, CCIM

Partner
+1 425 586 5642
cpowell@nai-psp.com



THE INFORMATION CONTAINED HEREIN HAS BEEN GIVEN TO US BY THE OWNER OF THE PROPERTY OR OTHER SOURCES WE DEEM RELIABLE, WE HAVE NO REASON TO DOUBT ITS ACCURACY, BUT WE DO NOT GUARANTEE IT. ALL INFORMATION SHOULD BE VERIFIED PRIOR TO PURCHASE OR LEASE.

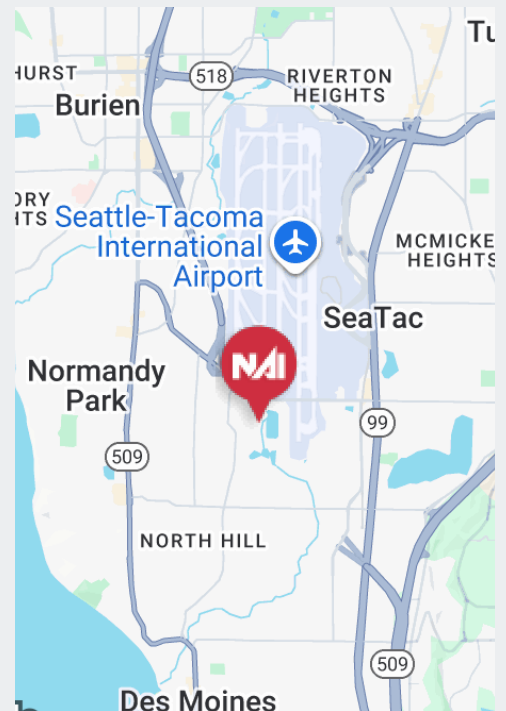

nai-psp.com

Floor Plan

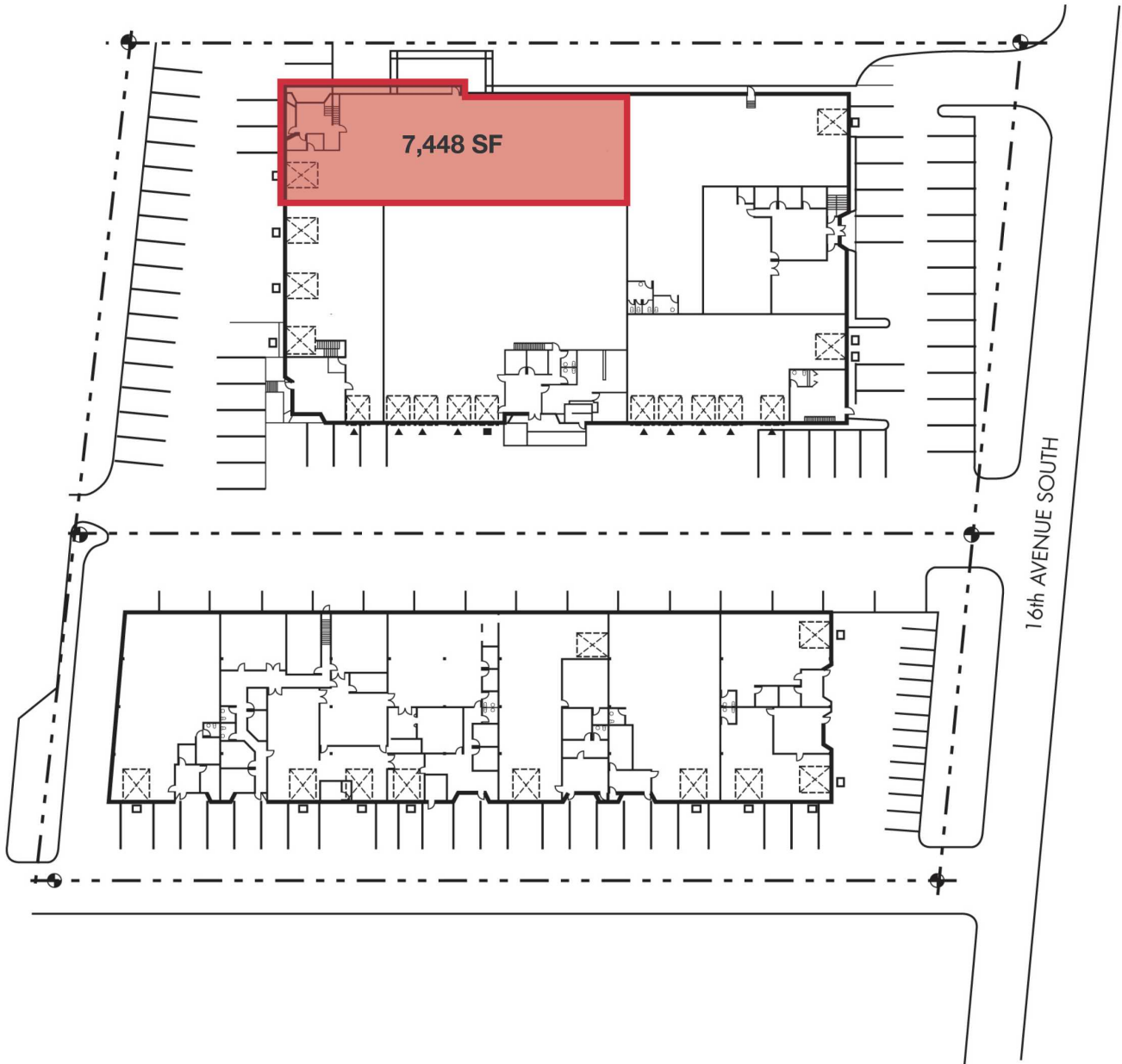

CONNOR POWELL, SIOR, CCIM

Partner
+1 425 586 5642
cpowell@nai-pp.com

