



FOR LEASE

1250 W Washington St
Sequim, WA 98382



RIVERBEND CENTER II

Jamie Firth | Justin Holmes

First Western Properties—Tacoma Inc. | 253.472.0404
6402 Tacoma Mall Blvd, Tacoma, WA 98409 | fwp-inc.com

1250 W WASHINGTON ST

CALL FOR RATE DETAILS

➤ 2,332 SF | END CAP (DRIVE-THRU)

➤ 1,902 SF | END CAP

- 2nd Generation Restaurant end-cap available with drive-thru.
- Neighboring tenants include Walmart, Costco, Home Depot, Petco, Sportsman Warehouse and many more national brands!
- Monument signage available along W Washington St - 6,850 CPD.
- Riverbend Center is just moments away from Highway-101.
- Exterior paint completed Fall 2025.

NEARBY RETAIL



Regis - 2025

Population

Average HH Income

Daytime Population

10 min DT

18,293

\$94,415

15,966

15 min DT

24,573

\$99,679

21,487

20 min DT

28,468

\$103,196

24,871



SITE PLAN

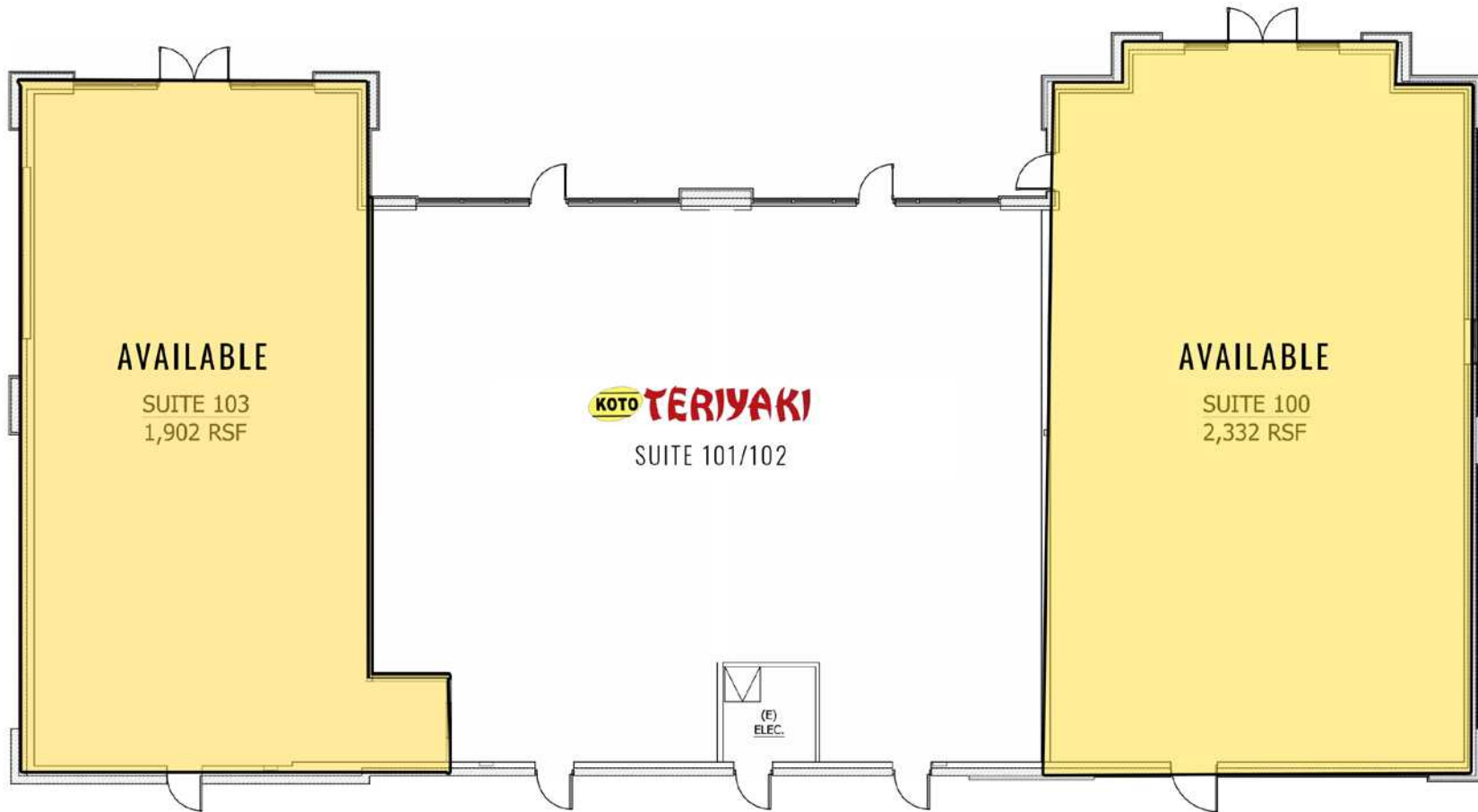

DRIVE-THRU

Suite	Tenant	SF	Rate
100	AVAILABLE	2,332	CALL FOR DETAILS
101/102	Koto's Teriyaki	2,760	LEASED
103	AVAILABLE	1,902	CALL FOR DETAILS

LOCATION AERIAL



Located on busy Washington Street



Close access to Highway 101



6,850 CPD
W Washington St



16,500 CPD
Highway 101

PHOTOS



TACOMA | KIRKLAND | PORTLAND | SEATTLE

RELATIONSHIP FOCUSED.
RESULTS DRIVEN.

1250, 1252, 1254, 1258
WEST WASHINGTON STREET

koto
TERIYAKI & SUSHI
AVAILABLE
AVAILABLE

koto
PHO

JAMIE FIRTH

📞 253.284.3649

✉️ jamie@firstwesternproperties.com

JUSTIN HOLMES

📞 253.447.2282

✉️ justin@firstwesternproperties.com



First Western Properties—Tacoma Inc. | 253.472.0404
6402 Tacoma Mall Blvd, Tacoma, WA 98409 | fwp-inc.com

© First Western Properties, Inc. DISCLAIMER: The above information has been secured from sources believed to be reliable, however, no representations are made to its accuracy. Prospective tenants or buyers should consult their professional advisors and conduct their own independent investigation. Properties are subject to change in price and/or availability without notice.