

WHSE/OFC  
LEASE



## WILLOWS PARK I & II, Building C

15205 - 15265 NE 95th Street | Redmond, WA 98052

Grant Rubenstein

425.289.2220

grant@rosenharbottle.com

425.454.3030  
rosenharbottle.com

PO Box 5003  
Bellevue, WA 98009 - 5003





# OFFICE/WAREHOUSE SPACE WITH RETAIL VISIBILITY

**Call for Rates**

**5,000 SF - 20,016 SF Available**

## **BUILDING DETAILS:**

- 18' Clear Height
- 2 Grade-Level Loading Doors
- 2 Dock-High Loading Doors
- Quality Concrete Tilt-Up Construction
- Building Signage Available
- Close-In Redmond Location

The information provided herein has been obtained from sources believed to be reliable, but no representation or warranty, express or implied, is made with respect to the accuracy or completeness of any such information. Each prospective buyer or tenant should independently investigate, evaluate and verify all information provided herein and any other matters deemed material. Please consult your attorney, tax advisor or other professional advisor. The terms of sale or lease set forth herein are subject to change or withdrawal at any time and without notice.

# SUITE 15225 FLOOR PLAN

## Features

- Available 1/1/2027
- 5,000 SF - 20,016 SF
- Call for Rates
- Warehouse/Office Space
- Located In Building C
- Power at 4,400 amps
- 36 tons of HVAC
- 6" Sewer Line
- 1 Dock-High Door
- 4 Grade-Level Doors
- 3 Restrooms

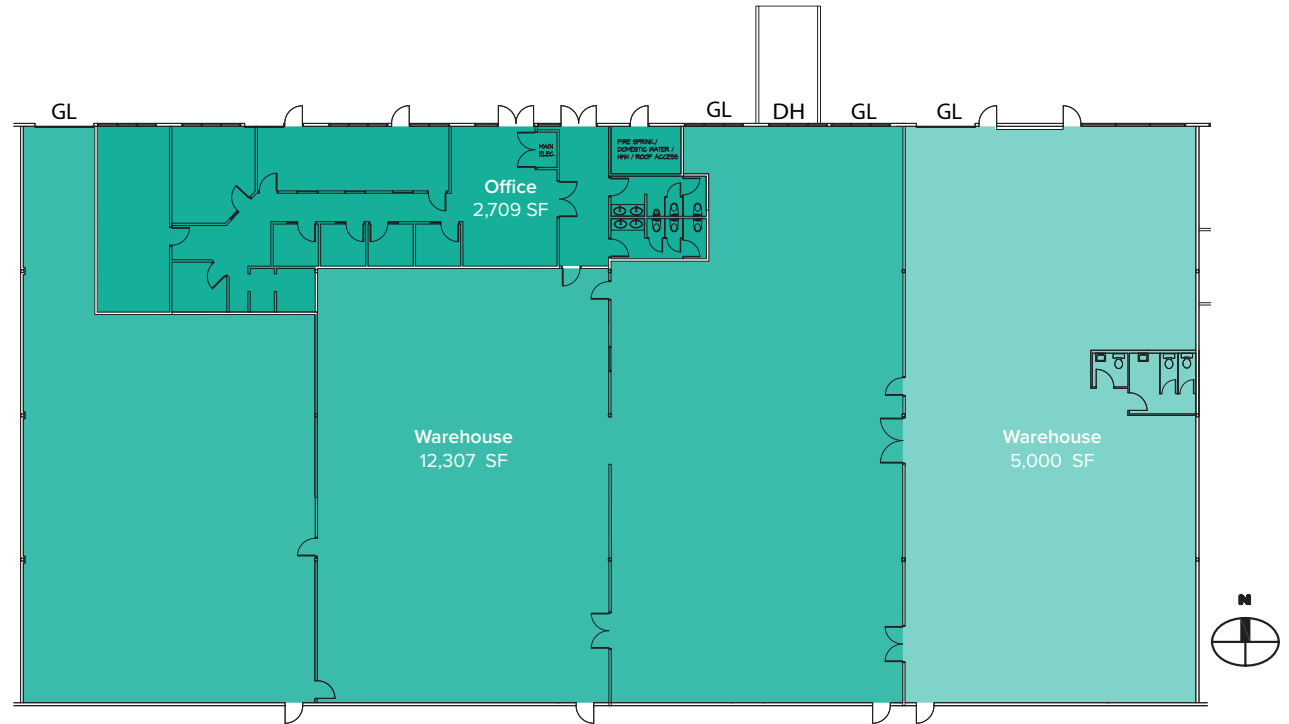

# SITE PLAN

NE 95th Street

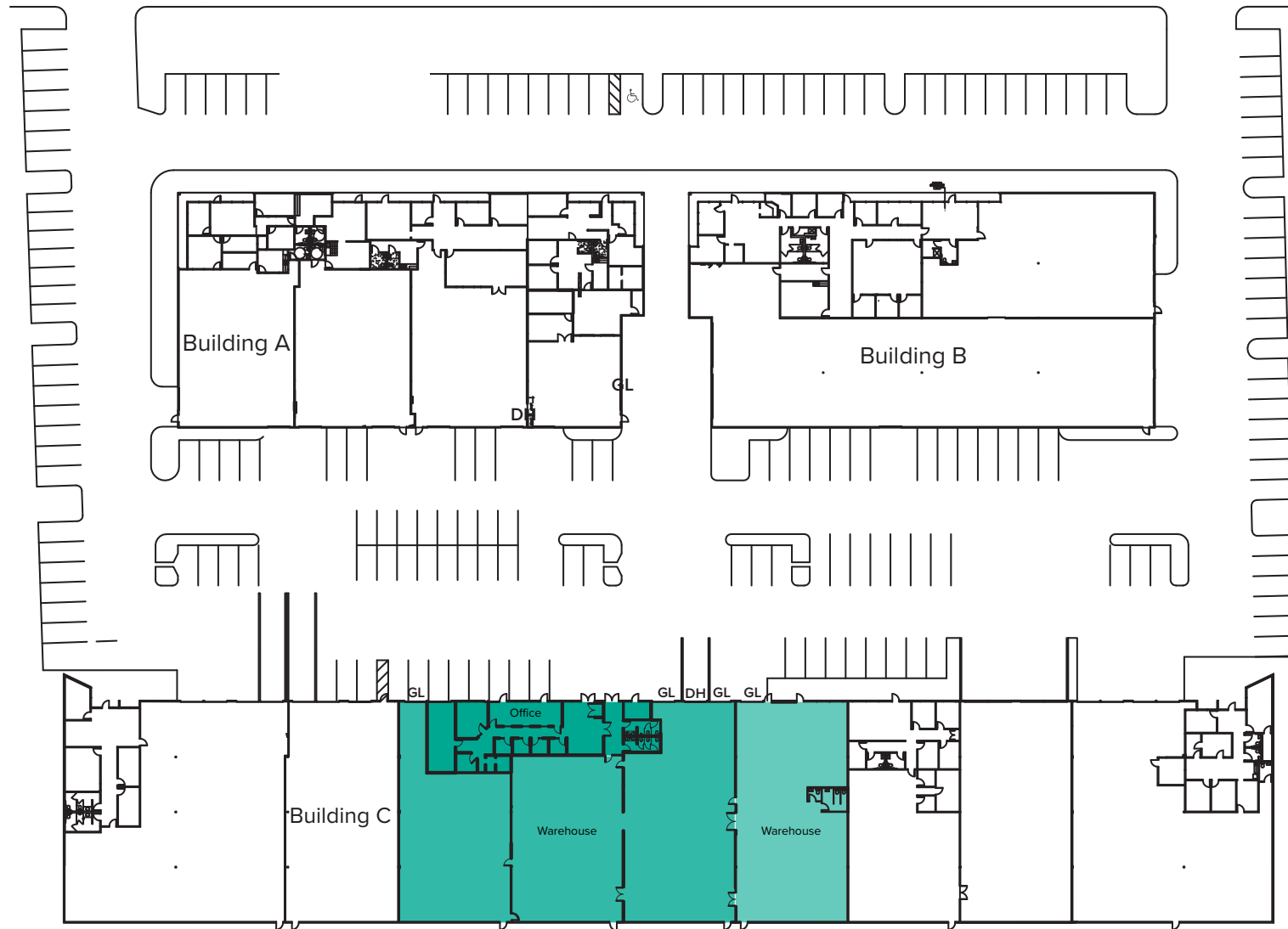

The information provided herein has been obtained from sources believed to be reliable, but no representation or warranty, express or implied, is made with respect to the accuracy or completeness of any such information. Each prospective buyer or tenant should independently investigate, evaluate and verify all information provided herein and any other matters deemed material. Please consult your attorney, tax advisor or other professional advisor. The terms of sale or lease set forth herein are subject to change or withdrawal at any time and without notice.

# LOCATION MAP

