

FOR LEASE

# WULFF INDUSTRIAL PARK

3104 C STREET NE, SUITE 205 | AUBURN, WA



±25,000 SF total

±2,948 SF office

6 DH doors

2 GL doors

Ample parking

Beautiful corporate image

\$1.00 PSF shell, plus NNN

\$1.35 PSF office add-on, plus NNN

±24' clear height

300 amps of 277/480 volt power, possible increase to 600 amps of 277/480 volt power

Available September 1, 2026

**DOUG KLEIN, SIOR**  
206.248.7348  
doug.klein@kidder.com

**TRAVIS STANAWAY**  
206.248.6526  
travis.stanaway@kidder.com

**KIDDER.COM**

This information supplied herein is from sources we deem reliable. It is provided without any representation, warranty, or guarantee, expressed or implied as to its accuracy. Prospective Buyer or Tenant should conduct an independent investigation and verification of all matters deemed to be material, including, but not limited to, statements of income and expenses. Consult your attorney, accountant, or other professional advisor.

**25,000**

SF TOTAL

**2,948**

SF OFFICE

**24'**

CLEAR HEIGHT

**km Kidder Mathews**

# WULFF INDUSTRIAL PARK

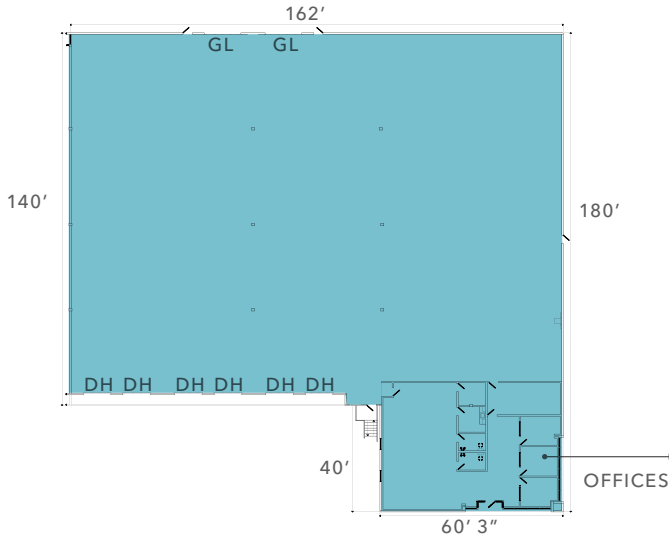

*25,000 SF*

TOTAL

*2,948 SF*

OFFICE

*24'*

CLEAR HEIGHT



[KIDDER.COM](http://KIDDER.COM)

This information supplied herein is from sources we deem reliable. It is provided without any representation, warranty, or guarantee, expressed or implied as to its accuracy. Prospective Buyer or Tenant should conduct an independent investigation and verification of all matters deemed to be material, including, but not limited to, statements of income and expenses. Consult your attorney, accountant, or other professional advisor.

