

FOR LEASE

3126 NW Randall Way
Silverdale, WA 98383



FREESTANDING RETAIL BUILDING

Justin Holmes | Lucy Malone | Josh Parnell | Justice Knox

First Western Properties—Tacoma Inc. | 253.472.0404
6402 Tacoma Mall Blvd, Tacoma, WA 98409 | fwp-inc.com

3126 NW RANDALL WAY is a freestanding retail building ideally positioned along NW Randall Way in Silverdale's primary retail corridor, offering strong visibility, easy access, and proximity to high-performing national co-tenants. The property sits on a well-situated commercial parcel that supports a wide range of retail uses and benefits from a robust regional customer base, providing tenants with a deep and growing consumer market in the heart of Kitsap County's dominant shopping district.

AVAILABLE

11,493 SF \$18.00 PSF + NNN PSF

- 125' of frontage along Randall Way (excellent visibility)
- Prominent free-standing monument sign on Randall Way
- Efficient site layout with surface parking (26 stalls)
- 56 parking stalls and loading dock located onsite.
- Highly accessible location with strong consumer draw and steady traffic.



Population



Average HH Income



Daytime Population

Regis - 2026

	Population	Average HH Income	Daytime Population
Mile 1	5,386	\$130,161	9,487
Mile 3	39,231	\$140,742	23,574
Mile 5	73,835	\$139,821	39,815

NEARBY RETAIL

KITSAP MALL

KOHL'S
expect great things[®]

JCPenney

COST PLUS
WORLD MARKET



TARGET

WinCo
FOODS

DICK'S
SPORTING GOODS

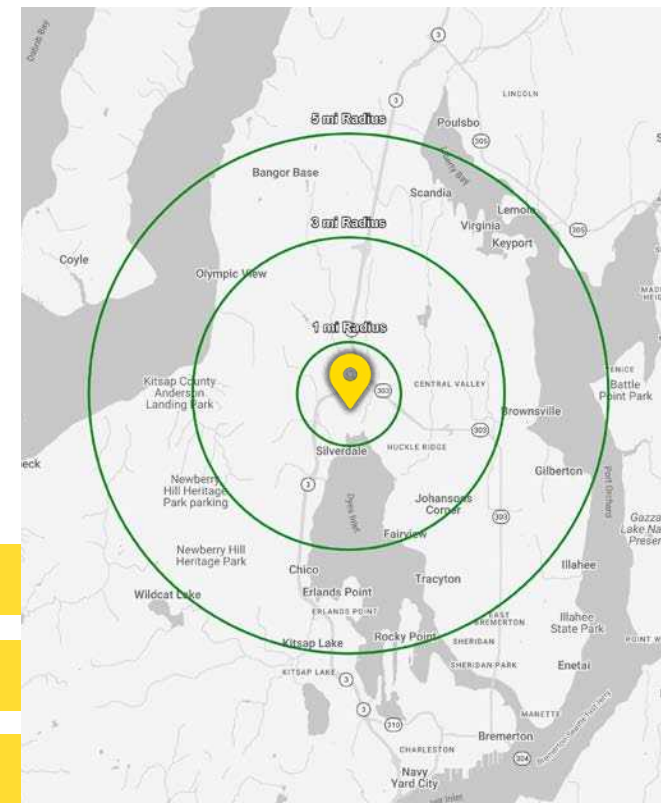

SITE PHOTOS



LOCATION AERIAL

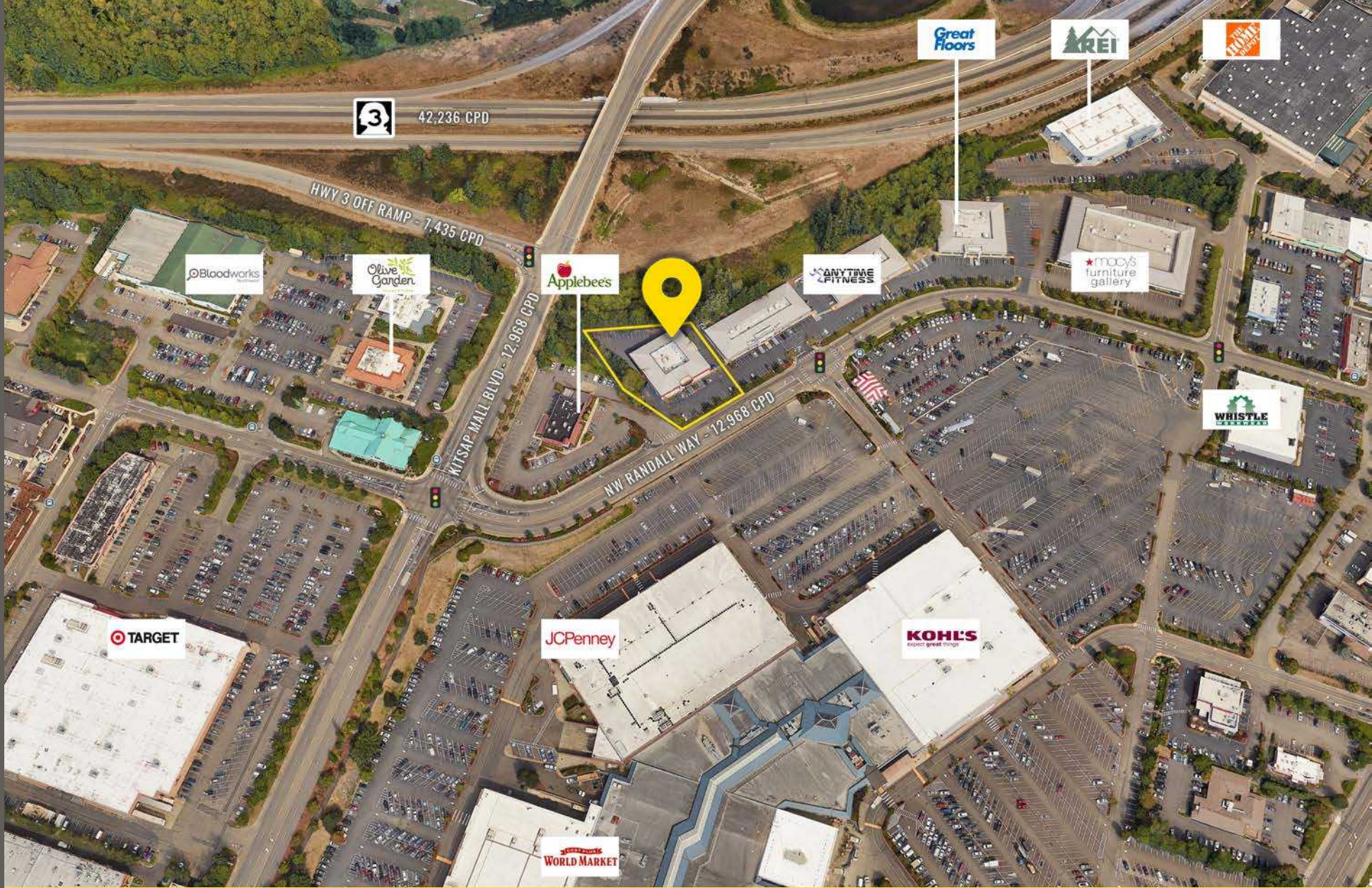

Located in the retail core
of Kitsap County



Located moments
from HWY 3



22,985 CPD
Kitsap Mall Blvd NW



12,968 CPD
NW Randall Way

LOCATION AERIAL



THE TRAILS
at Silverdale



CENTRAL KITSAP
HIGH SCHOOL
1,600 STUDENTS

CENTRAL KITSAP
MIDDLE SCHOOL
600 STUDENTS



DYES INLET

SITE PLAN

SITE: 0.89 ACRE
SEC-TWP-RNG: 16 25N 1E
NEIGHBORHOOD: 8401101
ZONING: RC

ADJ. PROPERTY

(E) DRIVEWAY

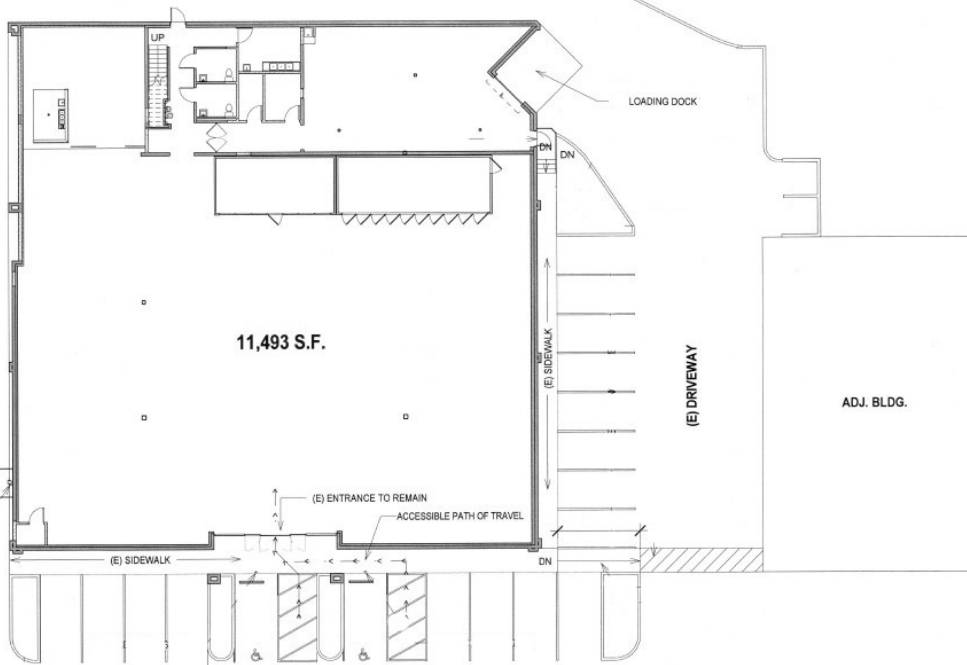

11,493 S.F.

LOADING DOCK

ADJ. BLDG.

(E) DRIVEWAY

NW Randall Way



TACOMA | KIRKLAND | PORTLAND | SEATTLE

RELATIONSHIP FOCUSED.
RESULTS DRIVEN.



JUSTIN HOLMES

 253.447.2282

 justin@firstwesternproperties.com

LUCY MALONE

 253.284.3634

 lucy@firstwesternproperties.com

JOSH PARNELL

 253.284.3630

 josh@firstwesternproperties.com

JUSTICE KNOX

 253.471.5501

 jknox@firstwesternproperties.com



First Western Properties - Tacoma, Inc. | 253.472.0404
5402 Tacoma Mall Blvd, Tacoma, WA 98409 | fwp-inc.com

© First Western Properties, Inc. DISCLAIMER: The above information has been secured from sources believed to be reliable, however, no representations are made to its accuracy. Prospective tenants or buyers should consult their professional advisors and conduct their own independent investigation. Properties are subject to change in price and/or availability without notice.