



# Prologis Park Trans-Pacific

## 30,000 SF Space for Sublease



## Property Information

### Details

- + 30,000 SF shell
- + 1,314 SF office
- + 7 dock-high doors (4 with levelers)
- + 1 oversized grade-level door (12' x 14')
- + 2 rail doors (Union Pacific)
- + 24' warehouse clear height
- + Racking available
- + Sublease term through January 31, 2029
- + HEAVY POWER: approximately 1,200 amps of 480/277 volt 3-phase (to be confirmed by electrician)
- + Immediate access to I-5 and Port of Tacoma
- + Available with 30-day notice
- + Call broker for rates



# Site Plan & Photos

4200B INDUSTRY DRIVE EAST  
FIFE, WA 98424

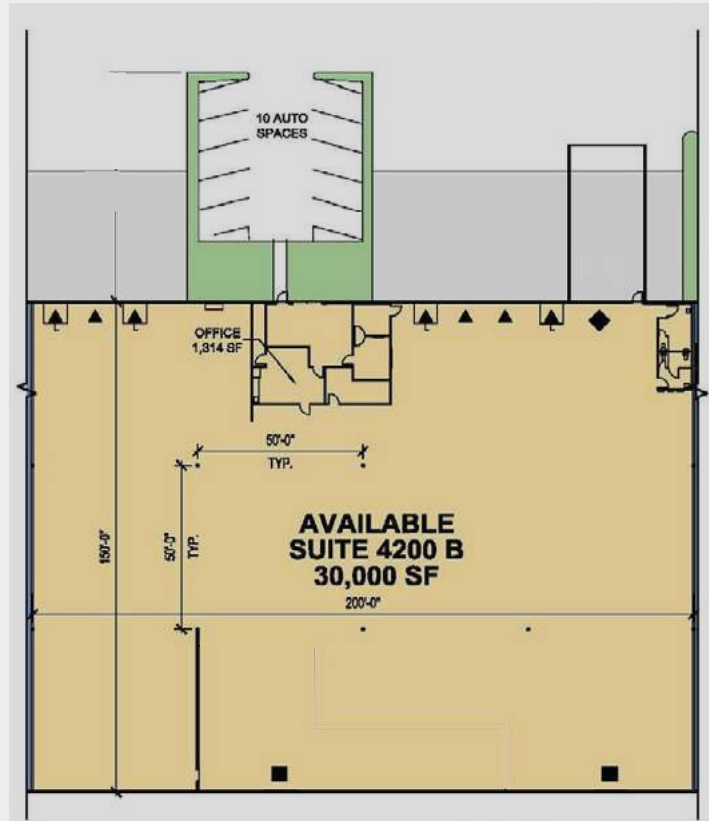

## Chris Cowles

First Vice President

+1253 596 0048

chris.cowles@cbre.com

## CBRE, Inc.

710 Market Street

Tacoma, WA 98402

© 2026 CBRE, Inc. All rights reserved. This information has been obtained from sources believed reliable but has not been verified for accuracy or completeness. CBRE, Inc. makes no guarantee, representation or warranty and accepts no responsibility or liability as to the accuracy, completeness, or reliability of the information contained herein. You should conduct a careful, independent investigation of the property and verify all information. Any reliance on this information is solely at your own risk. CBRE and the CBRE logo are service marks of CBRE, Inc. All other marks displayed on this document are the property of their respective owners, and the use of such marks does not imply any affiliation with or endorsement of CBRE. Photos herein are the property of their respective owners. Use of these images without the express written consent of the owner is prohibited. BSO 03.09.2026