

±101,559 SF (Now Divisible to ±30,000 SF)

Office/Warehouse Space For Lease



Seaway Business Center, Building E



1200 Industry St.
Everett, WA 98203

LOCATION

- Minutes from I-5, and Paine Field Airport

FACILITY

- ±101,559 SF Total
- ±4,588 SF 1st Floor Office Space
- Up to ±4,166 SF Mezzanine Office
- Entire Stand-Alone Building
- 24' Clear Height
- 25 Dock High Doors
- 4 Drive-in Doors
- ±3,000 Amps of Power
- Available Now

ADVANTAGES AND AMENITIES

- Access to the Prologis Essentials platform, which includes:
[Operations Essentials](#)
[Energy Essentials](#)
[Workforce Essentials](#)
[Mobility Essentials](#)
[Digital Essentials](#).

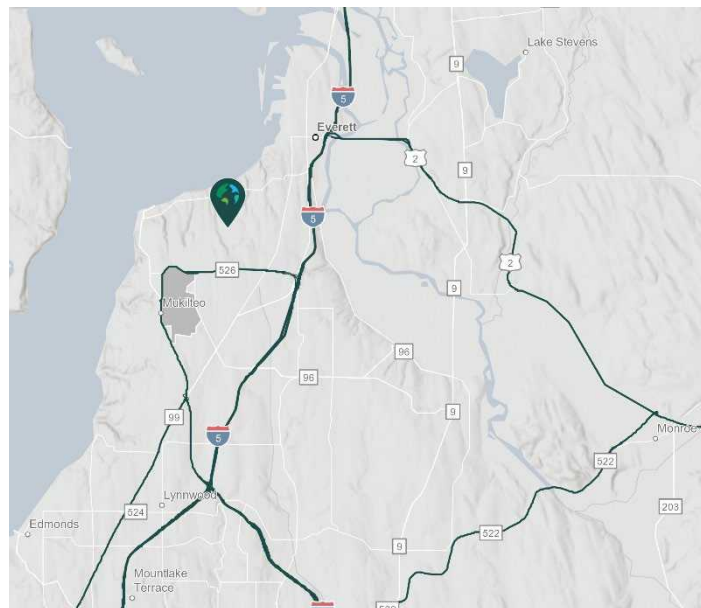

Your single-source service for efficient move-in and operations: [prologisessentials.com](https://www.prologisessentials.com)

±101,559 SF (Now Divisible to ±30,000 SF)

Office/Warehouse Space For Lease



Seaway Business Center, Building E

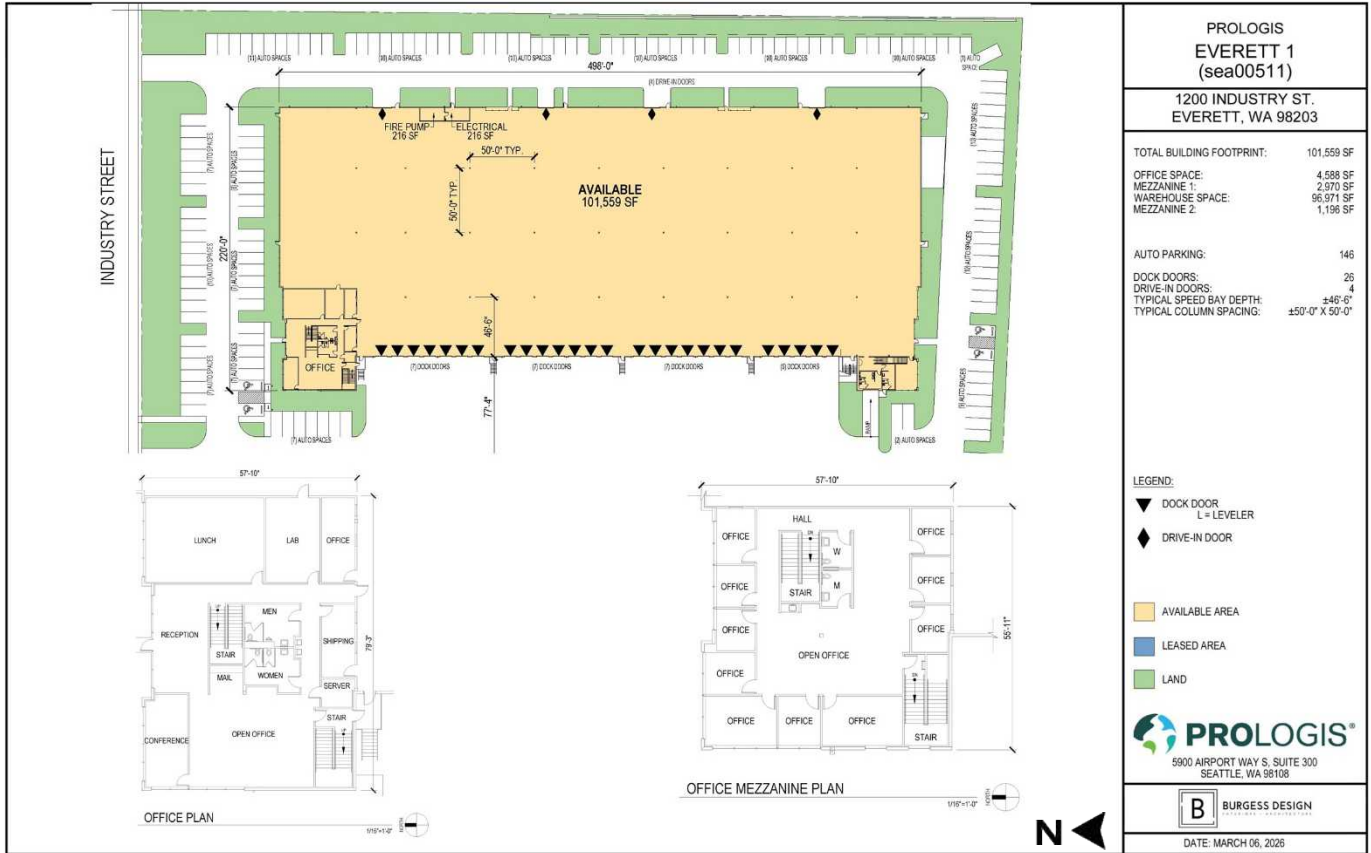

[Click Here to View Site & Space Plan](#)



CBRE

Ric Brandt
ric.brandt@cbre.com
ph +1 425 462 6901
cell +1 206 650 0442
929 108th Avenue NE
Suite 700
Bellevue, WA 98004, USA

CBRE

John Bauer
john.bauer@cbre.com
ph +1 425 462 6906
cell +1 206 660 9701
929 108th Avenue NE
Suite 700
Bellevue, WA 98004, USA

CBRE

Erik Larson
erik.larson@cbre.com
ph +1 425 462 6954
cell +1 360 239 7808
929 108th Avenue NE
Suite 700
Bellevue, WA 98004, USA

Prologis

Lucca Merlino
lmerlino@prologis.com
ph +1 206 414 7621
cell +1 206 498 6511
33930 Weyerhaeuser Way S
Suite 100
Federal Way, WA 98001 USA