

FOR LEASE

# I-90 PRESTON INDUSTRIAL PARK

*4,309 SF - 29,446 SF Industrial  
Spaces Available in Preston*

8114 - 8180 304TH AVE SE, PRESTON, WA

BLDG 2

BLDG 1

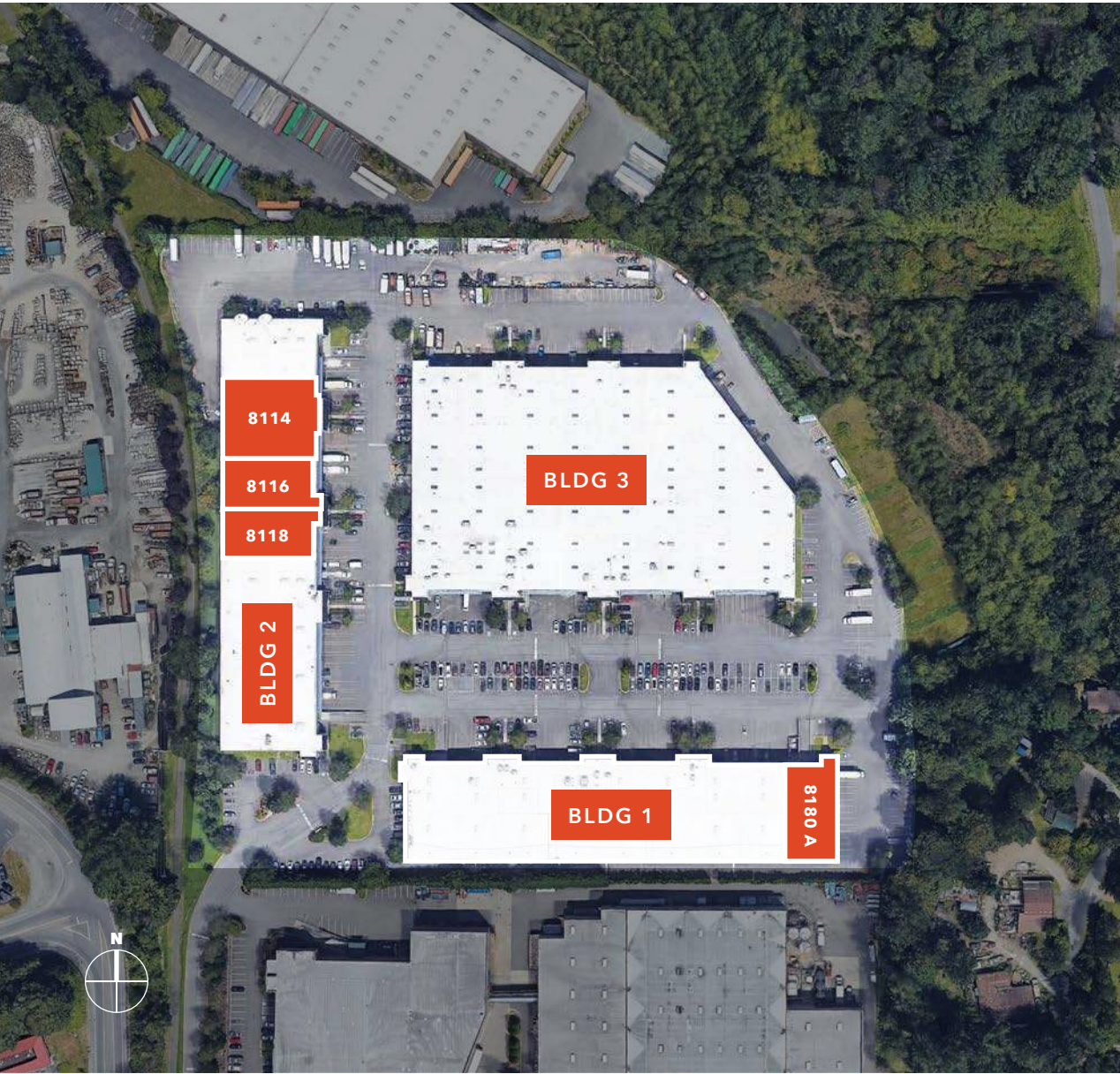

### SUITE AVAILABILITIES

Building 1	Total Area	Office	Warehouse
8180 A	5,722 SF	674 SF	5,048 SF
Building 2	Total Area	Office	Warehouse
8114	17,779 SF	2,940 SF	14,839 SF
8116	4,309 SF	857 SF	3,443 SF
8118	7,358 SF*	1,258 SF	6,100 SF
*1,043 SF of mezzanine not included in total SF			
8116 & 8118 Combined	11,667 SF	2,115 SF	9,543 SF
8114, 8116, 8118 Combined	29,446 SF	5,055 SF	24,382 SF

### PROPERTY DETAILS

Three buildings totaling ±298,000 SF

ESFR (Early Suppression Fast Response) sprinkler systems allows tenants to rack higher vertically, requiring less SF, reducing cost - no in-rack sprinklers required

Great freeway access to I-90, SR-18, SR-202, SR-203

Heavy power available

# FLOOR PLAN

## Building 1- Suite 8180 A

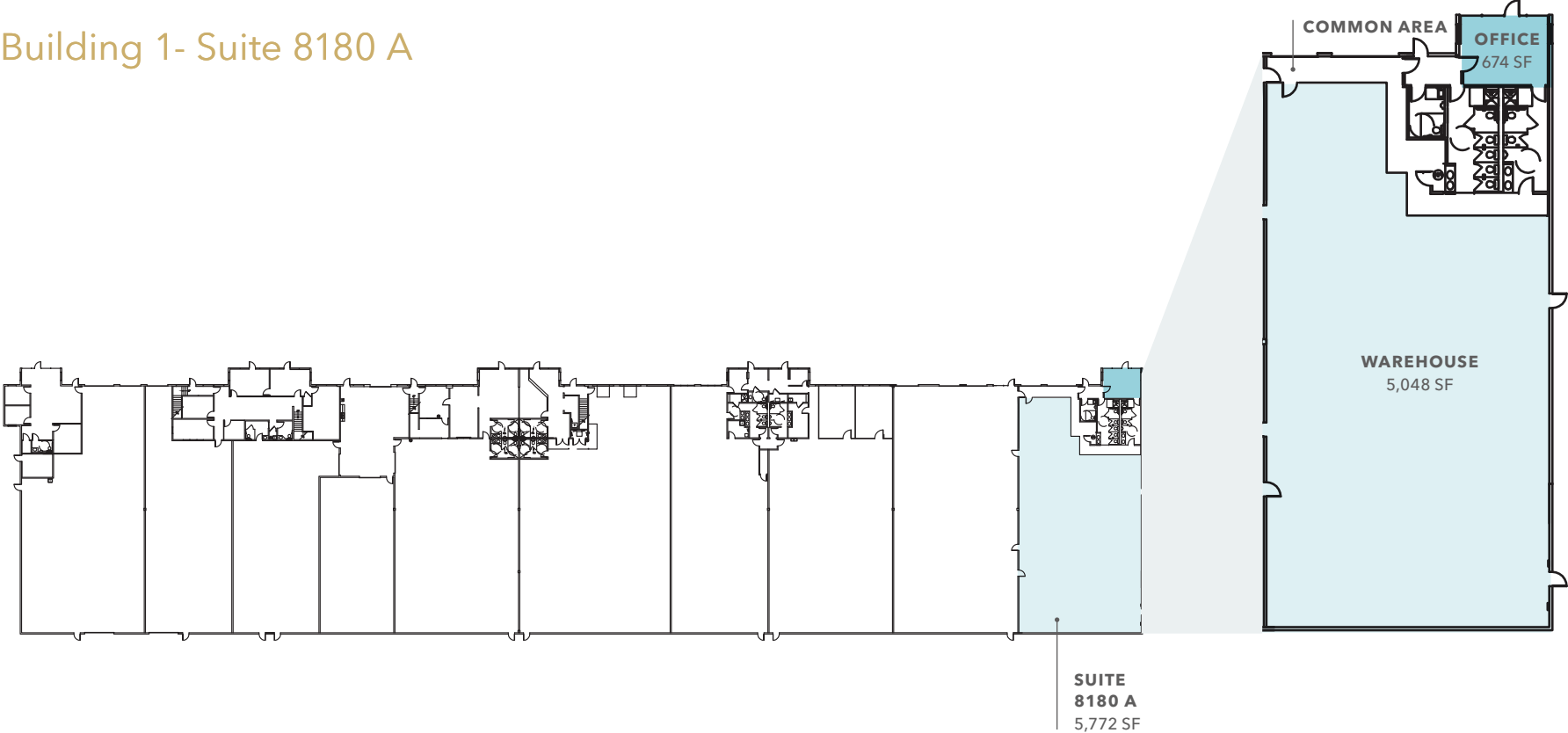

### LEGEND

- Office
- Warehouse

# FLOOR PLAN

## Building 2 - Suite 8114, Suite 8116, Suite 8118

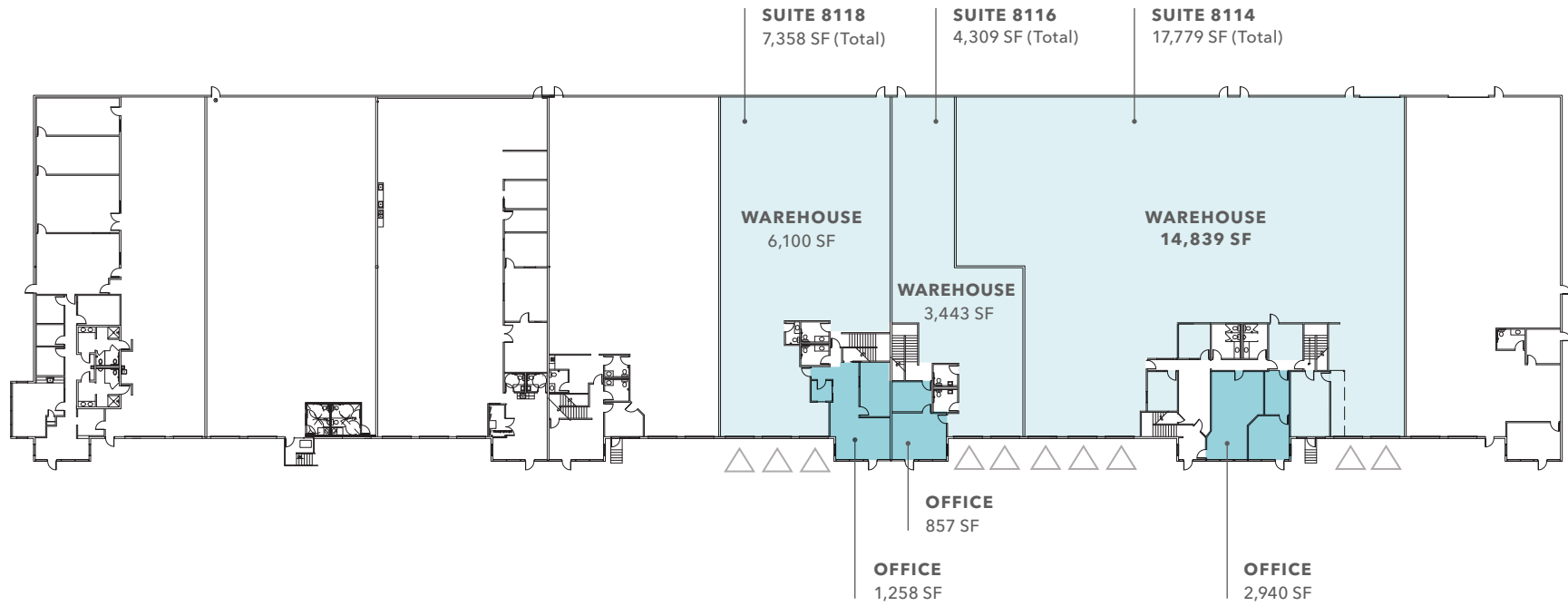

### LEGEND

■ Office

■ Warehouse

△ Dock-High Loading

\*Availability to add grade level loading



# FLOOR PLAN

## Building 2 - Suite 8116 & Suite 8118 Combined

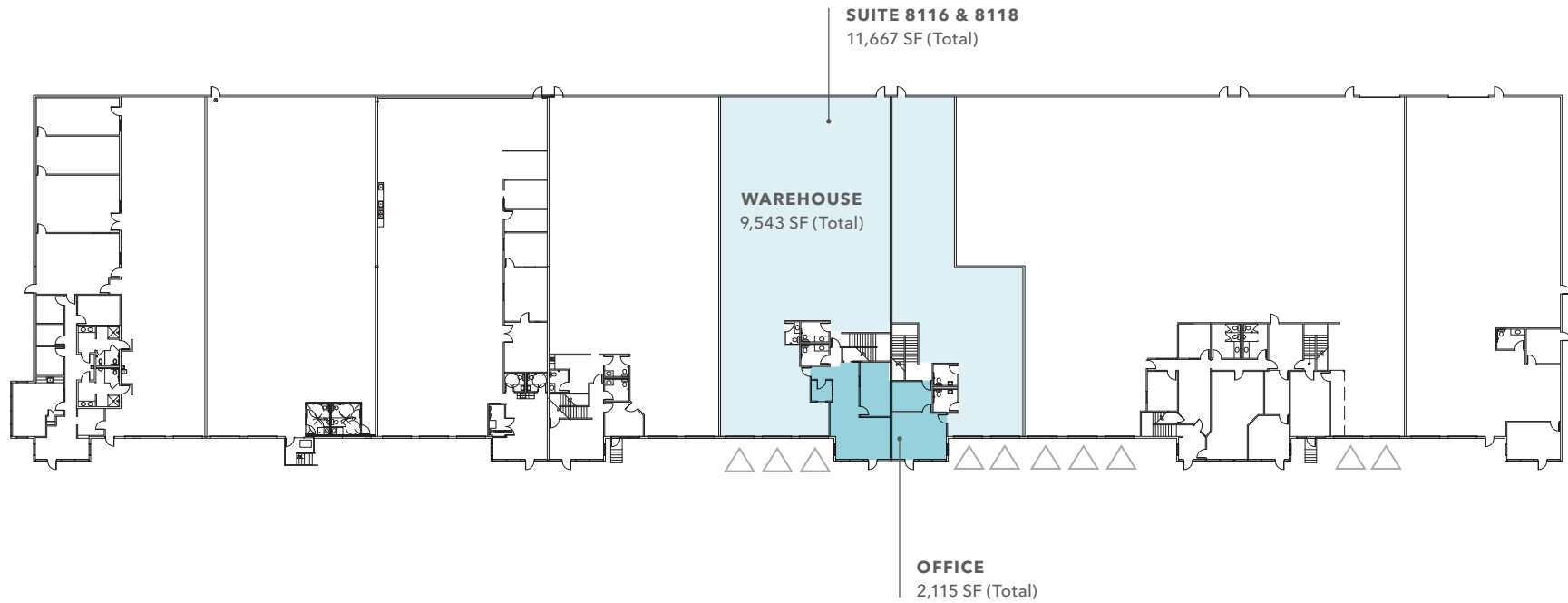

### LEGEND

■ Office

■ Warehouse

△ Dock-High Loading

\*Availability to add grade level loading



# FLOOR PLAN

## Building 2 - Suite 8118, Suite 8116, & Suite 8114 Combined

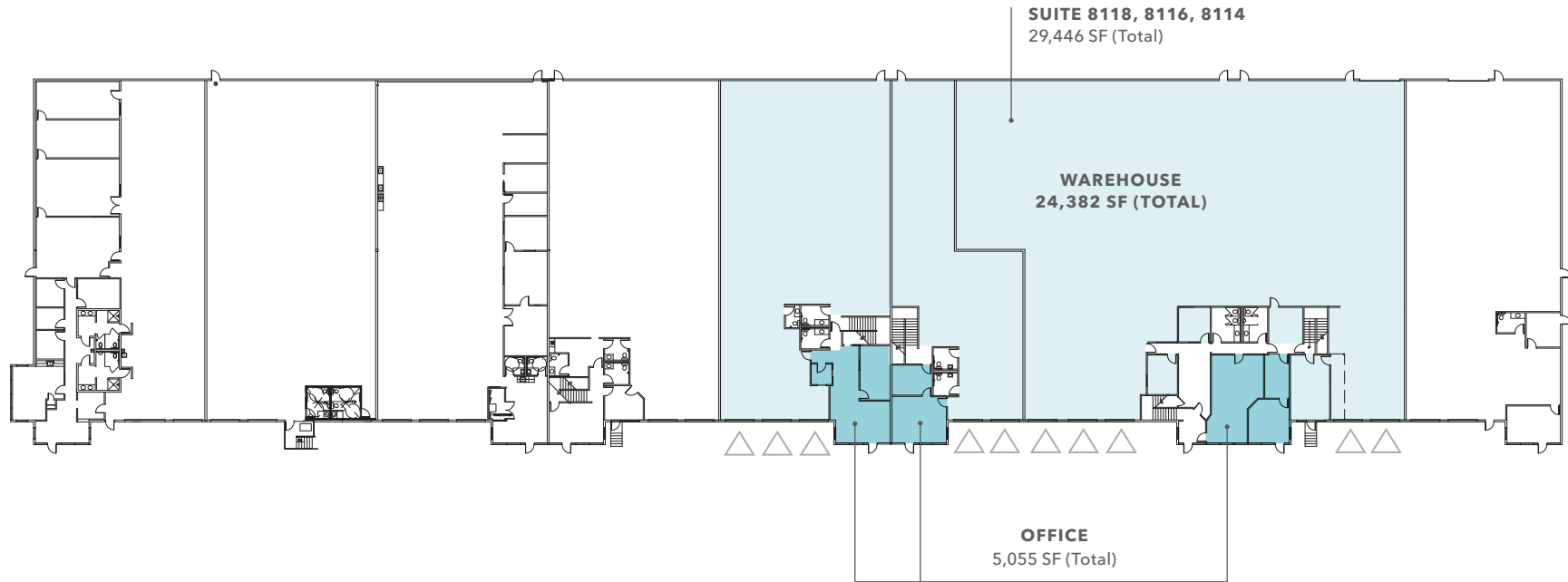

### LEGEND

■ Office

■ Warehouse

△ Dock-High Loading

\*Availability to add grade level loading



I-90 PRESTON INDUSTRIAL PARK

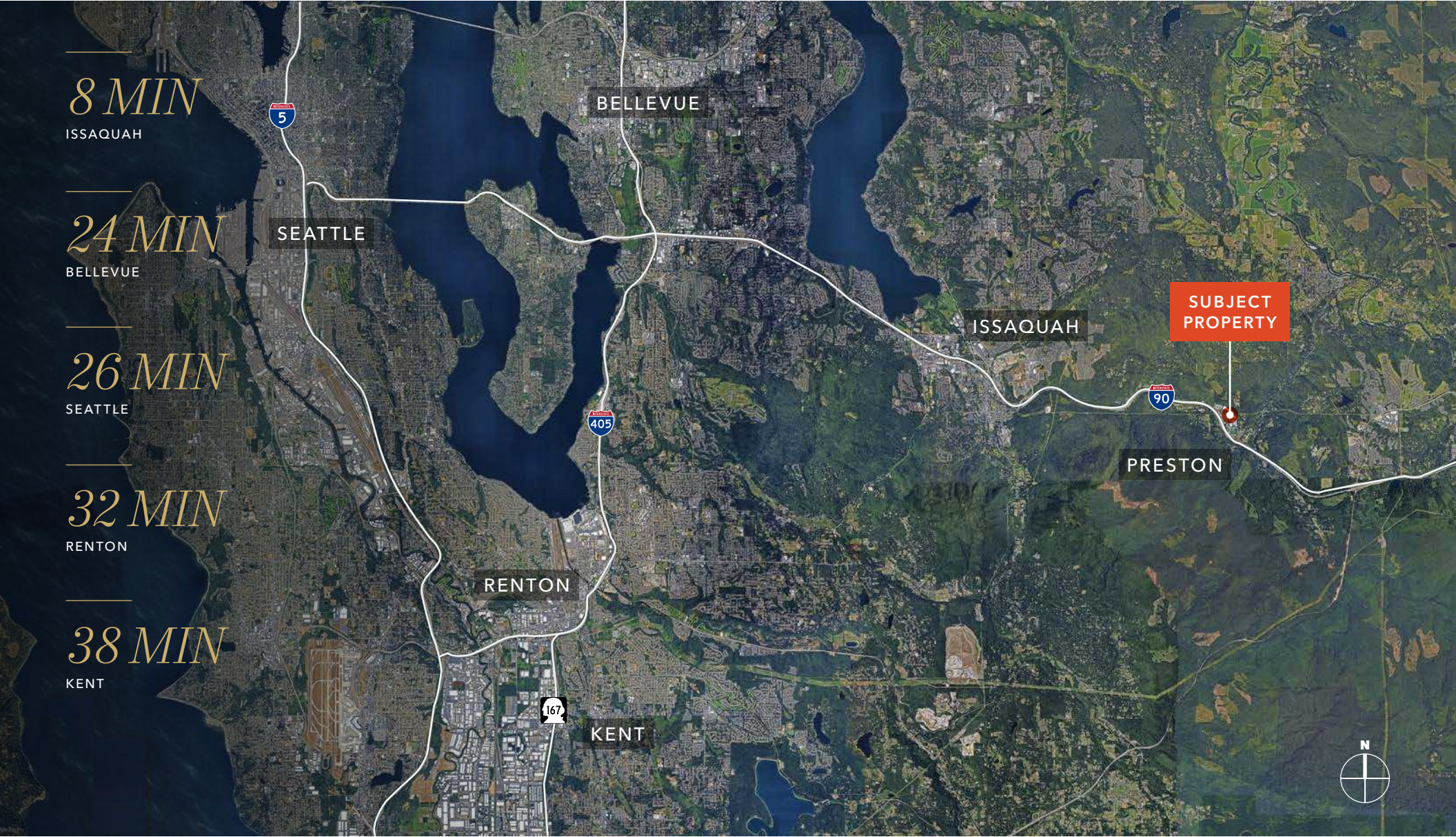

*8 MIN*

ISSAQUAH

*24 MIN*

BELLEVUE

*26 MIN*

SEATTLE

*32 MIN*

RENTON

*38 MIN*

KENT

**SUBJECT  
PROPERTY**





*Exclusively listed by*

**TODD GAUTHIER**  
Executive Vice President  
425.450.1118  
todd.gauthier@kidder.com

**JASON BLOOM**  
Executive Vice President  
425.450.1102  
jason.bloom@kidder.com

**KIDDER.COM**

This information supplied herein is from sources we deem reliable. It is provided without any representation, warranty, or guarantee, expressed or implied as to its accuracy. Prospective Buyer or Tenant should conduct an independent investigation and verification of all matters deemed to be material, including, but not limited to, statements of income and expenses. Consult your attorney, accountant, or other professional advisor. All Kidder Mathews designs are the sole property of Kidder Mathews. Branded materials and layouts are not authorized for use by any other firm or person.