

For Lease

Industrial

Available Now



8605 34th Ave South

Lakewood, WA 98499

- 50,218 SF Warehouse
- Great I-5 access; three I-5 interchanges within 2 miles
- Concrete - tilt-wall
- 32' clear height
- ESFR sprinklers
- 9 DH, 1 Drive-In
- 1,564 SF office
- On-site trailer stalls, up to 10 available
- Truck scale on-site
- Air Corridor 2 zoning, City of Lakewood

For more information:

Dave Douglas, SIOR, CCIM

+1 253 203 1326 • ddouglas@nai-psp.com

Kyle Schipper, SIOR

+1 253 203 1320 • kschipper@nai-psp.com



BELLEVUE | SEATTLE | TACOMA

914 A Street, Suite 200
Tacoma, WA 98402
+1 253 383 3100
nai-psp.com

THE INFORMATION CONTAINED HEREIN HAS BEEN GIVEN TO US BY THE OWNER OF THE PROPERTY OR OTHER SOURCES WE DEEM RELIABLE, WE HAVE NO REASON TO DOUBT ITS ACCURACY, BUT WE DO NOT GUARANTEE IT. ALL INFORMATION SHOULD BE VERIFIED PRIOR TO PURCHASE OR LEASE.

Industrial for Lease

8605 34th Ave South

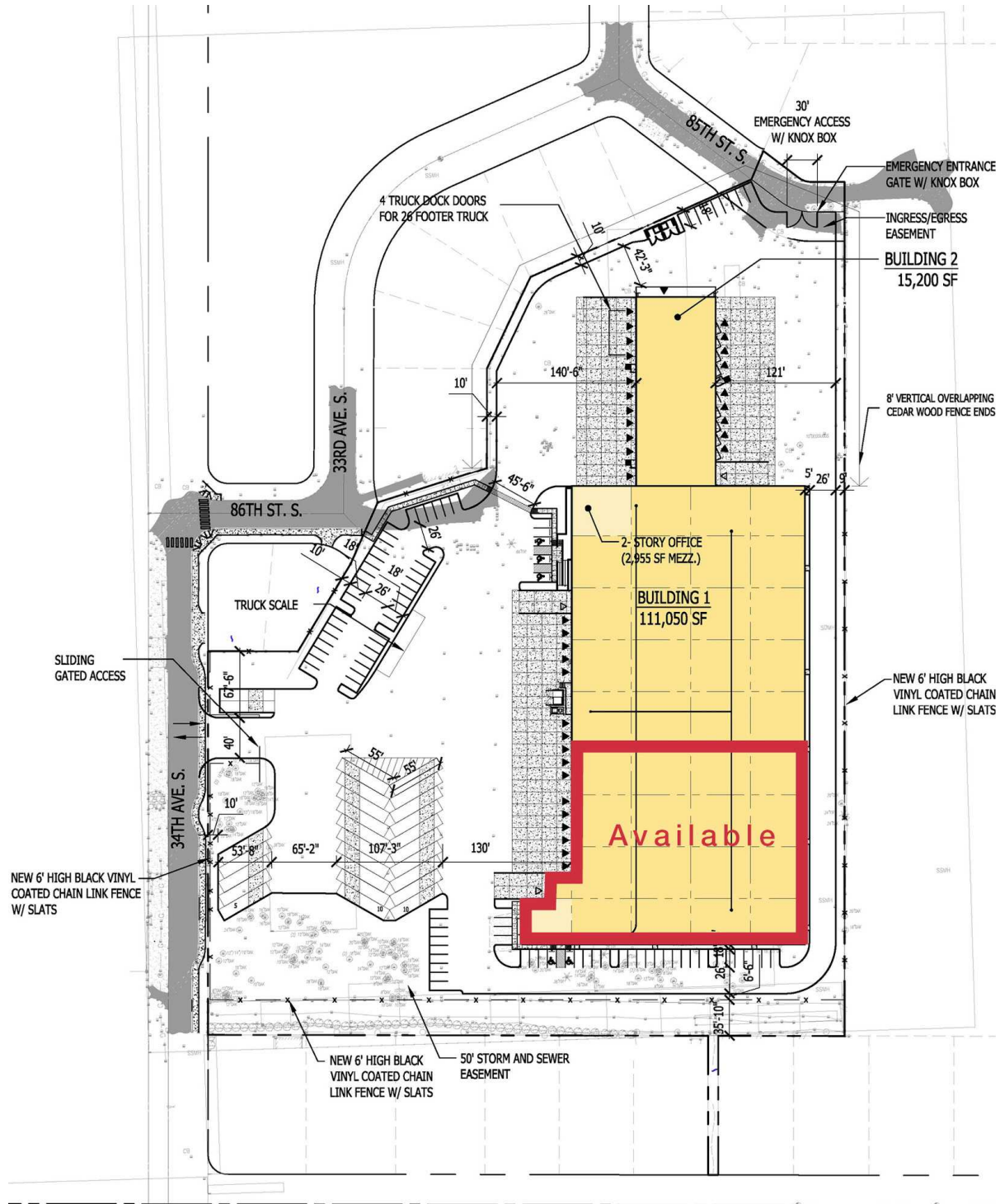

BELLEVUE | TACOMA

914 A Street, Suite 200
Tacoma, WA 98402
+1 253 383 3100
nai-psp.com

THE INFORMATION CONTAINED HEREIN HAS BEEN GIVEN TO US BY THE OWNER OF THE PROPERTY OR OTHER SOURCES WE DEEM RELIABLE, WE HAVE NO REASON TO DOUBT ITS ACCURACY, BUT WE DO NOT GUARANTEE IT. ALL INFORMATION SHOULD BE VERIFIED PRIOR TO PURCHASE OR LEASE.

Industrial for Lease

8605 34th Ave South



BELLEVUE | TACOMA

914 A Street, Suite 200

Tacoma, WA 98402

+1 253 383 3100

nai-psp.com

THE INFORMATION CONTAINED HEREIN HAS BEEN GIVEN TO US BY THE OWNER OF THE PROPERTY OR OTHER SOURCES WE DEEM RELIABLE, WE HAVE NO REASON TO DOUBT ITS ACCURACY, BUT WE DO NOT GUARANTEE IT. ALL INFORMATION SHOULD BE VERIFIED PRIOR TO PURCHASE OR LEASE.

Industrial for Lease

8605 34th Ave South



BELLEVUE | TACOMA

914 A Street, Suite 200
Tacoma, WA 98402
+1 253 383 3100
nai-psp.com

THE INFORMATION CONTAINED HEREIN HAS BEEN GIVEN TO US BY THE OWNER OF THE PROPERTY OR OTHER SOURCES WE DEEM RELIABLE, WE HAVE NO REASON TO DOUBT ITS ACCURACY, BUT WE DO NOT GUARANTEE IT. ALL INFORMATION SHOULD BE VERIFIED PRIOR TO PURCHASE OR LEASE.