

BRIDGE POINT KENT 180

7730 S 202nd St | Kent, WA

 **BRIDGE**



AVAILABLE SPACE

**88,765 SF -
182,283 SF**

OF BUILDINGS

1

CLEAR HEIGHT

40'

AVAILABLE

Now

NEW KENT INDUSTRIAL DEVELOPMENT

HIGHLIGHTS

- Stand-alone secure building
- Easy access to SR 167, I-5 and East Valley Highway
- 10 minutes to SEA International Airport
- 21 miles to Port of Tacoma & 17 miles to Port of Seattle
- Strong Kent labor force
- 25 Dock High Doors
- 2 Grade Level Doors
- Class "A" corporate image
- LED lighting
- 11 trailer parking stalls

NEWMARK

TAYLOR HOFF, SIOR

Vice Chairman
taylor.hoff@nmrk.com
425-362-1388

THAD MALLORY, SIOR

Executive Vice Chairman
thad.mallory@nmrk.com
425-362-1410

DEMISING SITE PLAN



TENANT A

Warehouse: 88,502 SF
Common: 263 SF
Total Rentable: 88,765 SF
Built to suit office space

TENANT B

Office: 3,087 SF
Mezzanine: 2,999 SF
Warehouse: 87,155 SF
Common: 277 SF
Total Rentable: 93,518 SF

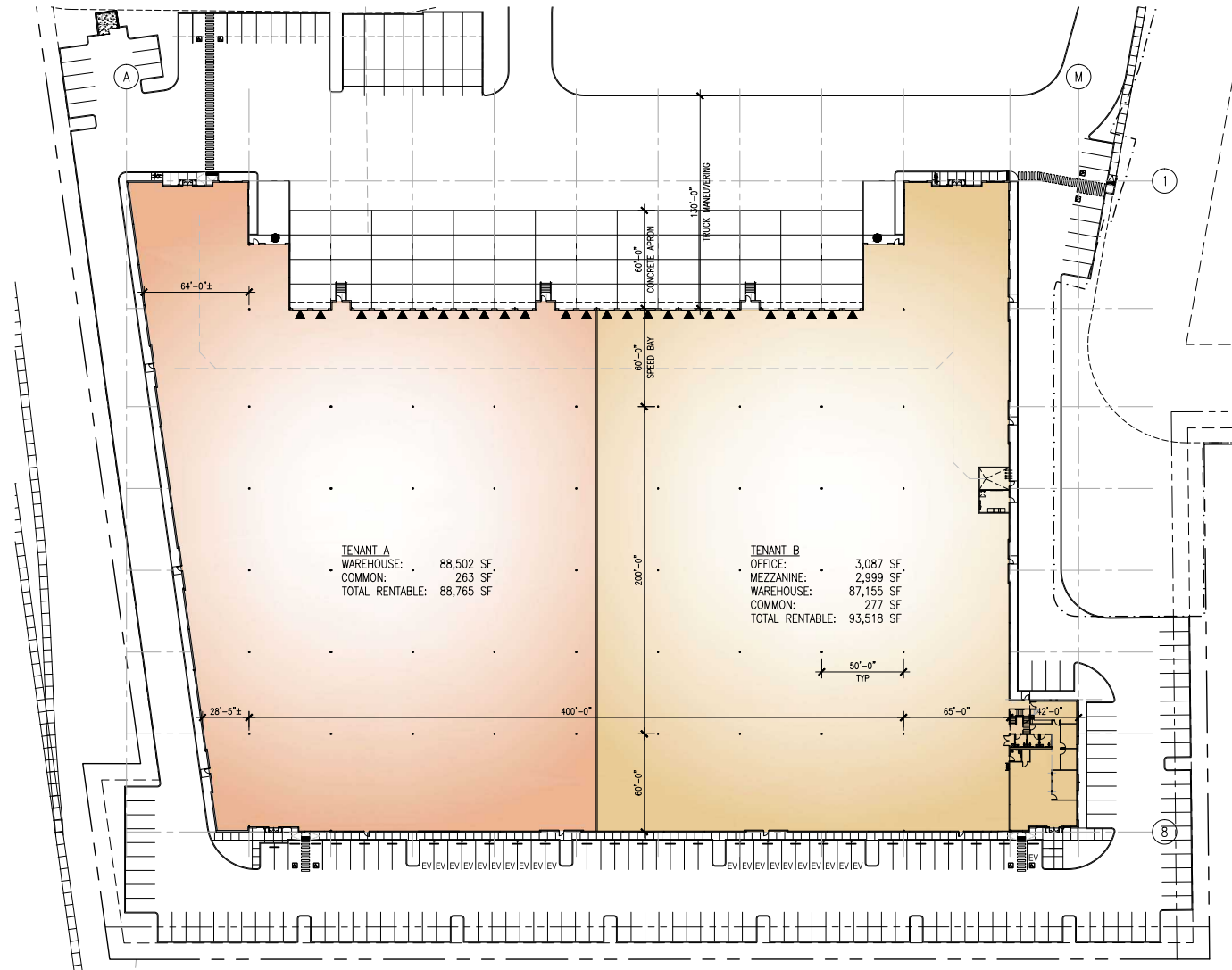

ACCESS MAP

ACCESS TO SEATTLE CBD
VIA I-5 NORTH
22 MIN / 17 MIL

Access to / from I-5
9 min / 3.8 mil

Access to / from
West Valley Hwy (181)
4 min / 1.4 mil

Access to / from
Hwy 167
5 min / 1.6 mil

SITE



181

167

NEWMARK

BRIDGE