

2,145 SF

**3208 20th Street East
Fife, WA 98424**

Prologis Park Trans-Pacific

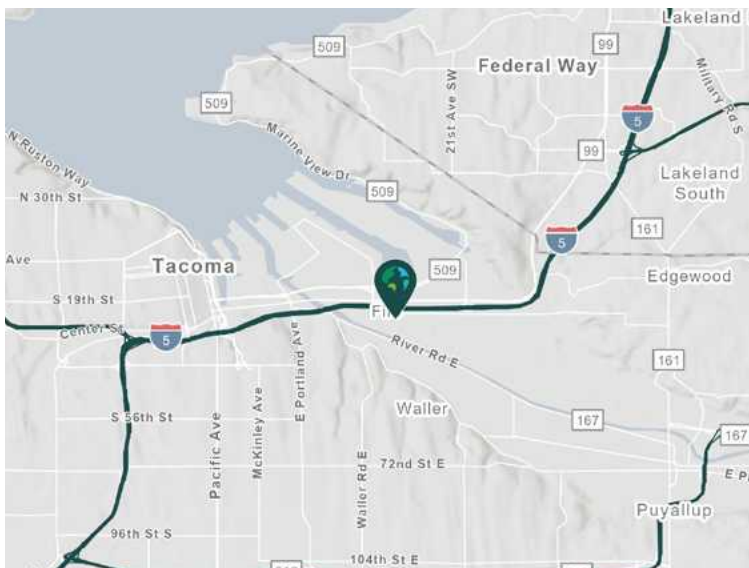

Property Features

Available Space	2,145 SF
Office SF	1,350 SF
Column Spacing	50' x 50'
Grade Level Door (w Leveler)	1
Drive-in Doors	1
Total Building Size	30,142 SF

- Immediate access to Interstate 5.
- Three miles to the Port of Tacoma main gate.
- No City of Fife B&O taxes.



Unlock the full potential of your warehouse with one strategic, single-source partner.



**BUILDING 9, SUITE 3208
OVERALL PLAN**

NTS

LEGEND:

- ▲ DOCK POSITION
- ▲ OVERSIZED DOCK POSITION
- ▲ DOCK POSITION W/ LEVELER
- ◆ DRIVE-IN DOOR
- RAIL DOOR
- LAND
- LEASED AREA
- AVAILABLE AREA

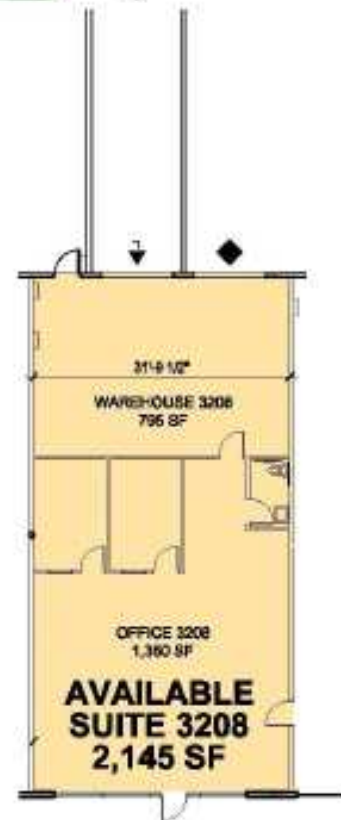

CBRE, Inc.
Monte Decker
monte.decker@cbre.com
ph +1 253 596 0041

Prologis
Kimberley Nemethy
knemethy@prologis.com
ph +1 206 414 7616
prologis.com