

# FOR SUBLEASE



## FORMER COSTA VIDA SPACE

9412 N Newport Highway | Spokane, WA 99218



### SUITE C

SUBLEASE RATE	\$38.00 PSF /YR
LEASE TYPE	NNN
SUITE SIZE	±2,480 SF

### BUILDING DETAILS

TOTAL BUILDING SIZE	±7,720 SF
YEAR BUILT	2014
LOT SIZE	±62,234 SF
PARCEL NO.	36202.0087

**CHAD CARPER**  
509.991.2222

[chad.carper@kiemleahagood.com](mailto:chad.carper@kiemleahagood.com)

**KIEMLEHAGOOD**

Highly visible location along Newport Highway, offering excellent exposure and strong daily traffic counts. This ±2,480 square foot suite is ideally suited for a variety of retail or service-oriented uses and benefits from its placement among established national tenants, driving consistent customer activity to the area. With convenient access and a well recognized corridor, this space presents a prime opportunity for businesses.

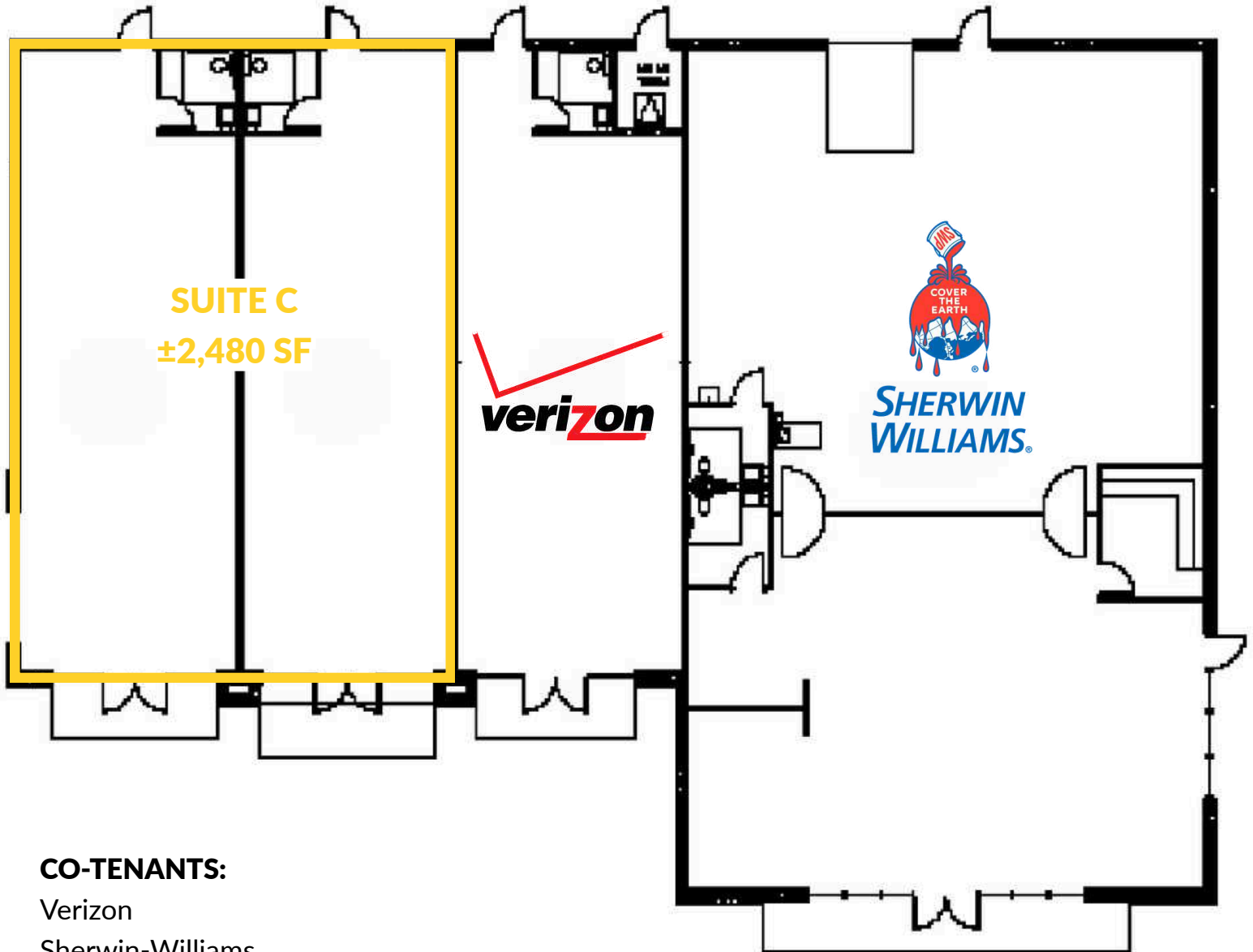

**CO-TENANTS:**

- Verizon
- Sherwin-Williams





<b>DEMOGRAPHICS</b>	<b>1 MI</b>	<b>3 MI</b>	<b>5 MI</b>
<b>EST POPULATION 2025</b>	11,481	76,306	172,490
<b>PROJ. POPULATION 2030</b>	12,068	76,367	171,543
<b>EST. HOUSEHOLDS 2025</b>	4,719	31,110	69,647
<b>2025 AVERAGE HHI</b>	\$98,775	\$105,985	\$104,374
<b>2025 MEDIAN HHI</b>	\$74,606	\$79,304	\$79,606

- NEARBY BUSINESSES**
- Applebee's
  - Bath & Body Works
  - Best Buy
  - Chick-fil-A
  - Chipotle Mexican Grill
  - Dick's Sporting Goods
  - Famous Footwear
  - Home Depot
  - Home Goods
  - Mister Car Wash
  - MUV Fitness
  - Olive Garden
  - Panda Express
  - Papa Murphy's
  - Ross
  - Safeway
  - Sherwin-Williams
  - Staples
  - Subway
  - Taco Bell
  - Target
  - Total Wine
  - Verizon
  - ... and more!



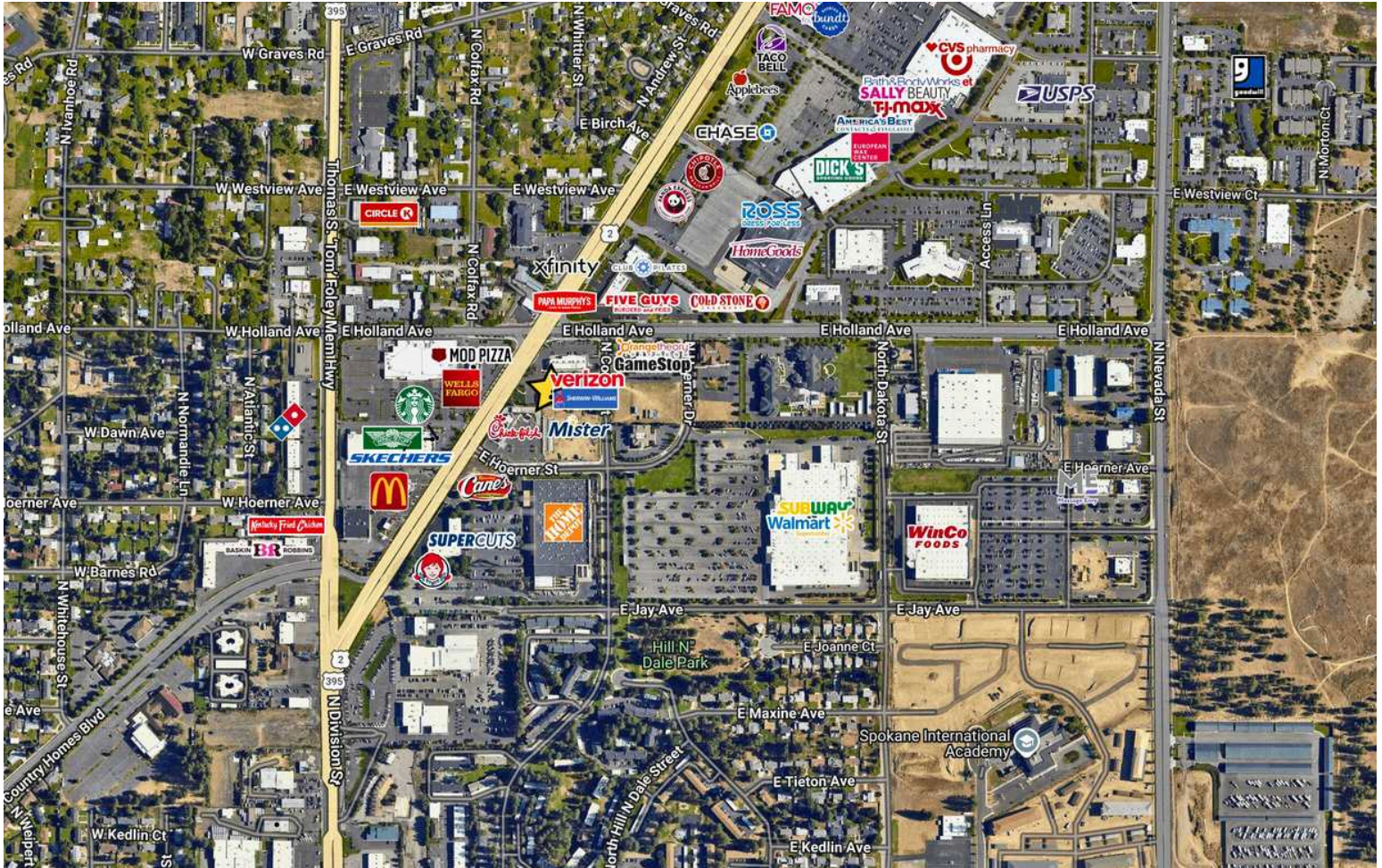

## FORMER COSTA VIDA SPACE

9412 N Newport Highway | Spokane, WA 99218



**CHAD CARPER**

509.991.2222

chad.carper@kiemlehagood.com

# KIEMLEHAGOOD

No warranty or representation, expressed or implied, is made by Kiemle Hagood, its agents or its employees as to the accuracy of the information contained herein. All information furnished is from sources deemed reliable and submitted subject to errors, omissions, change of terms and conditions, prior sale, lease or financing, or withdrawal without notice. No one should rely solely on the above information, but instead should conduct their own investigation to independently satisfy themselves. Kiemle Hagood respects the intellectual property of others: If you believe the conditions in your work has been violated through this Website, please contact our office for notice of claims of copyright infringement. For your complaint to be valid under the Digital Millennium Copyright Act of 1998 (DMCA), you must provide the following information when providing notice of the claimed copyright infringement: Identify the material on the Website that you believe infringes your work, with enough detail so that we may locate it on the Website; provide your address, telephone number and email address; provide a statement that you have a good faith belief that the disputed use is not authorized by the copyright owner, its agent, or the law; provide a statement that the information in the notification is accurate, and under penalty of perjury, that the complaining party is authorized to act on behalf of the owner of an exclusive right that is allegedly infringed; and provide your physical or electronic signature. Upon receiving your complaint, Kiemle Hagood will, upon review, remove content that you believe infringes your copyright if the complaint is found to be valid.

### OFFICE LOCATIONS

SPOKANE | COEUR D'ALENE | TRI-CITIES | MISSOULA

601 W MAIN AVENUE, SUITE 400  
SPOKANE WA 99201