



167 INDUSTRIAL

7450 26TH ST E, FIFE, WA

FOR LEASE | 225,972 SQ FT | Class A Warehouse Facility



KRAIG HEETER, SIOR
500 108th Ave NE, Suite 2400
Bellevue, WA 98004
206-248-7313
kraig.heeter@kidder.com



MATT WOOD, SIOR
5628 Airport Way S, Suite 238
Seattle, WA 98108
206-595-6814
matt.wood@kbcadvisors.com

OWNED BY



Property FEATURES

- 225,972 Total SF
- 2,990 SF planned office
- 70 Dock-high doors
w/ mechanical pit levelers
- 4 Grade-level doors

- 32' Clear height
- ESFR sprinkler
- Three phase power
- 166 Auto stalls
- Available now

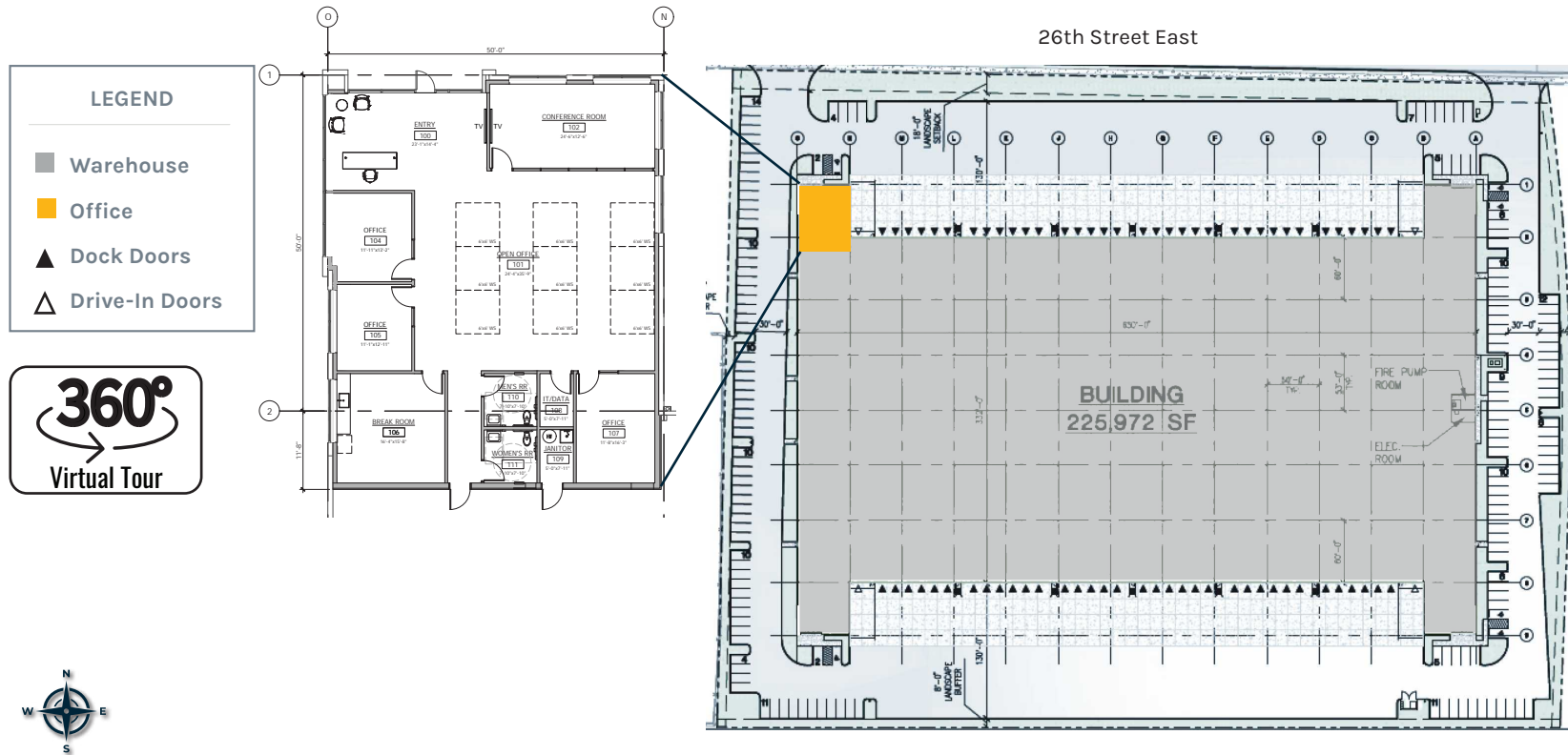

KRAIG HEETER, SIOR
 500 108th Ave NE, Suite 2400
 Bellevue, WA 98004
 206-248-7313
kraig.heeter@kidder.com



MATT WOOD, SIOR
 5628 Airport Way S, Suite 238
 Seattle, WA 98108
 206-595-6814
matt.wood@kbcadvisors.com



Location HIGHLIGHTS

- 5 Minutes to I-5
- 5 minutes to SR-167

[Future SR-167 Expansion Information](#)

- 10 Minutes to Port of Tacoma
- 45 minutes to Port of Seattle

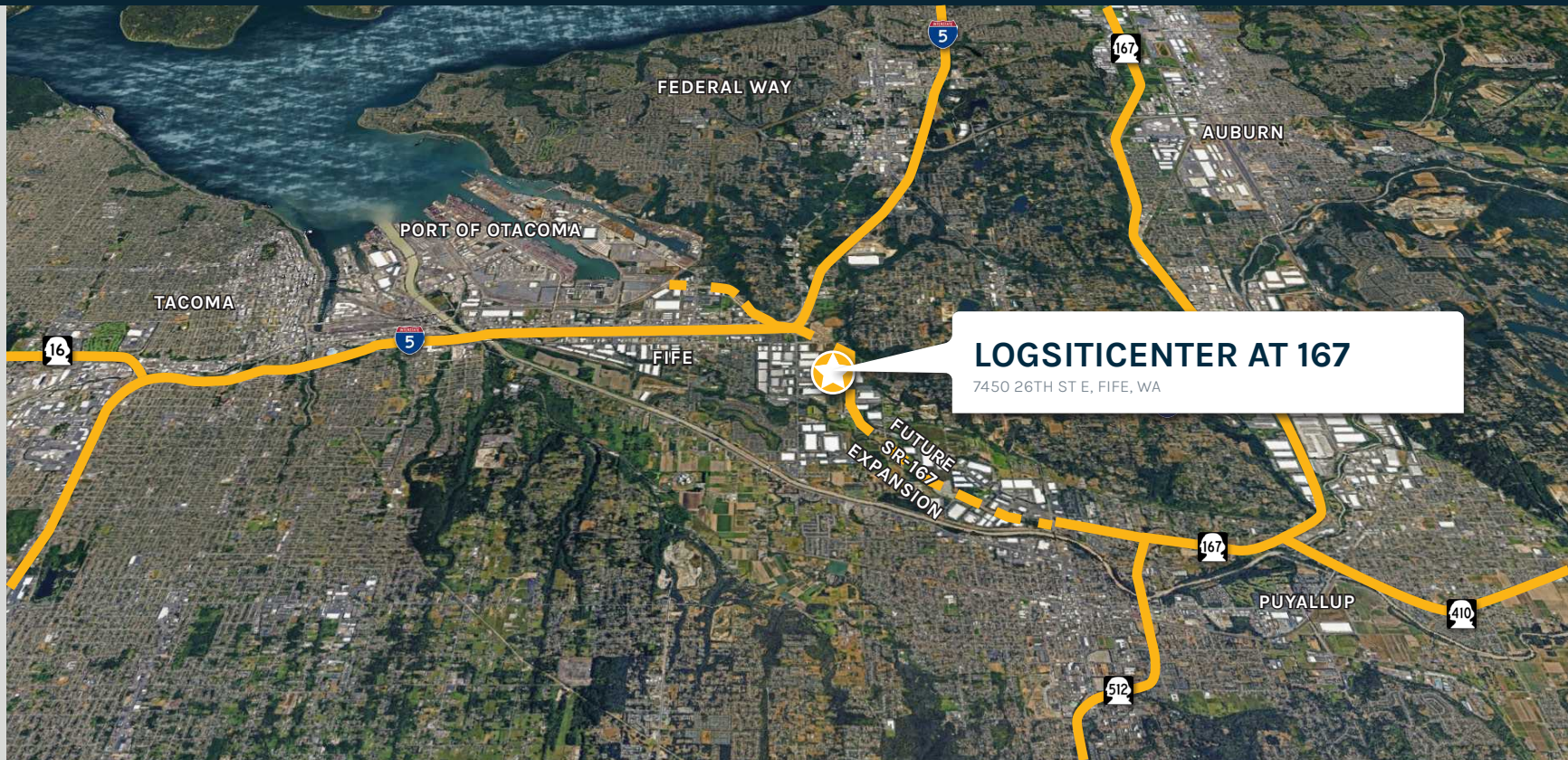

KRAIG HEETER, SIOR
500 108th Ave NE, Suite 2400
Bellevue, WA 98004
206-248-7313
kraig.heeter@kidder.com



MATT WOOD, SIOR
5628 Airport Way S, Suite 238
Seattle, WA 98108
206-595-6814
matt.wood@kbcadvisors.com



ABOUT ARES MANAGEMENT CORPORATION

Ares Management Corporation (NYSE: ARES) is a leading global alternative investment manager providing clients complementary primary and secondary investment solutions across the credit, private equity, real estate and infrastructure asset classes. We seek to provide flexible capital to support businesses and create value for our stakeholders and within our communities. By collaborating across our investment groups, we aim to generate consistent and attractive investment returns throughout market cycles. For more information, please visit www.aresmgmt.com.



KRAIG HEETER, SIOR
500 108th Ave NE, Suite 2400
Bellevue, WA 98004
206-248-7313
kraig.heeter@kidder.com



MATT WOOD, SIOR
5628 Airport Way S, Suite 238
Seattle, WA 98108
206-595-6814
matt.wood@kbcadvisors.com

