



TUKWILA COMMERCE PARK

12606 INTERURBAN AVE S,
BLDG B, SUITE 140, TUKWILA, WA

FOR LEASE 4,858 SF

742 SF Office

12' Clear height

1 Drive-in door

Available May 1, 2026

Call agent for rates

2026 Est. NNN \$0.42/SF

Excellent access to I-5 and SR-599

Adjacent to Tukwila Community Center
and Interurban Trail

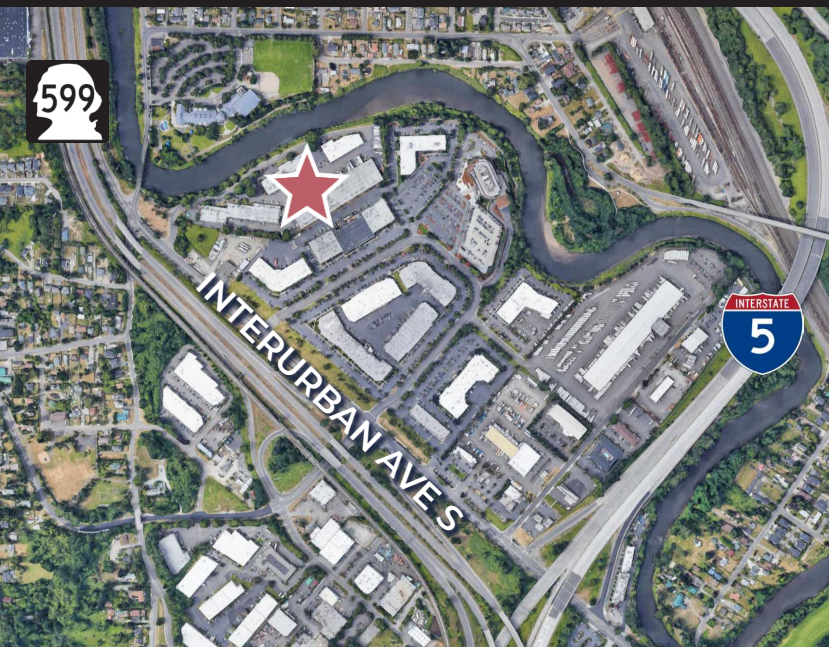

MATT WOOD, SIOR
+1 206 595 6814
matt.wood@kbcadvisors.com

JOHN BROOM
+1 206 877 2750
john.broom@kbcadvisors.com

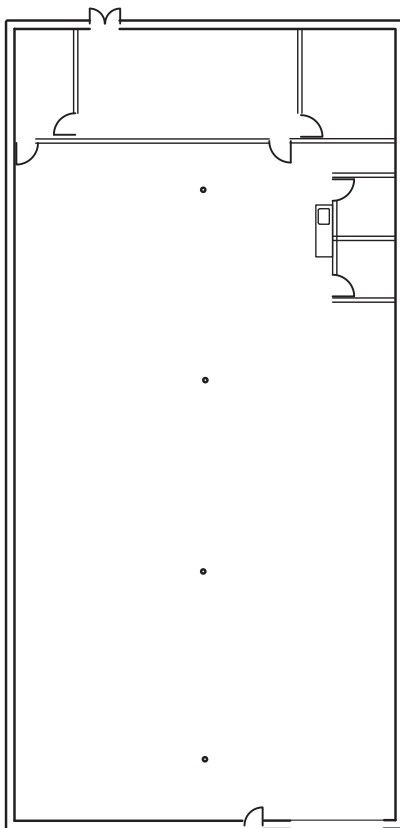
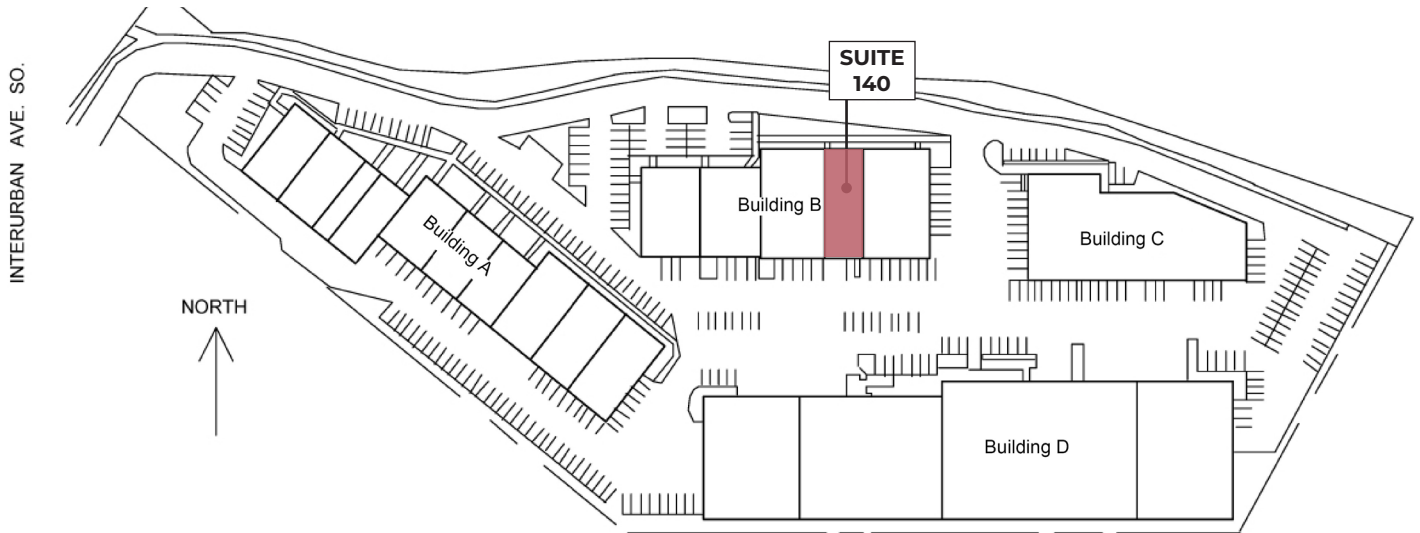

Space Information

4,858 SF Total

742 SF Office

12' Clear height

1 Drive-in door

Available with 30 days notice

 Grade-level door

MATT WOOD, SIOR

+1 206 595 6814

matt.wood@kbcadvisors.com

JOHN BROOM

+1 206 877 2750

john.broom@kbcadvisors.com