

**For Lease**

**427,253 Square Feet Available**



**BUILDING HIGHLIGHTS**

- 427,253 SF total – divisible to 90,000 SF
- 9,422 SF of office – 3 nodes
- 111 dock high doors
  - » 19 pit levelers
  - » 5 edge of dock levelers with dock seals
- 6 grade level doors
- 30' clear height
- 4,200 amps, 277/480v, 3-phase
- ESFR
- LED lighting with motion sensors
- Column spacing: 50' x 50'
- Cross loaded
- Truck court: 109' on south end, approx. 75' on north side
- 268 car stalls
- Building dimensions: 385' x 1,125'



**FLOOR PLAN**

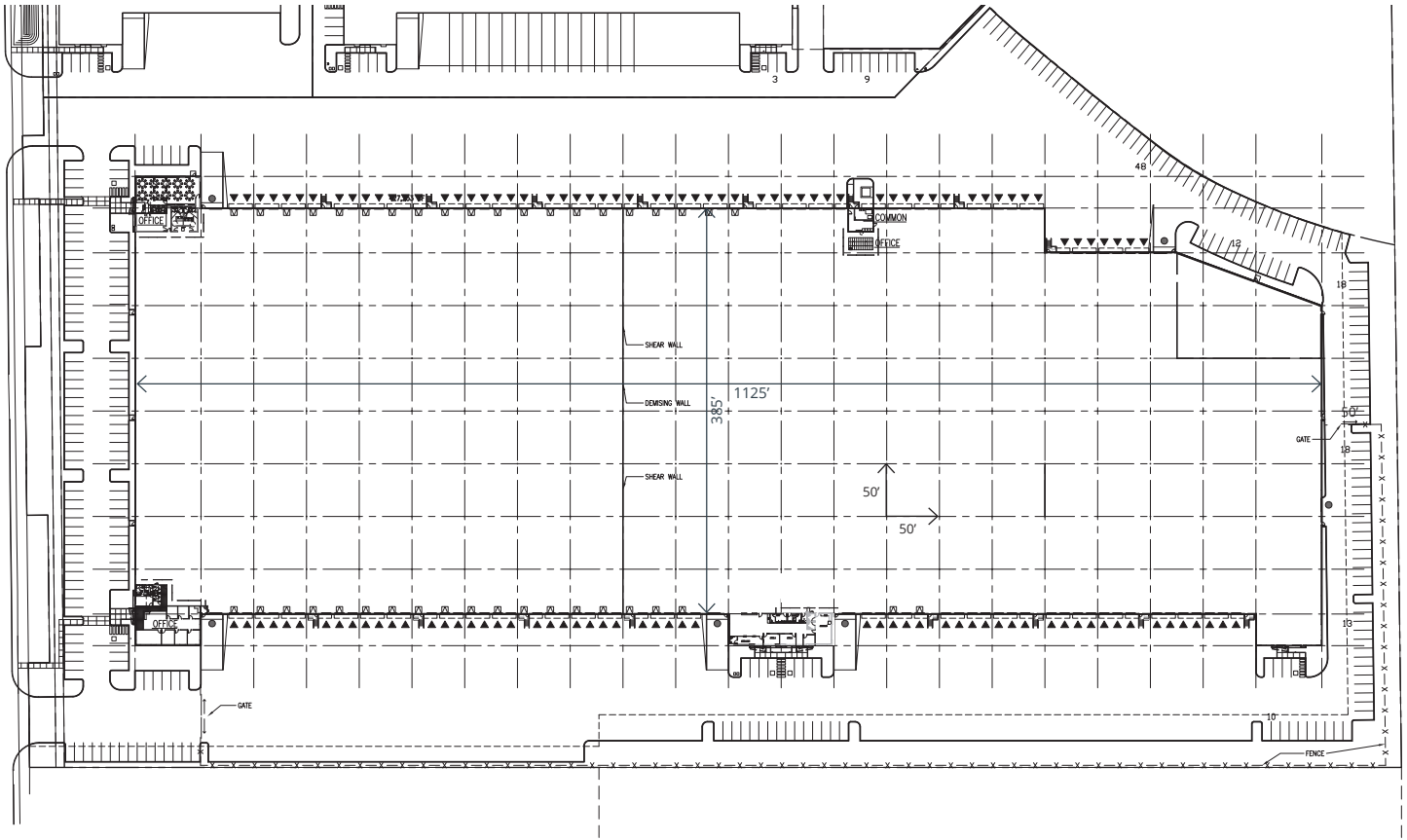

**OFFICE PLAN**

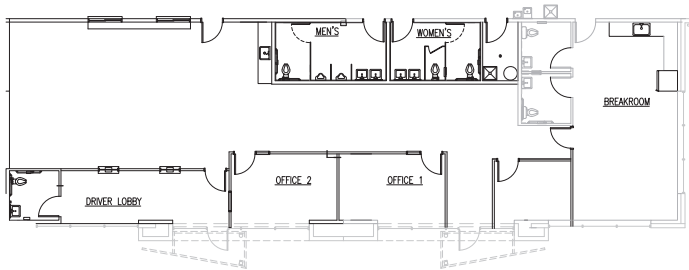

- ▲ Dock-high door
- Drive-in door

- Only minutes to retail including restaurants, shopping and theaters
- ±18 miles / ±30 minutes to Sea-Tac Airport
- ±30 miles / ±50 minutes to downtown Seattle
- ±31 miles / ±60 minutes to Port of Seattle
- ±14 miles / ±29 minutes to Port of Tacoma

*For more information on this opportunity, please contact*

**Matt McGregor, SIOR**  
+1 206 624 7401  
matt.mcgregor@colliers.com

**Bill Condon, SIOR**  
+1 206 235 9732  
bill.condon@colliers.com

