

M2 INDUSTRIAL CENTER

FOR LEASE

*38,400 Total SF Heavy Power Industrial Building
for Lease in Kent, WA*

7250 S 227TH PLACE, KENT, WA

38,400 SF

TOTAL BUILDING

9/1/26

AVAILABLE

PROPERTY DETAILS



Approximately 38,400 RSF

Approximately 3,450 total SF office in two areas

8 Dock doors

2 Ramped doors

Heavy power

2.53 acre site is fully fenced, gated and supports yard storage

Rare Rail Served building

Zoned I2 which allows some outside storage and other heavy industrial uses

Available 9/1/2026

\$1.10 / SF shell, NNN

\$1.35 office add-on, NNN

No yard additional cost

5 MIN

TO SR-167

9 MIN

TO SR-516

SITE PLAN

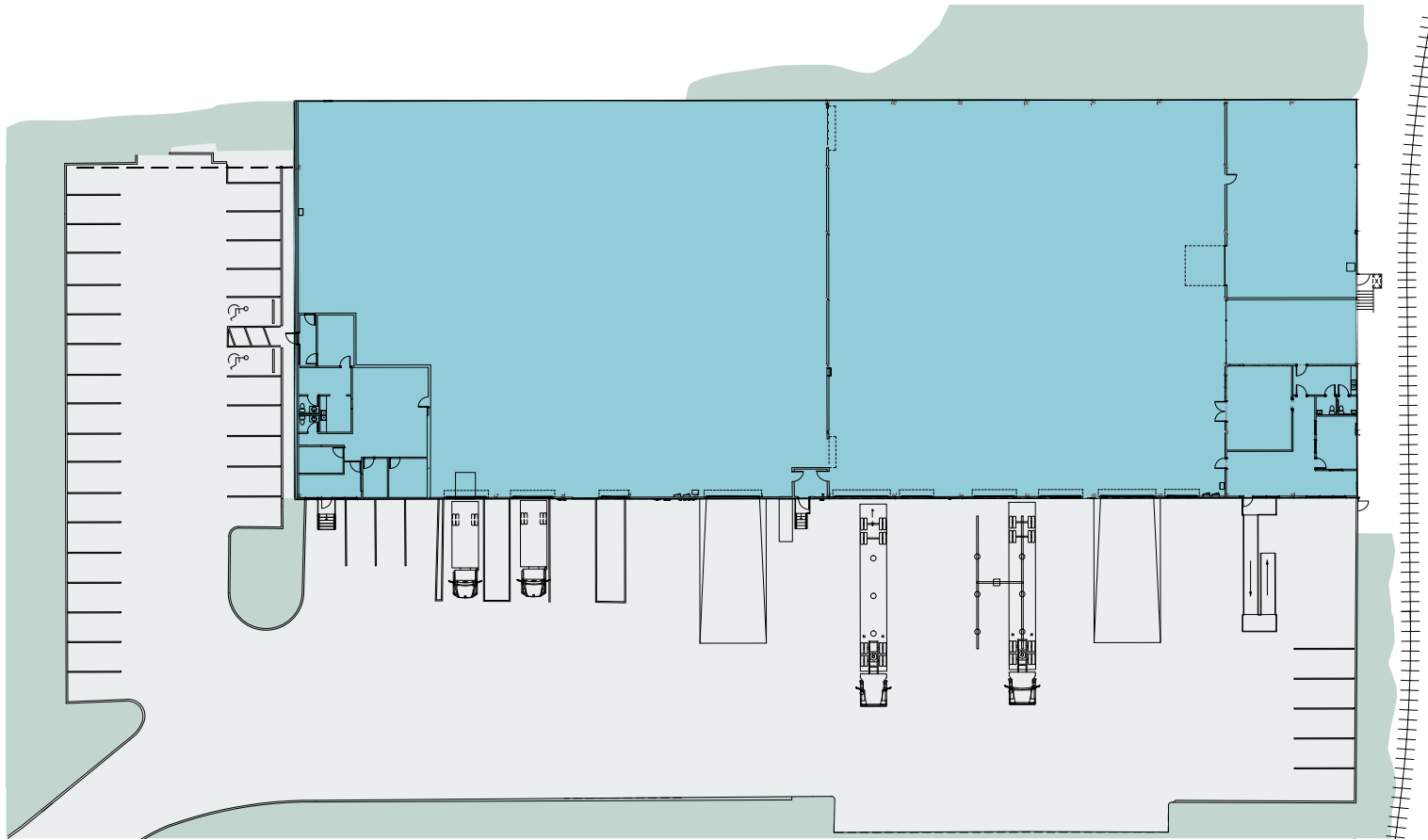

38,400

TOTAL RSF

3,450

TOTAL OFFICE SF

NOW

AVAILABLE



M2 INDUSTRIAL CENTER

Exclusively leased by

DOUG KLEIN, SIOR
Executive Vice President, Shareholder
206.248.7348
doug.klein@kidder.com

This information supplied herein is from sources we deem reliable. It is provided without any representation, warranty, or guarantee, expressed or implied as to its accuracy. Prospective Buyer or Tenant should conduct an independent investigation and verification of all matters deemed to be material, including, but not limited to, statements of income and expenses. Consult your attorney, accountant, or other professional advisor. All Kidder Mathews designs are the sole property of Kidder Mathews. Branded materials and layouts are not authorized for use by any other firm or person.

