



## TUKWILA COMMERCE PARK



A 12600-110	Decor Carpet One	B 12620-100	Adheteq
A 12600-116	GE Aviation	B 12620-120	
A 12600-120	Darigold	B 12620-130	Covalon
A 12600-130		B 12620-140	
A 12600-140		B 12620-150	Pacific Bath Co.
A 12600-150			
A 12600-160		D 12610-100	Morning Star Transport
A 12600-170	SAFELITE	D 12610-110	Superior Office Installation
C 12628-100	1-800 WATER DAMAGE	D 12610-120	Fern Expo
C 12628-120	Sound		
C 12628-130			



## TUKWILA COMMERCE PARK

12606 INTERURBAN AVE S,  
BLDG A, SUITE 140, TUKWILA, WA

## FOR LEASE 3,975 SF

1,002 SF Office

12' Clear height

2 Drive-in doors

Available Now

Call agent for rates

2025 Est. NNN \$0.365/SF

Excellent access to I-5 and SR-599

Adjacent to Tukwila Community Center  
and Interurban Trail

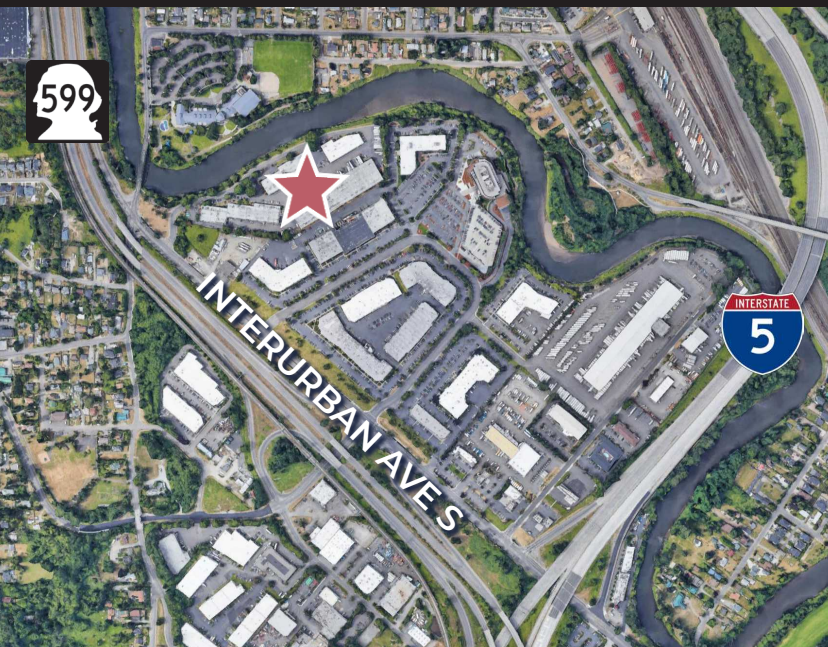

**MATT WOOD, SIOR**

+1 206 595 6814

[matt.wood@kbcadvisors.com](mailto:matt.wood@kbcadvisors.com)

**JOHN BROOM**

+1 206 877 2750

[john.broom@kbcadvisors.com](mailto:john.broom@kbcadvisors.com)

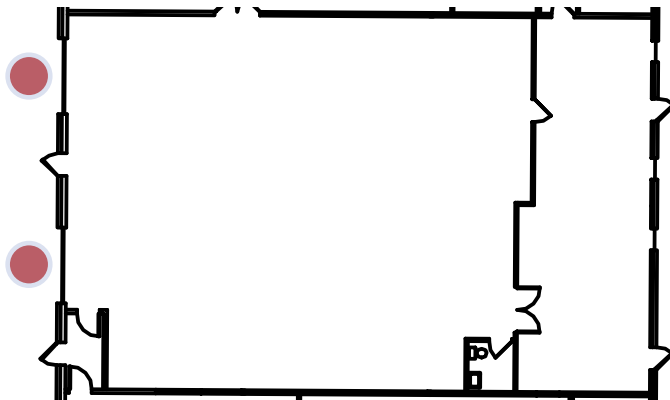
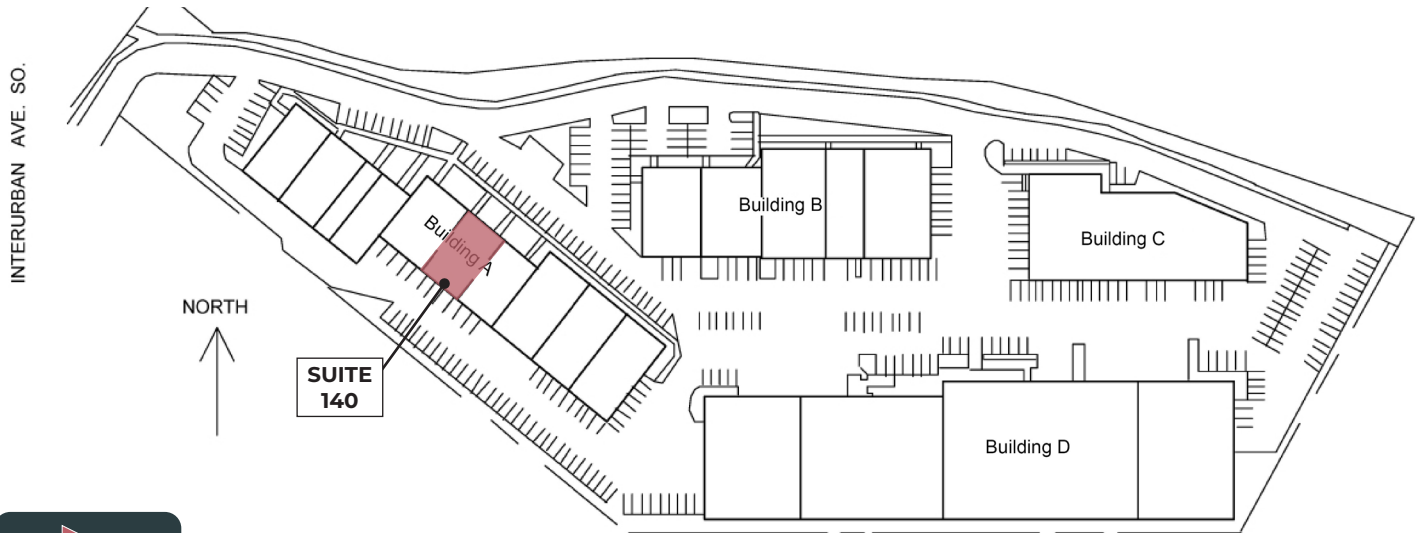

 drive-in door

## Space Information

- 3,975 SF Total
- 1,002 SF Office
- 12' Clear height
- 2 Drive-in doors
- Available Now

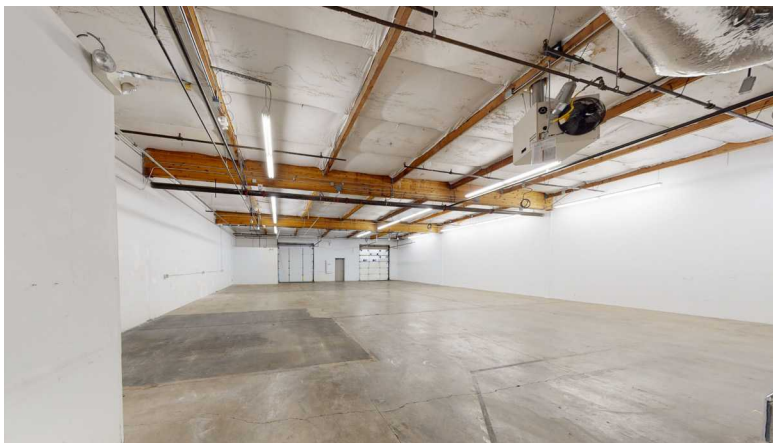

**MATT WOOD, SIOR**  
+1 206 595 6814  
matt.wood@kbcadvisors.com

**JOHN BROOM**  
+1 206 877 2750  
john.broom@kbcadvisors.com