

# BREWERY TOWER BUILDING

FOR LEASE: 2,067 SF

2509-2515 S HOLGATE ST | TACOMA, WA

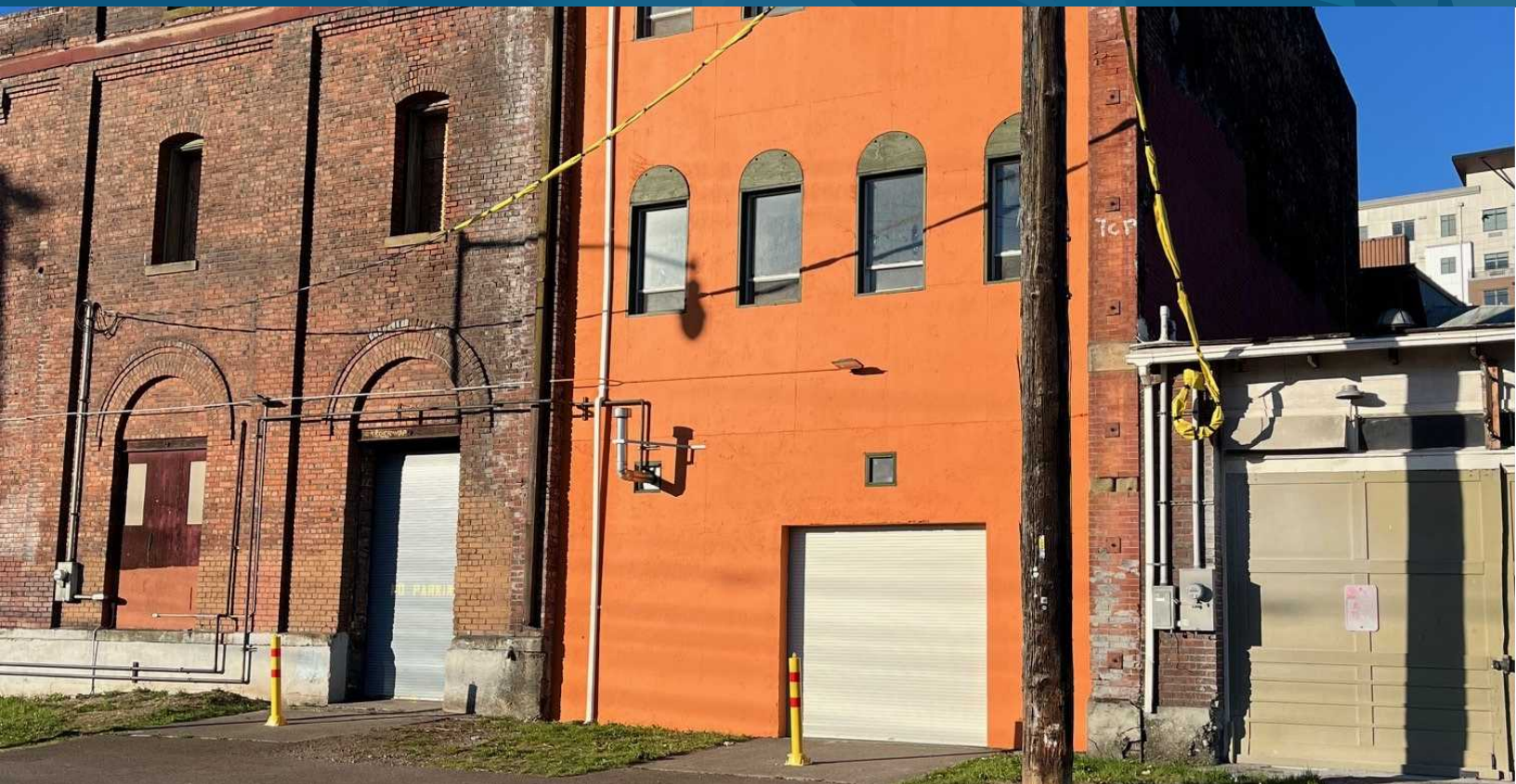

## LEASE INFORMATION

Available Size	Roll-up Doors	Clear Height	Available	Lease Rate	NNN Rate
± 2,067 SF	1 (7' x 10')	12'	Now	\$1,200/Mo	\$310/Mo

## PROPERTY FEATURES

- 3 phase power
- Electric door opener
- Located in Tacoma's Downtown Historical District
- Warehouse/Residential zoning
- Below market rates
- Within close proximity to I-5 and Hwy-16
- Located near UW Tacoma and Tacoma's Nalley Valley District
- Ideal for dead storage
- Secured parking available across street

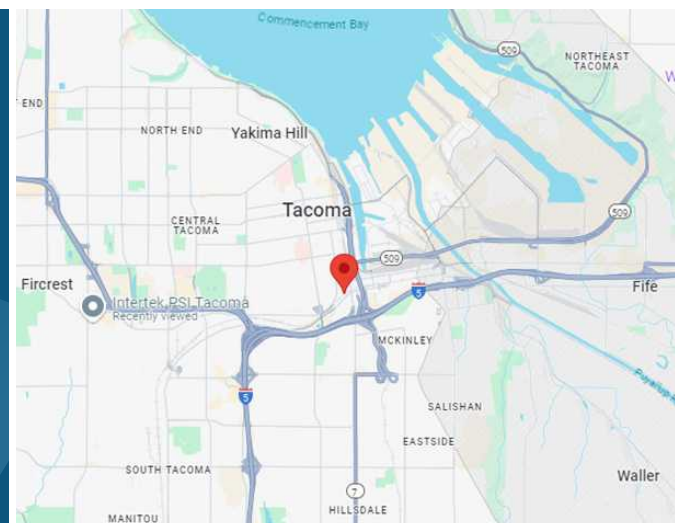

**JOEL JONES**  
253.779.2422

[jjones@neilwalter.com](mailto:jjones@neilwalter.com)

**JACOB HANIGAN**  
253.779.2401

[jhanigan@neilwalter.com](mailto:jhanigan@neilwalter.com)

All information references in this document are approximate. The information contained herein is contained from sources deemed reliable. It is provided without representation, warranty, or guarantee, expressed or implied as to accuracy. Prospective buyer or tenant should conduct its own independent investigation relating to the property, government codes and regulations, allowed uses, and all other matters, regardless of whether they are referred to or contained in this document.

# BREWERY TOWER BUILDING

2509-2515 S HOLGATE ST | TACOMA, WA

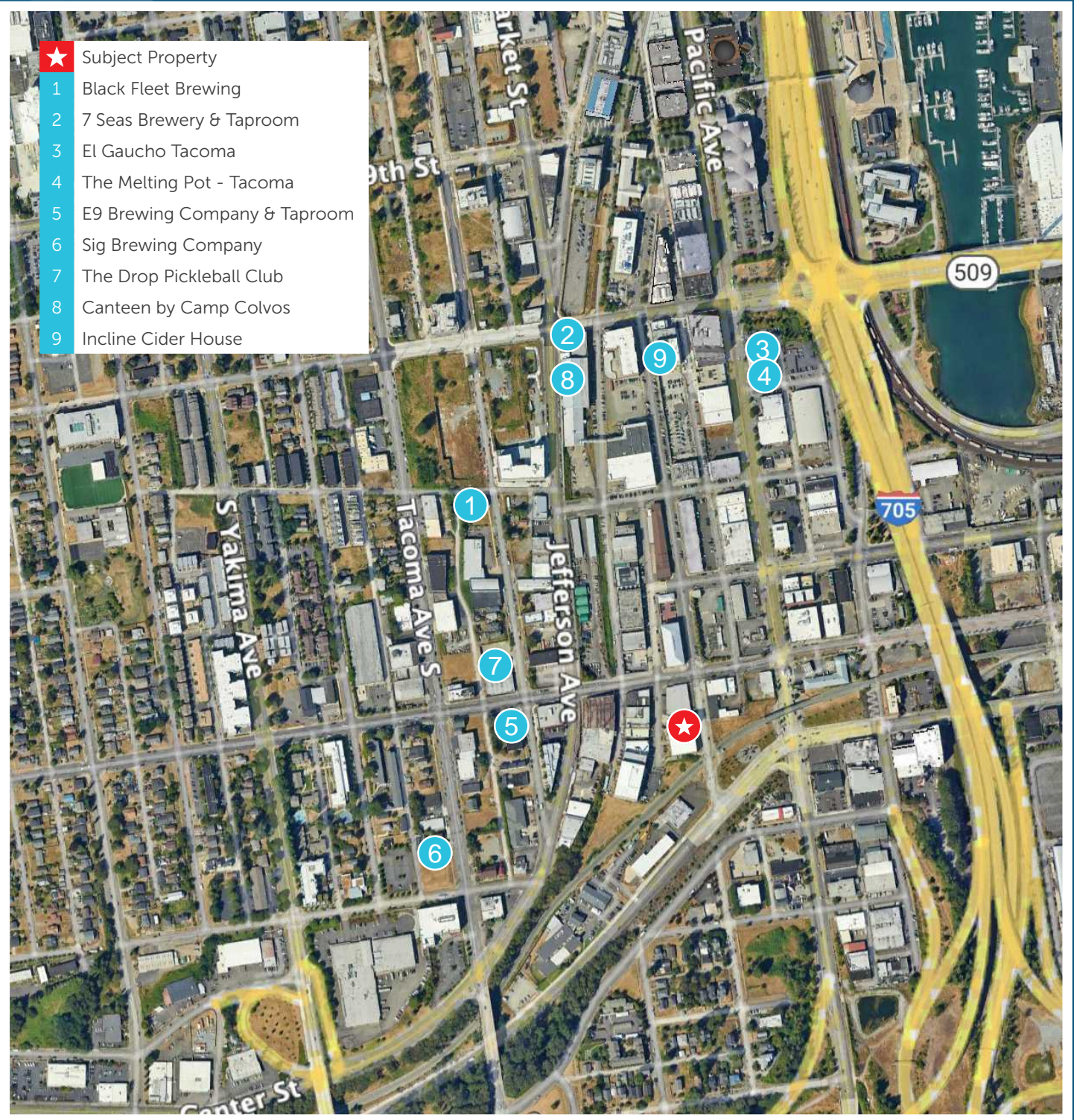

**JOEL JONES**  
253.779.2422  
jjones@neilwalter.com

**JACOB HANIGAN**  
253.779.2401  
jhanigan@neilwalter.com

1940 East D St, #100  
Tacoma, WA 98421  
253.779.8400  
www.neilwalter.com

All information references in this document are approximate. The information contained herein is contained from sources deemed reliable. It is provided without representation, warranty, or guarantee, expressed or implied as to accuracy. Prospective buyer or tenant should conduct its own independent investigation relating to the property, government codes and regulations, allowed uses, and all other matters, regardless of whether they are referred to or contained in this document.

# BREWERY TOWER BUILDING

2509-2515 S HOLGATE ST | TACOMA, WA



## SITE PLAN

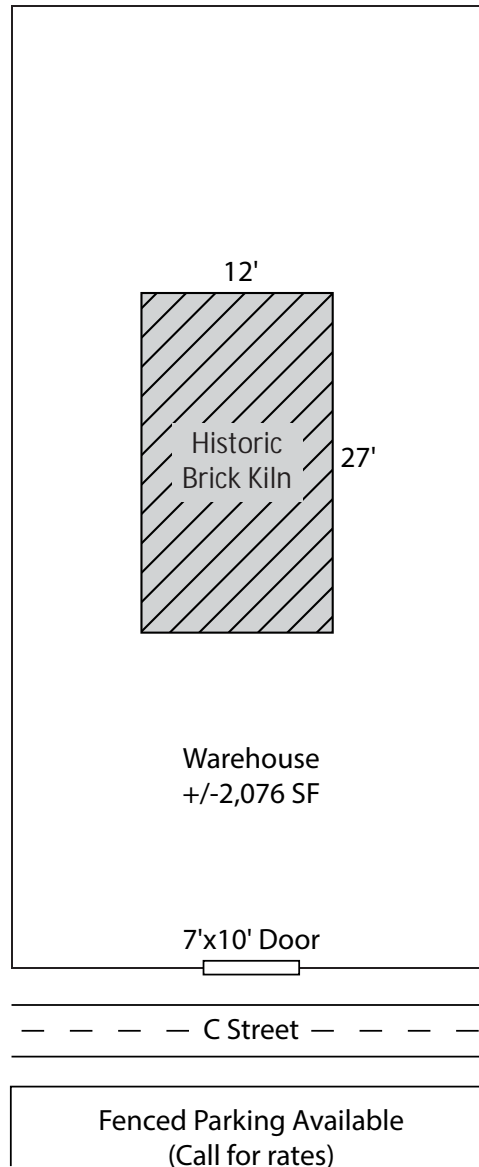

**JOEL JONES**  
253.779.2422  
jjones@neilwalter.com

**JACOB HANIGAN**  
253.779.2401  
jhanigan@neilwalter.com

1940 East D St, #100  
Tacoma, WA 98421  
253.779.8400  
www.neilwalter.com

All information references in this document are approximate. The information contained herein is contained from sources deemed reliable. It is provided without representation, warranty, or guarantee, expressed or implied as to accuracy. Prospective buyer or tenant should conduct its own independent investigation relating to the property, government codes and regulations, allowed uses, and all other matters, regardless of whether they are referred to or contained in this document.