

# BUILDING 300-LIBERTY PARK



**IRREPLACEABLE OWNER USER OFFICE BUILDING**

300 NE GILMAN BLVD | ISSAQUAH, WA

**AVAILABLE FOR SALE**

**6,022 RSF**  
**AVAILABLE FOR**  
**OCCUPANCY**

**ASKING PRICE**  
**\$3,800,000**



# BUILDING FEATURES



## BUILDING 300 - LIBERTY PARK

|                            |   |
|----------------------------|---|
| Address                    | 300 NE Gilman Blvd  |
| Building Size              | 6,022 RSF   |
| Lot Size (per King County) | 17,151 Square Feet  |
| Floors                     | One (1) plus basement/parking/storage                                   |
| Year Built                 | 1986  |
| Construction Type          | Wood frame  |
| Occupancy                  | 100% Lease includes 6 month termination clause                          |
| Parking                    | 18 stalls (3.0/1,000 RSF) 12 surface and 6 garage - plus shared parking |

# BUILDING 300 | SITEPLAN

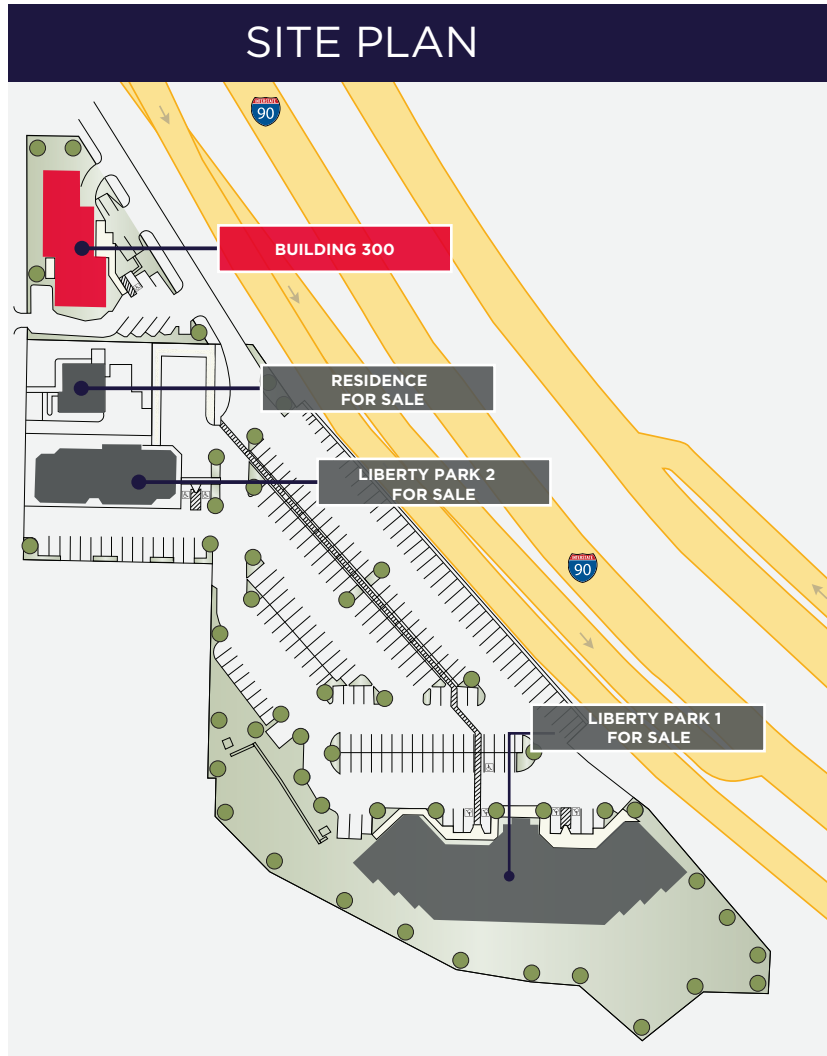

# FLOOR 1

| Suite #   | Rentable Area |
|-----------|---------------|
| SUITE 101 | 1,817 SF      |
| SUITE 102 | 2,390 SF      |
| SUITE 103 | 1,044 SF      |

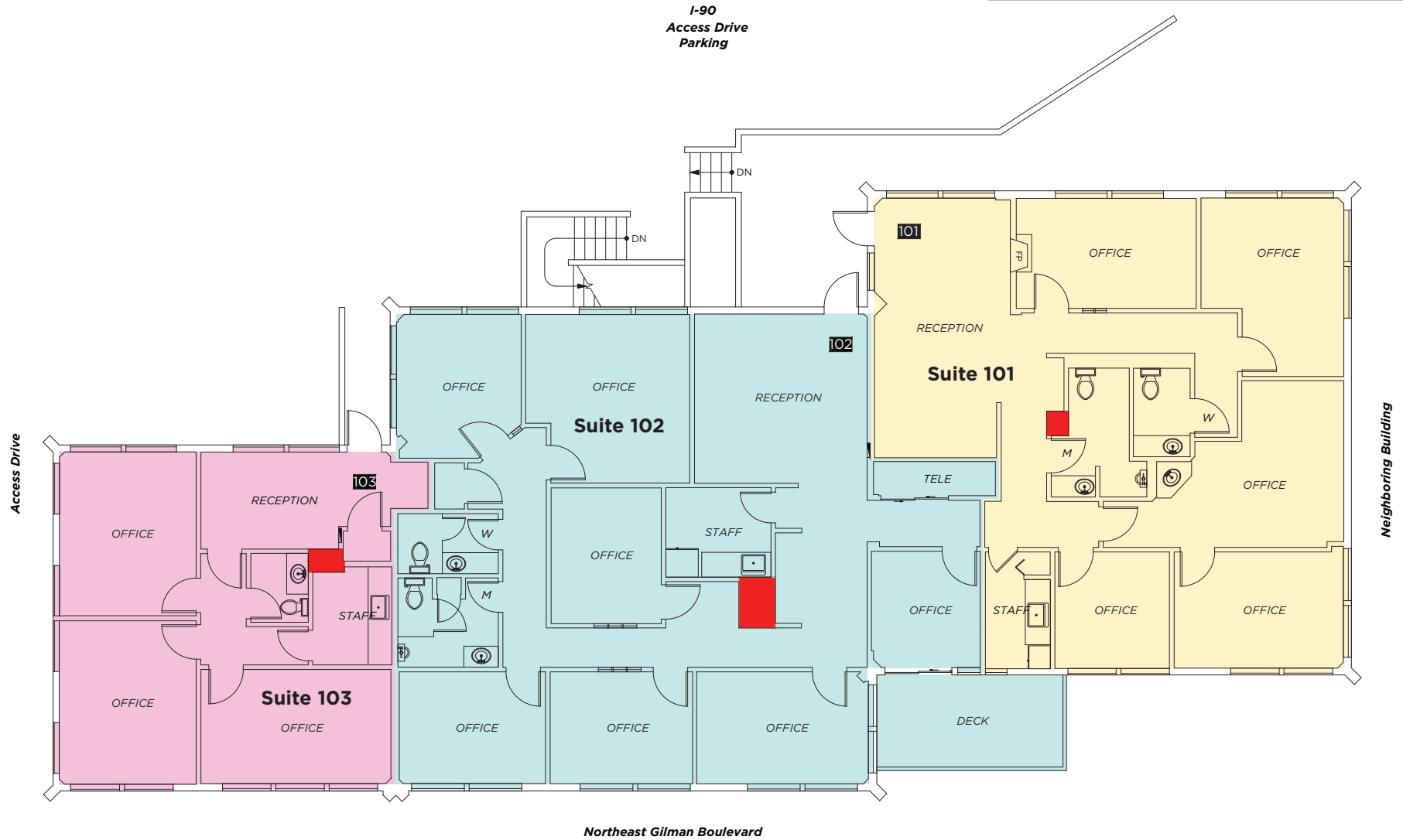

# GARAGE

| Suite #   | Square Feet |
|-----------|-------------|
| STORAGE A | 558 SF      |
| STORAGE B | 211 SF      |
| PARKING   | 2,143 SF    |

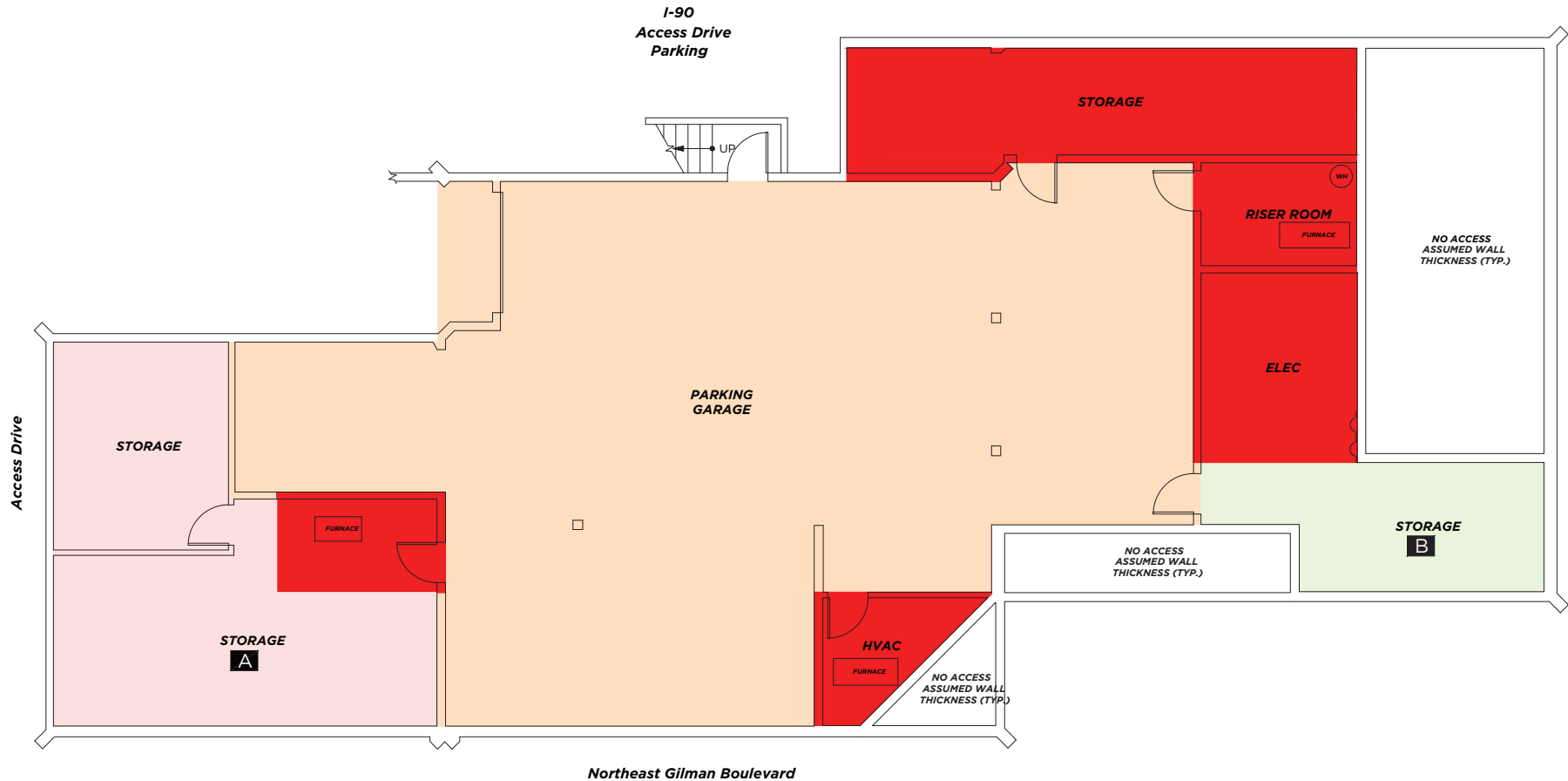

# LOCATION HIGHLIGHTS

EASY ACCESS TO TOP RATED AMENITIES

**ISSAQUAH HIGHLANDS**

**SWEDISH MEDICAL GROUP**  
575,000 SF

**BUILDING 300 LIBERTY PARK**

**HISTORIC DOWNTOWN ISSAQUAH**

**ISSAQUAH COMMONS**

- TARGET
- MREI CO-OP
- TRADER JOE'S
- SAFeway
- POTBELLY SANDWICH SHOP
- petco
- BED BATH & BEYOND
- Panera BREAD
- Starbucks
- SEPHORA
- FedEx Office
- CHIPOTLE MEXICAN GRILL
- ROSS DRESS FOR LESS
- ME Massage Envy
- Bath & Body Works

**LAKE SAMMAMISH CENTER**

- BEST BUY
- Fred Meyer
- PANDA EXPRESS
- QDOBA MEXICAN EATS
- Krispy Kreme DOUGHNUTS
- THE HONEY DIPPER
- Jamba
- Starbucks
- AT&T
- indigo URGENT CARE
- Walgreens

**GLOBAL HEADQUARTERS**

**Costco WHOLESALE**  
5,000 EMPLOYEES

**BIG LOTS!**

**425 FITNESS**

**LOWE'S**

**WU**

**HOBBY LOBBY**

**ISSAQUAH TRANSIT CENTER**

**Costco WHOLESALE**

**PET SMART**

**Michaels**

**QFC Quality Food Centers**

**Shell**

**REI CO-OP**  
SATELLITE OFFICE

# BUILDING 300-LIBERTY PARK

300 NE GILMAN BLVD | ISSAQUAH, WA



**BRIAN TOY**

Director  
+1 425 985 6706  
Brian.Toy@cushwake.com

**DAN CHHAN**

Managing Director  
+1 206 321 2047  
Dan.Chhan@cushwake.com

Cushman & Wakefield | 11235 SE 6th Street | Suite 200 | Bellevue, WA 98004