

**FOR LEASE**

**49,412 SF (4,997 SF OFFICE) + 1.25 AC YARD**

22601 76th Ave S | Kent, WA

S 228th St

EASY STONES  
22601  
76TH AVE SOUTH

**NEWMARK**

**TAYLOR HOFF, SIOR**  
taylor.hoff@nrmk.com  
425-362-1388

**THAD MALLORY, SIOR**  
thad.mallory@nrmk.com  
425-362-1410

# FOR LEASE

## 49,412 SF (4,997 SF OFFICE) + 1.25 AC YARD

22601 76th Ave S | Kent, WA

### SITE PLAN

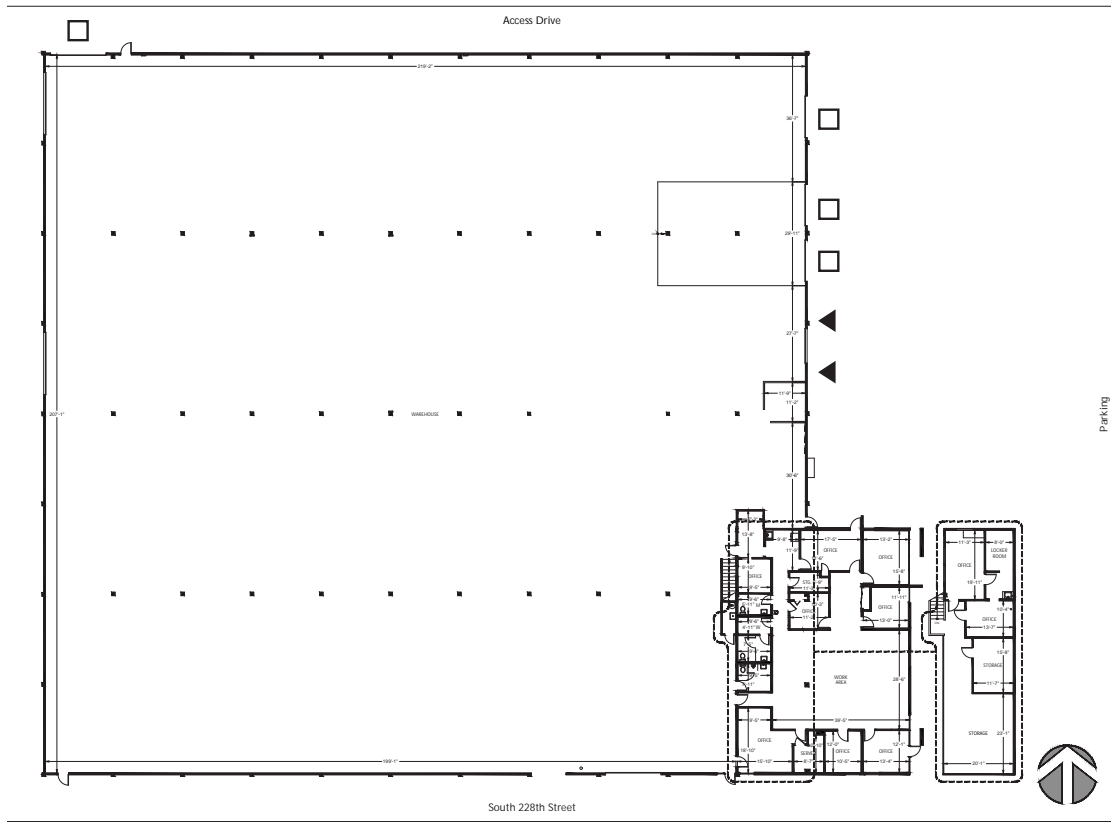

- ▲ DOCK HIGH
- GRADE LEVEL

### BUILDING & PROPERTY DETAILS

**TOTAL BUILDING SF**  
49,412 SF

**OFFICE SF**  
4,997 SF Total

**CLEAR HEIGHT**  
24'

**LOADING**  
2 Dock High Doors  
4 Grade Level Doors

**POWER**  
600 Amps, 277/480 Volt Power (Tenant to Verify)

**CRANES**  
Two (2) Six-Ton Overhead Cranes

**YARD**  
1.25 Acres Fully Secure, Fenced, & Paved Site

**VISIBILITY ON 228TH**  
Great Access to SR 167 & West Valley Hwy

**AVAILABLE**  
Now

**NEWMARK**

**TAYLOR HOFF, SIOR**  
taylor.hoff@nrmk.com  
425-362-1388

**THAD MALLORY, SIOR**  
thad.mallory@nrmk.com  
425-362-1410

FOR LEASE

49,412 SF (4,997 SF OFFICE) + 1.25 AC YARD

22601 76th Ave S | Kent, WA

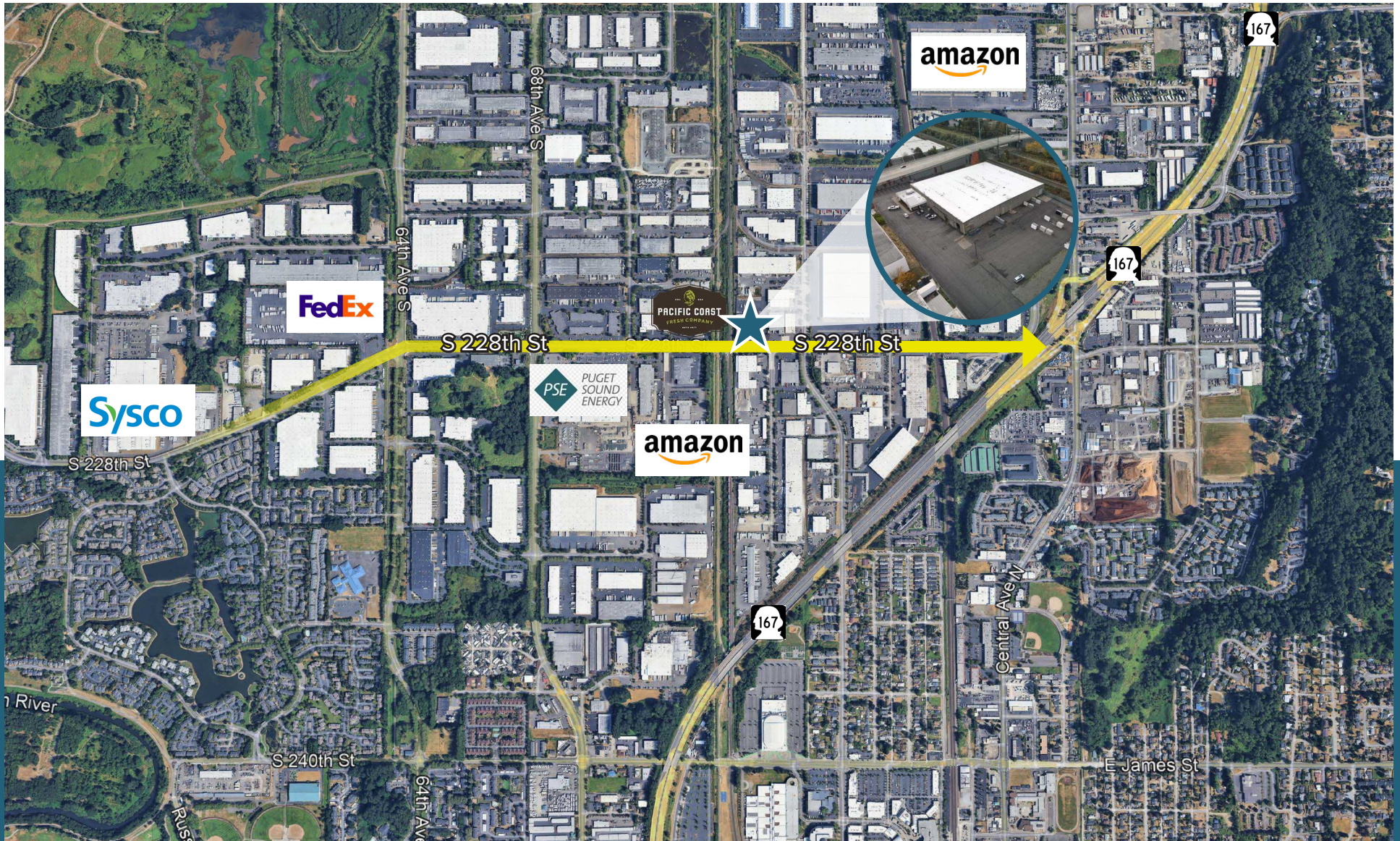

# 22601 76TH AVE S

KENT, WA

**TAYLOR HOFF, SIOR**

taylor.hoff@nmrk.com

425-362-1388

**THAD MALLORY, SIOR**

thad.mallory@nmrk.com

425-362-1410

The distributor of this communication is performing acts for which a real estate license is required. The information contained herein has been obtained from sources deemed reliable but has not been verified and no guarantee, warranty or representation, either express or implied, is made with respect to such information. Terms of sale or lease and availability are subject to change or withdrawal without notice.

**NEWMARK**