

# FOR LEASE ARBOR BLOCKS

BUILT-OUT RESTAURANT SPACE

333 8th Ave N, Suite 107, Seattle, WA 98109



For more information please contact:

LAURA MILLER

[laura@gibraltarusa.com](mailto:laura@gibraltarusa.com)

206.351.3573

333 8TH AVE N, SUITE 107, SEATTLE, WA 98109

## 2ND GENERATION RESTAURANT SPACE



### PROPERTY HIGHLIGHTS

- Prime, high visibility corner, 2nd generation quick-serve restaurant space in the heart of South Lake Union
- Display kitchen features 14' Type 1 hood and walk-in cooler
- Seating capacity 26: inside plus 8 sidewalk
- 27 public parking stalls (validation program available), monthly garage parking \$300/stall
- Surrounding businesses include Hangang Ramen (coming soon), MOOV Pilates, EVOKE Cafe Bar, Jack's BBQ, Thomas Street Warehouse, Fresh Flours, and Tous les Jours
- 1,421 SF
- Do not disturb existing tenant; call for details on the equipment package
- Rental Rate: \$48/SF plus 2026 NNN (\$7.09) = \$6,523.57 per month



90

TRANSIT SCORE



97

WALK SCORE



84

BIKE SCORE



197,644

TOTAL POPULATION



117,572

TOTAL HOUSEHOLDS



\$118,468

MEDIAN INCOME

\* 2025 demographics based on a 2-mile radius (Costar)

333 8TH AVE N, SUITE 107, SEATTLE, WA 98109

2ND GENERATION RESTAURANT SPACE



333 8TH AVE N, SUITE 107, SEATTLE, WA 98109

2ND GENERATION RESTAURANT SPACE

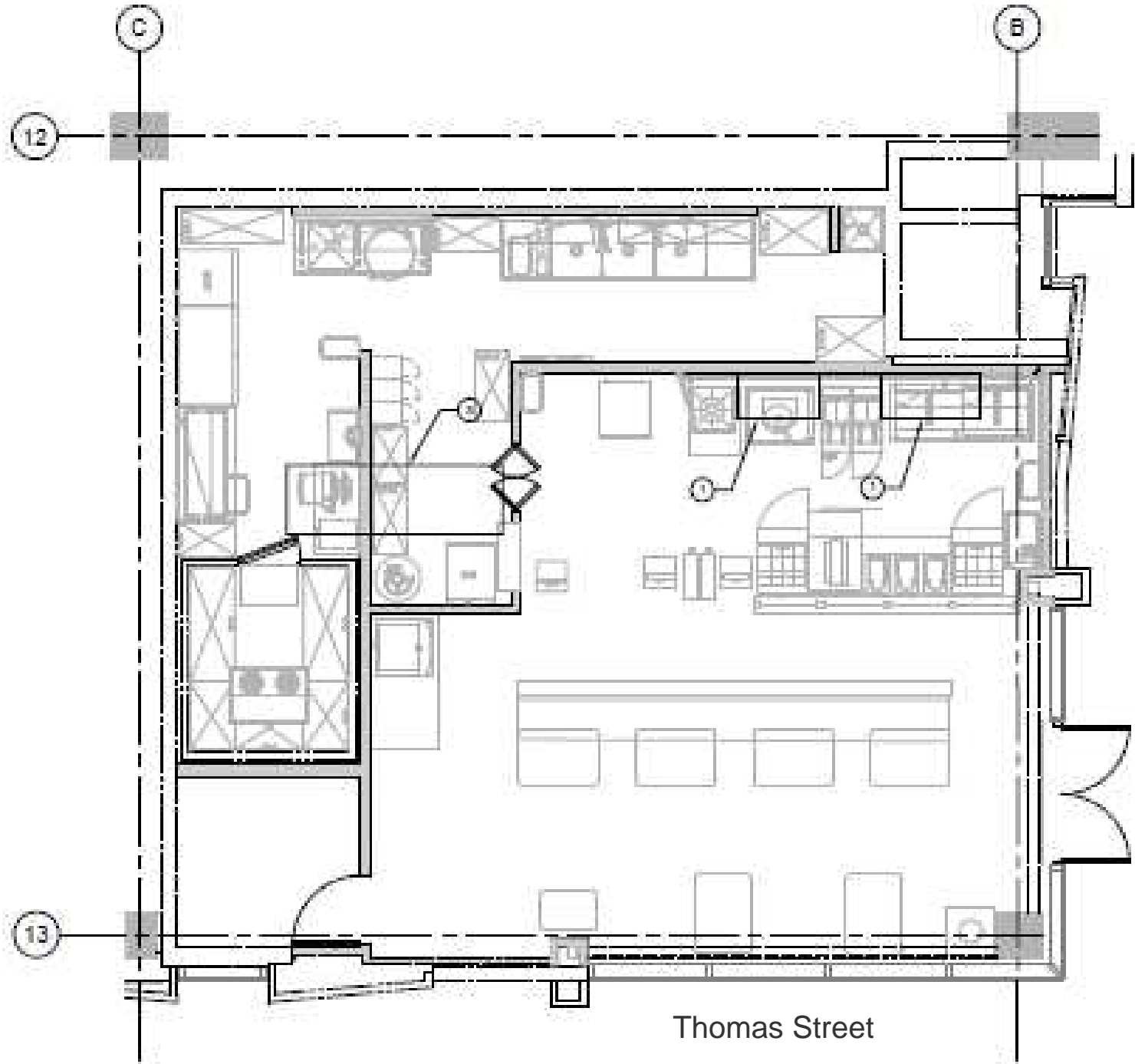

8th Avenue N

Thomas Street

333 8TH AVE N, SUITE 107, SEATTLE, WA 98109

## 2ND GENERATION RESTAURANT SPACE

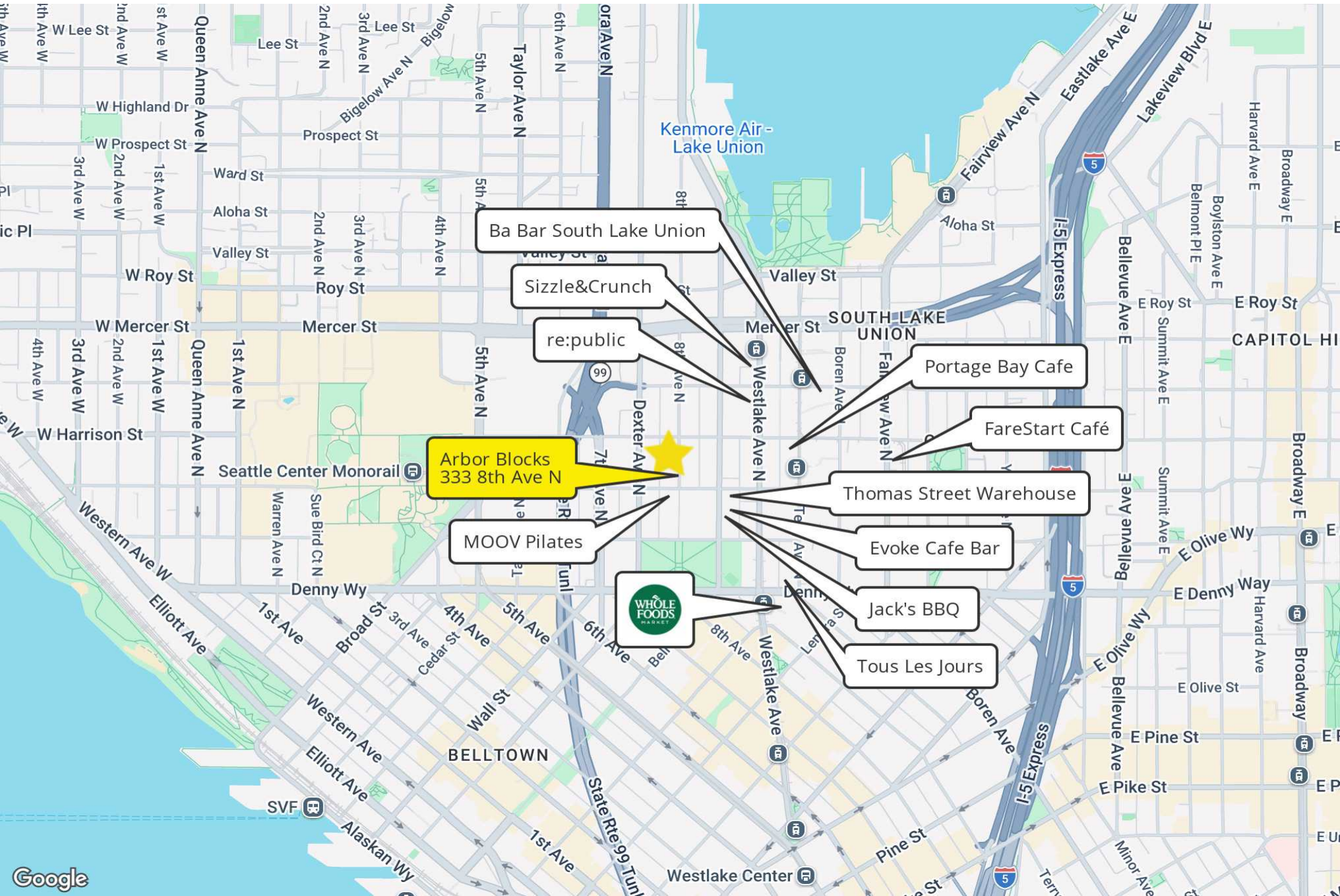

Ba Bar South Lake Union

Sizzle&Crunch

re:public

Portage Bay Cafe

FareStart Café

Arbor Blocks  
333 8th Ave N

Thomas Street Warehouse

MOOV Pilates

Evoke Cafe Bar



Jack's BBQ

Tous Les Jours