

BOISE, IDAHO HAS A NEW ADDRESS



# High West

BUSINESS PARK

1201 - 1409 WEST GOWEN ROAD | BOISE | IDAHO



photos as of 10/9/20



[www.highwestbusinesspark.com](http://www.highwestbusinesspark.com)

KEVIN SKILLESTAD

+1 206 715 0757

[kevin.skillestad@kbcadvisors.com](mailto:kevin.skillestad@kbcadvisors.com)

MICHAEL ROY

+1 206 940 7199

[michael.roy@kbcadvisors.com](mailto:michael.roy@kbcadvisors.com)



DEVELOPED BY





# High West

BUSINESS PARK

High West Business Park is Boise, Idaho's premier Class A Industrial destination located in the thriving Airport Submarket. High West offers state of the art industrial spaces designed to meet the demands of modern business and offers unparalleled access to major transportation hubs and a dynamic business environment. Spanning 22 acres in the Airport Submarket, the park provides up to 406,000 sf of flexible space with cutting edge features such as 36' clear heights, 7" floor slabs, LED lighting, and K-25.2 ESFR fire sprinklers. The facilities are built with efficiency and durability in mind, featuring a 60 mil TPO roof and clerestory windows to maximize natural light.

Bay sizes are designed for flexibility, with typical dimensions of 54' x 50' and speed bays of 54' x 60'. Dock doors measure 9' x 10', while drive-in doors are 12' x 14', making the park ideal for a wide range of industrial operations.

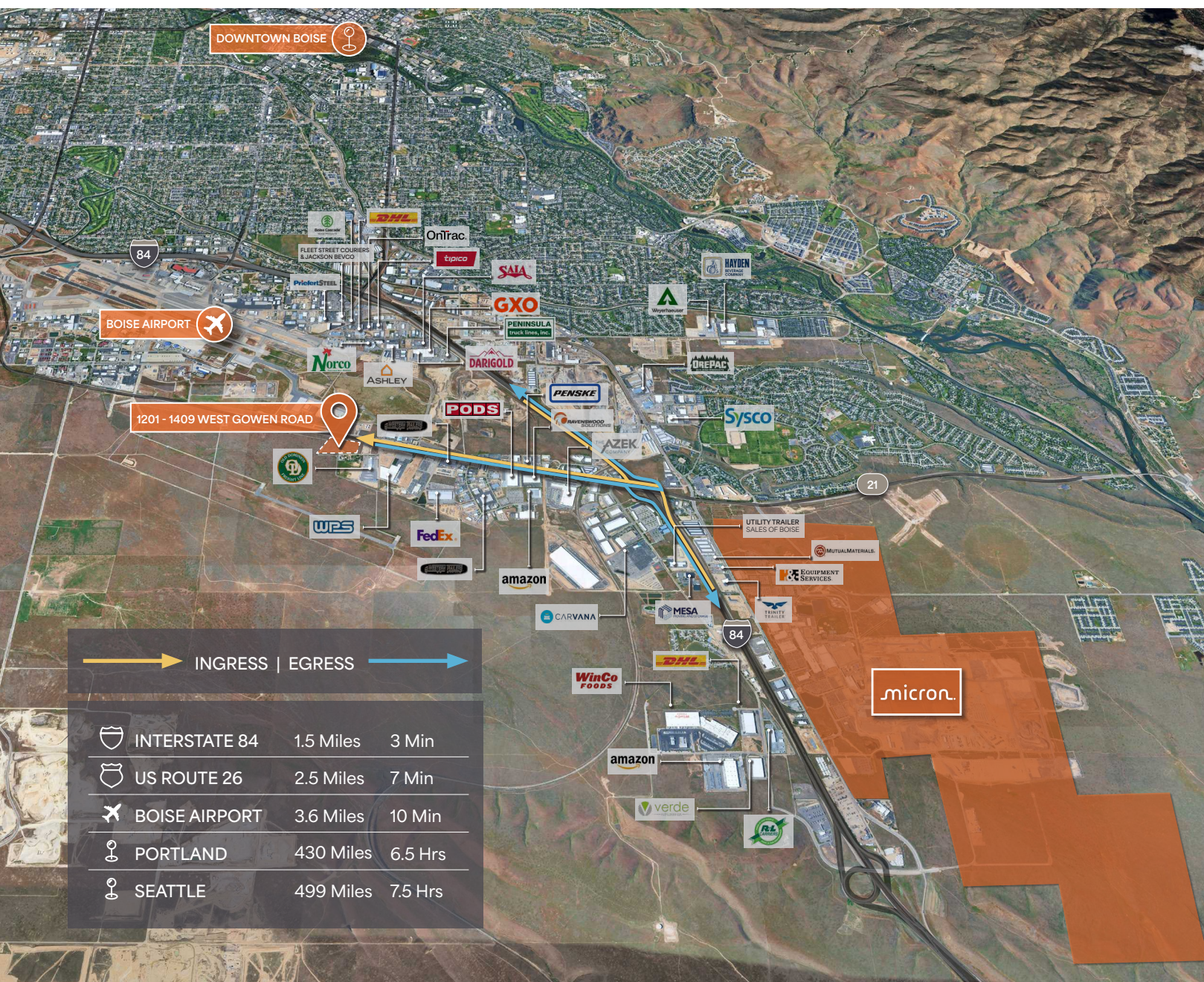

AVAILABLE NOW

CLASS A INDUSTRIAL  
75,000 - 406,000 SF



22.07 Acres



Direct Access to  
Boise Airport & I-84



The Sudler Companies has been family owned and operated for over 100 years and is based in Chatham, New Jersey. From their roots planted in 1907 to their current 9-million square foot commercial real estate portfolio, Sudler brings the personal touch of a family owned business, while also providing clients with industry leading in-house development, leasing, legal, management, construction and investment departments. Sudler meets the needs of the most discriminating commercial space users by finding the perfect match of location, building material and customization to provide businesses innovative construction solutions via first class buildings.

1201  
WEST GOWEN ROAD  
172,980 SF

1409  
WEST GOWEN ROAD  
233,456 SF



Developed by The Sudler Companies with a focus on innovation and sustainability, High West Business Park offers businesses the resources they need to succeed in a rapidly evolving market. Its modern infrastructure and thoughtful design make it an ideal location for industries seeking efficient, high-quality spaces that support growth and productivity.

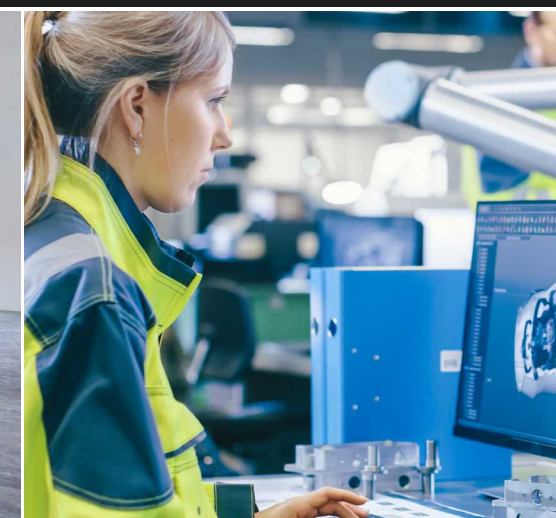
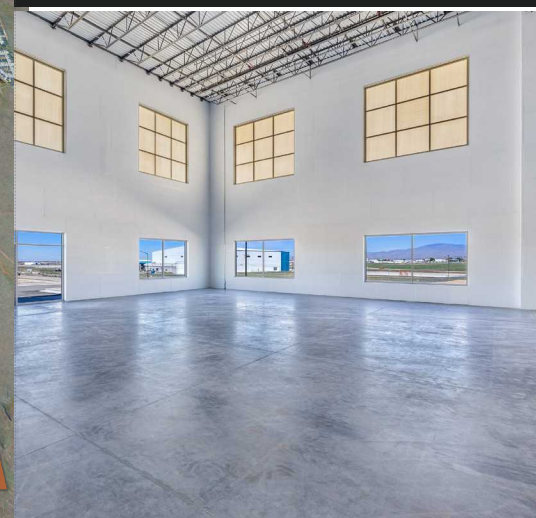

### SITE DESCRIPTION

- Over 22 Acres
- Up to 406K SF Available
- Direct Access To Boise Airport
- 1.5 Miles to Route 84

### BUILDING SPECIFICATIONS

- 36' Clear Height
- 7" Floor Slab
- LED Lighting System
- K-25.2 ESFR Fire Sprinklers
- 60 mil Roof TPO
- 54' x 50' Bay Size, Typical
- 54' x 60' Speed Bay Size, Typical
- 9' x 10' Dock Doors
- 12' X 14' Drive-in Doors
- Clerestory Windows Throughout
- 40k Mechanical Dock Levelers
- Total R Value
  - Roof - 30, Wall - 13, Floor - 10
- Building 1409 | 360' x 648'
- Building 1201 | 320' x 540'

### UTILITIES



**WATER**  
Veolia Water Idaho, Inc.  
3" Domestic, 12" main in road

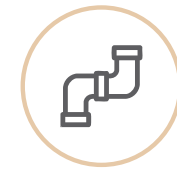

**SEWER**  
City of Boise Public Works



**GAS**  
Intermountain Gas  
Company Natural Gas



**ELECTRIC**  
Idaho Power  
3.7 MW or 4,000 +/-  
Amps For Site



**TELCOM**  
Fiber  
Available

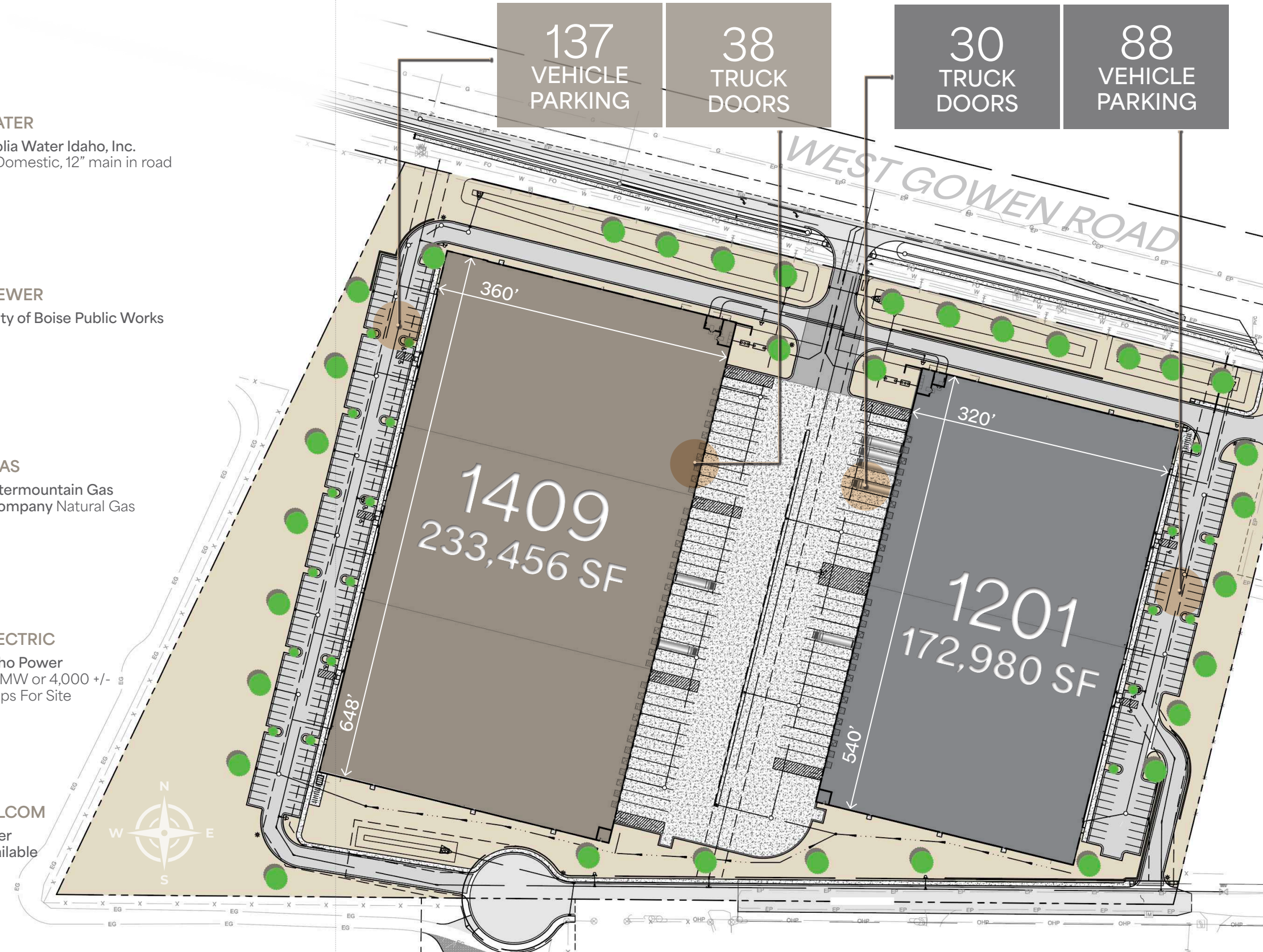



1409 WEST GOWEN ROAD

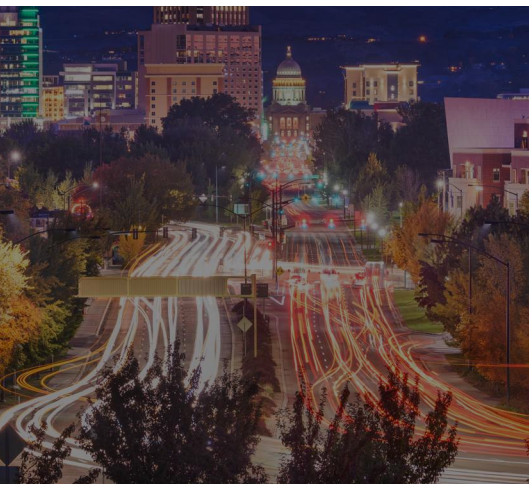

The local Boise economy has seen robust growth over the last five years, spurred largely by the region's expanding population. The growth of the Treasure Valley has brought in large corporations looking to invest in the area. Including...

**micron**

\$15 billion expansion, This new semiconductor fabricator is projected to bring 2,000 new Micron jobs and 15,000 indirect jobs to the Boise area.

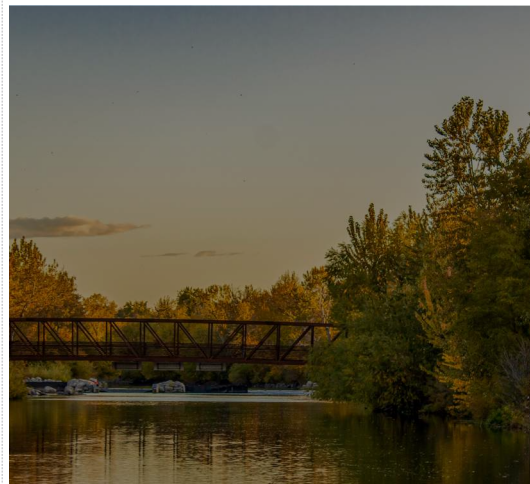

**∞ Meta**

New data center in Kuna, an \$800 million project projected to bring more than 100 direct jobs to the area.

Boise, Idaho is an ideal location for an industrial and commercial business park, offering central access to key distribution hubs and major transportation networks. Its strategic position within the Pacific Northwest ensures efficient logistics, making it a prime spot for businesses seeking strong regional connectivity.



1201 WEST GOWEN ROAD

**VOTED IN 2024**  
as one of the best  
mid-sized cities in  
the U.S., the capital  
of Idaho offers a  
low cost of living,  
many fun outdoor  
activities, and a  
thriving arts and  
culture scene.

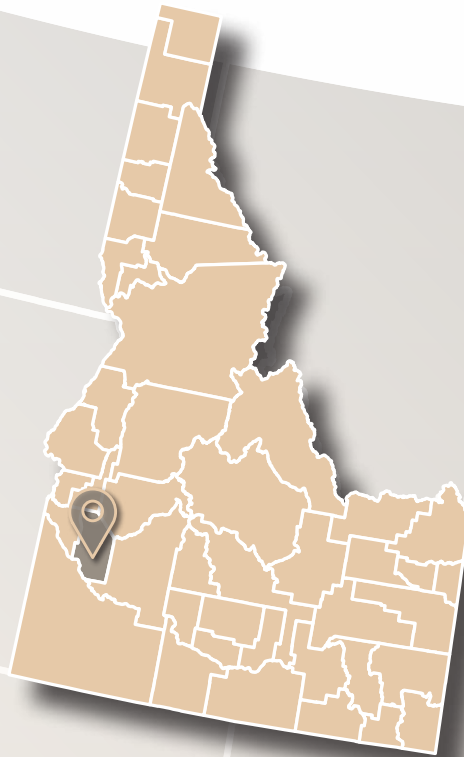

**BOISE, IDAHO HAS A NEW ADDRESS**



# High West

**BUSINESS PARK**

**1201 - 1409 WEST GOWEN ROAD | BOISE | IDAHO**

**KEVIN SKILLESTAD**

+1 206 715 0757

kevin.skillestad@kbcadvisors.com

**MICHAEL ROY**

+1 206 940 7199

michael.roy@kbcadvisors.com



**DEVELOPED BY**



© 2026 KBC ADVISORS This information has been obtained from sources believed to be reliable but has not been verified for accuracy or completeness. You should conduct a careful, independent investigation of the property and verify all information. Any reliance on this information is solely at your own risk. The KBC ADVISORS logo is a service mark of KBC ADVISORS. All other marks displayed on this document are the property of their respective owners. Photos herein are the property of their respective owners. Use of these images without the express written consent of the owners is prohibited.



**KBCADVISORS.COM**