

SKYE

at
Belltown

500 Wall Street,
Seattle WA 98121



Position your business at the center of it all at Skye Belltown, a premier retail opportunity in the heart of downtown Seattle.

Located along one of the city's most recognizable corridors, this space benefits from exceptional visibility, strong pedestrian traffic, and immediate proximity to major office towers, luxury hotels, and top-tier dining.

Surrounded by a dynamic mix of professionals, residents, and tourists, Skye Belltown offers retailers an ideal setting to capture consistent daily foot traffic as well as peak evening and weekend activity. Its central location provides seamless access to transit and walkable connectivity to some of Seattle's most iconic destinations.

With its vibrant urban energy and prime location, take advantage of the opportunity to establish your brand here!



SITE PLAN

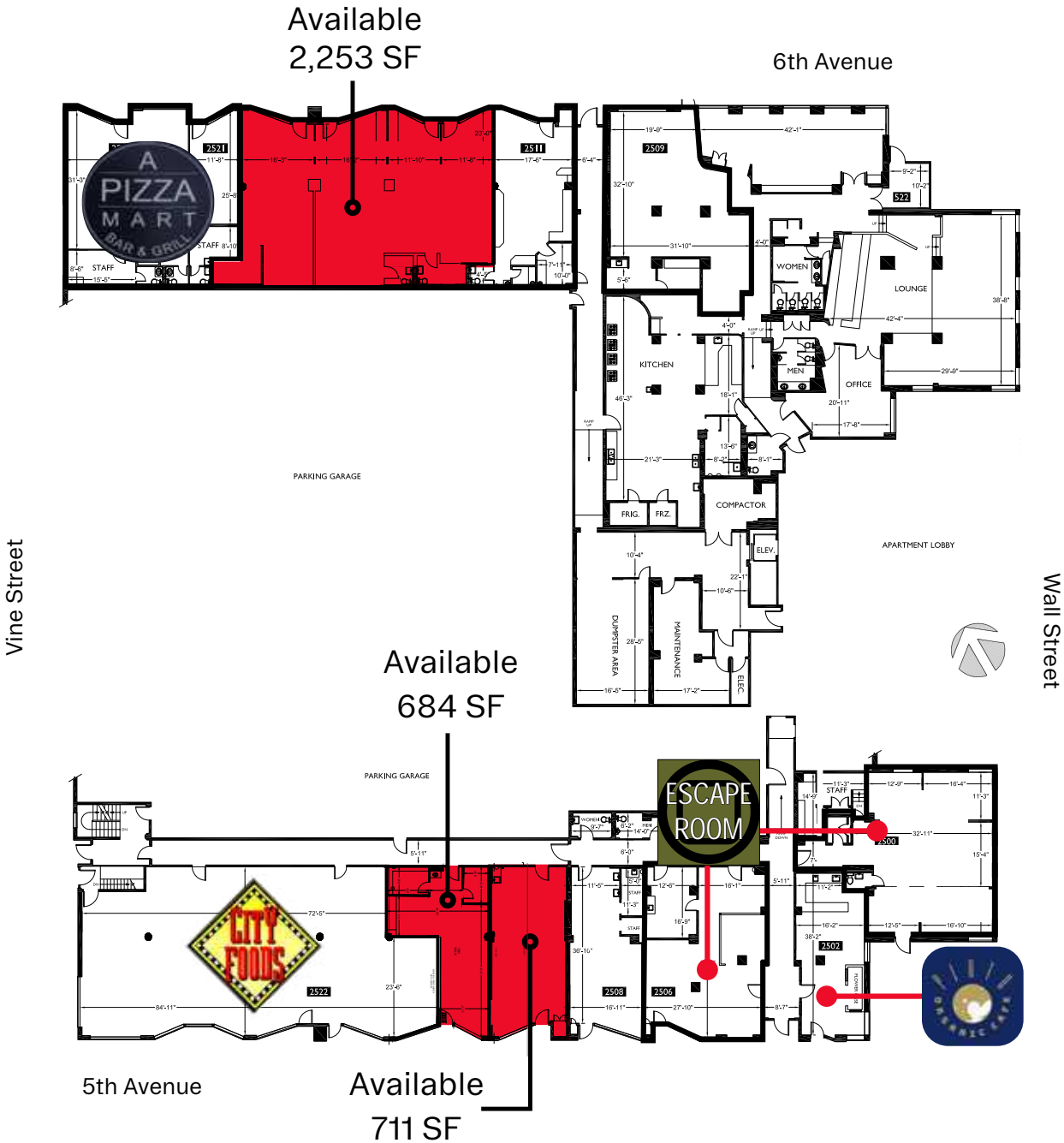

Demographics



AVERAGE HOUSEHOLD INCOME:

- 1-Mile: \$112,589
- 2-Mile: \$113,986
- 3-Mile: \$122,505



POPULATION:

- 1-Mile: 55,806
- 2-Mile: 138,389
- 3-Mile: 226,088



EMPLOYEES:

- 1-Mile: 161,818
- 2-Mile: 275,625
- 3-Mile: 332,492

98
Walk Score
"Walker's Paradise"

100
Transit Score
"Rider's Paradise"



SKYE

at
Belltown

500 Wall Street,
Seattle WA 98121

Tiffini Connell

tiffini@wccommercialrealty.com
206 854 1925

Avery Connell

avery@wccommercialrealty.com
206 475 9637

DISCLAIMER: The above information has been secured from sources believed to be reliable, however, no representations are made to its accuracy. Prospective tenants or buyers should consult their professional advisors and conduct their own independent investigation. Site plan and configuration are subject to change. Properties are subject to change in price and/or availability without notice. West Coast Commercial Realty, LLC

MEMBER OF  **SOURCE**   
RETAIL BROKER NETWORK

WCCR | West Coast
Commercial
Realty

206 283 5212
wccommercialrealty.com

