

FOR SUBLEASE

10700 NORTHUP WAY | BELLEVUE, WA 98004

# 10700 BUILDING



SPACE

# HIGHLIGHTS

- + Master Lease Expires July 31, 2028
- + Shorter term subleases considered.
- + Plug and Play ready with furniture available
- + Parking ratio: 4.58 / 1,000 RSF (surface and covered available)
- + Centrally located between Downtown Kirkland and Downtown Bellevue
- + Easy access to SR-520 & I-405

## 1<sup>ST</sup> FLOOR SPACE AVAILABLE

100 + 110  
SUITES

3,485 - 22,194  
RSF



## ADDITIONAL FEATURES



Fitness center + showers



Adjacent to the Cross Kirkland Corridor trail



520 Bike Trail



Located next to South Kirkland Park and Ride



Close proximity to Kirkland amenities such as Carillon Point and the Lake Washington waterfront



# AS-BUILT FLOOR PLAN

AVAILABLE WITH  
+/- 90 DAYS NOTICE  
**SUITE  
100**  
18,709 SF

AVAILABLE NOW  
**SUITE  
110**  
3,485 SF

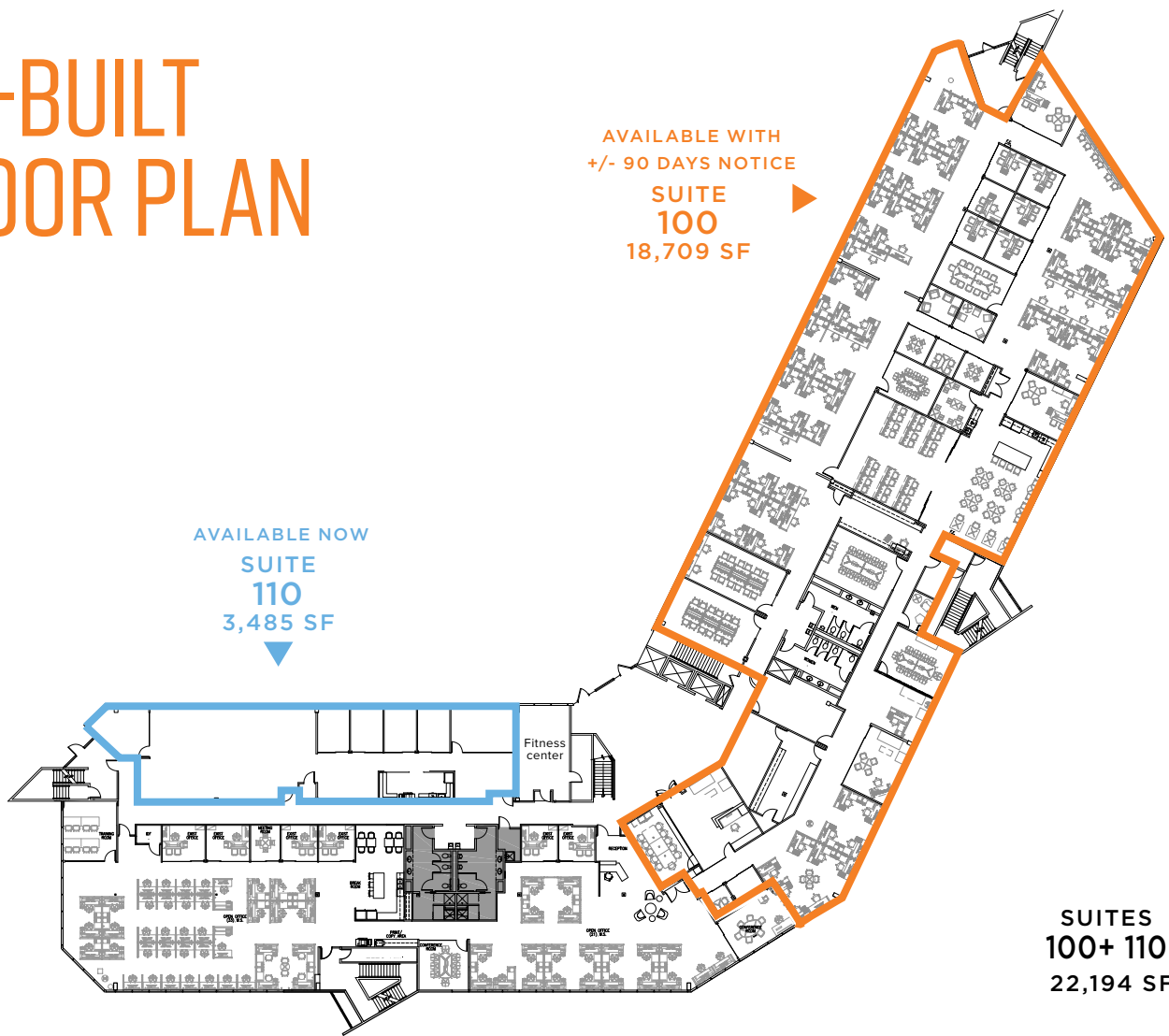

**SUITES  
100+ 110**  
22,194 SF



**Sam Ziemba**  
+1 425 974 4005  
sam.ziemba@jll.com

**Jake Bos**  
+1 425 974 4086  
jake.bos@jll.com

**Bailey Hallis**  
+1 425 974 4009  
bailey.hallis@jll.com

