

Avidex Building

13555 NE Bel-Red Rd Bellevue, WA 98005



FOR LEASE

Service Retail Space for Lease

Josh Heyum
Principal
425.445.5799
josh@vistapacif icgroupinc.com

Jake Staniszewski
Broker
425.284.4270 ext. 1009
jake@vistapacif icgroupinc.com



Avidex Building

13555 NE Bel-Red Rd Bellevue, WA 98005

Suites	SF	Rate	Availability
202	865 SF	\$32.00/SF ~ MG	Now
206	707 SF	\$32.00/SF ~ MG	Now

Features

- Bellevue Spring District
- Private Entries
- Ample Parking
- Efficient Build-Out
- Private Restrooms



Josh Heyum
Principal
425.445.5799

Jake Staniszewski
Broker
425.284.4270 ext. 1009
jake@vistapacificgroupinc.com



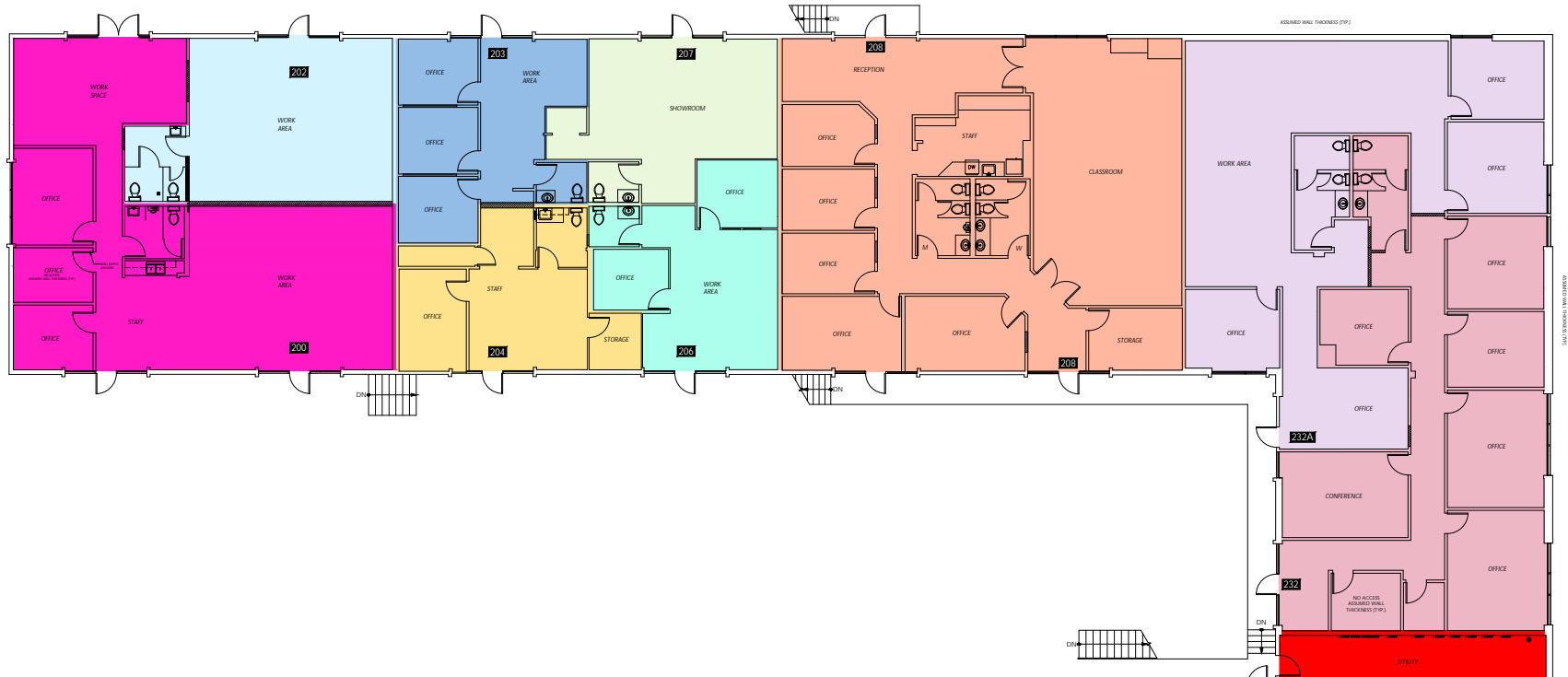

 PROPOSED WALL



	SQ. FT.	Suite #	Occupant Area	Rentable Area
Floor Summary				
Total Rentable Area	22,441.88	Suite 200	1,895.48	1,915.34
Total Occupant Area	22,209.19	Suite 202	855.81	864.78
Load Factor	1.010477	Suite 203	715.63	723.13
		Suite 204	688.75	695.97
		Suite 206	699.53	706.86
		Suite 207	657.70	664.59
		Suite 208	2,906.81	2,937.26
		Suite 226-230	9,713.44	9,815.21
		Suite 232	2,050.84	2,072.33
		Suite 232A	2,025.19	2,046.41
Floor Service Area	0			
Building Service Area	339.50			
Total Vertical	0			