



Jon-Don

Jon-Don
DELIVERY
IN REAR

FOR LEASE

21,600 SF AVAILABLE

4111 AIRPORT WAY S

SEATTLE, WA 98108



**CUSHMAN &
WAKEFIELD**

PROPERTY FEATURES

- Available Now
- 21,600 SF Available
- Divisible to 10,800 SF
- Mezzanine Office
- 3 Dock High Doors
- 2 Grade Level
- Contact Brokers for Rates



SITE PLAN

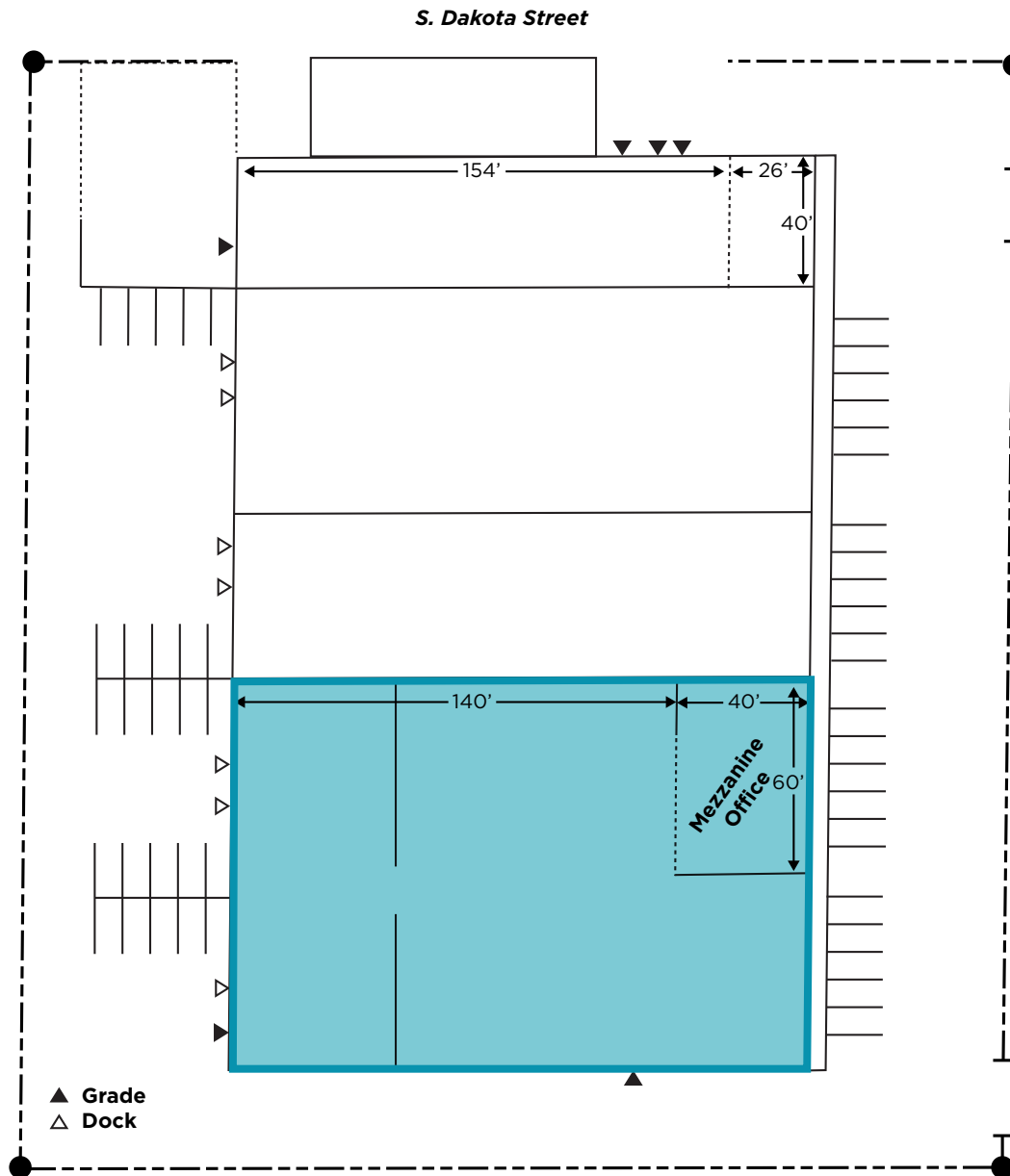



FOR MORE INFORMATION, CONTACT:

ANDREW SHULTZ

Senior Director
+1 206 215 1645
andrew.shultz@cushwake.com

SCOTT ALAN, SIOR

Executive Managing Director
+1 206 521 0236
scott.alan@cushwake.com

CUSHMAN & WAKEFIELD

601 Union Street, Suite 1100
Seattle, WA 98101
cushmanwakefield.com

©2026 Cushman & Wakefield. All rights reserved. The information contained in this communication is strictly confidential. This information has been obtained from sources believed to be reliable but has not been verified. NO WARRANTY OR REPRESENTATION, EXPRESS OR IMPLIED, IS MADE AS TO THE CONDITION OF THE PROPERTY (OR PROPERTIES) REFERENCED HEREIN OR AS TO THE ACCURACY OR COMPLETENESS OF THE INFORMATION CONTAINED HEREIN, AND SAME IS SUBMITTED SUBJECT TO ERRORS, OMISSIONS, CHANGE OF PRICE, RENTAL OR OTHER CONDITIONS, WITHDRAWAL WITHOUT NOTICE, AND TO ANY SPECIAL LISTING CONDITIONS IMPOSED BY THE PROPERTY OWNER(S). ANY PROJECTIONS, OPINIONS OR ESTIMATES ARE SUBJECT TO UNCERTAINTY AND DO NOT SIGNIFY CURRENT OR FUTURE PROPERTY PERFORMANCE.

