

# COLMAN BUILDING

811 1ST AVE | SEATTLE, WA 98104

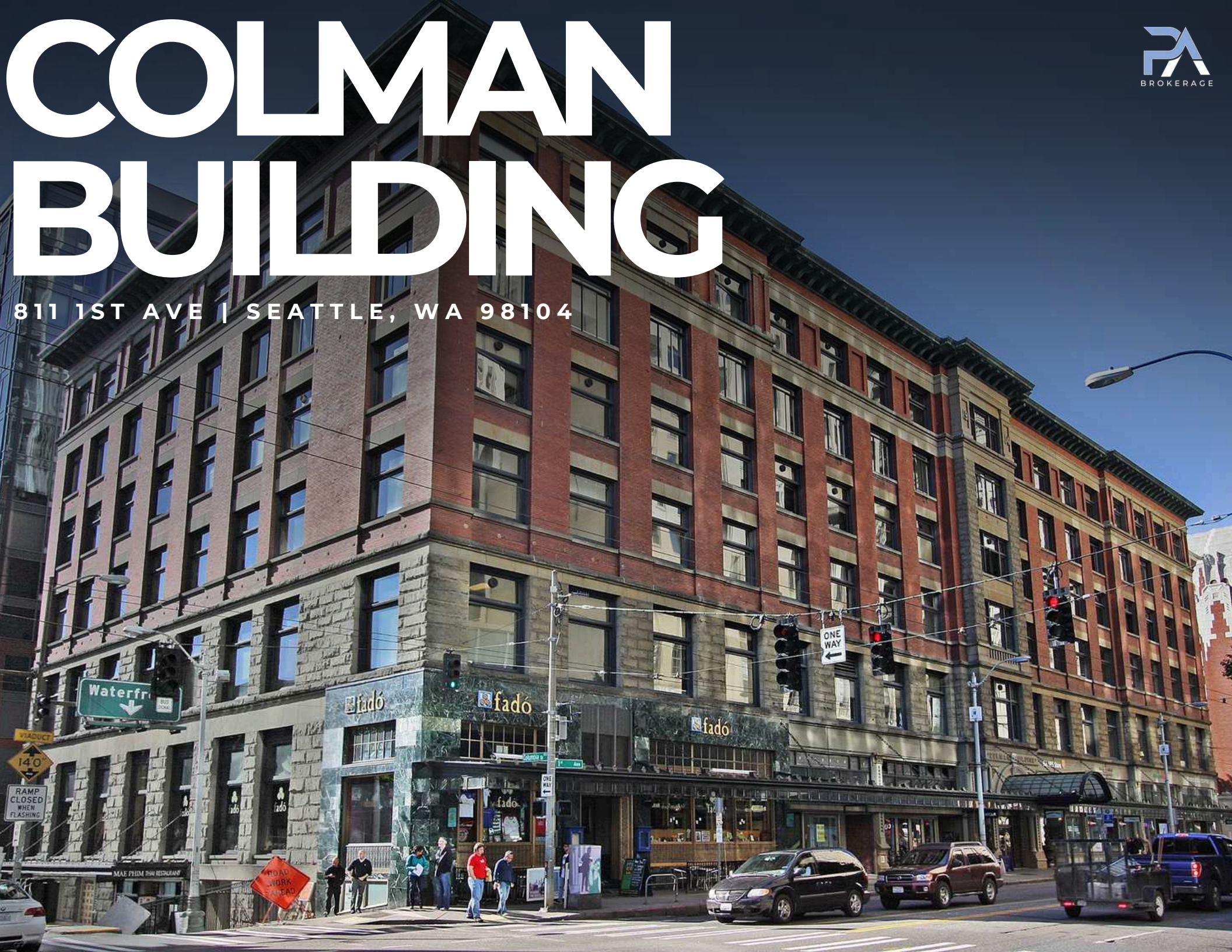

# 811 1ST AVE SEATTLE, WA 98104



## COLMAN BUILDING

The Colman Building, located in the iconic Pioneer Square neighborhood, presents a unique retail opportunity within a historic landmark. Constructed between 1889 and 1906, this six-story, 143,922 SF building is listed on the National Register of Historic Places and holds City of Seattle landmark status.

Situated near the ferry terminal, Marion Street Pedestrian Bridge, and the revitalized Seattle Waterfront, the Colman Building offers prime street-level retail spaces.

With its rich history and strategic location, the Colman Building is an ideal setting for retailers seeking to be part of Seattle's vibrant downtown community.

### AVAILABILITY

92C	818 SF	PENDING
94C	1,259 SF	
96C	987 SF	
801F	6,071 SF	PENDING
805	3,116 SF	PENDING
807	2,613 SF	PENDING
815	1,282 SF	
817	1,317 SF	
821	1,117 SF	
823F	1,218 SF	PENDING
91M	4,050 SF	PENDING

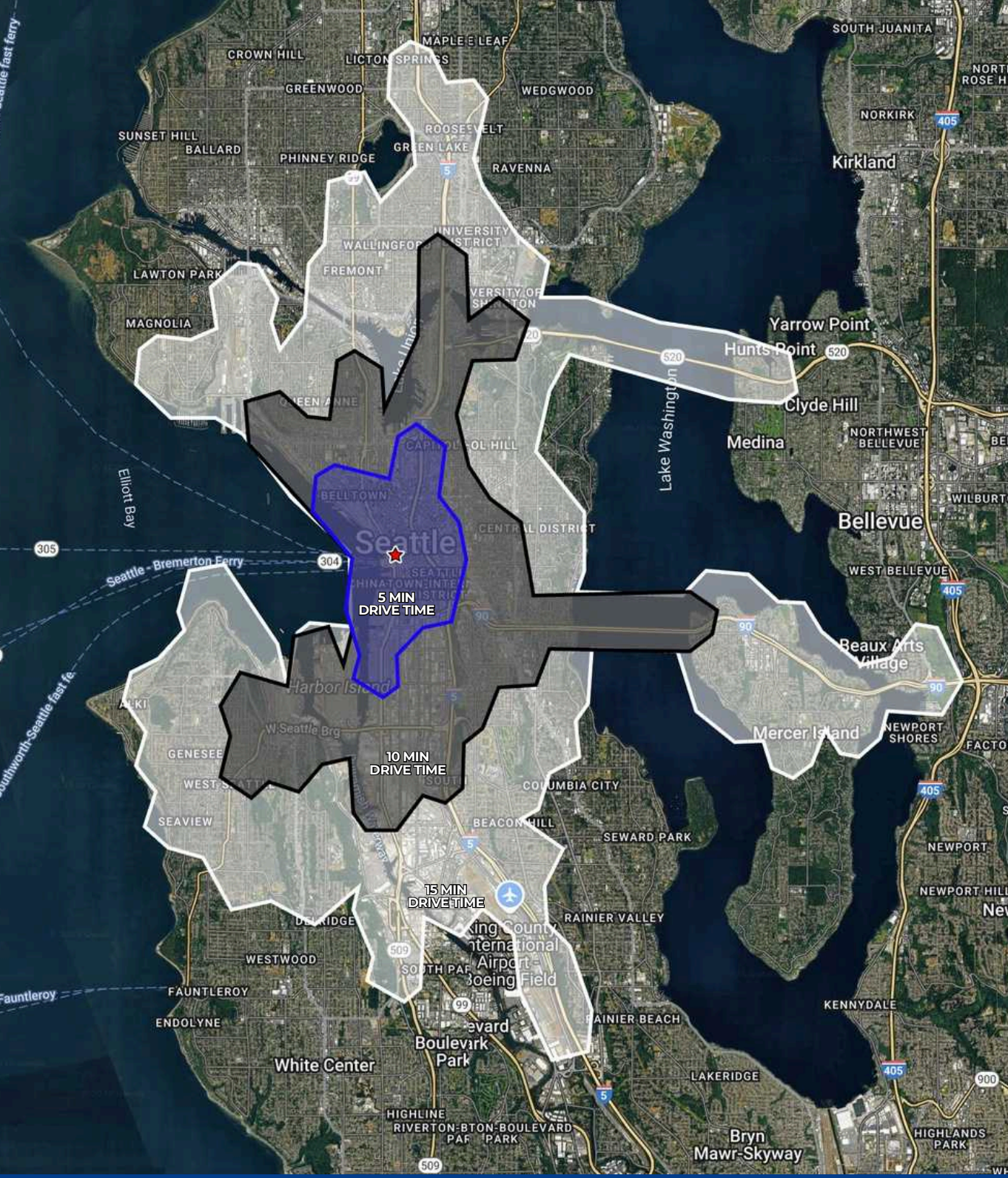

TOTAL POPULATION

**91.7K | 210.4K | 442.4K**

5 | 10 | 15 MIN DRIVE TIME

DAYTIME POPULATION

**202.4K | 323K | 487.6K**

5 | 10 | 15 MIN DRIVE TIME

TOTAL HOUSEHOLDS

**58.5K | 122.4K | 227.3K**

5 | 10 | 15 MIN DRIVE TIME

AVG. HOUSEHOLD INCOME

**\$157K | \$169K | \$183K**

5 | 10 | 15 MIN DRIVE TIME

TOTAL BUSINESSES

**12.3K | 21.6K | 36.5K**

5 | 10 | 15 MIN DRIVE TIME

TOTAL EMPLOYEES

**176.9K | 269.5K | 372.4K**

5 | 10 | 15 MIN DRIVE TIME

\*2024 PROJECTIONS FOR 5-10-15 MIN DRIVE TIMES FROM SITE. COLLECTED VIA SITESUSA



**AVAILABLE SUITES**

**92C** 818 SF  
*PENDING*

**94C** 1,259 SF

**96C** 987 SF

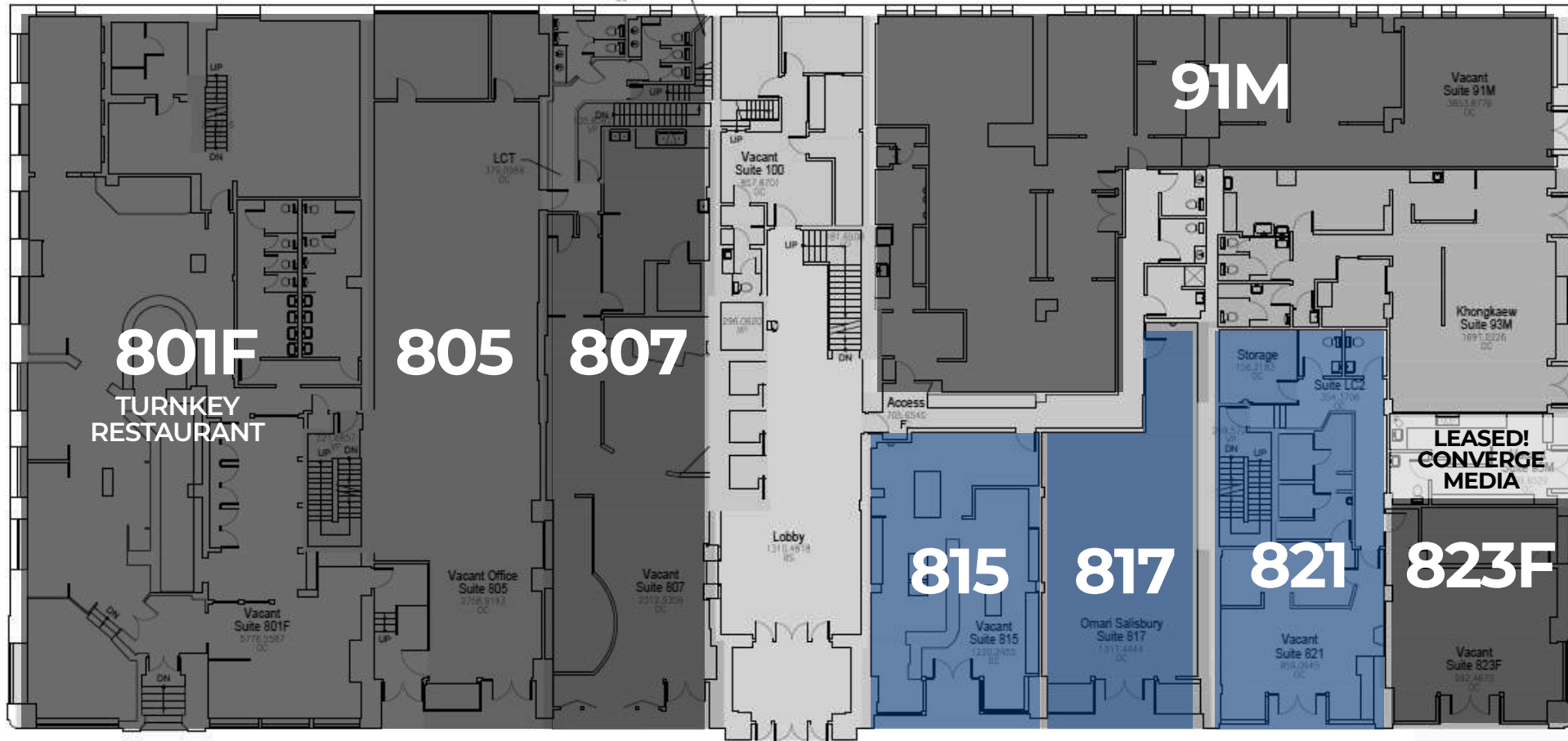

## AVAILABLE SUITES

**801F** 6,071 SF  
*PENDING* \*TURNKEY RESTAURANT

**805**  
*PENDING*

**807**  
*PENDING*

**815** 1,282 SF

**817** 1,317 SF

**821** 1,117 SF

**823F** 1,218 SF  
*PENDING*

**91M** 4,050 SF  
*PENDING*



## PIONEER SQUARE NEIGHBORHOOD

- |                                    |                              |
|------------------------------------|------------------------------|
| 1. Collins Pub                     | 14. Quality Athletics        |
| 2. Damn the Weather                | 15. Smith Tower Observatory  |
| 3. Il Terrazzo Carmine             | 16. Courtyard by Marriott    |
| 4. McCoy's Firehouse Bar & Grill   | 17. Fuji Sushi               |
| 5. Tat's Deli                      | 18. Maneki Restaurant        |
| 6. Ohsun                           | 19. 84 Yesler Seafood        |
| 7. Cone & Steiner                  | 20. Central Saloon           |
| 8. Stonington Gallery              | 21. Embassy Suites by Hilton |
| 9. Foster/White Fallery            | 22. LUMEN Field              |
| 10. The Marble Room                | 23. Shawn O'Donnell's        |
| 11. Bill Speidels Underground Tour | 24. Uwajimaya Seattle        |
| 12. Flatstick Pub                  | 25. Pioneer Square Pergola   |
| 13. 13 Coins                       |                              |

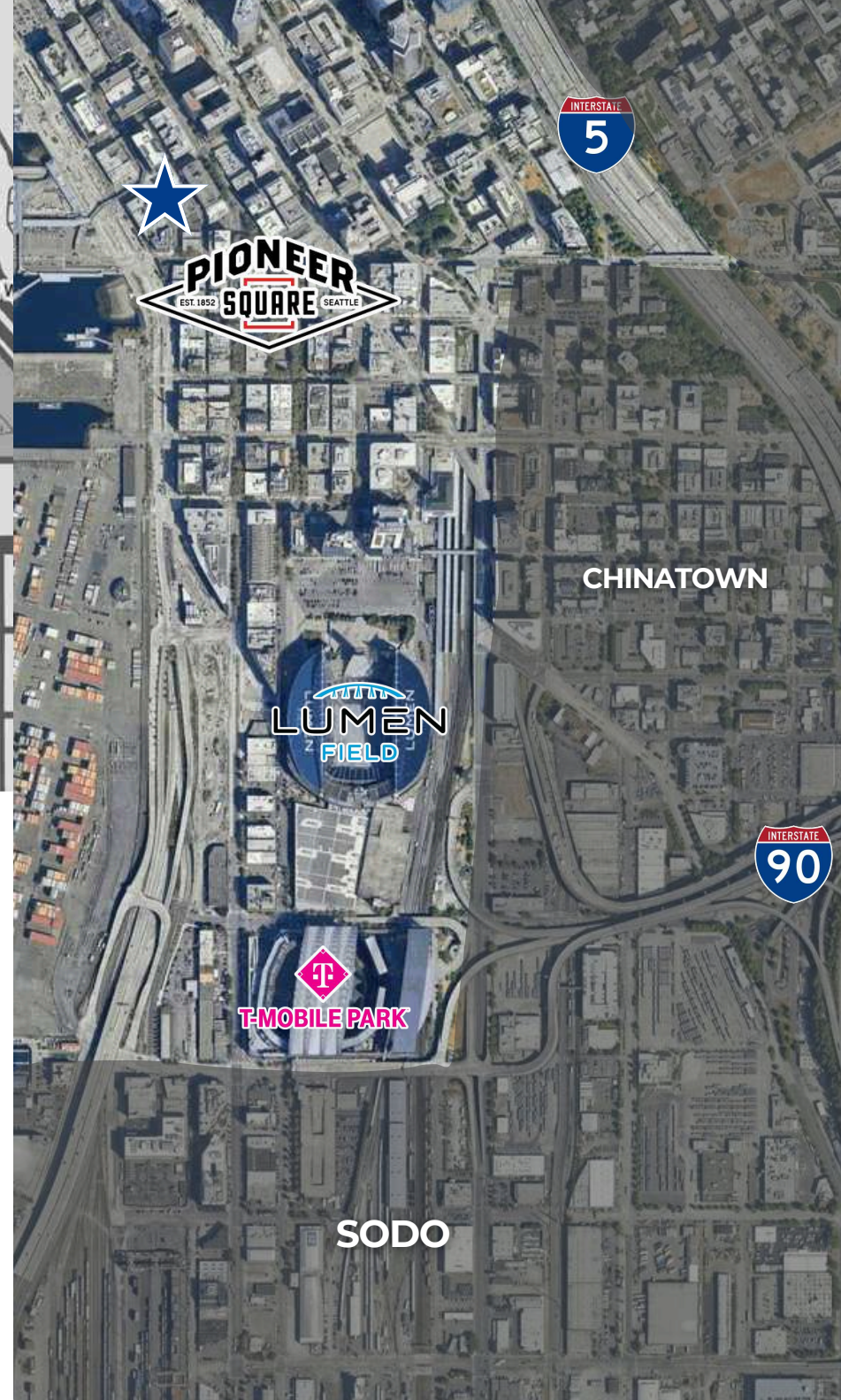



## **DAMIAN SEVILLA**

**VICE PRESIDENT**  
**DAMIAN@PAADVISORS.COM**

**206.931.9900**

## **RYAN CORNISH**

**SENIOR VICE PRESIDENT | PARTNER**  
**RYAN@PAADVISORS.COM**

**206.375.6142**

