

**FOR LEASE**

3126 NW Randall Way  
Silverdale, WA 98383



## **FREESTANDING RETAIL BUILDING**

Justin Holmes | Lucy Malone | Josh Parnell | Justice Knox

First Western Properties—Tacoma Inc. | 253.472.0404  
6402 Tacoma Mall Blvd, Tacoma, WA 98409 | fwp-inc.com

**3126 NW RANDALL WAY** is a freestanding retail building ideally positioned along NW Randall Way in Silverdale's primary retail corridor, offering strong visibility, easy access, and proximity to high-performing national co-tenants. The property sits on a well-situated commercial parcel that supports a wide range of retail uses and benefits from a robust regional customer base, providing tenants with a deep and growing consumer market in the heart of Kitsap County's dominant shopping district.

**AVAILABLE**

**11,493 SF      \$18.00 PSF + NNN PSF**

- 125' of frontage along Randall Way (excellent visibility)
- Prominent free-standing monument sign on Randall Way
- Efficient site layout with surface parking (26 stalls)
- 56 parking stalls and loading dock located onsite.
- Highly accessible location with strong consumer draw and steady traffic.



Population



Average HH Income



Daytime Population

Regis - 2026	Population	Average HH Income	Daytime Population
Mile 1	5,386	\$130,161	9,487
Mile 3	39,231	\$140,742	23,574
Mile 5	73,835	\$139,821	39,815

**NEARBY RETAIL**



**TARGET**

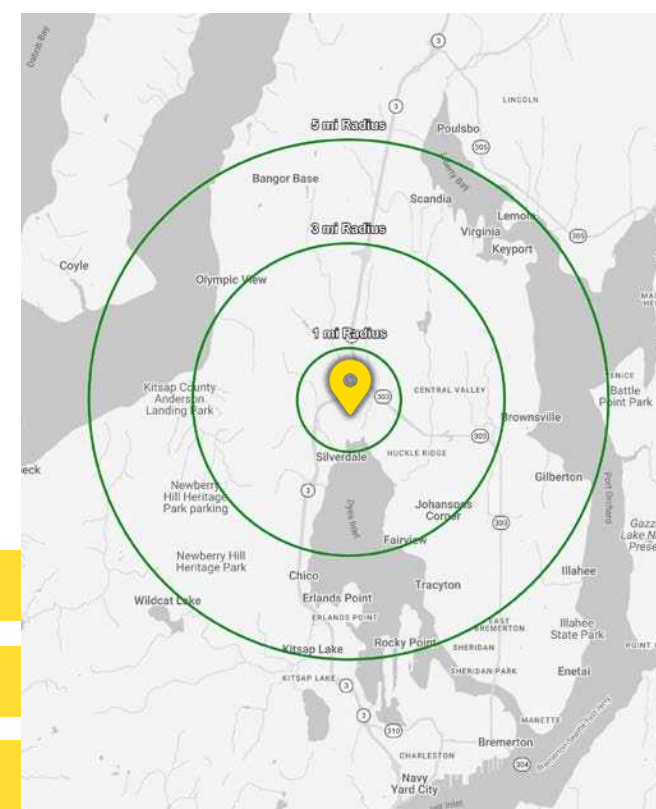

SITE PHOTOS



LOCATION AERIAL

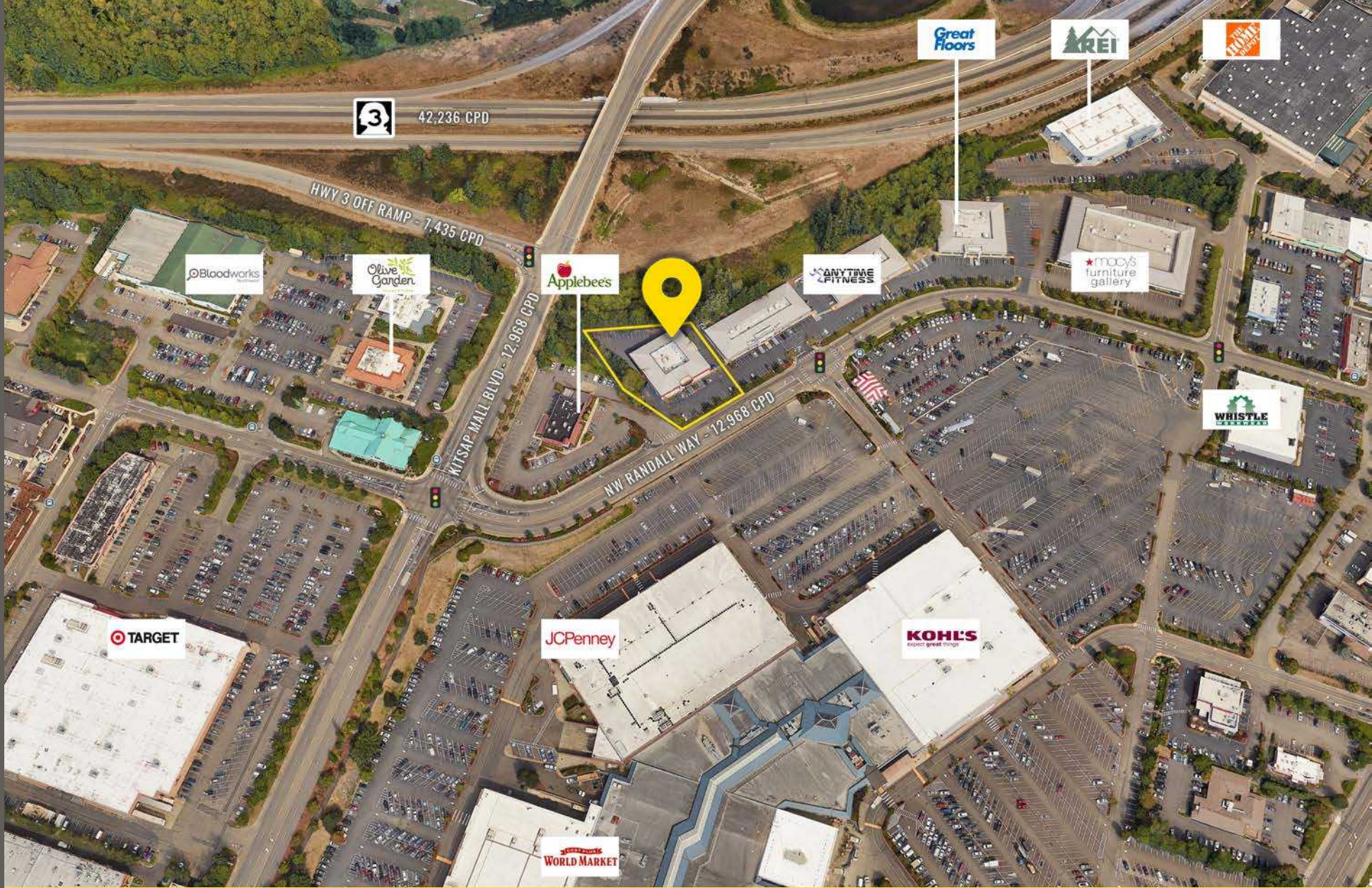

Located in the retail core  
of Kitsap County



Located moments  
from HWY 3



22,985 CPD  
Kitsap Mall Blvd NW



12,968 CPD  
NW Randall Way

LOCATION AERIAL



THE TRAILS  
at Silverdale

--	--



--	--

--	--

CENTRAL KITSAP  
HIGH SCHOOL  
1,600 STUDENTS

CENTRAL KITSAP  
MIDDLE SCHOOL  
600 STUDENTS

Virginia Mason  
Franciscan Health  
St. Michael Medical Center

DYES INLET

# SITE PLAN

SITE: 0.89 ACRE  
SEC-TWP-RNG: 16 25N 1E  
NEIGHBORHOOD: 8401101  
ZONING: RC

ADJ. PROPERTY

(E) DRIVEWAY

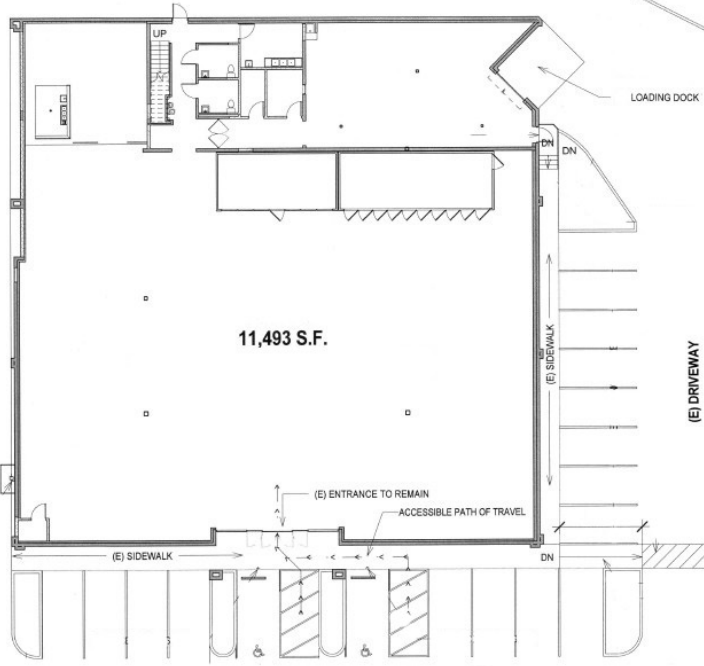

11,493 S.F.

LOADING DOCK

ADJ. BLDG.

(E) DRIVEWAY

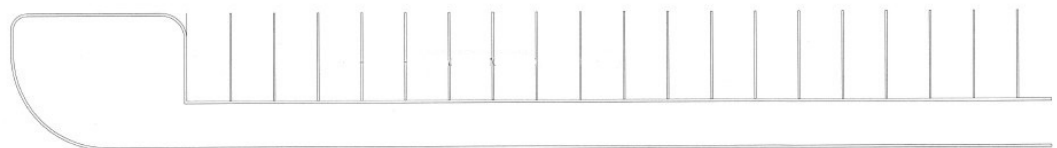

NW Randall Way

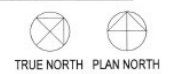

TACOMA | KIRKLAND | PORTLAND | SEATTLE

RELATIONSHIP FOCUSED.  
RESULTS DRIVEN.



**JUSTIN HOLMES**

 253.447.2282

 [justin@firstwesternproperties.com](mailto:justin@firstwesternproperties.com)

**LUCY MALONE**

 253.284.3634

 [lucy@firstwesternproperties.com](mailto:lucy@firstwesternproperties.com)

**JOSH PARNELL**

 253.284.3630

 [josh@firstwesternproperties.com](mailto:josh@firstwesternproperties.com)

**JUSTICE KNOX**

 253.471.5501

 [jknox@firstwesternproperties.com](mailto:jknox@firstwesternproperties.com)



First Western Properties - Tacoma, Inc. | 253.472.0404  
5402 Tacoma Mall Blvd, Tacoma, WA 98409 | [fwp-inc.com](http://fwp-inc.com)

© First Western Properties, Inc. DISCLAIMER: The above information has been secured from sources believed to be reliable, however, no representations are made to its accuracy. Prospective tenants or buyers should consult their professional advisors and conduct their own independent investigation. Properties are subject to change in price and/or availability without notice.