

OFFICE/FLEX/LAB SPACE FOR LEASE

# EVERETT TECHNICAL PARK I

1615 75TH STREET SW, EVERETT, WA 98203



Everett Technical Park I is a 95,000 sf two-story building located in the heart of Everett's industrial hub. The property is ideally suited for office, call center or education/training purposes. It has convenient access to transportation corridors, and is only minutes from the Boeing 777 and 787 manufacturing facilities.

## AVAILABLE SPACE

- Suite 110: 20,940 RSF
- Suite 100: 25,690 RSF
- Rental rate: \$14.00/RSF/Yr, NNN

## FEATURES

- Generous column spacing provides efficient layout options
- Ample electrical capacity
- Fiber connectivity
- Approx. 5 parking stalls per 1,000 rentable square feet
- Numerous amenities nearby
- Excellent access to SR 526 and I-5

**DEREK HEED**  
425 453 3133  
Bellevue, WA  
derek.heed@colliers.com

**GREGG RIVA**  
206 595 1525  
Bellevue, WA  
gregg.riva@colliers.com

**TALOR OKADA**  
425 492 5145  
Bellevue, WA  
talor.okada@colliers.com



OFFICE/FLEX/LAB SPACE FOR LEASE

# EVERETT TECHNICAL PARK I

1615 75TH STREET SW, EVERETT, WA 98203



**ENTIRE FIRST FLOOR: 46,630 RSF**

**SUITE 100: 25,690 RSF** - AVAILABLE 4/1/27  
(POTENTIALLY SOONER, PLEASE INQUIRE WITH LISTING BROKERS)

**SUITE 110: 20,940 RSF** - AVAILABLE IMMEDIATELY

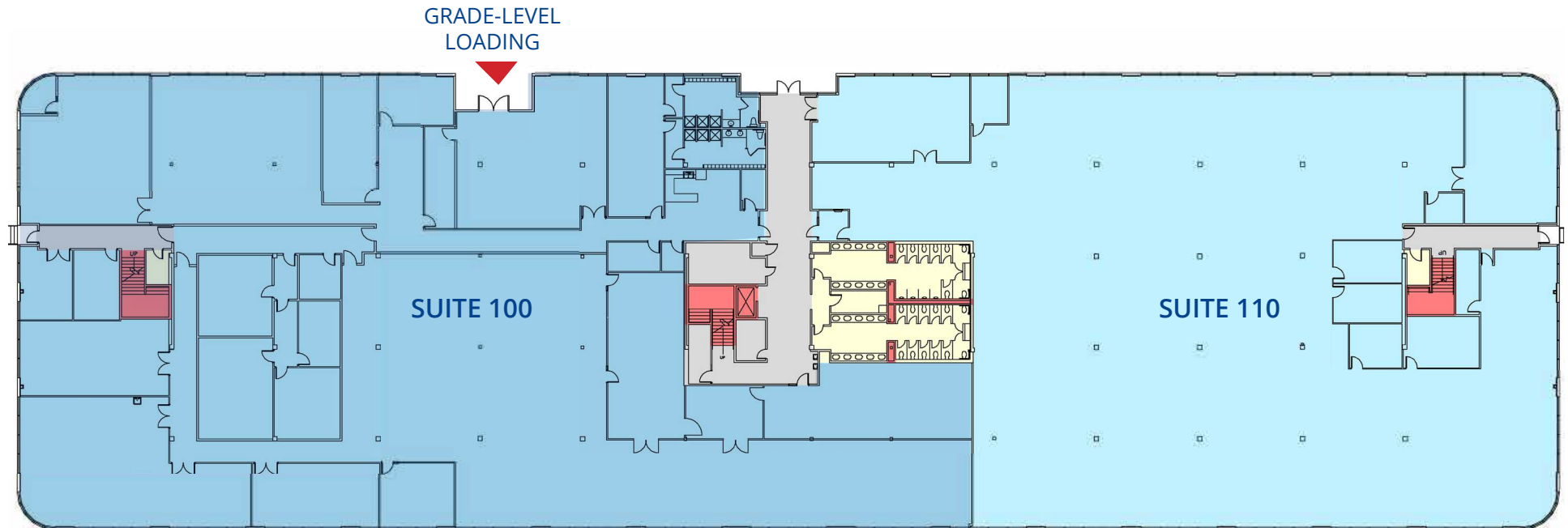

**DEREK HEED**  
425 453 3133  
Bellevue, WA  
derek.heed@colliers.com

**GREGG RIVA**  
206 595 1525  
Bellevue, WA  
gregg.riva@colliers.com

**TALOR OKADA**  
425 492 5145  
Bellevue, WA  
talor.okada@colliers.com



OFFICE/FLEX/LAB SPACE FOR LEASE

# EVERETT TECHNICAL PARK I

1615 75TH STREET SW, EVERETT, WA 98203



## Neighboring Tenants

DEREK HEED  
425 453 3133  
Bellevue, WA  
derek.heed@colliers.com

GREGG RIVA  
206 595 1525  
Bellevue, WA  
gregg.riva@colliers.com

TALOR OKADA  
425 492 5145  
Bellevue, WA  
talor.okada@colliers.com

