



# FOR LEASE

## PINEWATER PLAZA

10925 N Newport Highway | Spokane, WA 99218

**VANDERVERT**  
*Developments*

**CHAD CARPER**

509.991.2222

chad.carper@kiemleahagood.com

**KIEMLEHAGOOD**

**CHRIS BELL**

509.622.3538

cbell@naiblack.com

**NAI Black**

**SUITE 10 DETAILS**

LEASE RATE | \$20 PSF /YR (\$2,813.33 /Month) + NNN  
LEASE TYPE | NNN  
SUITE 10 SIZE | ±1,688 SF

**PAD C - LAND FOR LEASE/BUILT-TO-SUIT**

LEASE RATE | Contact Listing Broker  
LOT SIZE | ±34,066 SF (±0.78 AC)  
PROPOSED BUILDING | ±4,650 SF

**PAD D - LAND FOR LEASE/BUILT-TO-SUIT**

LEASE RATE | Contact Listing Broker  
LOT SIZE | ±26,338 SF (±0.61 AC)  
PROPOSED BUILDING | ±6,800 SF

Suites and land lease options are available at this highly visible commercial location just ¼ mile from North Spokane's Costco and directly adjacent to the Northside YMCA. The property benefits from strong traffic exposure and excellent visibility. Surrounded by established anchors and daily activity drivers, this site offers a prime opportunity for businesses seeking visibility, accessibility, and a high-traffic setting.

**CENTER ANCHORED BY:**

- Retro Donuts
- Inland Northwest Ballet
- U.S. Army Corps of Engineers:

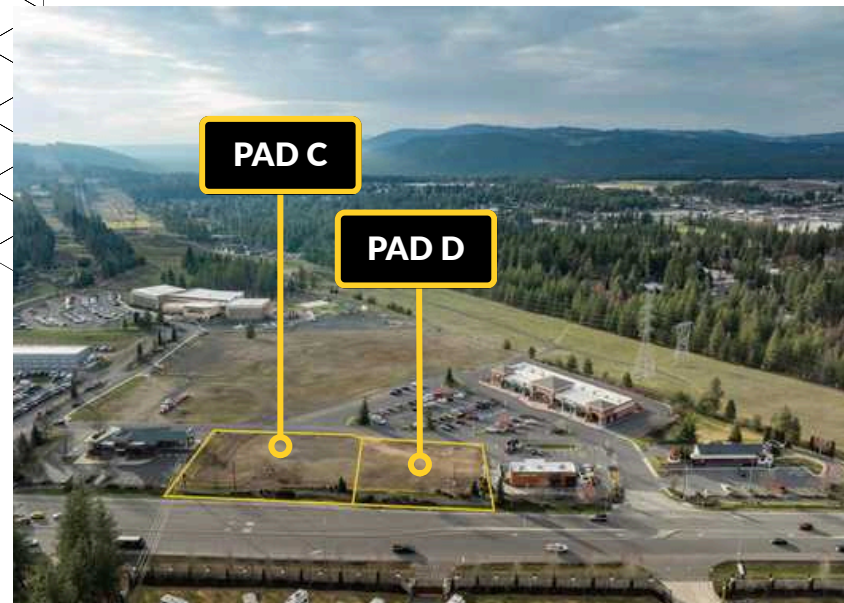



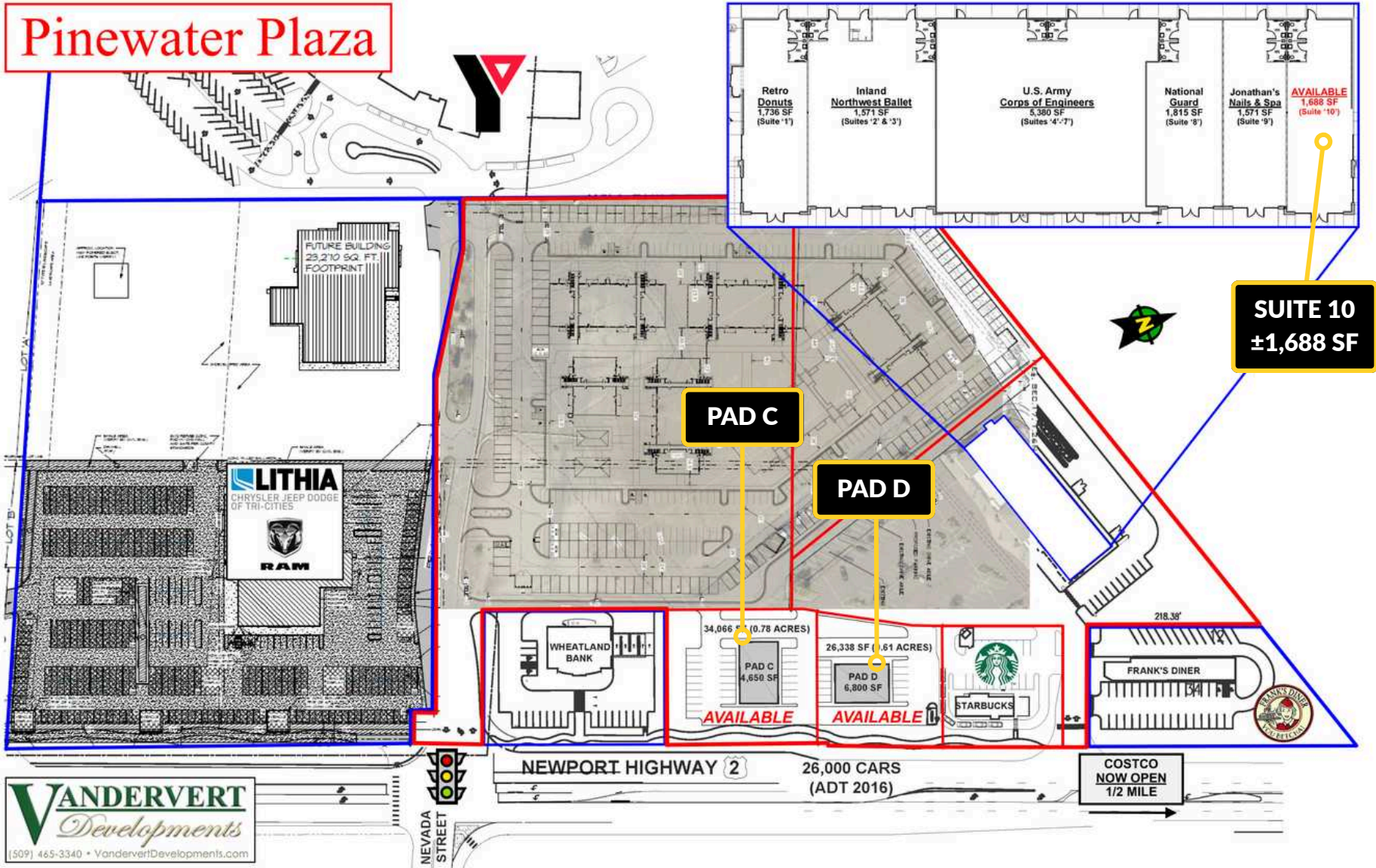

**VANDERVERT**  
*Developments*  
 (509) 465-3340 • VandervertDevelopments.com

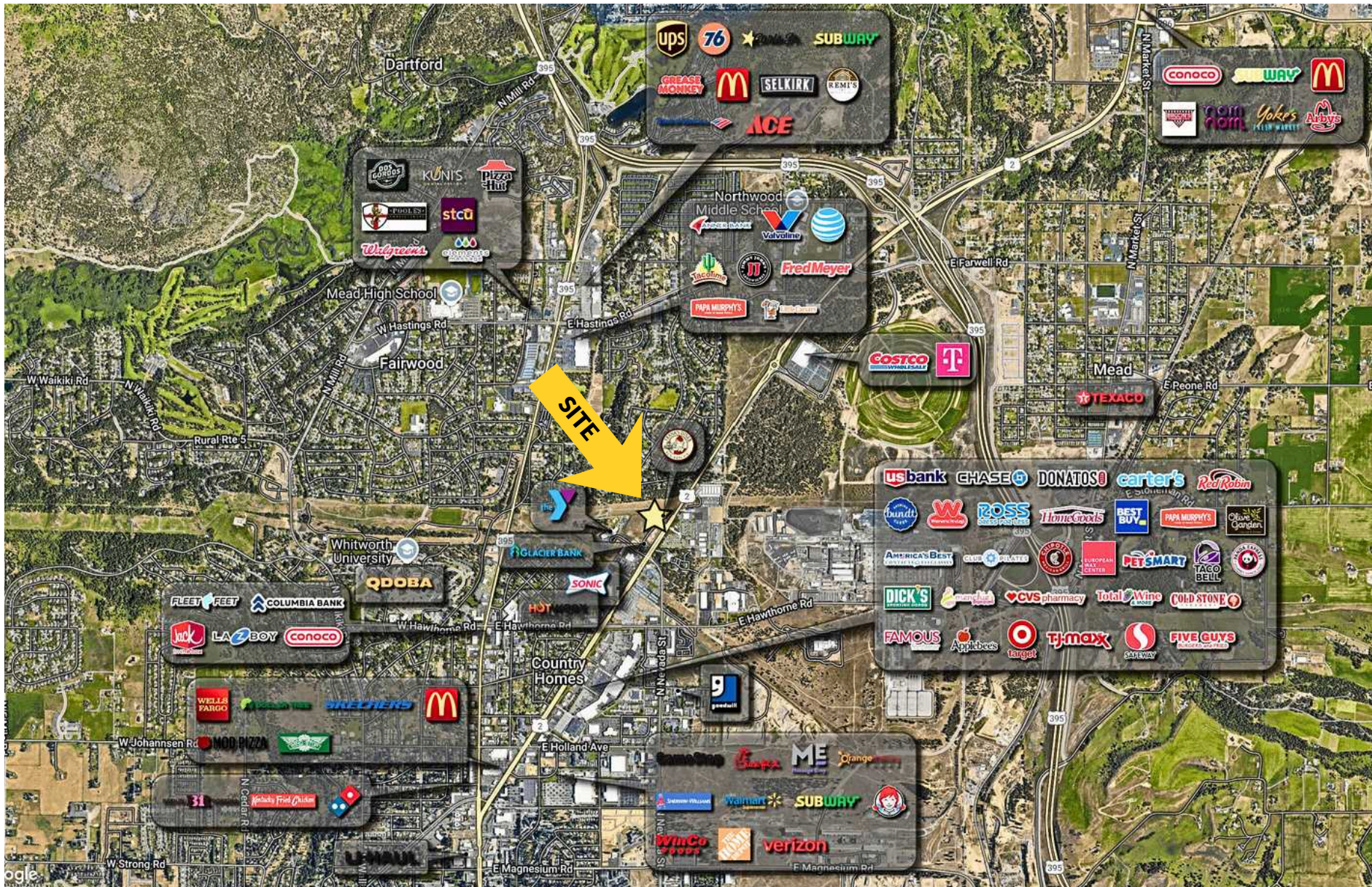

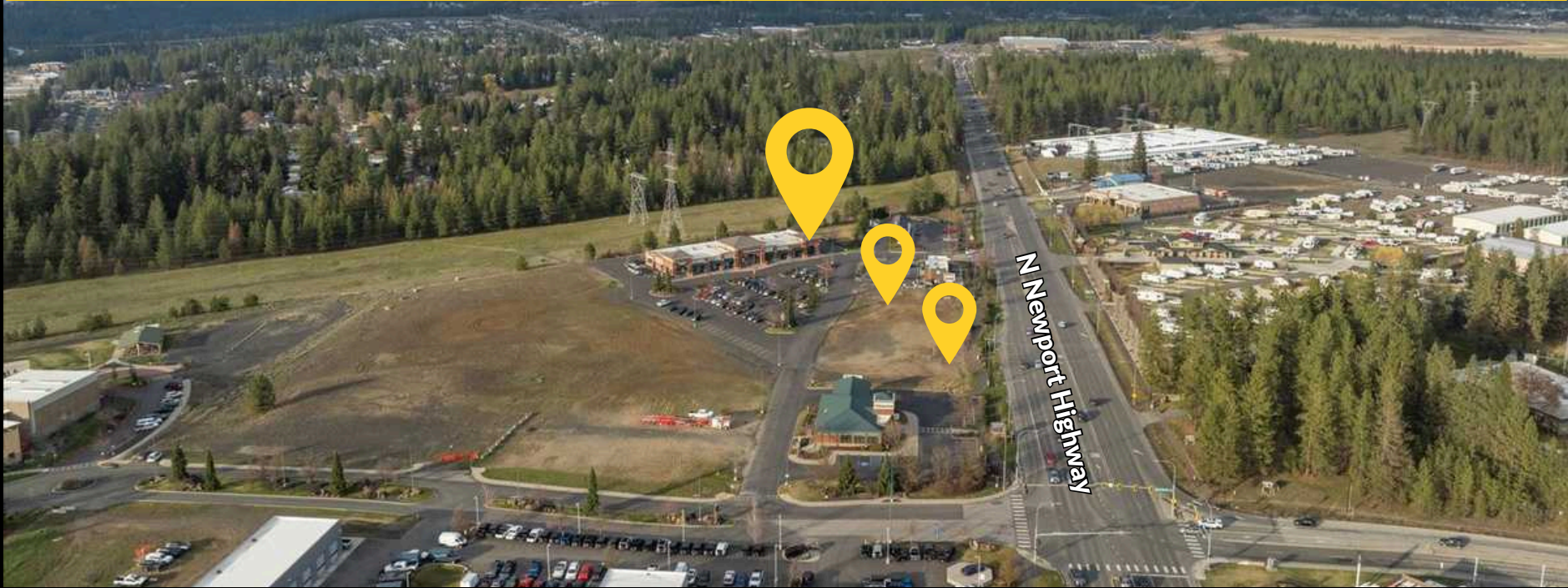

<b>DEMOGRAPHICS</b>	<b>1 MILE RADIUS</b>	<b>3 MILE RADIUS</b>	<b>5 MILE RADIUS</b>
2025 Estimate Population	7,794	54,453	141,142
2030 Projected Population	8,860	55,012	140,561
2025 Estimated Households	3,194	22,251	56,271
2025 Median Age	37.3	38.1	37.8
2025 Average Household Income	\$120,463	\$109,624	\$110,677
2025 Median Household Income	\$87,653	\$80,326	\$83,657

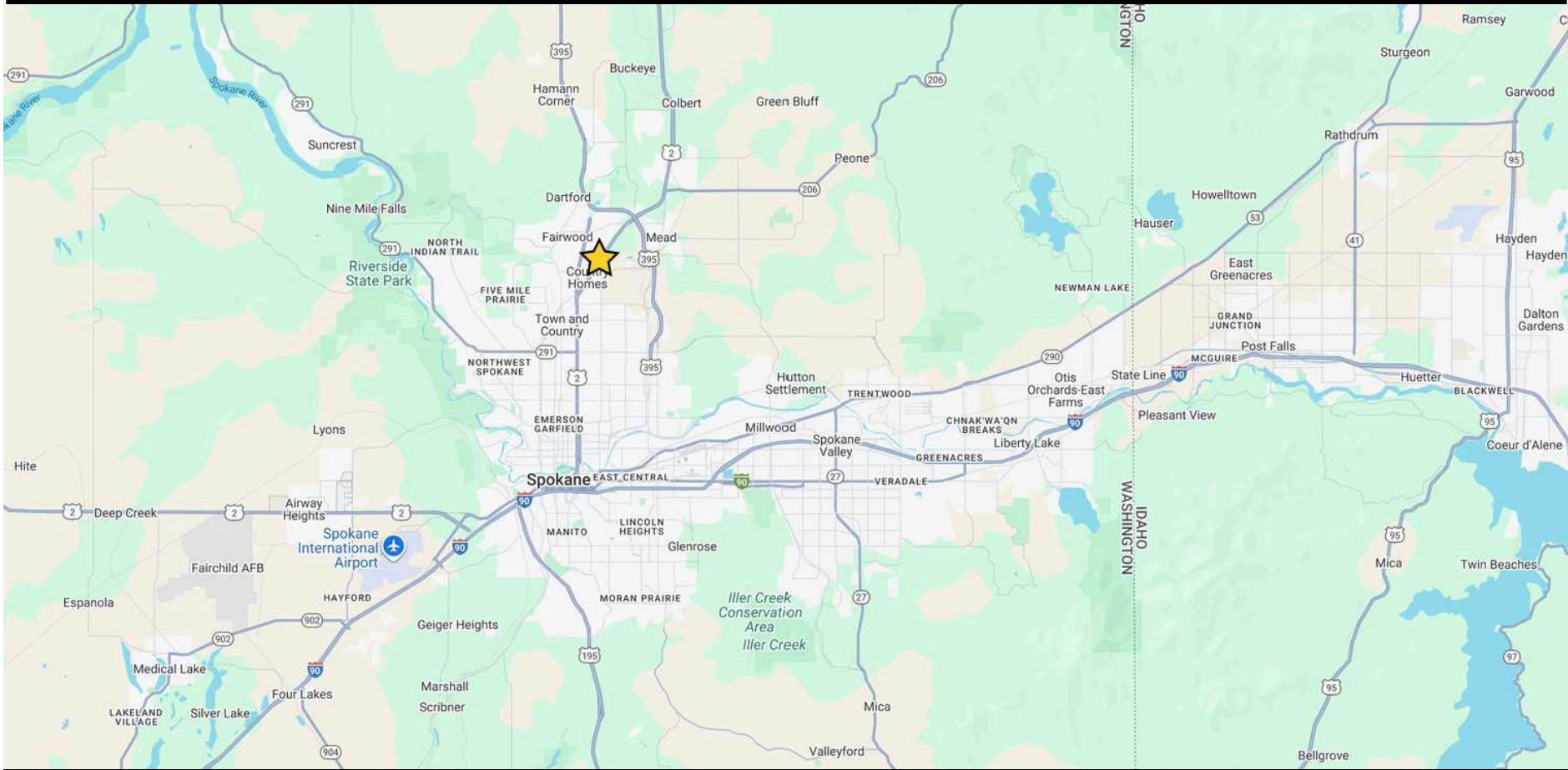

No warranty or representation, expressed or implied, is made by Kiemle Hagood, its agents or its employees as to the accuracy of the information contained herein. All information furnished is from sources deemed reliable and submitted subject to errors, omissions, change of terms and conditions, prior sale, lease or financing, or withdrawal without notice. No one should rely solely on the above information, but instead should conduct their own investigation to independently satisfy themselves.

Kiemle Hagood respects the intellectual property of others:  
 If you believe the copyright in your work has been violated through this Website, please contact our office for notice of claims of copyright infringement. For your complaint to be valid under the Digital Millennium Copyright Act of 1998 (DMCA), you must provide the following information when providing notice of the claimed copyright infringement: identify the material on the Website that you believe infringes your work, with enough detail so that we may locate it on the Website; provide your address, telephone number and email address; provide a statement that you have a good faith belief that the disputed use is not authorized by the copyright owner, its agent, or the law; provide a statement that the information in the notification is accurate, and under penalty of perjury, that the complaining party is authorized to act on behalf of owner of an exclusive right that is allegedly infringed; provide your physical or electronic signature. Upon receiving your complaint, Kiemle Hagood will, upon review, remove content that you believe infringes your copyright if the complaint is found valid.



**CHAD CARPER**  
 509.991.2222

chad.carper@kiemlehagood.com

**CHRIS BELL**  
 509.622.3538

cbell@naiblack.com

