

ONE SPACE REMAINS!



BROADSTONE VEGA | RETAIL FOR LEASE

REDMOND, WASHINGTON

16135 NE 85th Street, Redmond, WA 98052

PROJECT OVERVIEW | SUMMARY

Property Highlights

Prime Retail Space in Downtown Redmond with High Ceilings and Natural Light

Retail 2: 2,130 SF | Dentist Office

Retail 3: 973 SF | 2nd Floor Retail Available

On Grade Retail Parking



362
Class "A" Luxury Units



93
Walk Score™



PROPERTY OVERVIEW | 2ND FLOOR PLAN

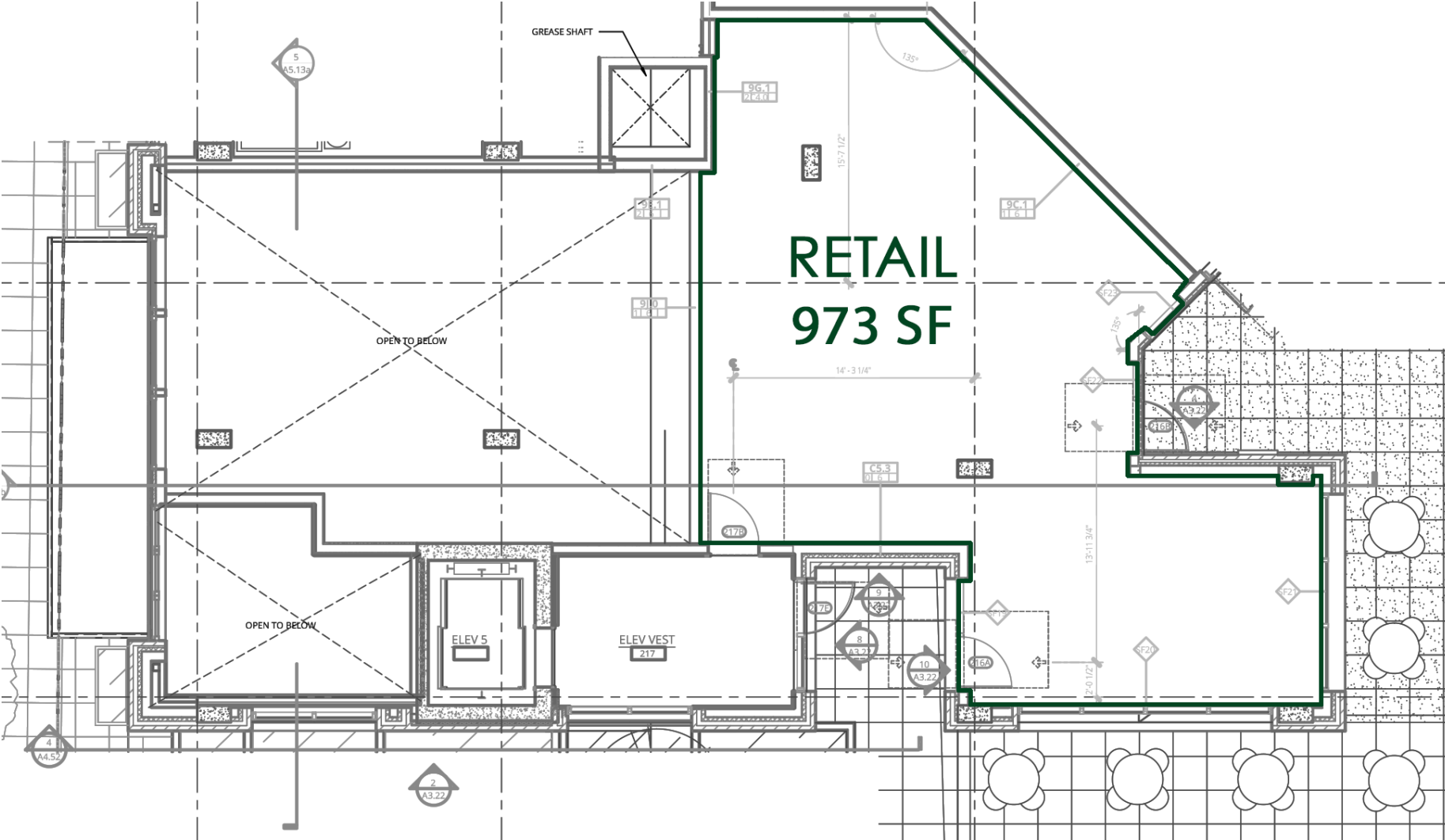

PROPOSED DEMISING PLAN	
Retail 3	973 SF Retail

PROPERTY OVERVIEW | LOCATION AERIAL





DEMOGRAPHICS

POPULATION

	1 MILE	3 MILES	5 MILES
2010 CENSUS	515,277	77,957	38,391
2020 CENSUS	22,862	98,100	244,985
2025 ESTIMATED	728,296	105,643	256,723
2030 PROJECTED	31,920	109,903	262,547

MISC. DEMOGRAPHICS

	1 MILE	3 MILES	5 MILES
MEDIAN AGE	32.5	34.9	36.6
EDUCATION: SOME COLLEGE <	91.5%	90.3%	88.3%
ADJ. DAYTIME DEMOGRAPHICS	23,090	74,291	204,929

HOUSEHOLD INCOME

	1 MILE	3 MILES	5 MILES
2025 MEDIAN	\$153,886	\$177,976	\$176,015
2030 MEDIAN PROJECTED	\$153,924	\$177,049	\$174,811
2025 AVERAGE	\$191,818	\$238,920	\$242,915
2030 AVERAGE PROJECTED	\$191,559	\$237,471	\$241,018

DATA SOURCE: ©2026, SITES USA

INQUIRE



ANGELA OLIVERI
Executive Vice President
+1 206.853.1330
aoliveri@fwp-inc.com

JACK SENTZ
Licensed Brokers Assistant
+1 509.731.7204
jsentz@fwp-inc.com

First Western Properties, Inc.
11621 97th Lane NE
Kirkland, WA 98034

O: +1 425.822.5522

www.fwp-inc.com