

# AUBURN ITC BLDG B, STE 170



*Industrial Space  
For Lease*

*11,100*  
TOTAL SF

*1,270*  
OFFICE SF

*24'*  
CLEAR HEIGHT

## INDUSTRIAL FOR LEASE

11,100 SF total / 1,270 SF office

Can combine with Suite 150 for 70,011 SF (6,282 SF)

4 dock-high doors / 1 grade-level door

24' clear height

Easy access to SR-167 via 277th St or 15th St and access to I-5 via 277th St

M-1 zoning

50' concrete aprons

Canopies over loading doors

\$1.15 shell rate / \$1.25 office rate

Available November 1, 2026

**CHRIS CORR**  
206.248.7324  
chris.corr@kidder.com

**MATT MURRAY, SIOR**  
206.248.6541  
matt.murray@kidder.com

**KIDDER.COM**

FOR LEASE

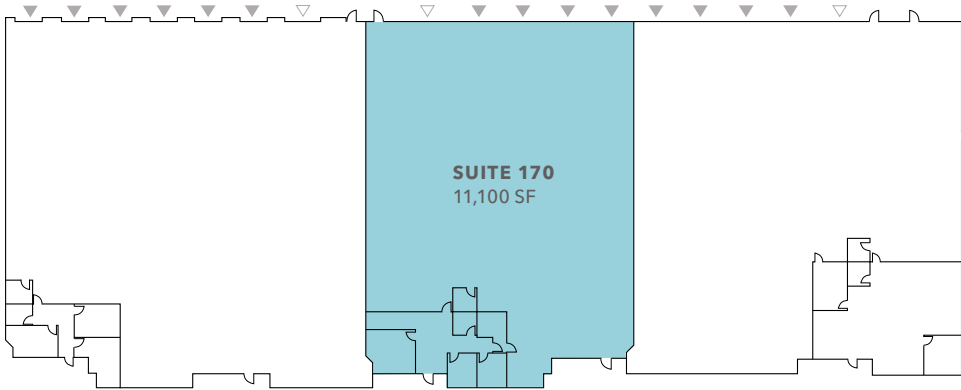

*11,100 SF*

BUILDING B, SUITE 170

*1,270 SF*

OFFICE

*24'*

CLEAR HEIGHT

**LEGEND**

△ Drive-In Loading    ▲ Dock-High Loading

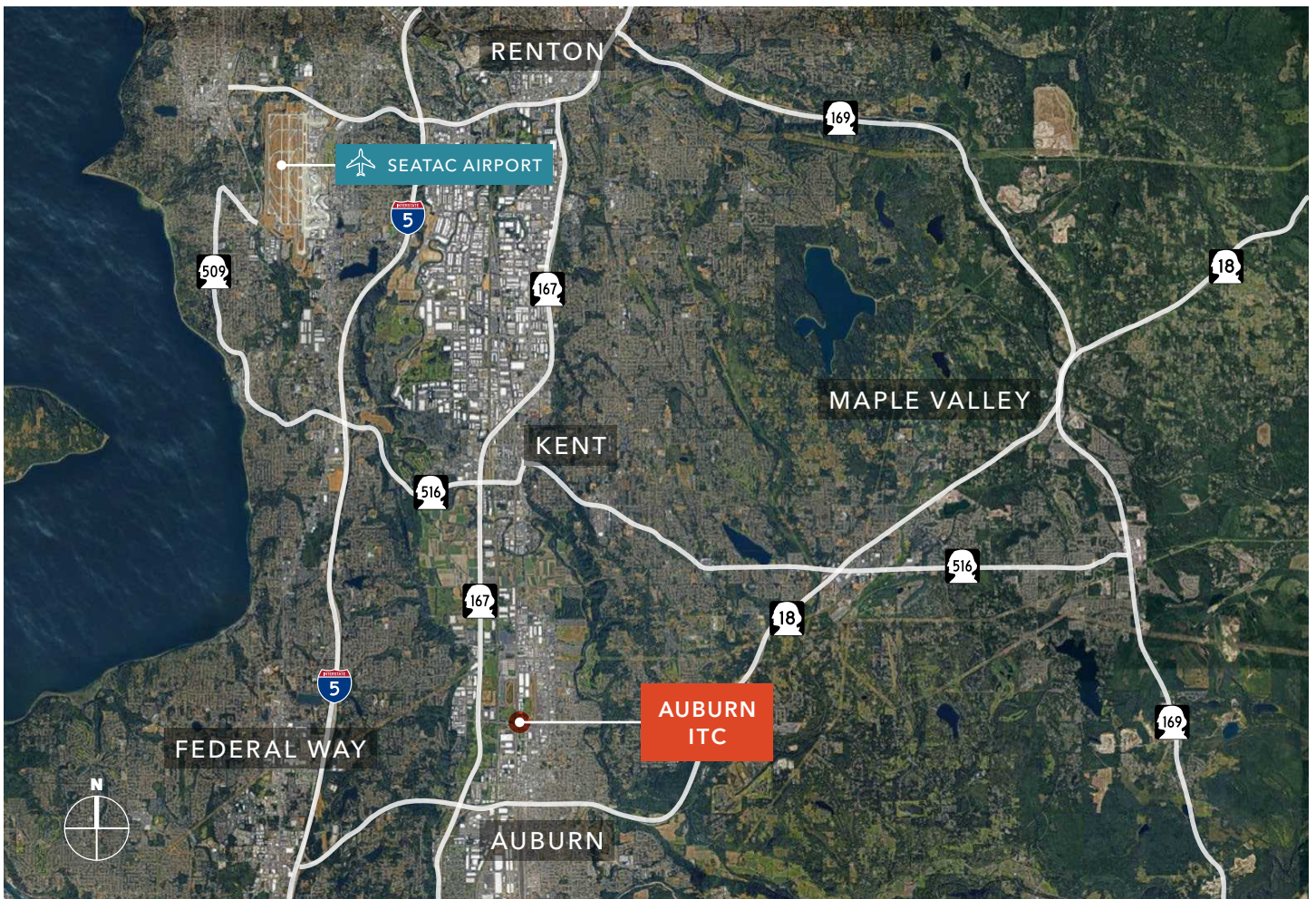

**KIDDER.COM**

This information supplied herein is from sources we deem reliable. It is provided without any representation, warranty, or guarantee, expressed or implied as to its accuracy. Prospective Buyer or Tenant should conduct an independent investigation and verification of all matters deemed to be material, including, but not limited to, statements of income and expenses. Consult your attorney, accountant, or other professional advisor.

