

MOSS BAY BUILDING

First floor, 4,708 SF flex/industrial space available
– steps from Downtown Kirkland.



1015 7TH AVENUE, KIRKLAND, WA 98033

ERNIE VELTON
(425) 985-7573
erniev@jshproperties.com

REESE VELTON
(425) 894-6555
reesev@jshproperties.com

 **JSH** | **PROPERTIES, INC.**

Site Plan

Flexible Workspaces in the Heart of Kirkland

The Moss Bay Building offers highly versatile flex/industrial suites with private offices, shop space, and restrooms—perfect for automotive, light industrial, and early-stage companies. Located at 1015 7th Avenue, Kirkland, this first-floor space sits directly on the Cross Kirkland Corridor Trail and is within walking

distance of Downtown Kirkland's shops, restaurants, and Google's Kirkland campus. Quick access to I-405, marked parking stalls, and nearby amenities like Kirkland Urban, Marina Park Pavilion, and Costco make this an exceptional business location.



AVAILABLE	SF	BASE RENT	NNN	COMMENTS
SUITE 140	4,708	\$25.00/SF	\$5.00/SF	Loading Dock, Reception, Restroom, Mezzanine

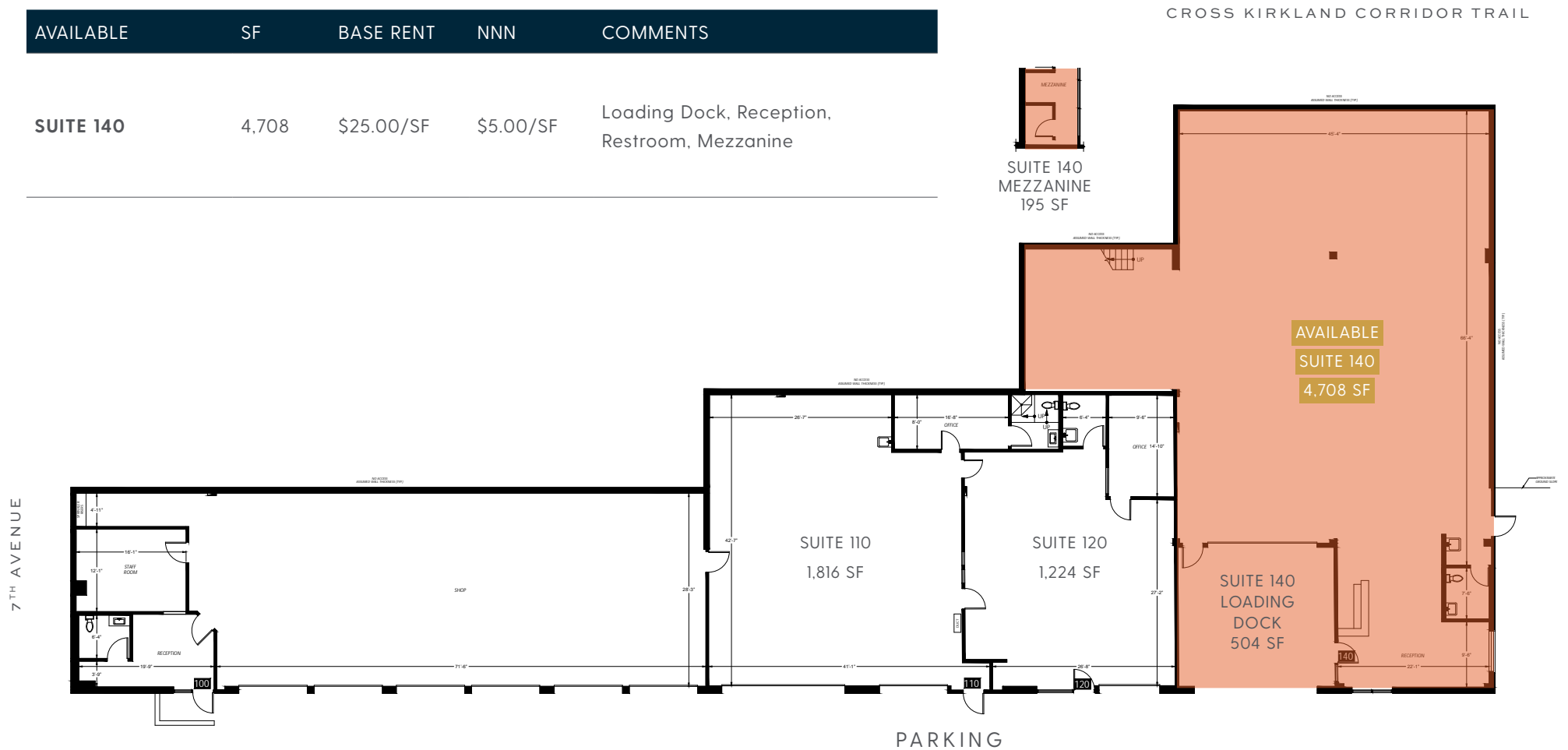

Downtown Kirkland



DEMOGRAPHICS	1 MILE	3 MILE	5 MILE
Population	14,005	80,736	239,706
Average HH Income	\$219,348	\$208,492	\$218,219
Households	8,403	43,362	127,679
Daytime Population	23,106	120,875	386,665



Aerial



AVAILABLE
SUITE 140
4,708 SF