

Auburn Commerce Center

3416 B Street N.W., Suite A, Auburn, WA

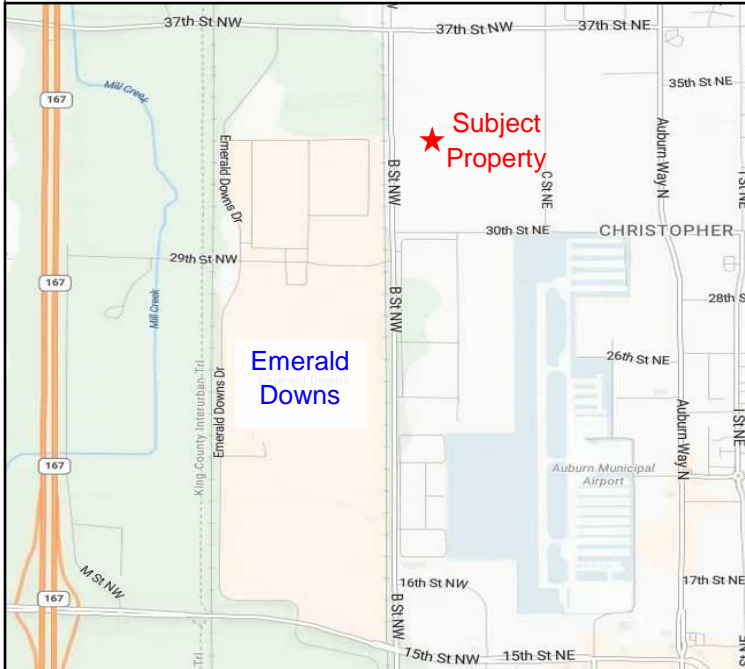

NOW LEASING
Industrial Space
14,246 SF



FEATURES

Bay Size: 14,246 SF (includes mezzanine, one (1) bathroom)

Loading Doors: 2 dock high doors (9'x10')
1 grade level door (12'x14')

Height: 24' clear
Concrete tilt-up

Power: 3 phase - 277/480v

Fire Protection: ESFR Sprinklers
High pile

Zoning: Auburn M2

Access: Convenient to SR 167 via
15th Street NW or S. 277th Street

Available: VACANT

Lease Rate: Negotiable



Robert B. Chadek
2050 112th Avenue SE, Suite 230, Bellevue, WA
(425) 453-5354



Auburn Commerce Center

AUBURN COMMERCE CENTER

'B' STREET N.W.

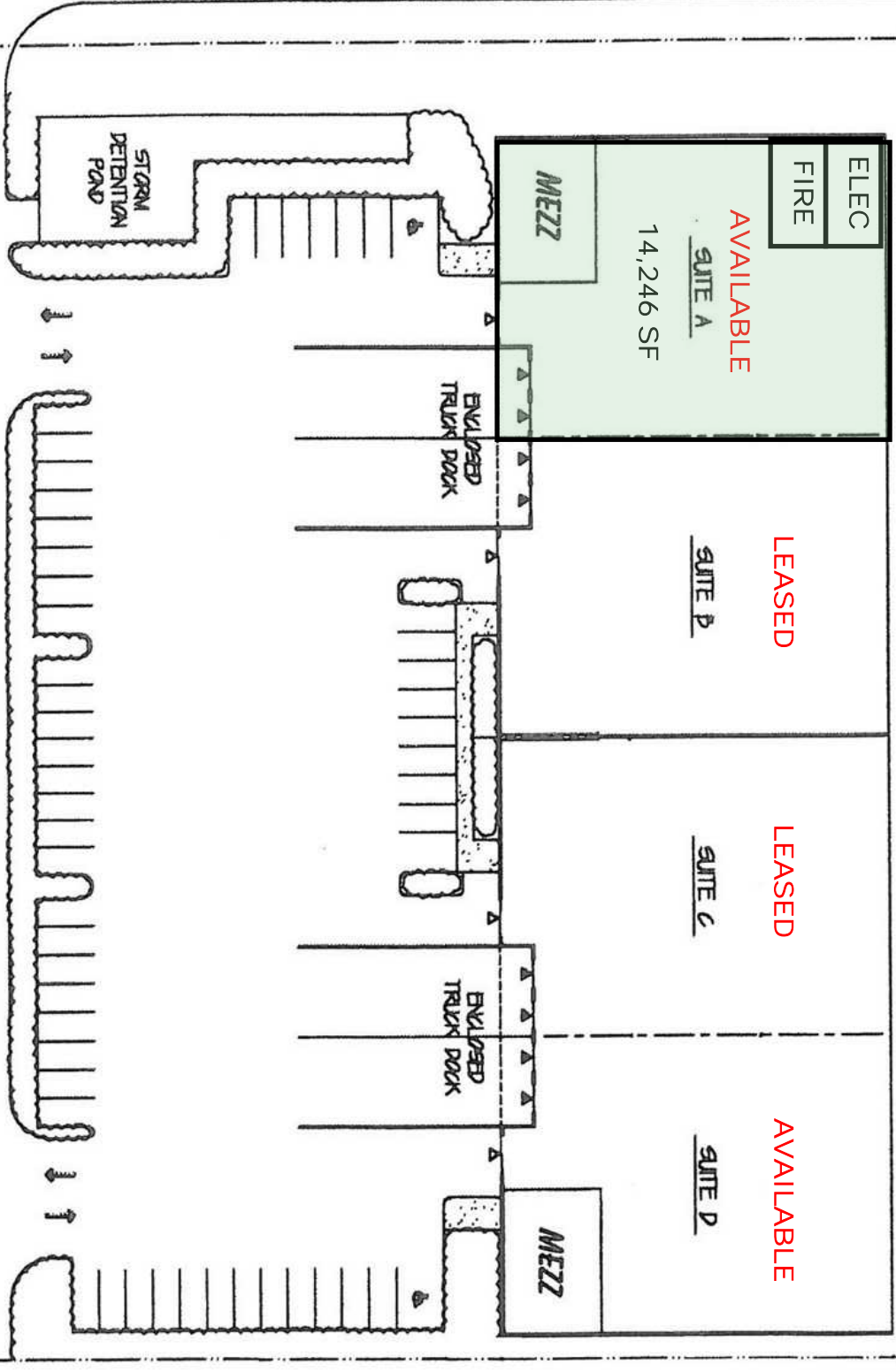

▲ 12' x 14' ON-GRADE ROLL-UP DOOR
 ▲ 9' x 12' DOCK HIGH ROLL-UP DOOR

SITE PLAN

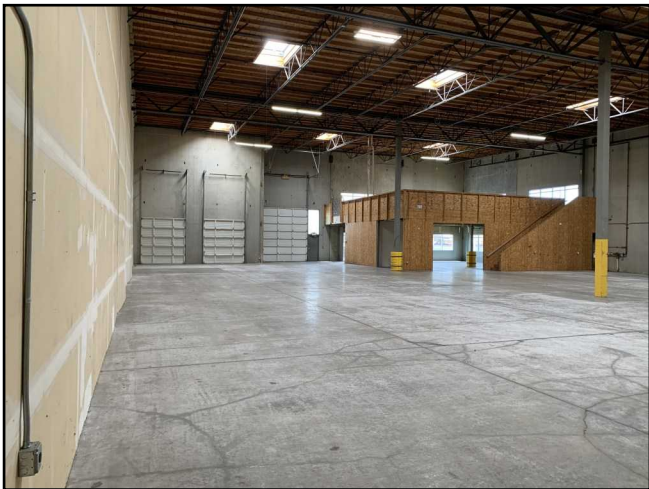
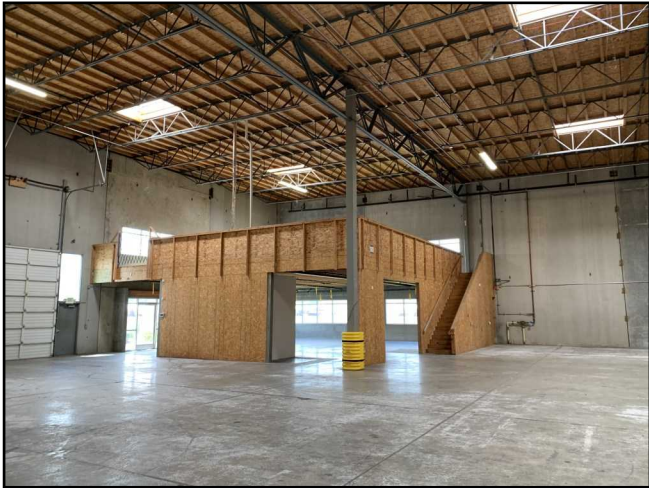

Auburn Commerce Center - Suite A