

# FOR LEASE

Retail | Salon | Boutique  
space available near  
downtown Arlington



## Arlington Plaza

20308 77th Ave NE, Arlington, WA

*Ideal boutique retail /office uses space situated near Highway 9. The property has recently undergone a complete renovation, including new HVAC units, new paint, with individual utilities supplied to each unit.*

### PROPERTY HIGHLIGHTS

- + Prime retail space in Downtown Arlington
- + Excellent visibility & signage
- + Proximity to Arlington Airport and apartment complex
- + Perfect for small boutique retail or office uses
- + Current salon layout
- + Recent HVAC and roof renovations
- + Suite E available w/ 30 day notice
- + Lease Rate: \$25.00/SF, plus NNN (NNN= \$9 p/f)
- + **DO NOT DISTURB TENANTS**



THE INFORMATION CONTAINED HEREIN HAS BEEN GIVEN TO US BY THE OWNER OF THE PROPERTY OR OTHER SOURCES WE DEEM RELIABLE. WE HAVE NO REASON TO DOUBT ITS ACCURACY, BUT WE DO NOT GUARANTEE IT. ALL INFORMATION SHOULD BE VERIFIED PRIOR TO PURCHASE OR LEASE.

TOTAL SF

**3,563 SF**

SUITE H

**2,363 SF**

SUITE E

**1,200 SF**

**BLAKE STEDMAN**

Senior Vice President  
+1 425 586 5621  
bstedman@nai-psp.com

**RICHARD ZHOU**

Associate  
+1 425 586 5623  
rzhou@nai-psp.com

# Floor Plan

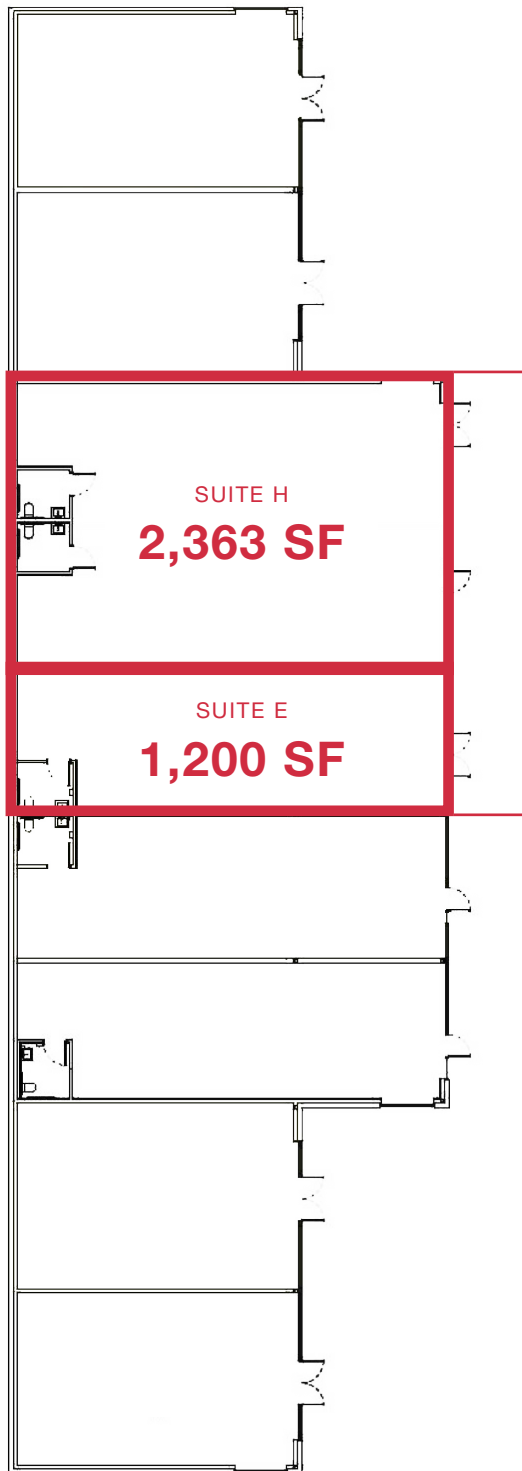

CAN BE COMBINED TO  
**3,563 SF**

**BLAKE STEDMAN**  
Senior Vice President  
+1 425 586 5621  
bstedman@nai-pp.com

**RICHARD ZHOU**  
Associate  
+1 425 586 5623  
rzhou@nai-pp.com



# Demographics



## 20308 77TH AVE NE | ARLINGTON, WA

	1 MILE	3 MILES	5 MILES
Population	7,440	24,729	49,079
2030 Population	8,100	26,672	53,314
Households	2,866	9,100	18,052
Median Age	37.3	38.4	38.7
Median HH Income	\$98,217	\$105,365	\$104,074
Average HH Income	\$118,367	\$131,351	\$126,247

### BLAKE STEDMAN

Senior Vice President  
+1 425 586 5621  
bstedman@nai-psp.com

### RICHARD ZHOU

Associate  
+1 425 586 5623  
rzhou@nai-psp.com



# Retailer Map



Google



**BLAKE STEDMAN**  
Senior Vice President  
+1 425 586 5621  
bstedman@nai-psp.com

**RICHARD ZHOU**  
Associate  
+1 425 586 5623  
rzhou@nai-psp.com

