



16th Avenue Industrial Building

18915 16th Ave S SeaTac, WA 98188

Property Highlights

- 32,438 SF available (8,474 SF total office area)
- Divisible to 18,032 SF, 14,406 SF, 10,584 SF, or 7,448 SF
- 8 DH & 4 GL door
- 23' clear height
- Lease Rates: \$1.00 PSF, NNN (Shell); \$1.25 office add on
- NNN = \$0.3825 PSF
- Ability to create a small fenced yard area
- Stand alone building for lease adjacent to SeaTac International Airport
- Available now

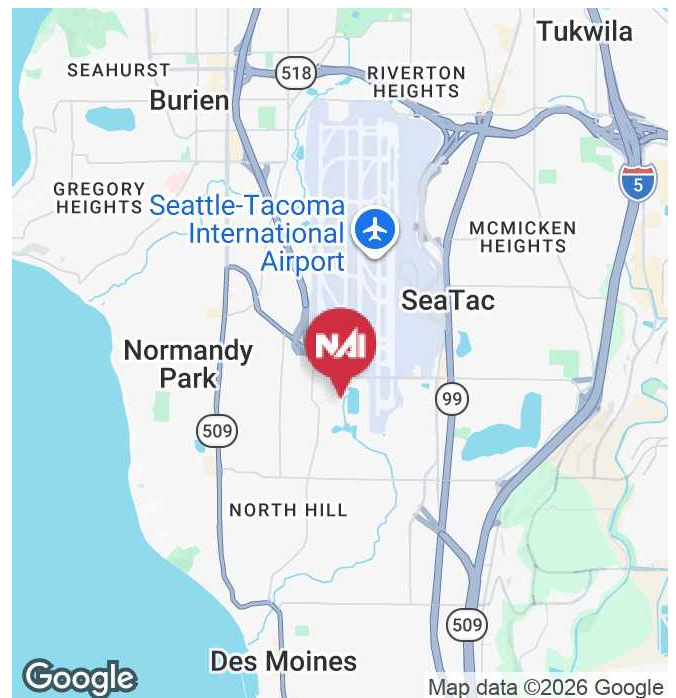

Kent Channing

Partner | 425.586.5628
kchanning@nai-psp.com

Arie Salomon, SIOR, CCIM

Principal | 425.586.5636
asalomon@nai-psp.com





FOR LEASE



32,438 SF



AVAILABLE
NOW

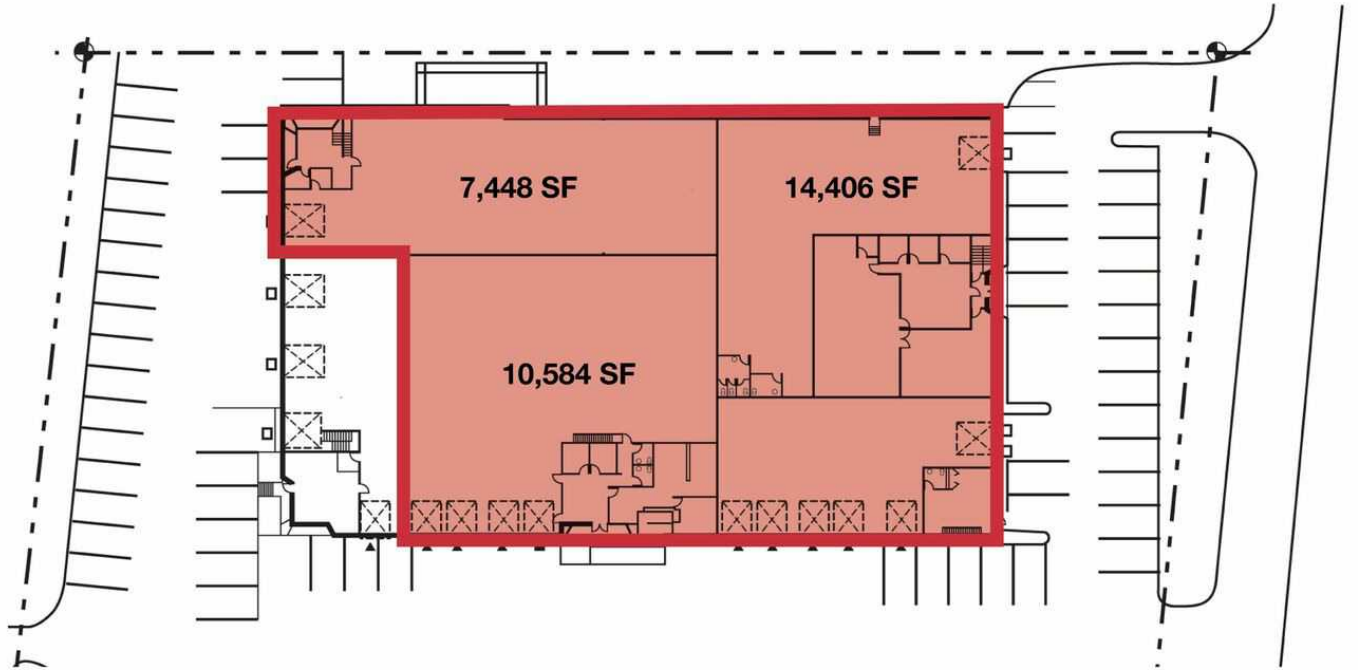

Kent Channing

Partner | 425.586.5628

kchanning@nai-psp.com

Arie Salomon, SIOR, CCIM

Principal | 425.586.5636

asalomon@nai-psp.com



<https://www.nai-psp.com>

THE INFORMATION SUPPLIED HEREIN IS FROM SOURCES WE DEEM RELIABLE. IT IS PROVIDED WITHOUT ANY REPRESENTATION, WARRANTY OR GUARANTEE, EXPRESSED OR IMPLIED, AS TO ITS ACCURACY. PROSPECTIVE BUYER OR TENANT SHOULD CONDUCT AN INDEPENDENT INVESTIGATION AND VERIFICATION OF ALL MATTERS DEEMED TO BE MATERIAL, INCLUDING, BUT NOT LIMITED TO, STATEMENTS OF INCOME AND EXPENSES. CONSULT YOUR ATTORNEY, ACCOUNTANT OR OTHER PROFESSIONAL ADVISOR.