



16th Avenue Industrial Building

18923 & 18929 16th Ave S SeaTac, WA

Property Highlights

- 18,032 SF available (3,150 SF office)
- Divisible to 7,448 SF (1,500 SF office) & 10,584 SF (1,650 SF office)
- 3 DH & 2 GL door
- 23' clear height
- Lease Rate: \$1.00 PSF, NNN (Shell); \$1.25 office add on
- NNN = \$0.3825 PSF
- Can be combined with adjacent space to create 32,438 SF facility
- Available now

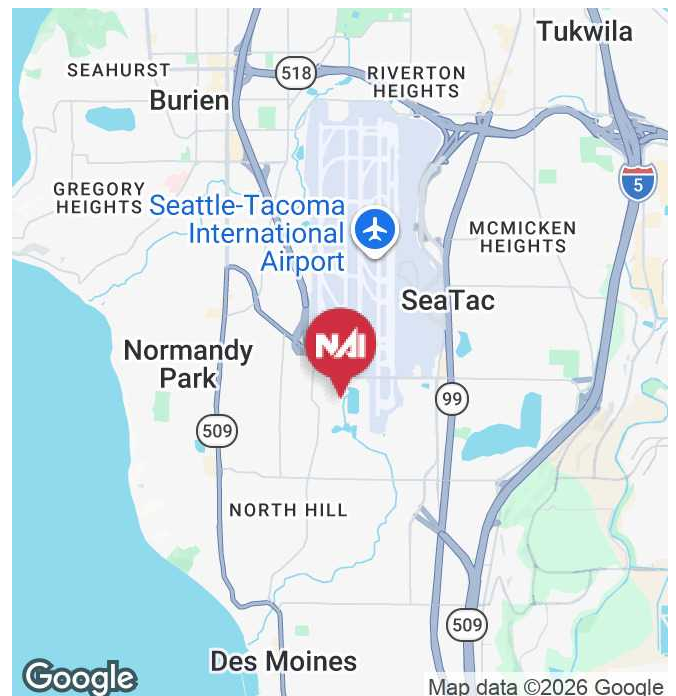

Kent Channing

Partner | 425.586.5628
kchanning@nai-psp.com

Arie Salomon, SIOR, CCIM

Principal | 425.586.5636
asalomon@nai-psp.com





FOR LEASE



18,032 SF



AVAILABLE
NOW

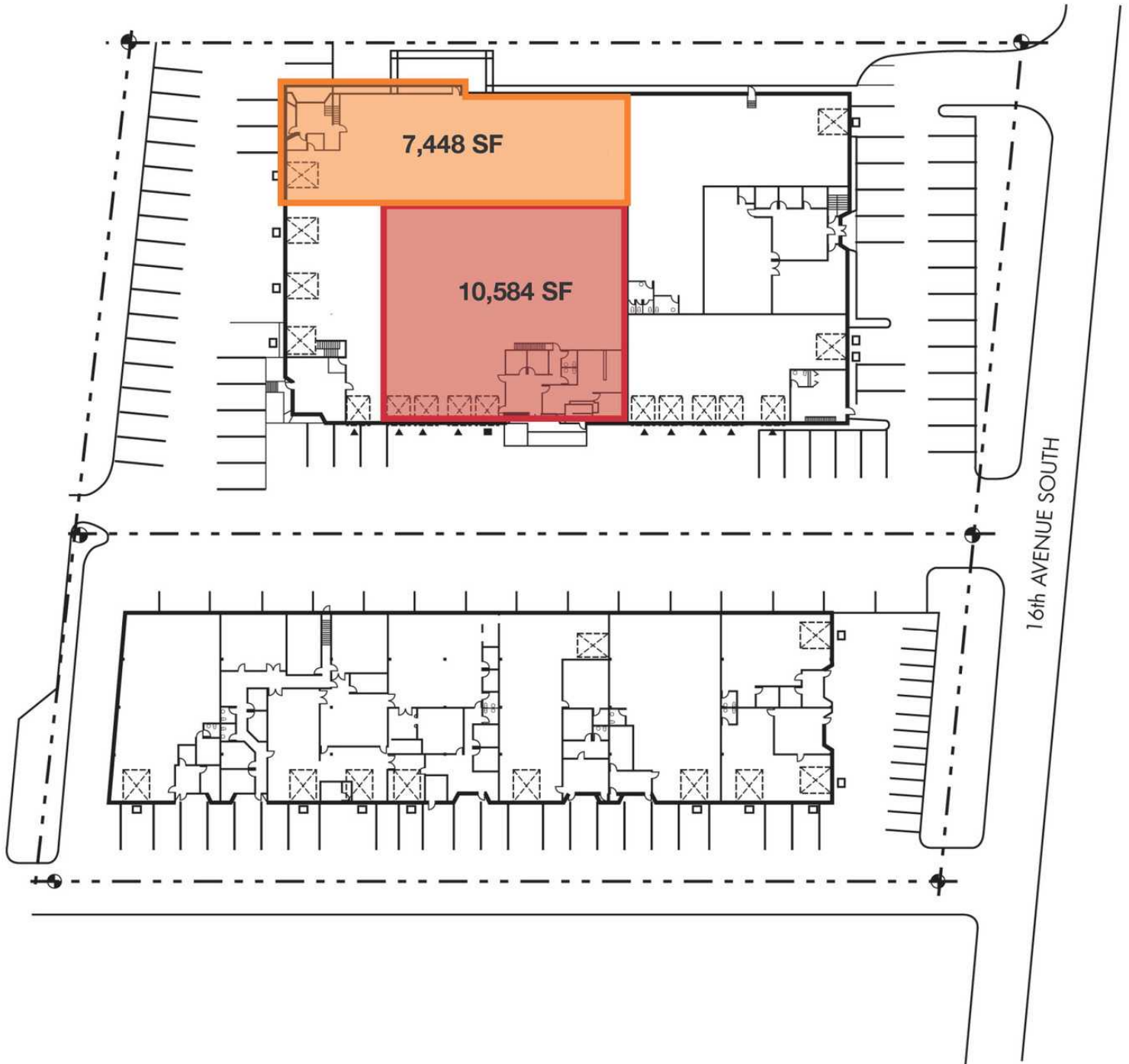

Kent Channing

Partner | 425.586.5628

kchanning@nai-psp.com

Arie Salomon, SIOR, CCIM

Principal | 425.586.5636

asalomon@nai-psp.com

