

sloane

RETAIL FOR LEASE

616 Battery St, Seattle, WA 98121



Blake Taylor | Madeline Stutz | Tiffini Connell

WCCR | West Coast
Commercial
Realty

sloane

Positioned at the highly visible intersection of 7th Avenue and Denny Way, Sloane is a 45-story residential tower (retail delivery Q1 2027) anchoring the north edge of downtown Seattle. The project provides two distinct retail spaces available for lease in a densifying, high-income urban neighborhood.

With prominent frontage along Denny Way—one of Seattle’s most heavily trafficked east-west corridors—the spaces benefit from exceptional visibility and connectivity between South Lake Union, Belltown, and the downtown core.



SITE PLAN

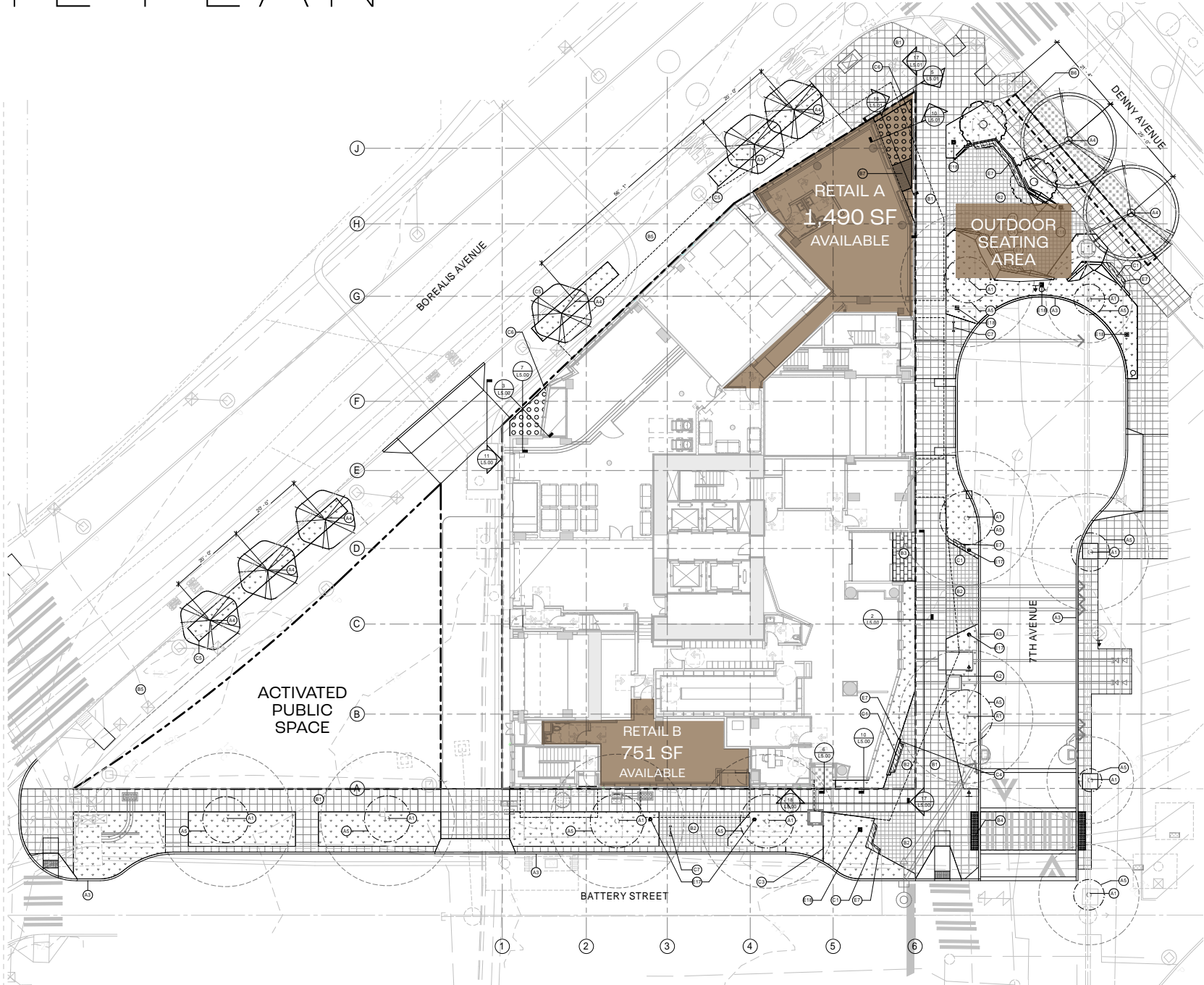

FLOOR PLAN

RETAIL A

1,490 SF AVAILABLE

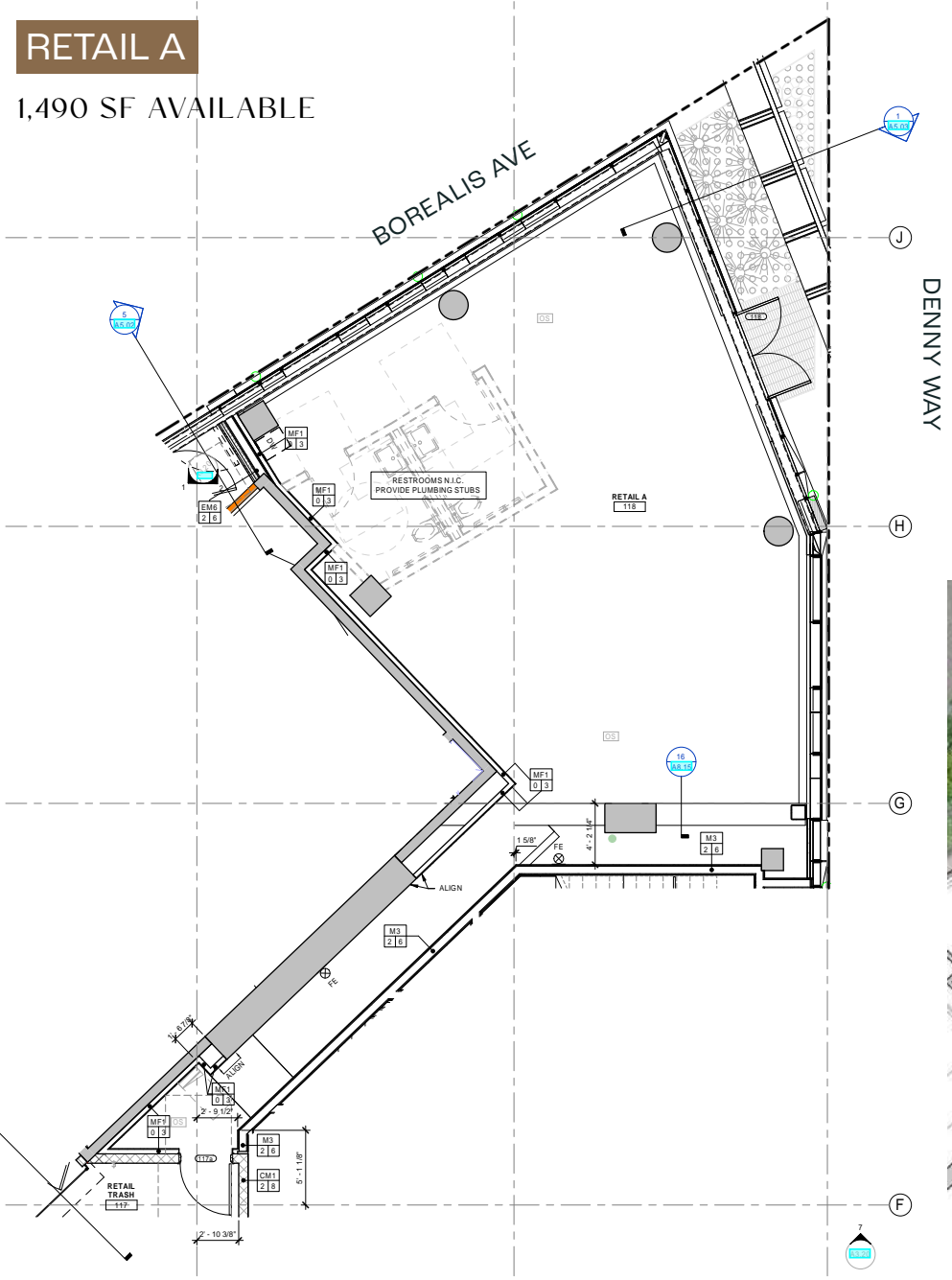

FLOOR PLAN

RETAIL B

751 SF AVAILABLE

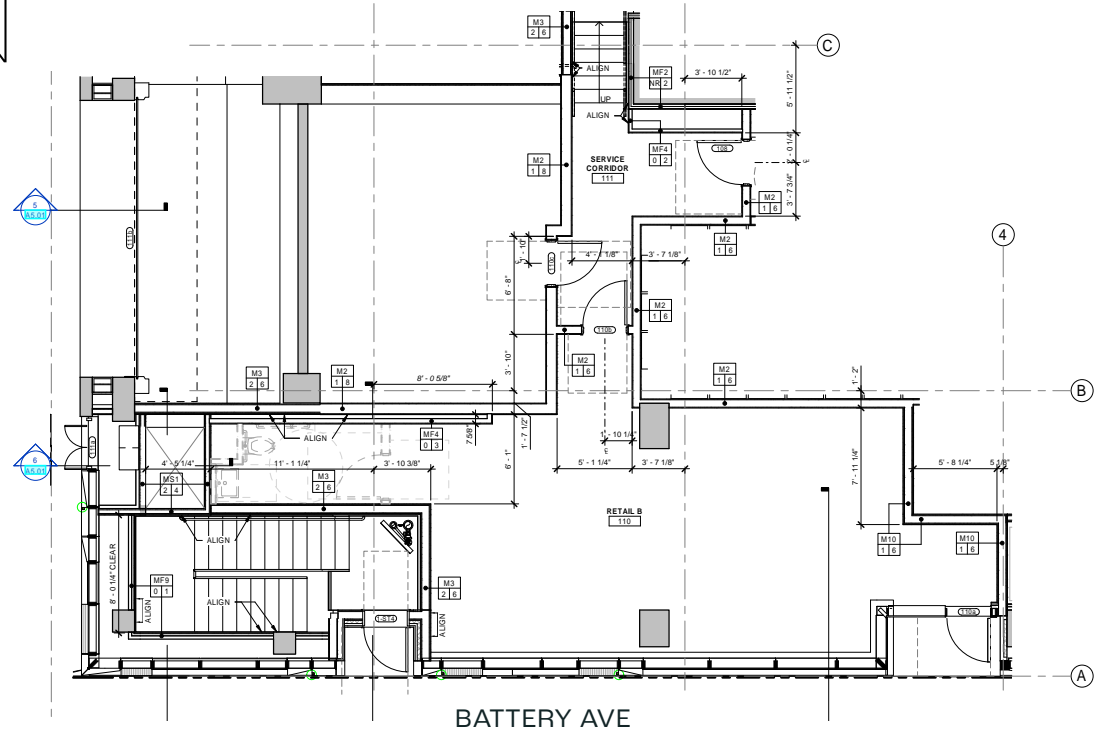



DEMOGRAPHICS

Downtown Seattle continues to see strong residential growth, with tens of thousands of apartment units delivered over the past decade and a growing full-time population that supports a vibrant, walkable retail environment. The surrounding neighborhood is characterized by a highly educated, affluent renter base, with strong demand for boutique fitness, wellness, food & beverage, and service-oriented retail. Immediate proximity to major employment hubs in South Lake Union and the Denny Triangle further drives consistent daytime population and foot traffic.

This is a rare opportunity to establish a presence in a high-density, supply-constrained corridor with built-in visibility, a strong residential customer base, and seamless access to some of Seattle's most dynamic neighborhoods.

	2 MILES	5 MILES	10 MILES
TOTAL POPULATION	166,100	490,152	1,106,186
TOTAL EMPLOYEES	262,467	432,679	694,814
AVG. HOUSEHOLD INCOME	\$147,520	\$155,578	\$158,076
TOTAL HOUSEHOLDS	99,743	242,114	493,295

100

TRANSIT SCORE

83

BIKE SCORE

99

WALK SCORE



sloane

Blake Taylor

blake@wccommercialrealty.com

206 422 7598

Madeline Stutz

madeline@wccommercialrealty.com

206 422 7598

Tiffini Connell

tiffini@wccommercialrealty.com

206 854 1925

DISCLAIMER: The above information has been secured from sources believed to be reliable, however, no representations are made to its accuracy. Prospective tenants or buyers should consult their professional advisors and conduct their own independent investigation. Site plan and configuration are subject to change. Properties are subject to change in price and/or availability without notice. West Coast Commercial Realty, LLC

MEMBER OF
SITE SOURCE
REAL ESTATE NETWORK

CBA

ICSC

CoStar
POWER BROKER

WCCR | West Coast
Commercial
Realty

206 283 5212

wccommercialrealty.com

