

196th Commerce Center

56,744 SF For Lease



Unmatched East Valley
Highway frontage



Oversized grade-level
door



60' x 20'
Column Spacing



Heavy Power

8240 South 196th Street Kent, WA 98032

Matt Wood, SIOR
+1 206 595 6814
matt.wood@kbcadvisors.com

Michael Roy
+1 206 940 7199
michael.roy@kbcadvisors.com

John Broom
+1 206 877 2750
john.broom@kbcadvisors.com

KBC Advisors | Seattle
5628 Airport Way, Suite 238
Seattle, WA 98108

Floor Plan

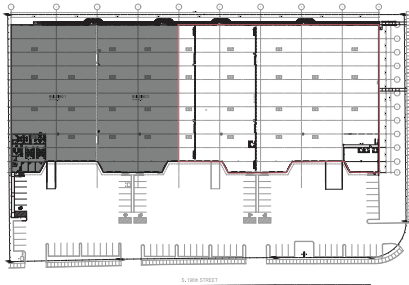
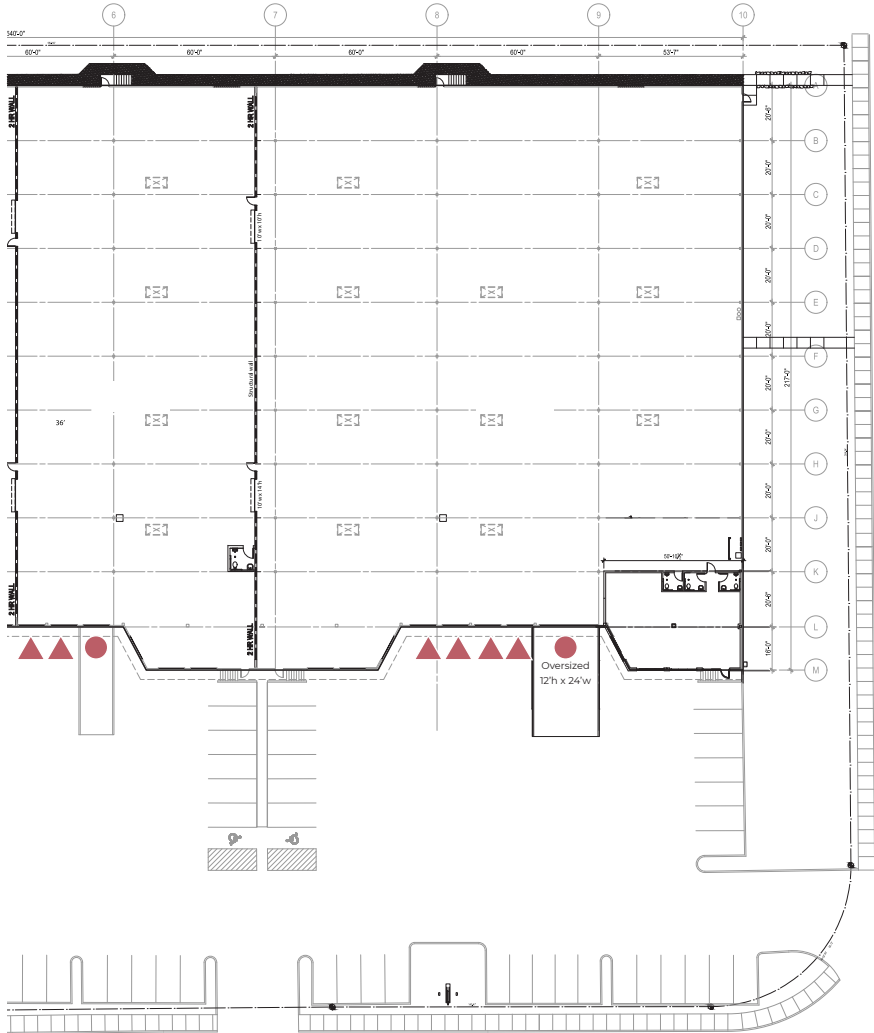

56,744
Square Feet

1,852
SF Office

6
Dock-high doors

2
Grade-level doors
(1 oversized)

TWO 600
Amp panels

24'
Clear height

48
Auto stalls

10/1/2026
Availability

Matt Wood, SIOR
+1 206 595 6814
matt.wood@kbcadvisors.com

Michael Roy
+1 206 940 7199
michael.roy@kbcadvisors.com

John Broom
+1 206 877 2750
john.broom@kbcadvisors.com

KBC Advisors | Seattle
5628 Airport Way, Suite 238
Seattle, WA 98108

Access Map

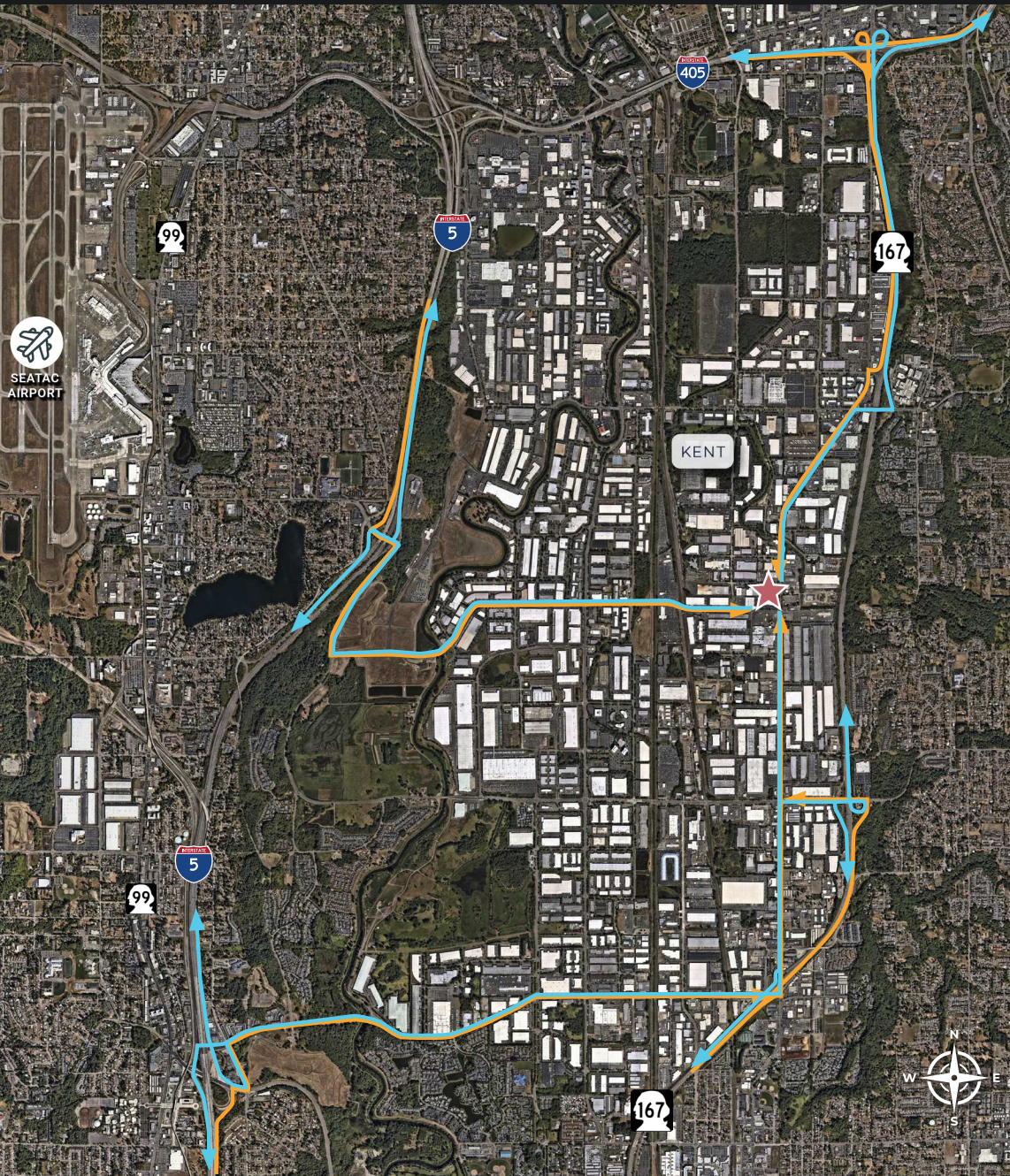

Matt Wood, SIOR
+1 206 595 6814
matt.wood@kbcadvisors.com

Michael Roy
+1 206 940 7199
michael.roy@kbcadvisors.com

John Broom
+1 206 877 2750
john.broom@kbcadvisors.com

KBC Advisors | Seattle
5628 Airport Way, Suite 238
Seattle, WA 98108

© 2026 KBC ADVISORS This information has been obtained from sources believed to be reliable but has not been verified for accuracy or completeness, and KBC Advisors disclaims any guarantees, warranties or representations, express or implied, as to the completeness or accuracy as to the information contained herein. You should conduct a careful, independent investigation of the property and verify all information. Any reliance on this information is solely at your own risk. The KBC ADVISORS logo is a service mark of KBC ADVISORS. All other marks displayed on this document are the property of their respective owners. Photos herein are the property of their respective owners. Use of these images without the express written consent of the owners is prohibited.

