

**FOR SALE
OR LEASE**

21,025 SF Building on 70,132 SF of Land
17300 West Valley Highway, Tukwila

NEWMARK

THAD MALLORY, SIOR
Executive Vice Chairman
425-362-1410
thad.mallory@nmrk.com

PROPERTY DETAILS

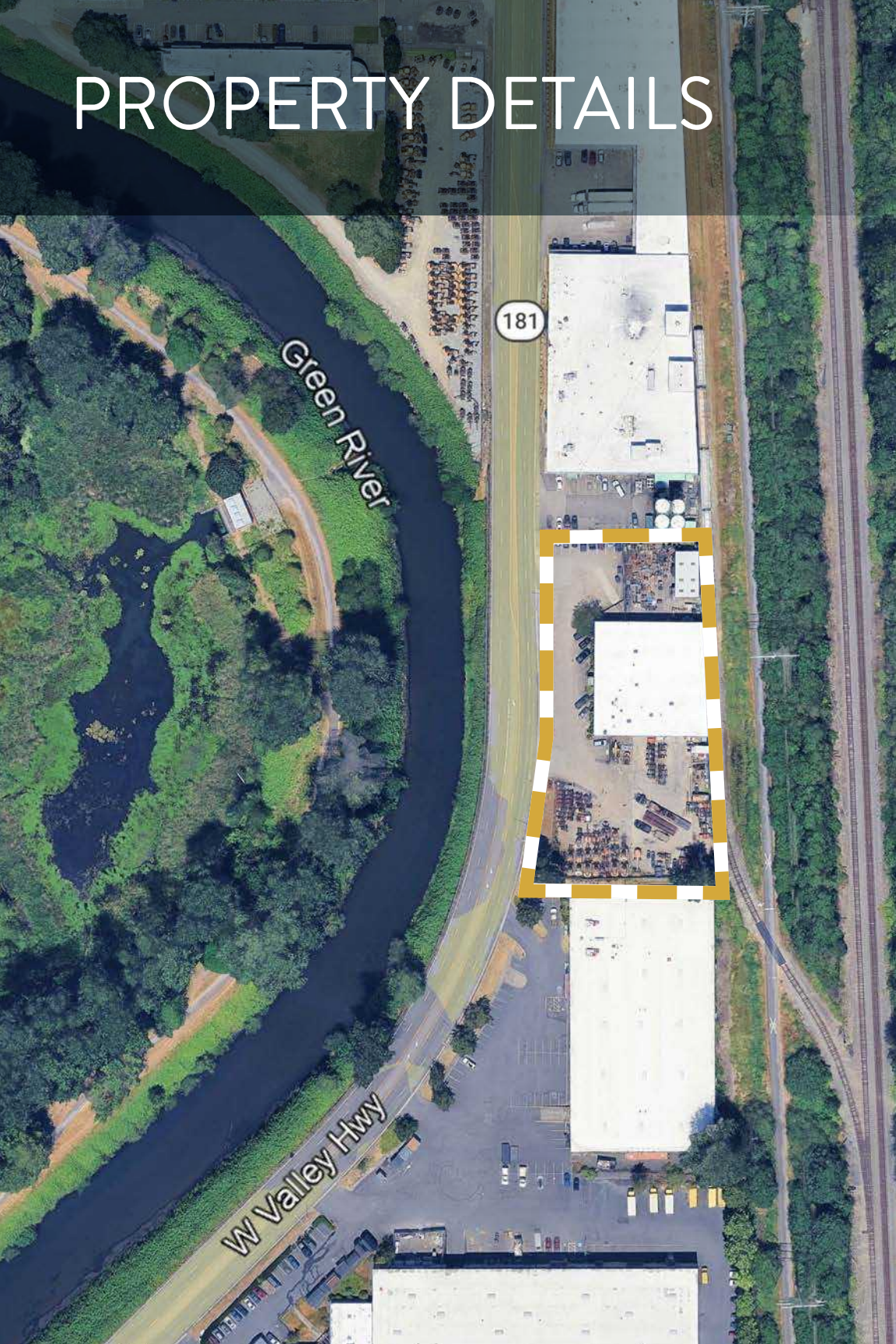

Total Site	70,132 SF (1.61 AC)
Loading	Dock High & Grade Level
Clear Height	Approx. 20'
Zoning	C/LI (City of Tukwila)
Sale Price	\$8,900,000
Lease Rate	\$40,000, NNN
Available	September 2026
Comments	Updated building with dock platform loading and outside storage. Exposure to West Valley Highway and immediate access to I-405, I-5, and SR-167

Structures	21,025 SF
Main Building	±15,589 SF
Metal Shed Building	±1,323 SF
Mezzanine Office/Storage	±4,122 SF
Excess Land/Yard	
South Fenced Yard	±25,000 SF (0.57 AC)
North Fenced Yard	±8,000 SF (0.18 AC)
Total Combined Fenced Yard	±33,000 SF (0.75 AC)

FIRST FLOOR PLAN

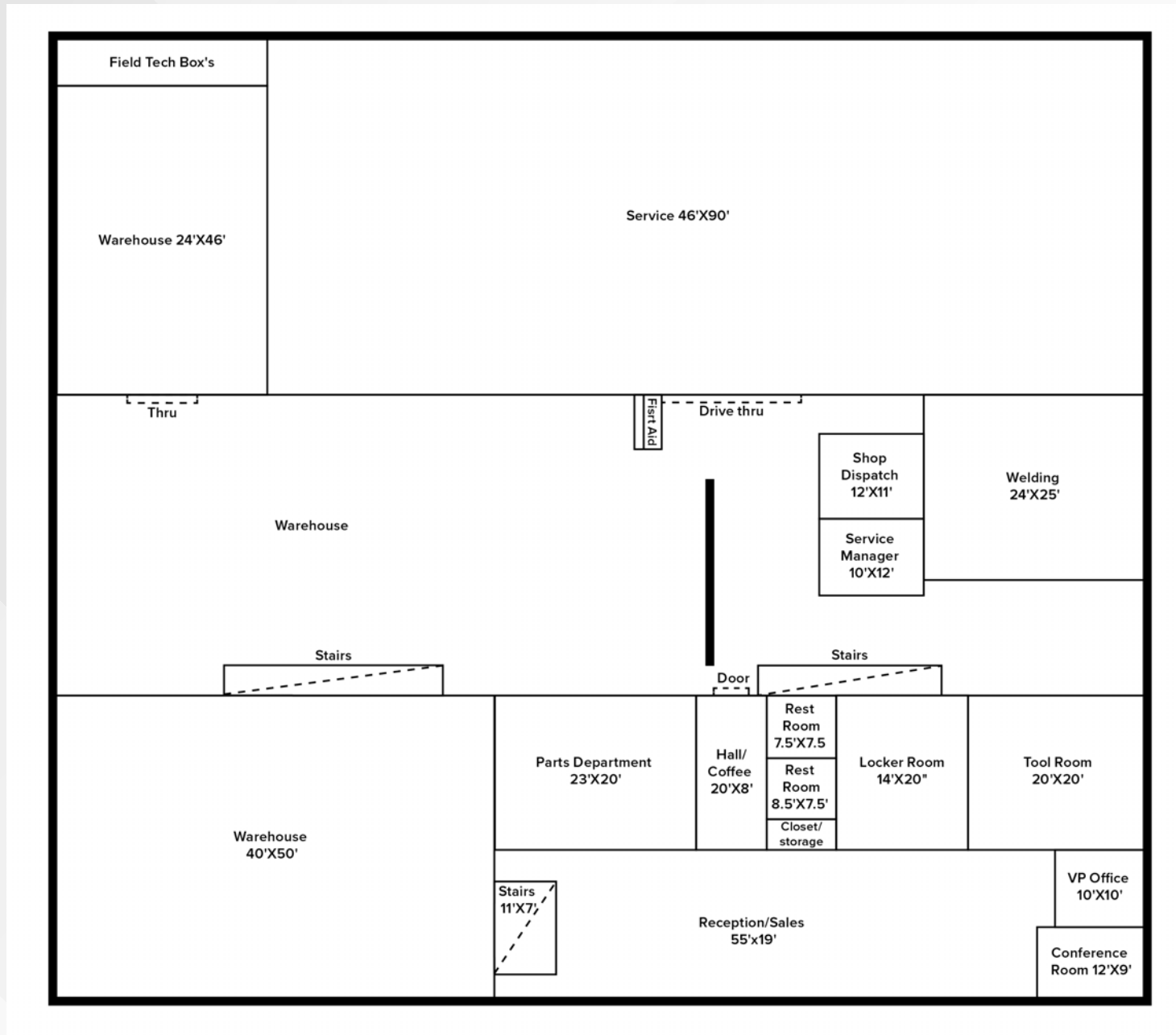

PHOTOS



NEWMARK

REGIONAL AERIAL

Drive Times

SEATAC INT'L AIRPORT

10 Minutes

PORT OF SEATTLE

15 Minutes

DOWNTOWN BELLEVUE

20 Minutes

EASY ACCESS

I-5, I-405, SR 99, SR 118, SR 509

Downtown
Seattle

Tukwila

SEATAC
Int'l Airport



FOR SALE OR LEASE

21,025 SF Building on 70,132 SF of Land
17300 West Valley Highway, Tukwila

The distributor of this communication is performing acts for which a real estate license is required. The information contained herein has been obtained from sources deemed reliable but has not been verified and no guarantee, warranty or representation, either express or implied, is made with respect to such information. Terms of sale or lease and availability are subject to change or withdrawal without notice.

NEWMARK

THAD MALLORY, SIOR
Executive Vice Chairman
425-362-1410
thad.mallory@nrmk.com