

**FOR SALE  
OR LEASE**

**LIND AVE  
INDUSTRIAL  
CENTER**

**23,121 SF TOTAL**

865 LIND AVE SW  
RENTON, WA



**NEWMARK**

**TAYLOR HOFF, SIOR**

Vice Chairman

425.362.1388

[taylor.hoff@nmrk.com](mailto:taylor.hoff@nmrk.com)

**THAD MALLORY, SIOR**

Executive Vice Chairman

425.362.1410

[thad.mallory@nmrk.com](mailto:thad.mallory@nmrk.com)



## BUILDING DETAILS

<b>Address</b>	865 Lind Ave SW Renton, WA
<b>Parcel Number</b>	192305-9030
<b>Land Size</b>	0.72 Acres (31,360 SF)
<b>Rentable Area</b>	23,121 SF
<b>Office</b>	2,783 SF
<b>Clear Height</b>	24'
<b>Loading</b>	2 Dock High Doors
<b>Parking</b>	26 Parking Stalls
<b>Zoning</b>	CA
<b>Interior</b>	Fully Insulated
<b>Available</b>	11/1/2026
<b>Lease Rate</b>	\$1.35 Blended, \$0.33 NNN
<b>Sales Price</b>	\$6,246,670

## PROPERTY HIGHLIGHTS

- Rare standalone building strategically located in Renton, immediately adjacent to I-405 and proximate to I-5 & SR-167
- Meticulously maintained and functional relative to market with two dock high doors, 24' clear height, and partially temperature controlled warehouse space

# FLOOR PLANS

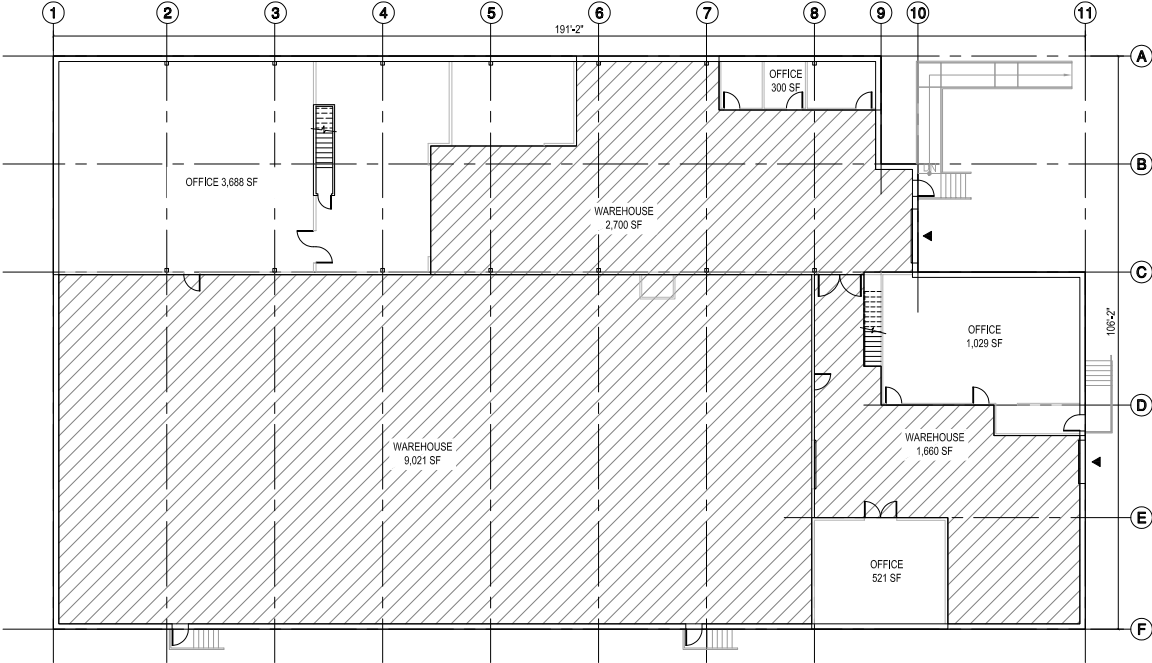

FIRST FLOOR

## MEZZANINE

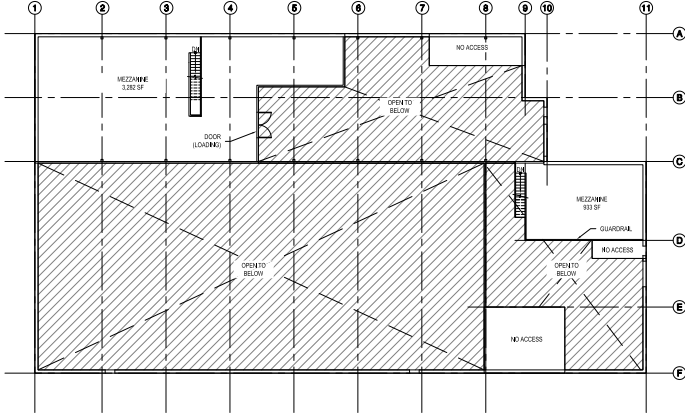

# BUILDING LOCATION

SeaTac Airport	5 Miles
Port of Seattle	11 Miles
Port of Tacoma	24 Miles

**LIND AVENUE  
INDUSTRIAL CENTER**  
865 LIND AVE SW  
RENTON, WA



# LIND AVE INDUSTRIAL CENTER

865 LIND AVENUE SW  
RENTON, WA

**NEWMARK**

**TAYLOR HOFF, SIOR**

Vice Chairman

425.362.1388

[taylor.hoff@nrmk.com](mailto:taylor.hoff@nrmk.com)

**THAD MALLORY, SIOR**

Executive Vice Chairman

425.362.1410

[thad.mallory@nrmk.com](mailto:thad.mallory@nrmk.com)

The distributor of this communication is performing acts for which a real estate license is required. The information contained herein has been obtained from sources deemed reliable but has not been verified and no guarantee, warranty or representation, either express or implied, is made with respect to such information. Terms of sale or lease and availability are subject to change or withdrawal without notice. 18-1023