

FOR SUBLEASE

TOTEM LAKE BUSINESS PARK

*2,476 SF Office/Industrial Space
Available in Kirkland*

12815 NE 124TH ST
KIRKLAND, WA, 98034

SUBJECT
PROPERTY

KIDDER.COM

km Kidder
Mathews

12815 NE 124TH ST

PROPERTY OVERVIEW

ADDRESS	12815 NE 124th St Kirkland, WA 98034
SUITE A	2,476 SF
OFFICE	674 SF
WAREHOUSE	1,802 SF
LEASE RATES	\$1.50/SF blended, NNN
TERM	Expires December 31, 2027

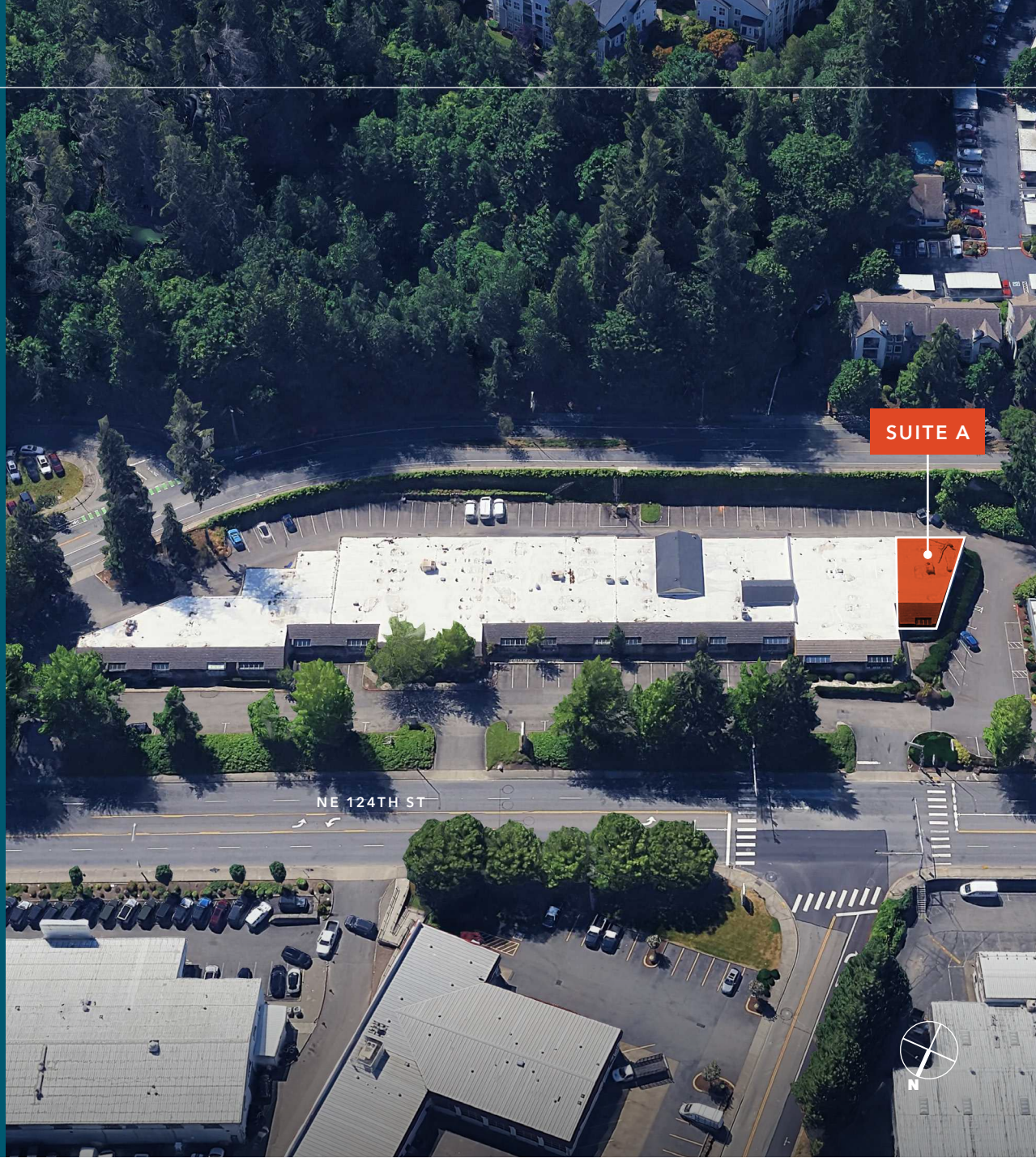

2,476 SF
SUITE A

16'
CLEAR HEIGHT

FLOOR PLAN

Suite A

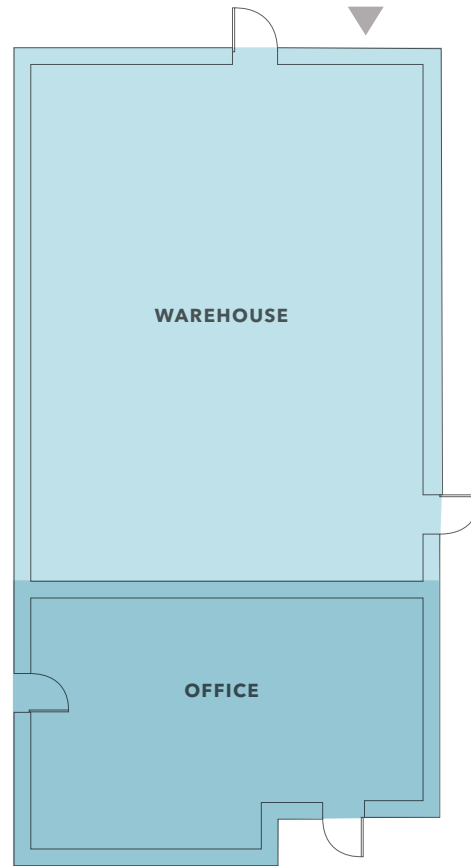

2,476 SF

TOTAL AVAILABLE

674 SF

OFFICE

1,802 SF

WAREHOUSE



▲ Grade level loading

Exclusively listed by

TODD GAUTHIER

Executive Vice President

425.450.1118

todd.gauthier@kidder.com

JASON BLOOM

Executive Vice President

425.450.1102

jason.bloom@kidder.com

KIDDER.COM

This information supplied herein is from sources we deem reliable. It is provided without any representation, warranty, or guarantee, expressed or implied as to its accuracy. Prospective Buyer or Tenant should conduct an independent investigation and verification of all matters deemed to be material, including, but not limited to, statements of income and expenses. Consult your attorney, accountant, or other professional advisor. All Kidder Mathews designs are the sole property of Kidder Mathews. Branded materials and layouts are not authorized for use by any other firm or person.

