

# West Valley @ 216<sup>th</sup> Building B | FOR LEASE



6701 South 216<sup>th</sup> Street, Kent, WA 98032

17,920 SF Total

2,254 SF Office

7 Dock-high doors

3 Grade-level doors

15' Clear height

Available now

West Valley signage

Corner location

2026 est. NNN \$0.35/SF

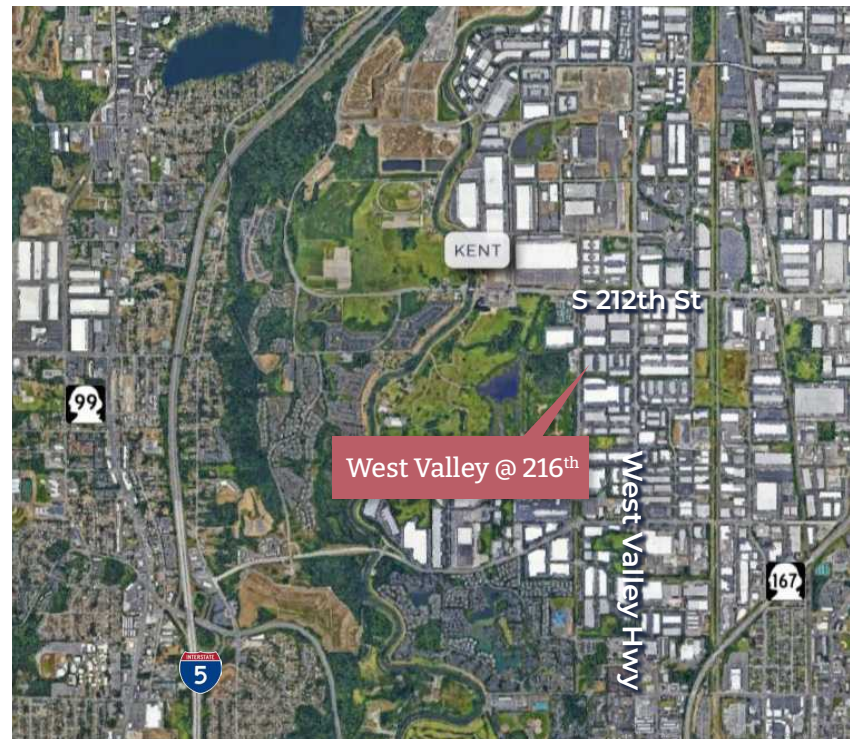

**Matt Wood, SIOR**  
206 595 6814  
matt.wood@kbcadvisors.com

**John Broom**  
206 877 2750  
john.broom@kbcadvisors.com

KBCADVISORS.COM

# West Valley @ 216<sup>th</sup> Building B

6701 South 216<sup>th</sup> Street, Kent, WA 98032

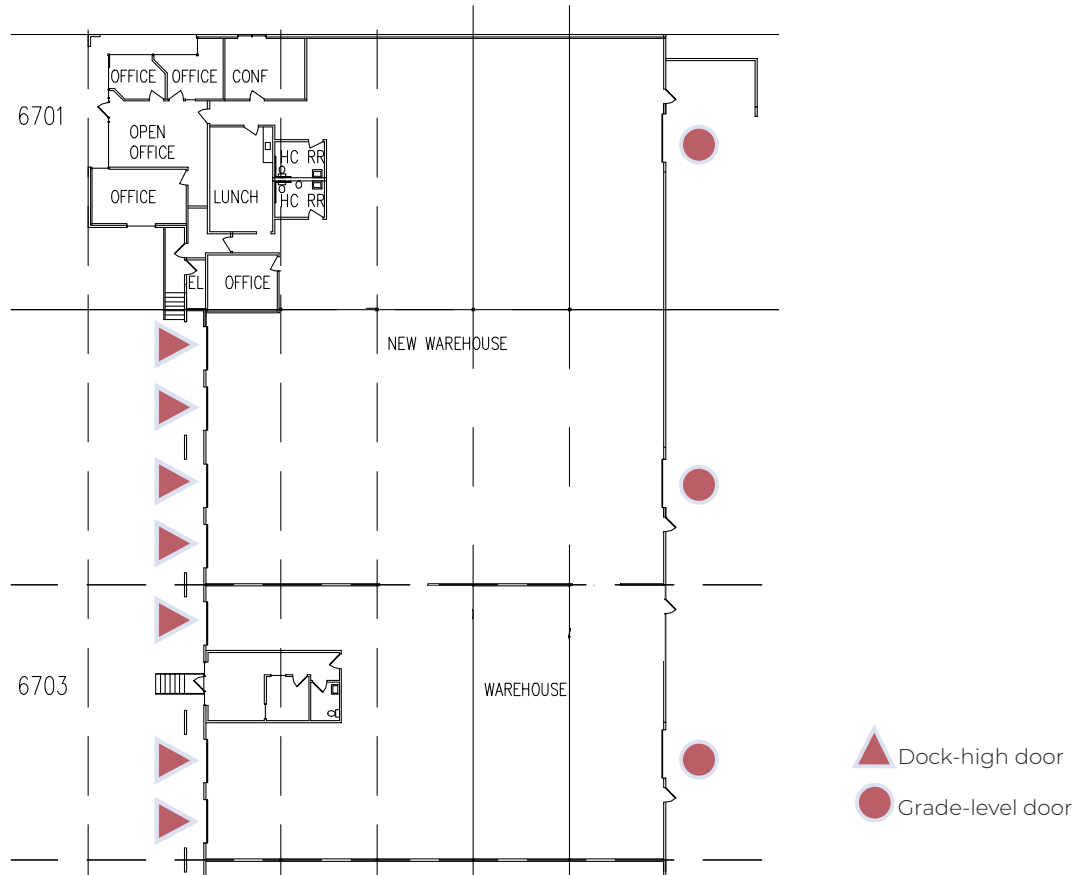

## Space Information

Building SF	17,920 SF
Office SF	2,254 SF
Clear Height	15'
Loading Doors	7 Dock-high 3 Grade-level
Available	Now

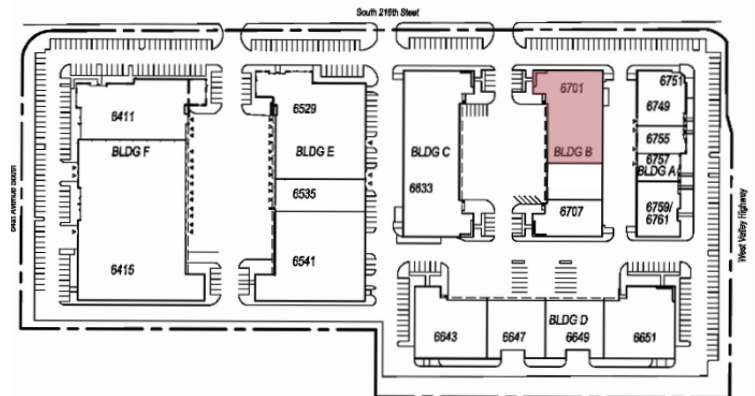

**Matt Wood, SIOR**  
206 595 6814  
matt.wood@kbcadvisors.com

**John Broom**  
206 877 2750  
john.broom@kbcadvisors.com

**KBCADVISORS.COM**

© 2026 KBC ADVISORS This information has been obtained from sources believed to be reliable but has not been verified for accuracy or completeness. You should conduct a careful, independent investigation of the property and verify all information. Any reliance on this information is solely at your own risk. The KBC ADVISORS logo is a service mark of KBC ADVISORS. All other marks displayed on this document are the property of their respective owners. Photos herein are the property of their respective owners. Use of these images without the express written consent of the owners is prohibited.