

# PROSSER PLAZA

5849 TACOMA MALL BLVD  
TACOMA, WA 98409

Suire B1 - 2,836 SF \* can be combined with B1A

Suite B1A - 1,505 SF \* can be combined with B1

Suite D - 2,000 SF available 10/2026

Great I-5 and Tacoma Mall Blvd visibility

Located just South of the Tacoma Mall & direct access from Interstate 5

Parking 5.1 stalls per 1,000 SF, 179,000 average daily traffic



**BLAKE WEBER**  
206.898.1231 | blake.weber@kidder.com

**NED WHALEN**  
206.491.5998 | ned.whalen@kidder.com

**DON WHITTLES**  
253.208.2257 | don.whittles@kidder.com

**TIM WEBER**  
206.650.0391 | tim.weber@kidder.com

**KIDDER.COM**

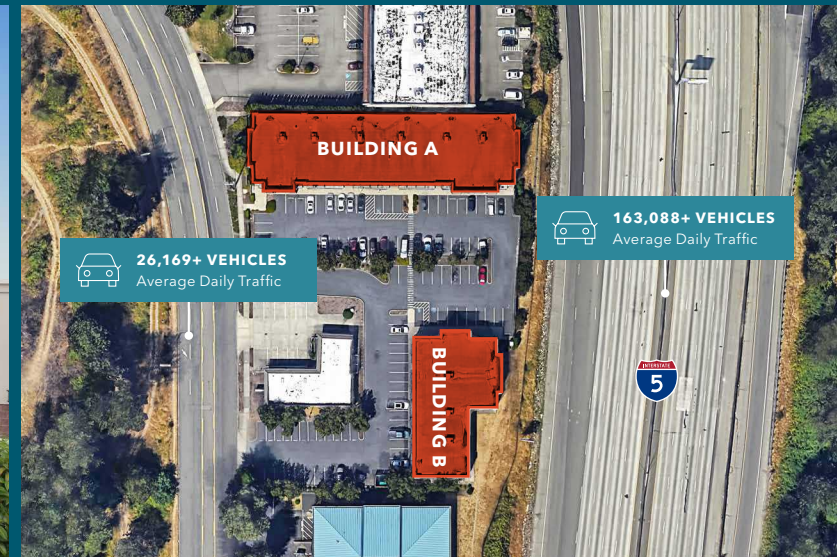

# PROSSER PLAZA



## BUILDING A AVAILABILITIES

Suite	SF	Tenant	Lease Rate
A	5,388	Prosser Piano	Leased
<b>B1*</b>	<b>2,836</b>	<b>AVAILABLE</b>	<b>\$25.00 SF +NNN</b>
<b>B1A*</b>	<b>1,505</b>	<b>AVAILABLE</b>	<b>\$25.00 SF +NNN</b>
<b>D</b>	<b>2,000</b>	<b>AVAILABLE 10/26</b>	<b>\$25.00 SF +NNN</b>
E	2,350	Club Champion	Leased

\*can be combined for 4,341 SF

NNN's = \$8.64 PSF

## DEMOGRAPHICS

	1 Mile	3 Miles	5 Miles
POPULATION	16,809	140,360	310,713
MEDIAN AGE	35.5	34.3	36.2
AVG HH INCOME	\$116,610	\$103,622	\$109,808

KIDDER.COM

This information supplied herein is from sources we deem reliable. It is provided without any representation, warranty, or guarantee, expressed or implied as to its accuracy. Prospective Buyer or Tenant should conduct an independent investigation and verification of all matters deemed to be material, including, but not limited to, statements of income and expenses. Consult your attorney, accountant, or other professional advisor.



# FLOOR PLAN - BLDG A

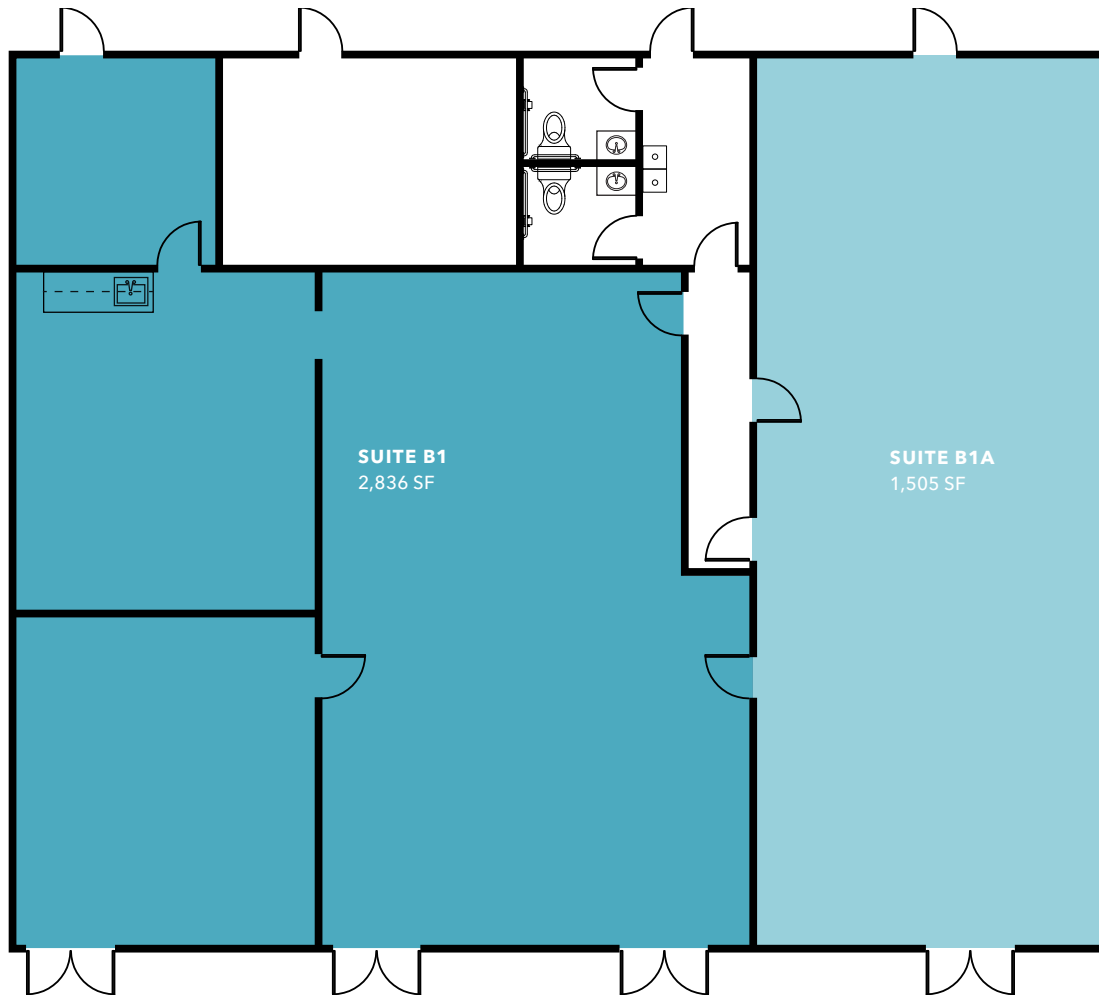

*2,836 SF*

BLDG A, SUITE B1

*1,505 SF*

BLDG A, SUITE B1A

*\$25.00*

PER SF + NNN NNN (\$8.64 PSF)

Can combine suites B1 & B1A for 4,341 SF

# PROSSER PLAZA



KIDDER.COM

This information supplied herein is from sources we deem reliable. It is provided without any representation, warranty, or guarantee, expressed or implied as to its accuracy. Prospective Buyer or Tenant should conduct an independent investigation and verification of all matters deemed to be material, including, but not limited to, statements of income and expenses. Consult your attorney, accountant, or other professional advisor.